

# Mill Lane, West Derby.

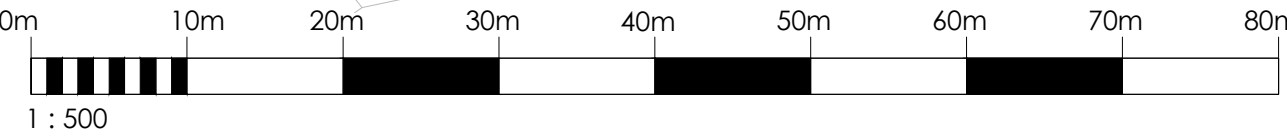
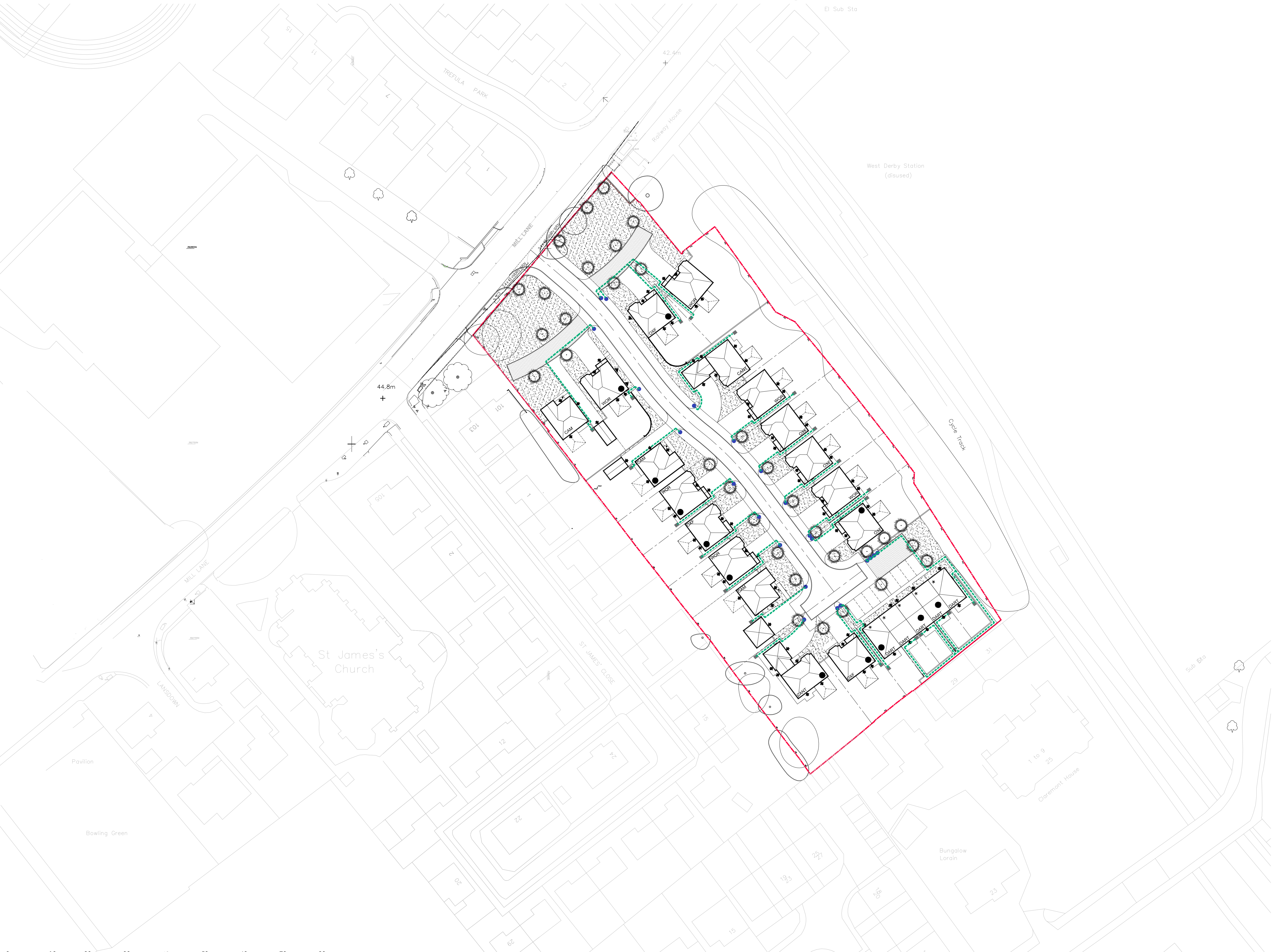

Survey Information

Legend

- Indicates bin collection point on kerbside
- Indicates location of proposed wheellie bins within private plot curtilage
- Indicates pedestrian walking distance from bin storage to collection point
- Indicates refuse vehicular

Item	Description
------	-------------

E	19.02.2016	Amended to correspond with Detailed Site Layout.	GJF
D	10.02.2016	Amended to correspond with Detailed Site Layout.	MJC
C	01.02.2016	Amended to correspond with Detailed Site Layout.	MJC
B	12/01/2016	Position of drive way to plots 1-2 amended.	TGH
A	07/01/2016	House type footprints updated.	TGH
Revision	Date	Amendment	Initials

**REDROW HOMES**

Redrow Homes Ltd - Lancashire Division

Redrow House, 14 Eaton Avenue, Budshaw Village, Chorley, Lancashire, PR67 7NA

Tel: 01772 643700 Fax: 01772 643701 Web: www.redrow.co.uk

Development	<b>Mill Lane</b>		
Location	<b>West Derby</b>		
Marketing Name			
Drawing Title	<b>Waste Management Layout</b>		
Drawing Number	<b>WML-001</b>		
Revision	E	Scale @ A1	1:500
Drawn By	MCK	Date Started	18.12.15
Checked by		Date	

Legal Disclaimer TBC:

This layout has been designed after due consideration of our Content & Constraints Plan