

Key:-

- Extra items required to comply with Approved Document M4(2) shown in blue.
- Clear space required in WC & Bathroom.
- Number indicates item related to AD-M4(2) Criterion

Approved Document M4(2) Criteria

- Principal entrance to have:
 - 1200 x 1200mm level external landing covered for a minimum width of 900mm and depth of 600mm.
 - Lighting on dusk to dawn or PIR sensor.
 - Min. clear opening width of 850mm with a 300mm nib on the leading edge, maintained for a minimum distance of 1200mm beyond it.
- All other external doors must comply with paragraph 1.3 above
- Hall or Landing clear width is 900mm.
- Door clear widths as AD-M4(2) Table 2.1. 300mm nib to all doors within entrance storey.
- Entrance level living space
- In a dwelling with 3 or more bedrooms, the entrance level WC also allows for a potential level access shower.
- Bathroom and WC walls / ducts / boxings can support fixings (e.g. grab rails, seats and other adaptations)
- 850mm (min.) clear width to stairs when measured 450mm above the pitch line (ignoring any newel post).

The Sunningdale M4(2) Heritage Collection "2017 Edition"

EF Series
1654sqft 153.70m²
DATE: April 2018
REV:



EF_SUND_M42_DM.7

Drawing Scale 1:50 @ A3

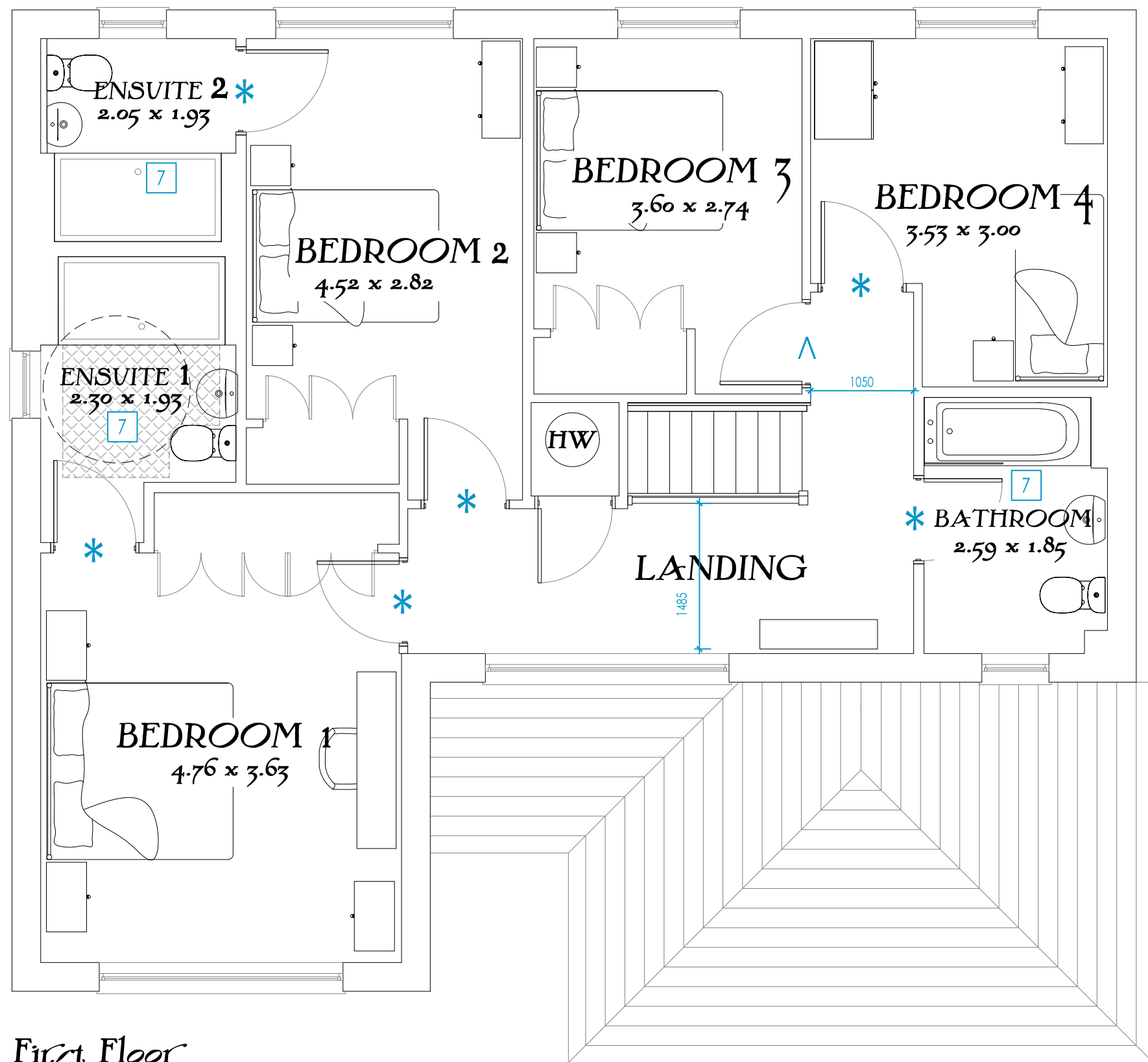



Key:-

-  Extra items required to comply with Approved Document M4(2) shown in blue.
-  Clear space required in WC & Bathroom.
-  Number indicates item related to AD-M4(2) Criterion

Approved Document M4(2) Criteria

1. Principal entrance to have:
 - 1.1. 1200 x 1200mm level external landing covered for a minimum width of 900mm and depth of 600mm.
 - 1.2. Lighting on dusk to dawn or PIR sensor.
 - 1.3. Min. clear opening width of 850mm with a 300mm nib on the leading edge, maintained for a minimum distance of 1200mm beyond it.
2. All other external doors must comply with paragraph 1.3 above
3. Hall or Landing clear width is 900mm.
4. Door clear widths as AD-M4(2) Table 2.1. 300mm nib to all doors within entrance storey.
5. Entrance level living space
6. In a dwelling with 3 or more bedrooms, the entrance level WC also allows for a potential level access shower.
7. Bathroom and WC walls / ducts / boxings can support fixings (e.g. grab rails, seats and other adaptations)
8. 850mm (min.) clear width to stairs when measured 450mm above the pitch line (ignoring any newel post).

The Sunningdale M4(2) Heritage Collection "2017 Edition"

EF Series
1654sqft 153.70m²
DATE: April 2018
REV:

EF_SUND_M42_DM.7

Drawing Scale 1:50 @ A3





Front Elevation



Side Elevation



Rear Elevation



Side Elevation

The Sunningdale M4(2) Heritage Collection "2017 Edition"

EF Series Brick (B1)
1654sqft 153.70m²
DATE: April 2018 REV: -



EF_SUND_M42_DM.7

Drawing scale 1:100 @ A3

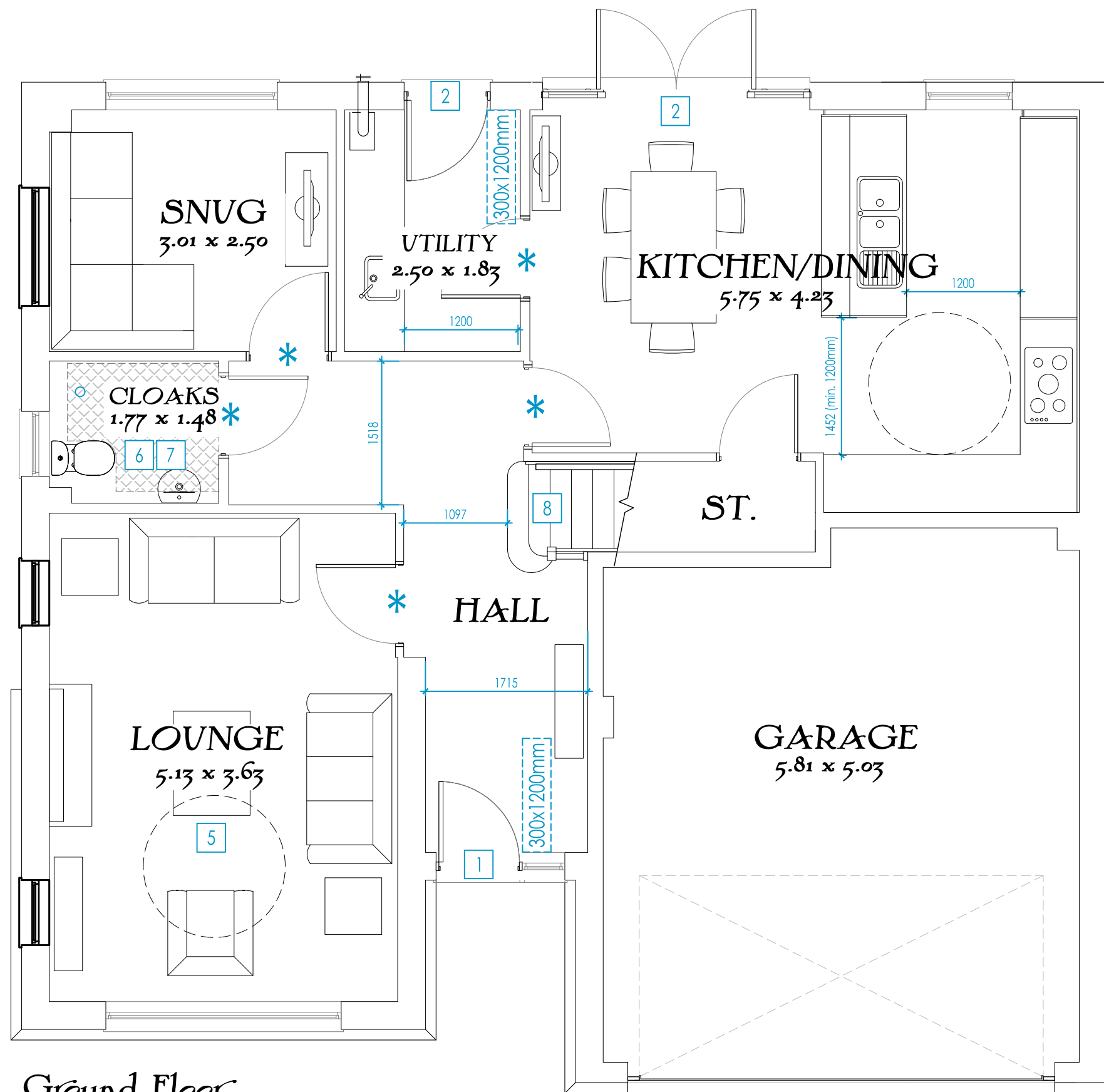



Key:-

-  Extra items required to comply with Approved Document M4(2) shown in blue.
-  Clear space required in WC & Bathroom.
-  Number indicates item related to AD-M4(2) Criterion

Approved Document M4(2) Criteria

- Principal entrance to have:
 - 1200 x 1200mm level external landing covered for a minimum width of 900mm and depth of 600mm.
 - Lighting on dusk to dawn or PIR sensor.
 - Min. clear opening width of 850mm with a 300mm nib on the leading edge, maintained for a minimum distance of 1200mm beyond it.
- All other external doors must comply with paragraph 1.3 above
- Hall or Landing clear width is 900mm.
- Door clear widths as AD-M4(2) Table 2.1. 300mm nib to all doors within entrance storey.
- Entrance level living space
- In a dwelling with 3 or more bedrooms, the entrance level WC also allows for a potential level access shower.
- Bathroom and WC walls / ducts / boxings can support fixings (e.g. grab rails, seats and other adaptations)
- 850mm (min.) clear width to stairs when measured 450mm above the pitch line (ignoring any newel post).

The Sunningdale M4(2) (Cnr)

Heritage Collection
"2017 Edition"

EF Series
1654sqft 153.70m²
DATE: April 2018
REV:

EF_SUND_M42_DM.7

Drawing Scale 1:50 @ A3



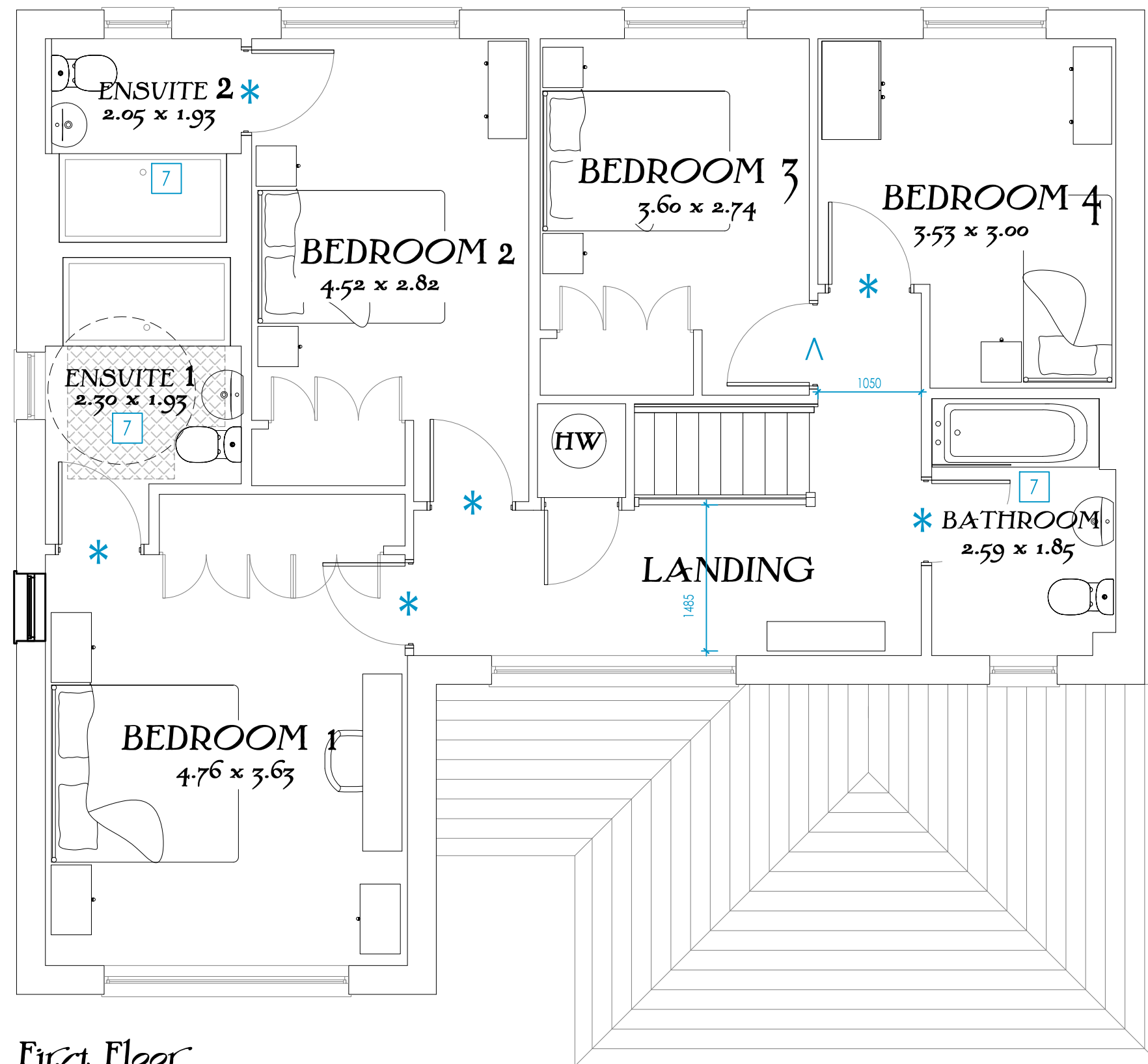

Key:-



Extra items required to comply with Approved Document M4(2) shown in blue.



Clear space required in WC & Bathroom.



Number indicates item related to AD-M4(2) Criterion

Approved Document M4(2) Criteria

1. Principal entrance to have:
 - 1.1. 1200 x 1200mm level external landing covered for a minimum width of 900mm and depth of 600mm.
 - 1.2. Lighting on dusk to dawn or PIR sensor.
 - 1.3. Min. clear opening width of 850mm with a 300mm nib on the leading edge, maintained for a minimum distance of 1200mm beyond it.
2. All other external doors must comply with paragraph 1.3 above
3. Hall or Landing clear width is 900mm.
4. Door clear widths as AD-M4(2) Table 2.1. 300mm nib to all doors within entrance storey.
5. Entrance level living space
6. In a dwelling with 3 or more bedrooms, the entrance level WC also allows for a potential level access shower.
7. Bathroom and WC walls / ducts / boxings can support fixings (e.g. grab rails, seats and other adaptations)
8. 850mm (min.) clear width to stairs when measured 450mm above the pitch line (ignoring any newel post).

The Sunningdale M4(2) (Cnr)

Heritage Collection
"2017 Edition"

EF Series
1654sqft 153.70m²
DATE: April 2018
REV:

EF_SUND_M42_DM.7

Drawing Scale 1:50 @ A3





Front Elevation

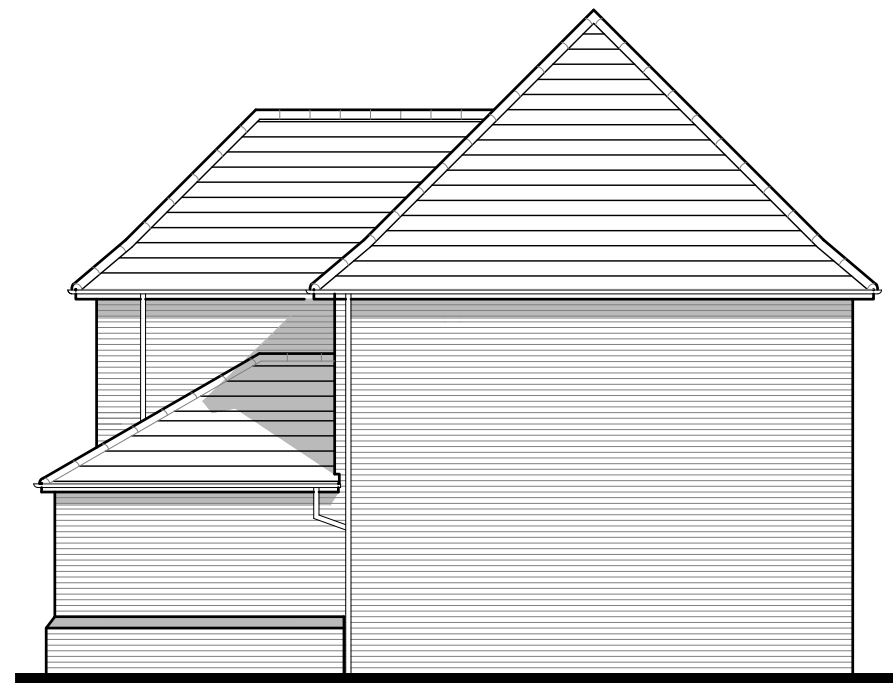

Side Elevation



Rear Elevation



Side Elevation

The Sunningdale M4(2) (Cnr)

Heritage Collection
"2017 Edition"

EF Series Brick (B1)
1654sqft 153.70m²
DATE: April 2018 REV: -

EF_SUND_M42_DM.7

Drawing scale 1:100 @ A3



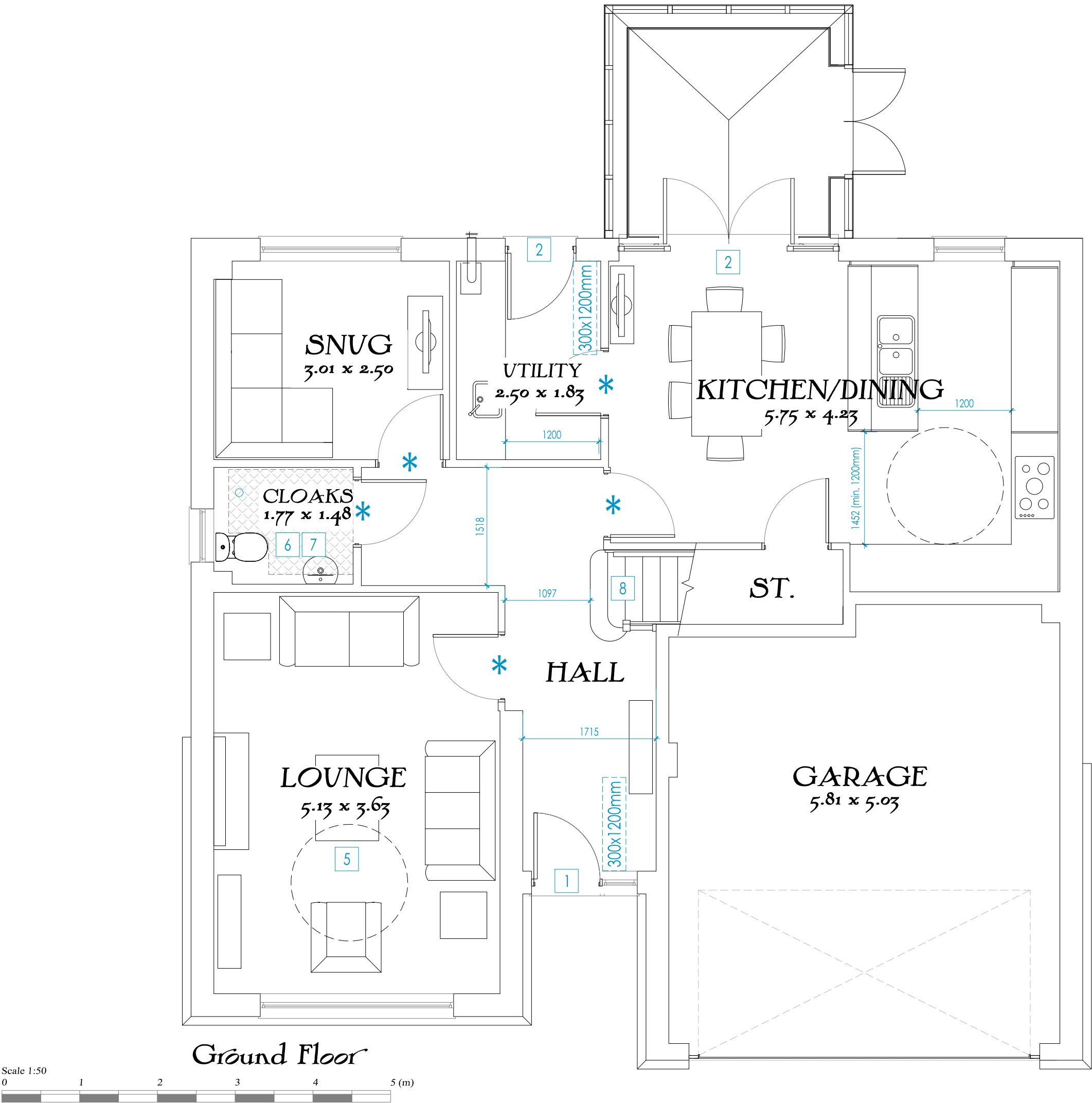

Key:-

- Extra items required to comply with Approved Document M4(2) shown in blue.
- Clear space required in WC & Bathroom.
- Number indicates item related to AD-M4(2) Criterion

- Approved Document M4(2) Criteria**
- Principal entrance to have:
 - 1200 x 1200mm level external landing covered for a minimum width of 900mm and depth of 600mm.
 - Lighting on dusk to dawn or PIR sensor.
 - Min. clear opening width of 850mm with a 300mm nib on the leading edge, maintained for a minimum distance of 1200mm beyond it.
 - All other external doors must comply with paragraph 1.3 above
 - Hall or Landing clear width is 900mm.
 - Door clear widths as AD-M4(2) Table 2.1. 300mm nib to all doors within entrance storey.
 - Entrance level living space
 - In a dwelling with 3 or more bedrooms, the entrance level WC also allows for a potential level access shower.
 - Bathroom and WC walls / ducts / boxings can support fixings (e.g. grab rails, seats and other adaptations)
 - 850mm (min.) clear width to stairs when measured 450mm above the pitch line (ignoring any newel post).

The Sunningdale M4(2) (Conservatory)

Heritage Collection
"2017 Edition"

EF Series
1654sqft 153.70m²
DATE: April 2018
REV:



EF_SUND_M42_DM.7

Drawing Scale 1:50 @ A3

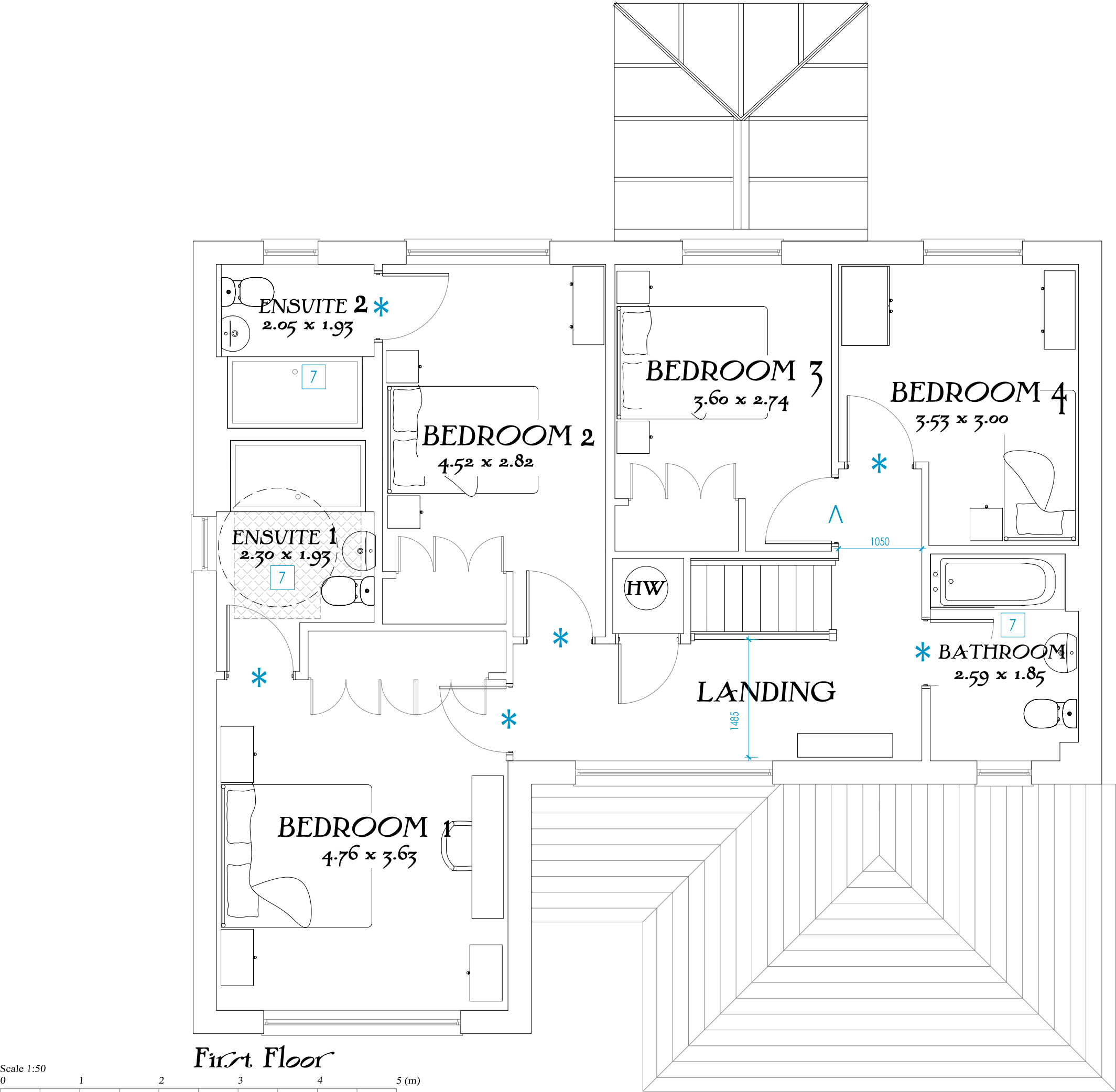



Key:-

-  Extra items required to comply with Approved Document M4(2) shown in blue.
-  Clear space required in WC & Bathroom.
-  Number indicates item related to AD-M4(2) Criterion

- Approved Document M4(2) Criteria**
- Principal entrance to have:
 - 1200 x 1200mm level external landing covered for a minimum width of 900mm and depth of 600mm.
 - Lighting on dusk to dawn or PIR sensor.
 - Min. clear opening width of 850mm with a 300mm nib on the leading edge, maintained for a minimum distance of 1200mm beyond it.
 - All other external doors must comply with paragraph 1.3 above
 - Hall or Landing clear width is 900mm.
 - Door clear widths as AD-M4(2) Table 2.1. 300mm nib to all doors within entrance storey.
 - Entrance level living space
 - In a dwelling with 3 or more bedrooms, the entrance level WC also allows for a potential level access shower.
 - Bathroom and WC walls / ducts / boxings can support fixings (e.g. grab rails, seats and other adaptations)
 - 850mm (min.) clear width to stairs when measured 450mm above the pitch line (ignoring any newel post).

The Sunningdale M4(2) (Conservatory)

Heritage Collection
"2017 Edition"

EF Series
1654sqft 153.70m²
DATE: April 2018
REV:
EF_SUND_M42_DM.7

Drawing Scale 1:50 @ A3





Front Elevation



Side Elevation



Rear Elevation



Side Elevation

The Sunningdale M4(2) (Conservatory)

Heritage Collection
"2017 Edition"

EF Series Brick (B1)
1654sqft 153.70m²
DATE: April 2018 REV: -

EF_SUND_M42_DM.7

Drawing scale 1:100 @ A3

