

clocks walls lined with plywood to comply with criterion 11.

drainage allocation for a shower in the wc area

clear turning space shown hatched.

900mm min. stair width measured 450mm above pitch height.

provision for through floor lift 1100x1400mm

Ground Floor

#### Key:-

--- Location of walls / doors on standard house type shown in red.

■ Extra items required to comply with Lifetime Homes shown in blue.

---△ Track Hoist route shown in green.

□ Clear space required in WC & Bathroom.

..\\Lifetime Homes Logo.jpg

bathroom walls lined with plywood to comply with criterion 11.

ensuite walls lined with plywood to comply with criterion 11.

structure above ceiling should be capable of supporting, or capable of adaptation to support, the future installation of single point hoists above the bed, bath and wc.

provision for through floor lift 1100x1400mm

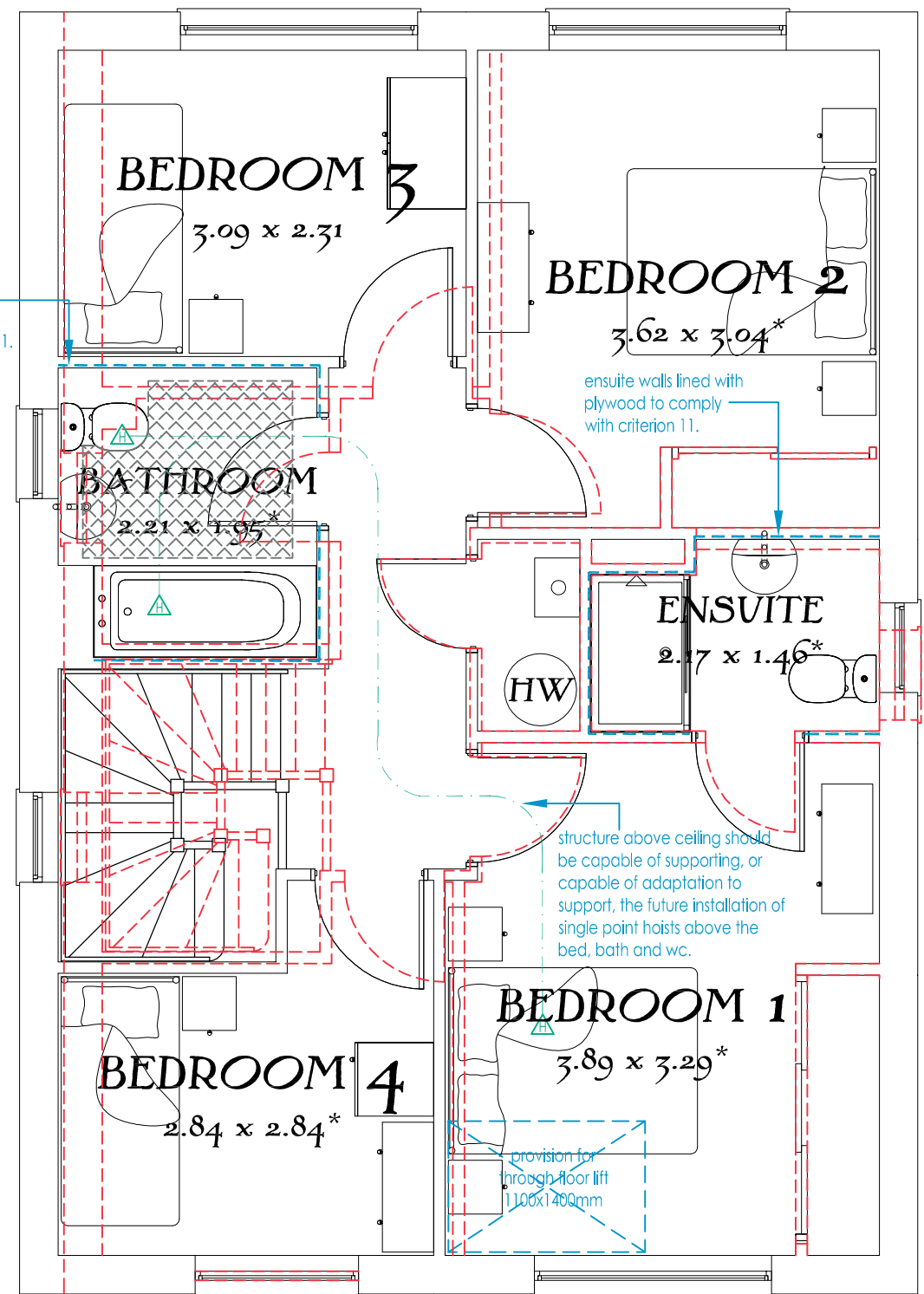

First Floor

#### General Notes

- Each habitable room to have 1 No. openable window with controls no higher than 1200mm from finished floor level (kitchen & bathroom window not applicable).
- All service controls should be within a height of 450mm to 1200mm from finished floor. Services include switches, sockets, tv / telephone points, consumer units, heating programmer / radiator thermostats, and water stop tap.

The Stratford  
Lifetime Homes  
Based on E4H117-3  
1239sqft (1173sqft)

DATE: Aug 2014

Drawing scale 1:50 @ A3

..\\Redrow Logos\\Redrow logo (New).jpg