

C:\Documents and Settings\126629\Desktop\Standard Details\1R-6.dwg, 16/10/2013 10:34:33, 126629

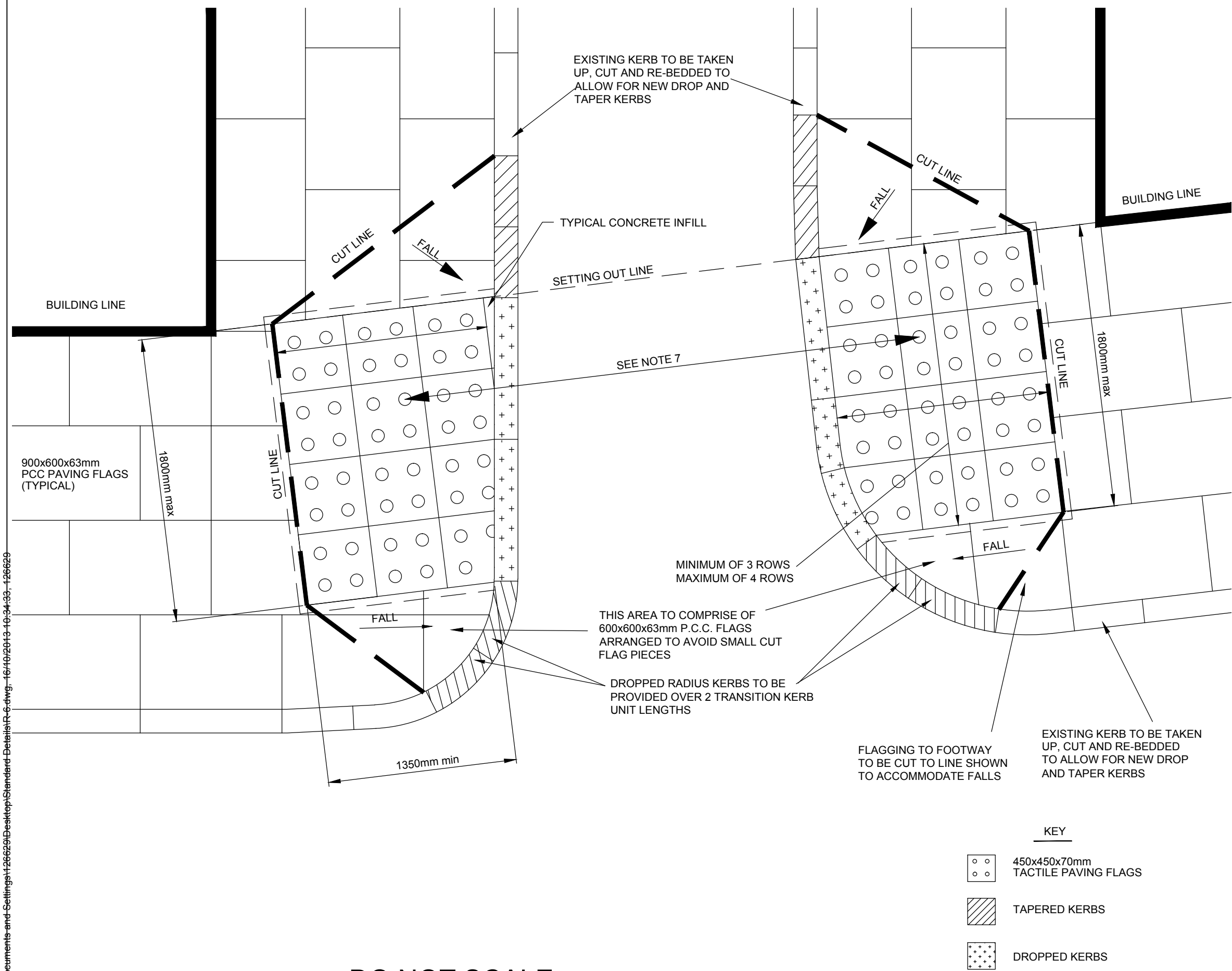

DO NOT SCALE

- NOTES
- 1 ALL DIMENSIONS ARE IN MILLIMETRES
 - 2 FOR FLEXIBLE FOOTWAY CONSTRUCTION, KERBING ARRANGEMENT AND FOOTWAY FALLS TO BE AS STANDARD CROSSING DRAWING TOGETHER WITH EDGING STRIP.
 - 3 FOR FOOTWAY CONSTRUCTION SEE Standard Detail HD/R3
 - 4 TACTILE PAVING FLAGS TO BE LAID IN ACCORDANCE WITH DFT PUBLICATION 'GUIDANCE ON THE USE OF TACTILE PAVING SURFACES'
 - 5 BUFF TACTILE PAVING FLAGS TO BE USED AT UNCONTROLLED CROSSING POSITIONS
 6. ANY MAKE UP IN PAVED CONSTRUCTION FOOTWAYS TO BE IN CUT FLAGS SAVED FROM EXISTING FOOTWAY. FLAGS TO BE ARRANGED AS SUCH AS TO AVOID SMALL CUT PIECES. CONCRETE INFILL ONLY TO BE USED WITH THE INSTRUCTION OF SITE ENGINEER.
 7. DROP KERBS ON CROSSING TO ALIGN WITH CROSSING ON OPPOSITE SIDE OF ROAD. BLISTERS ON TACTILE PAVING MUST ALIGN WITH BLISTERS ON PAVIORS ON OPPOSITE SIDE OF ROAD.
 8. FOR CROSS SECTION SEE DETAIL ON STANDARD UNCONTROLLED CROSSING
 - 9 FOR KERBS ADJACENT A WATER CARRYING CHANNEL, UPSTAND SHOULD BE 6mm ABSOLUTE MAXIMUM DESIRABLE 0mm. ADJACENT A 'DRY' CHANNEL KERBS SHOULD BE FLUSH
 - 10 DRAINAGE PROVISION TO BE CONSIDERED SEPARATELY



PROJECT TITLE

2008 ISSUE

Standard Detail

Highways

DRAWING INFORMATION

Non-Standard In-Line Uncontrolled Pedestrian Dropped Crossing

Survey By	-	Survey Date	-
Design By	DRC	Design Date	Jan 2003
Drawn By	PP	Creation Date	May 2005
Checked By	CF	Checked Date	May 2008
Approv'd By	JW	Approv'd Date	May 2008
Drawing Status	Drawing Scale		
	N.T.S.		
Drawing Number	Revision		
	Std Detail/HD/R6		
File Name			
TCSU Site Ref	N/A	BES Ref	N/A
A3 395 x 272mm	Printed on 16-Oct-13 by Deakin, David		