

Appendix 6 – Kings Waterfront Estates Drainage Plans

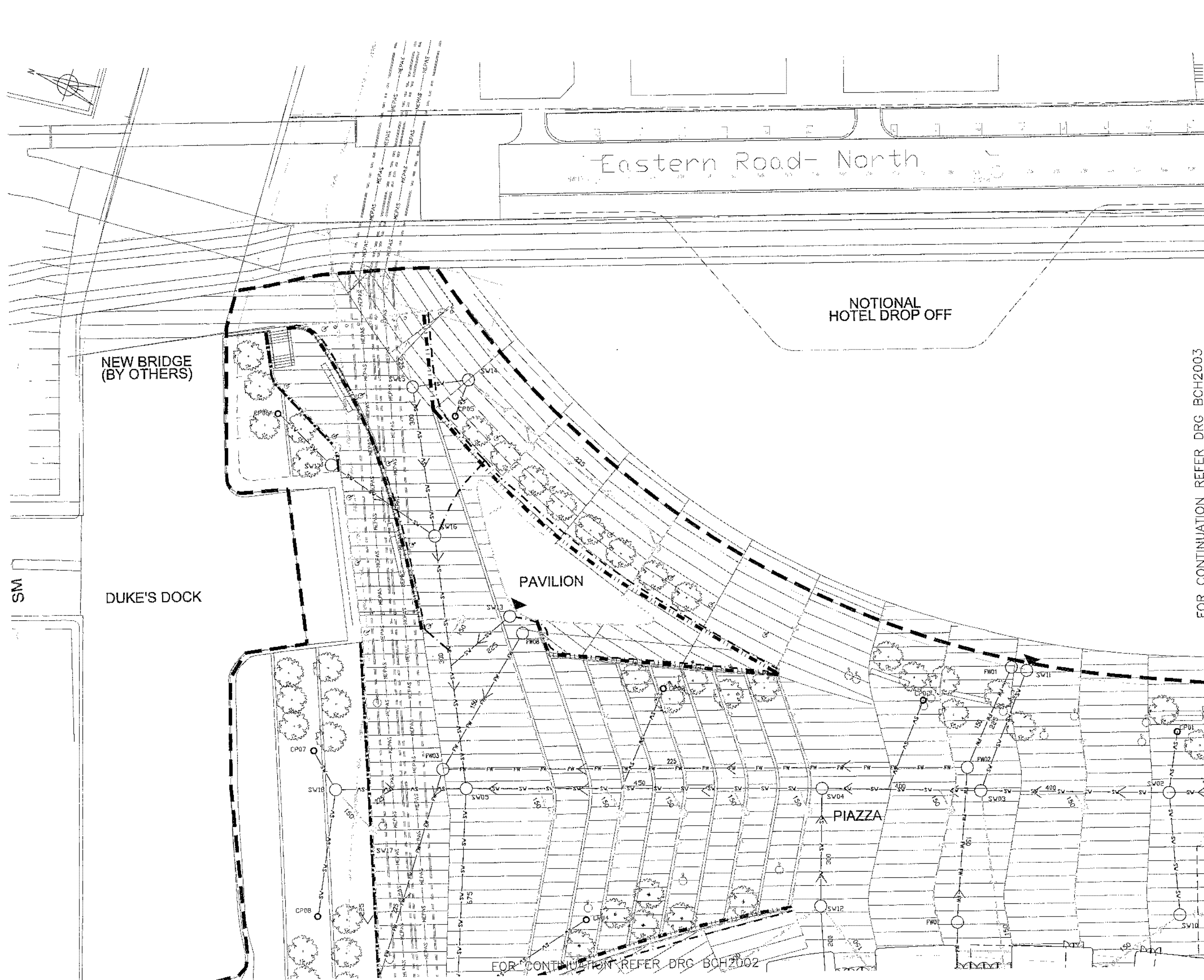

- Notes
1. DO NOT SCALE FROM THIS DRAWING.
 2. FOR GENERAL NOTES ON EXTERNAL DRAINAGE REFER TO BHC2000.
 3. REFER TO DRG BHC2020-21 FOR STANDARD DETAILS.
 4. REFER TO MANHOLE SCHEDULE FOR MANHOLE AND INVERT LEVEL INFORMATION.
 5. LANDSCAPE DRAINAGE BY OTHERS.

- LEGEND
- PROPOSED EXTERNAL MANHOLE
 - SV — PROPOSED SURFACE WATER
 - FW — PROPOSED FOUL WATER
 - EXISTING FOUL RISING MAIN
 - ▲ BUILDING DISCHARGE POINT (REFER TO BHC3000 SERIES)
 - INDICATIVE LANDSCAPE DRAINAGE CATCHPIT (INCOMING LANDSCAPE DRAINAGE BY OTHERS)
 - LINEAR DRAINAGE SUMP
 - LINEAR DRAINAGE (REFER TO BHC 2030'S SERIES)
 - PERFORATED DRAIN FROM RETAINING WALLS
 - ⌋ CONNECTION TO SEWERS

FOR CONTINUATION REFER DRG BCH2003

02	FOR TENDER	13.06.05	RMAB
01	TENDER ISSUE	12.05.05	RMAB
00	ORIGINAL ISSUE	04.04.05	RMAB

FOR TENDER	JUNE 05
Issued only for purpose indicated	Date

17 Newman Street
London
W1P 3HQ

Tel: 0171 927 9700
Fax: 0171 927 9701

Buro Happold
Consulting Engineers

Project: KINGS WATERFRONT
EXTERNAL DRAINAGE LAYOUT
SHEET 1 OF 4

Scale: 1:250 @ A1
Drawn by: ASK
Checked by: RMAB
Date: MAY 2005

Job no.: 008636
Drawing no.: BHC2001
Rev: 02

FOR CONTINUATION REFER DRG BCH2002

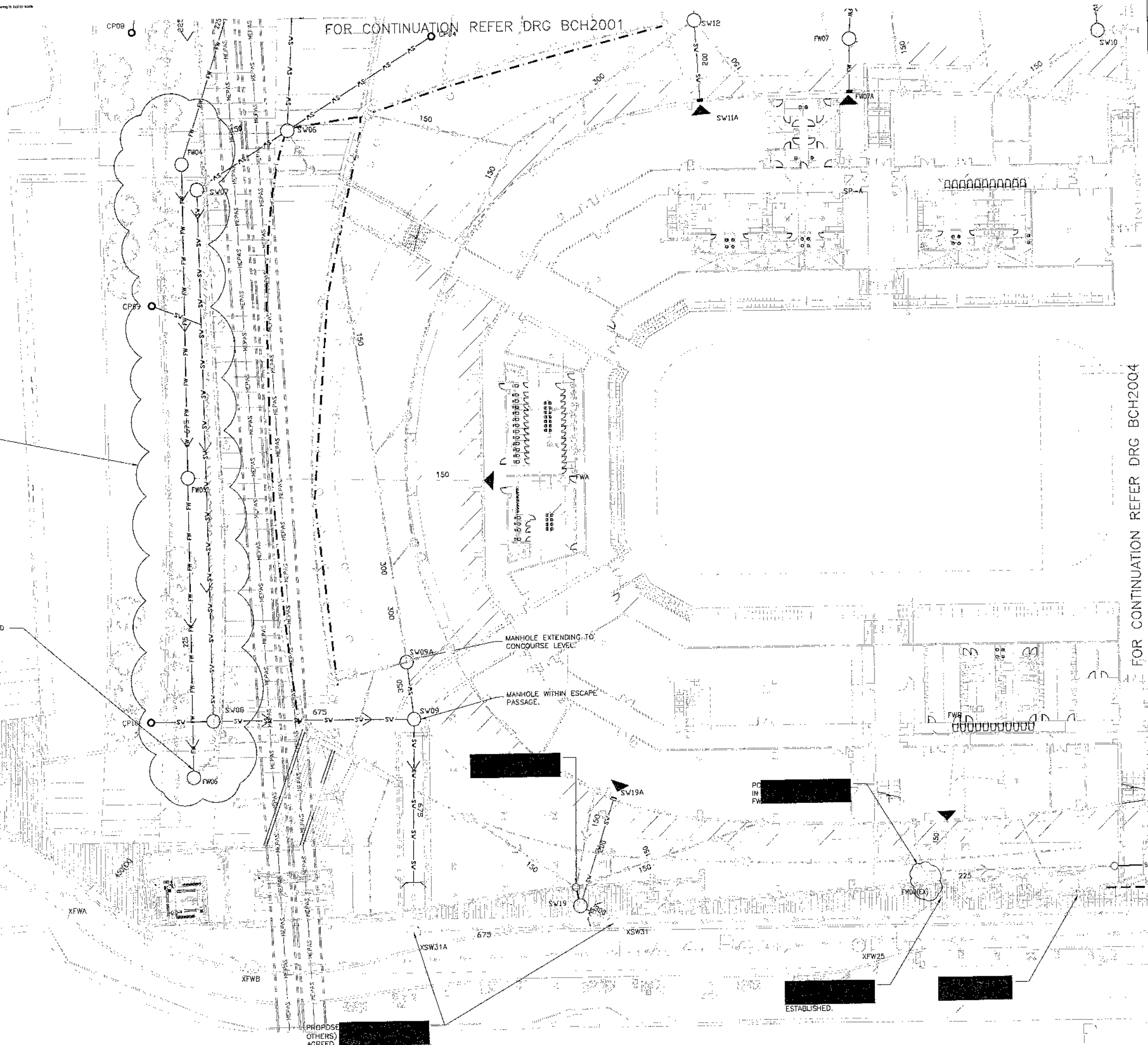

NEW MANHOLE TO BE CONSTRUCTED
ON EXISTING FOUL SEWER AND
EXISTING UPSTREAM CONNECTION
ABANDONED.

FOR CONTINUATION REFER DRG BCH2001











FOR CONTINUATION REFER DRG BCH2004

DO NOT SCALE THIS DRAWING

Notes

1. DO NOT SCALE FROM THIS DRAWING.
2. FOR GENERAL NOTES ON EXTERNAL DRAINAGE REFER TO BHC2000.
3. REFER TO DRG BHC2020-21 FOR STANDARD DETAILS.
4. REFER TO MANHOLE SCHEDULE FOR MANHOLE AND INVERT LEVEL INFORMATION.
5. LANDSCAPE DRAINAGE BY OTHERS.
6. CONTRACTOR TO CONFIRM EXACT LOCATION OF RISING MAIN PRIOR TO START OF WORKS.

LEGEND

-  PROPOSED EXTERNAL MANHOLE
 SV → SV PROPOSED SURFACE WATER
 FV → FV PROPOSED FOUL WATER
 --- --- --- EXISTING FOUL RISING MAIN
 BUILDING DISCHARGE POINT
 (REFER TO BHC3000 SERIES)
 INDICATIVE LANDSCAPE DRAINAGE
 CATCHPIT (INCOMING LANDSCAPE
 DRAINAGE BY OTHERS)
 --- --- --- LINEAR DRAINAGE SUMP
 --- --- --- LINEAR DRAINAGE (REFER TO
 BHC 2030's SERIES)
 --- --- --- PERFORATED DRAIN FROM
 RETAINING WALLS
 CONNECTION TO SEWERS

02	FOR TENDER	13.06.05	RMAB
01	TENDER ISSUE	12.05.05	RMAB
00	ORIGINAL ISSUE	04.04.05	RMAB

Row	Description	Date	Checked
-----	-------------	------	---------

FOR TENDER	JUNE 05
Issued only for purposes indicated	Date

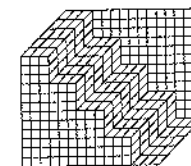

17 Newman Street
London
W1P 3HD

Tel 0171 927 9700
Fax 0171 927 9701

Architect **WILKINSONEY ARCHITECTS**

KINGS WATERFRONT
EXTERNAL DRAINAGE LAYOUT
SHEET 2 OF 4

Stakes	1250 @ A1	Job No.	008636
Drawn by	ABK	Erasing No.	BHC2002
Checked by	FWAB		
Date	MAR 2005	Rev	(2)

FOR CONTINUATION REFER DRG BCH2000

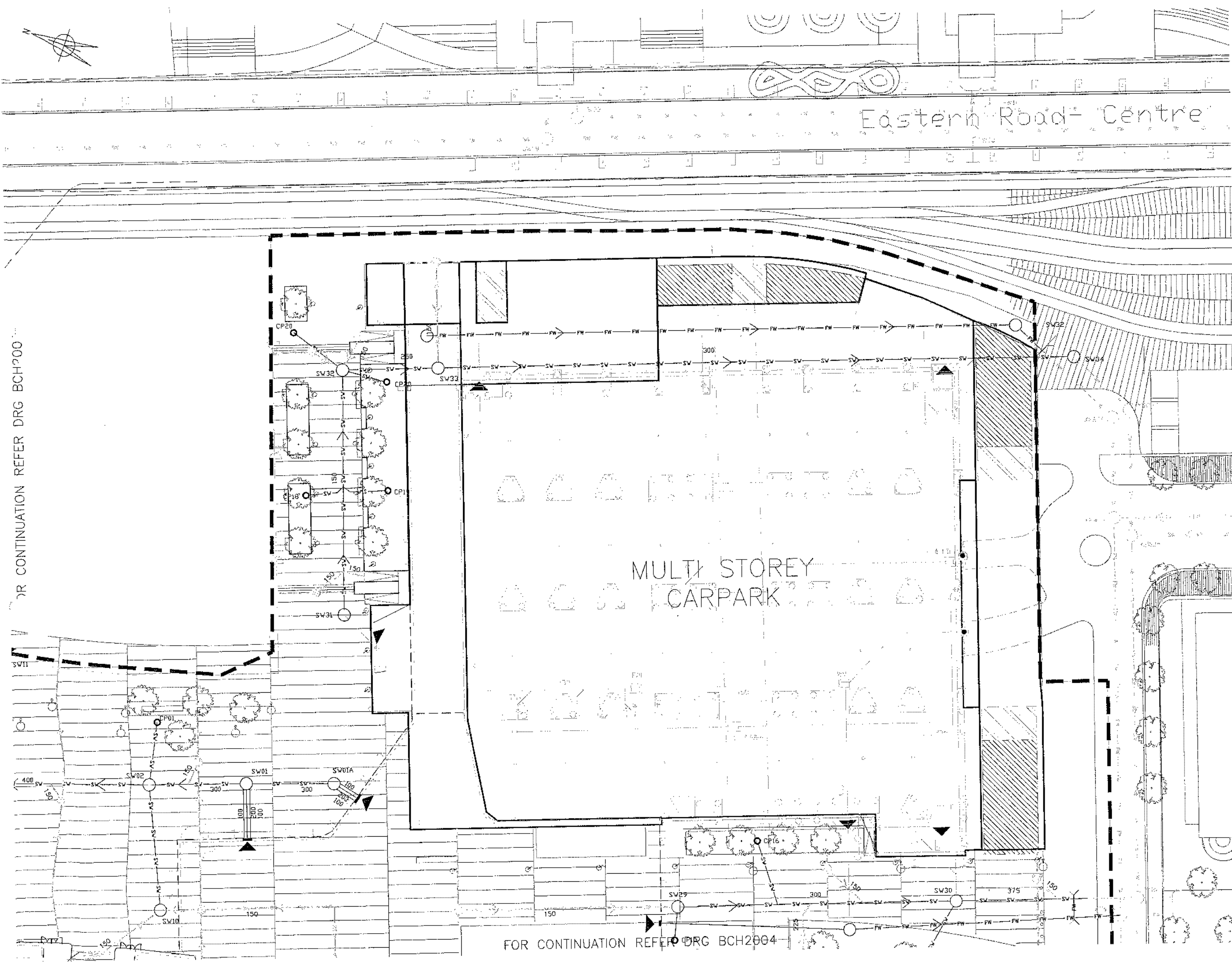

- Notes
1. DO NOT SCALE FROM THIS DRAWING.
 2. FOR GENERAL NOTES ON EXTERNAL DRAINAGE REFER TO BHC2000.
 3. REFER TO DRG BHC2020-21 FOR STANDARD DETAILS.
 4. REFER TO MANHOLE SCHEDULE FOR MANHOLE AND INVERT LEVEL INFORMATION.
 5. LANDSCAPE DRAINAGE BY OTHERS.

- LEGEND
- PROPOSED EXTERNAL MANHOLE
 - SV → SV PROPOSED SURFACE WATER
 - FW → FW PROPOSED FOUL WATER
 - EXISTING FOUL RISING MAIN
 - ▲ BUILDING DISCHARGE POINT (REFER TO BHC3000 SERIES)
 - INDICATIVE LANDSCAPE DRAINAGE CATCHPIT (INCOMING LANDSCAPE DRAINAGE BY OTHERS)
 - LINEAR DRAINAGE SUMP
 - LINEAR DRAINAGE (REFER TO BHC 2030's SERIES)
 - - - PERFORATED DRAIN FROM RETAINING WALLS
 - CONNECTION TO SEWERS

02	FOR TENDER	13.06.05	RMAE
01	TENDER ISSUE	12.05.05	RMAE
00	ORIGINAL ISSUE	04.04.05	RMAE

No	Description	Date	Checked
----	-------------	------	---------

FOR TENDER
Issued only for purpose indicated

JUNE 05
Date

17 Newmarket Street
London
W1P 3HD

Tel: 0171 927 9700
Fax: 0171 927 9701

Architect: WILKINSON EYRE ARCHITECTS

Project: KINGS WATERFRONT
EXTERNAL DRAINAGE LAYOUT
SHEET 3 OF 4

Scale: 1:250 @ A1
Drawn by: ASK
Checked by: PAB
Date: JAN 2005

Job No: 008636
Drawing No: BHC2004
Rev: 02

Buro Happold
Consulting Engineers

FOR CONTINUATION REFER DRG BCH2004

OR CONTINUATION REFER DRG BCH2000

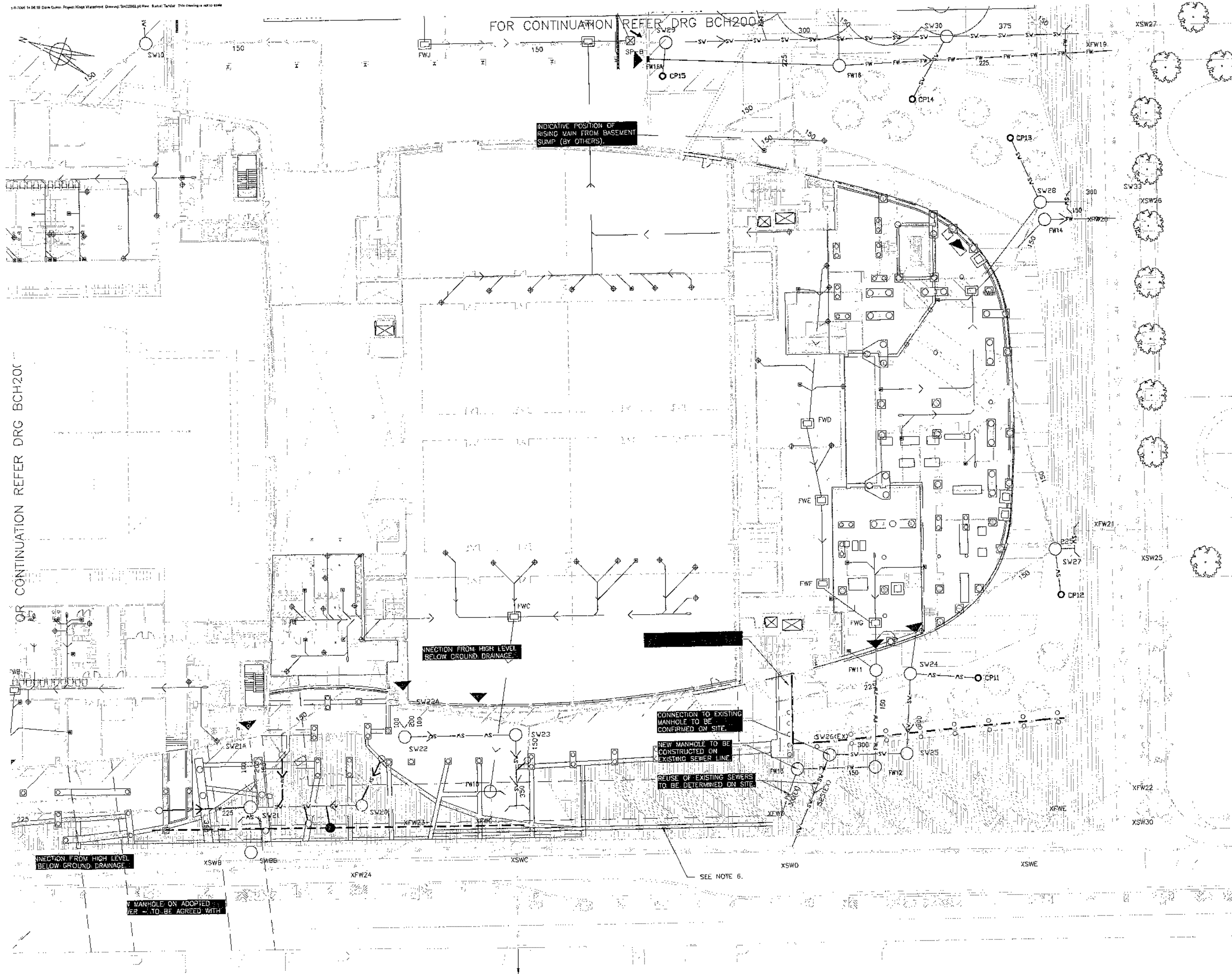

- Notes**
1. DO NOT SCALE FROM THIS DRAWING.
 2. FOR GENERAL NOTES ON EXTERNAL DRAINAGE REFER TO BHC2000.
 3. REFER TO DRG BHC2020-21 FOR STANDARD DETAILS.
 4. REFER TO MANHOLE SCHEDULE FOR MANHOLE AND INVERT LEVEL INFORMATION.
 5. LANDSCAPE DRAINAGE BY OTHERS.
 6. CURED IN PLACE STRUCTURAL SEWER LINER TO BE INSTALLED WITHIN EXISTING FOUL SEWER WHERE SEWER PASSES BENEATH STRUCTURE. EXTENT AND DETAILS TO BE CONFIRMED.

- LEGEND**
- PROPOSED EXTERNAL MANHOLE
 - SV → SV PROPOSED SURFACE WATER
 - FW → FW PROPOSED FOUL WATER
 - EXISTING FOUL RISING MAIN
 - ▲ BUILDING DISCHARGE POINT (REFER TO BHC3000 SERIES)
 - INDICATIVE LANDSCAPE DRAINAGE CATCHPIT (INCOMING LANDSCAPE DRAINAGE BY OTHERS)
 - LINEAR DRAINAGE SUMP
 - LINEAR DRAINAGE (REFER TO BHC 2030's SERIES)
 - PERFORATED DRAIN FROM RETAINING WALLS
 - CONNECTION TO SEWERS

02	FOR TENDER	13.06.05	RMAB
01	TENDER ISSUE	12.05.05	RMAB
00	ORIGINAL ISSUE	04.04.05	RMAB

Rev	Description	Date	Checked
-----	-------------	------	---------

FOR TENDER	JUNE 05
Issued only for purposes indicated	Date

17 Newnham Street
London
W1P 3HD

Tel: 0171 927 0700
Fax: 0171 927 9701

Buro Happold
Consulting Engineers

Project	KINGS WATERFRONT EXTERNAL DRAINAGE LAYOUT SHEET 4 OF 4		
Drawn by	1250 @ J1	Job No.	008636
Checked by	ASB	Drawing No.	BHC2000
Date	MAY 2005	Rev	02