

Bath Street

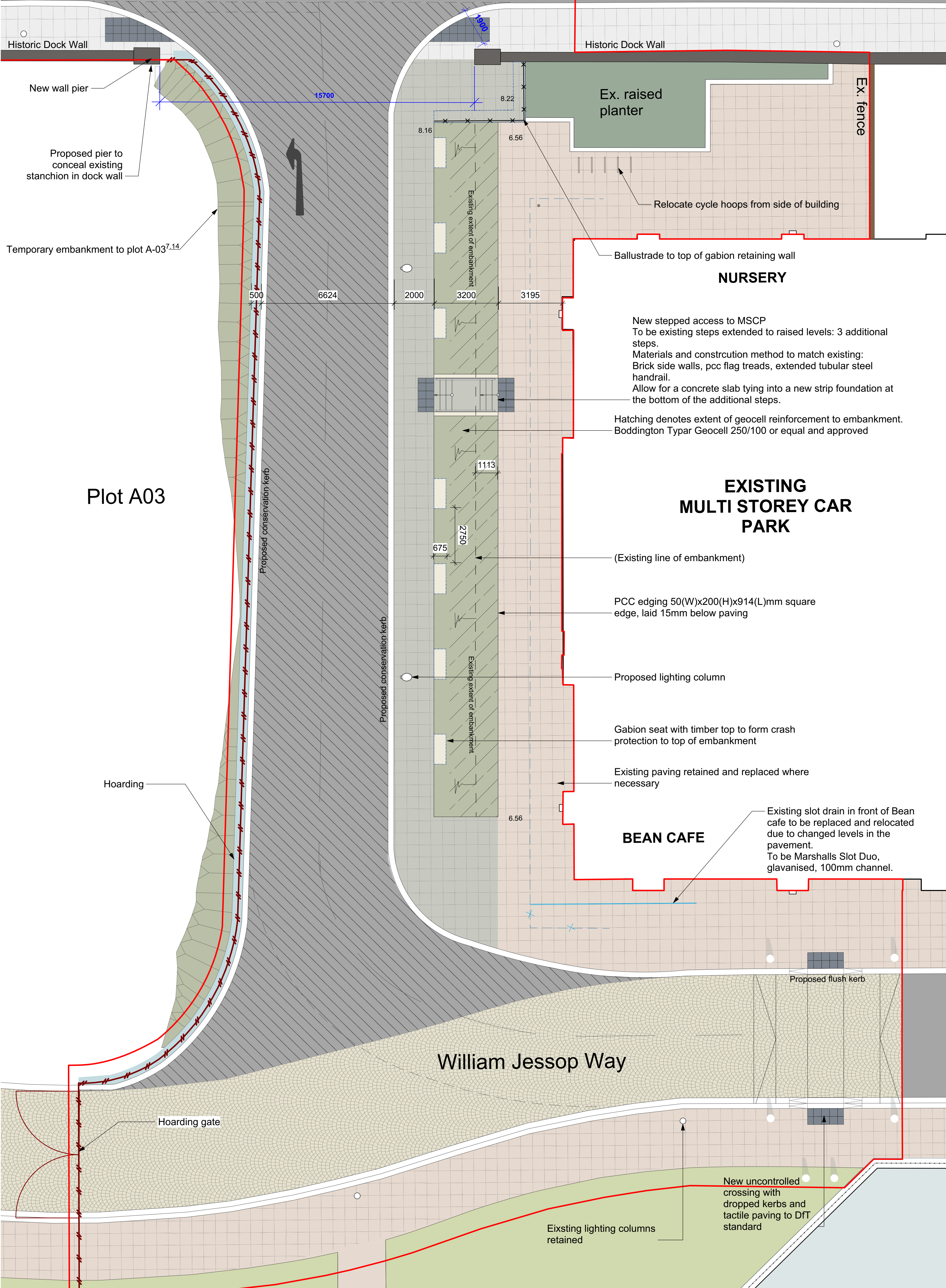

Boundaries

- Planning Boundary
- Hoarding Line
- Ownership Boundary

Kerbs + Edging - PROPOSED

Type: Conservation Kerb - 914 (L) x 255(W) x 145(H)
Supplier: Marshalls
Location: To Proposed Carriageway

Pedestrian Surfaces - EXISTING

Existing PCC Slab Paving
Location: Princes Dock footpaths
Supplier: Marshalls
Product: Saxon textured concrete paving
Dimensions: 600(L) x 600(W)
Colour: Natural
Laying Pattern: Stack Bond (4x4 grid)

Existing PCC Slab Paving
Location: Bath Street footpath
Supplier: Marshalls
Product: Saxon textured concrete paving
Dimensions: 600(L) x 900(W)
Colour: Natural
Laying Pattern: Stack Bond (4x4 grid)

Pedestrian Surfaces - PROPOSED

Type: Proposed PCC Slab Paving
Supplier: Marshalls
Product: Saxon textured concrete paving
Dimensions: 600(L) x 600(W) x 65mm(T)
Colour: Natural, to match existing
Laying Pattern: Stack Bond (4x4 grid)

Type: PCC Tactile Paving
Supplier: Marshalls
Dimensions: 600(L) x 600(W) x 65(T)
Colour: Charcoal

Trafficked Surfaces - EXISTING

Type: Existing hot rolled asphalt
Location: To William Jessop Way carriageway

Type: Existing Carriageway Granite setts paving
Location: To William Jessop Way carriageway

Trafficked Surfaces - PROPOSED

Type: Bituminous Carriageway
Location: To William Jessop Way
Material: Hot rolled asphalt with 10mm aggregate surface course

Unbound Hard Surfaces

Gravel Strip:
Location: Strip between road kerb and hoarding
Material: Stone to dust: 0-20mm gauge crushed quarried.
Stone type: submit proposals.
Colour: grey
Thickness: 75mm layer
Sub-base: 150mm lightly compacted Type 1 aggregate, no topsoil underneath. No use of geotextile.

Softworks

Type: Existing Lawned Areas
Location: As Shown

Type: Ornamental Planting
Location: As Shown

Type: Proposed Embankment
Location: As Shown

NOTE

For all sub-surface and structurally relevant elements refer to the engineers' details and specification.
Don't scale from the drawing, engineers' dimensions take precedence. Please consult with us in case of inconsistencies with engineers' information.

Submit proposals and samples for all surface materials for approval prior to construction.

05	04/12/2017	Planning	JV	JD
04	01/12/2017	Planning	JV	JD
03	28/10/2017	Tender	JV	JD
02	24/10/2017	Tender	JV	JD
01	23/10/2017	Tender	JV	JD

Issue	Date	Status	Drawn	Apprvd.
-------	------	--------	-------	---------

THIS DRAWING IS COPYRIGHT PROTECTED AND MAY NOT BE REPRODUCED IN WHOLE OR PART WITHOUT WRITTEN AUTHORITY FROM THE OWNER.

- NOTE:**
- Do not scale from this drawing. Always work to noted dimensions.
 - All dimensions are in millimetres unless otherwise stated.
 - All setting out, levels and dimensions to be agreed on site.
 - The dimensions of all materials must be checked on site before being laid out.
 - This drawing must be read with the relevant specification clauses and detail drawings.
 - Order of construction and setting out to be agreed on site.

**Planit Intelligent Environments LLP**
E: info@planit-ie.com W: planit-ie.com

MANCHESTER
2 Back Grafton St
Altrincham
WA14 1DY
T: 0161 928 9281

LONDON
18 Bowling Green Lane
London
EC1R 0BW
T: 0207 253 5678

Client	Peel Holdings	
Project	Liverpool Waters Princes Dock - Dock Wall Opening	
Drg Title	Landscape Works General Arrangement	
Created on	Created by	Approved by
23/10/2017	JV/JD	PS
Scale	Size	Status
1:100	A1	Planning