

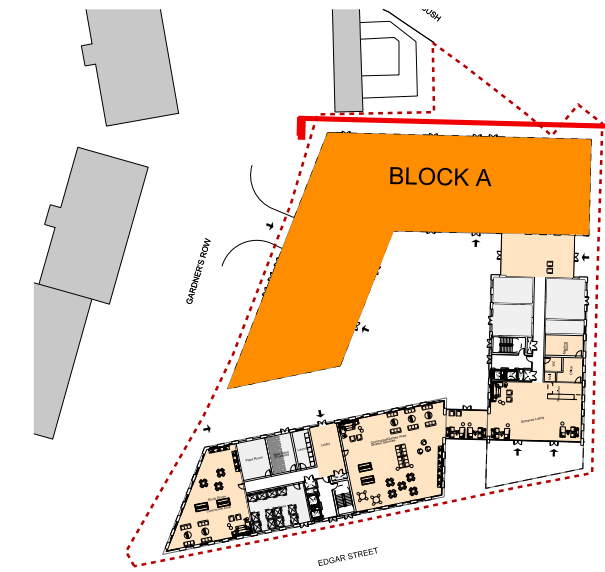

- MATERIALS KEY
1. Brickwork - stretcher bond (Colour: Gold-White)
  2. Brickwork - soldier coarse (Colour: Gold-White)
  3. Perforated brickwork (Colour: Gold-White)
  4. Anodised aluminium (Colour: Anolok 545)
  5. Profiled anodised aluminium panel (Colour: Anolok 545)
  6. Anodised aluminium windows (Colour: Anolok 545)
  7. Glazed Juliet balcony balustrade
  8. Opaque glass infill panel
  9. Aluminium brise soleil (Colour: Anolok 545)
  10. Aluminium ventilation louvres
  11. Aluminium surround (Colour: Anolok 541)
  12. Aluminium door (Colour: Anolok 541)
  13. Concrete cladding
  14. Frameless glass balustrade
  15. Perforated aluminium balcony
  16. Glazed curtain walling

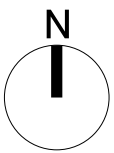

FALCONER  
CHESTER  
HALL



No 12 Temple Street, Liverpool, L2 5RH Telephone +44(0)151 243 5800  
5th Floor, 22 Soho Square, London, W1D 4NS Telephone +44(0) 203 137 7393

Project Title  
Beverington Bush/ Gardner's Row, Liverpool  
Drawing Title  
Elevation 01 - Block A  
Client  
Jamworks  
Drawn By  
JC  
Date  
14.08.2015  
Scale  
1:100 @ A1  
Project No.  
P14-092  
Drawing No.  
02-05-A-001  
www.fcharchitects.com  
© F.C.H.