

Ground Floor

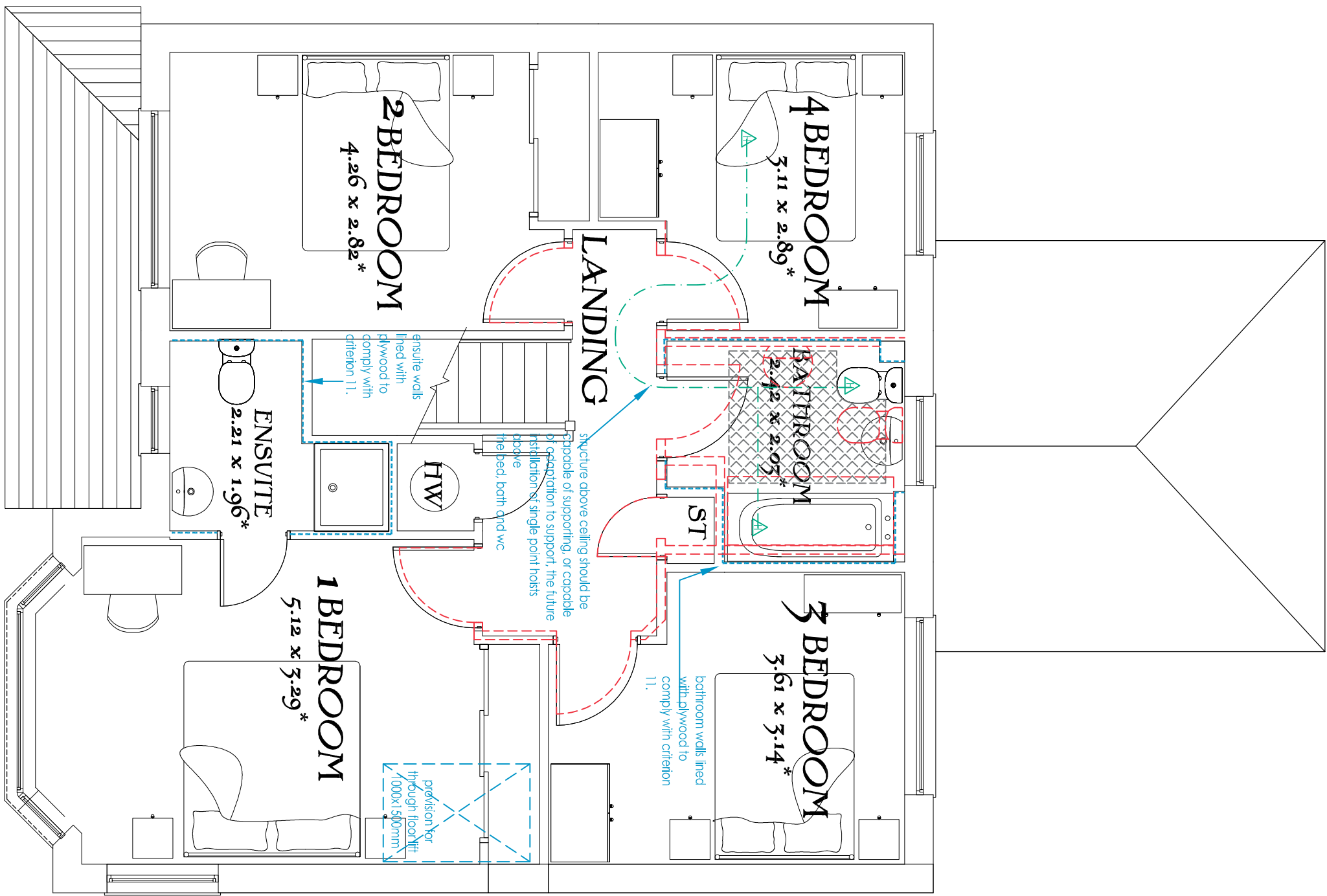

First Floor



- Key::**
- Location of walls / doors on standard house type shown in red.
 - Extra items required to comply with Lifetime Homes shown in blue.
 - Track Hoist route shown in green.
 - Clear space required in WC & Bathroom.

- General Notes**
- Each habitable room to have 1 No. operable window with controls no higher than 1200mm from finished floor level (kitchen & bathroom window not applicable).
 - All service controls should be within a height of 450mm to 1200mm from finished floor. Services include switches, sockets, tv / telephone points, consumer units, heating programmer / radiator thermostats, and water stop tap.

Lifetime Homes
Based on E4H130-1

DATE: July 2014
REV: B

Drawing scale 1:50 @ A2

The Oxford
Plot 2

Revisions:
A 01.02.16 Conservatory added.
B 11.02.16 Gable windows added to plot 2 only

