

The use of this data by the recipient acts as an agreement of the following statements. Do not use this data if you do not agree with any of the following statements:

All drawings are based upon site information supplied by third parties and as such their accuracy cannot be guaranteed. All features are approximate and subject to clarification by a detailed topographical survey, statutory service enquiries and confirmation of the legal boundaries.

The controlled version of this drawing should be viewed in DWG or PDF format not DWG or other formats. All prints of this drawing must be made in full colour.

Where this drawing has been based upon Ordnance Survey data, it has been reproduced under the terms of Ryder Licence No. 100000144. Reproduction of this drawing in whole or in part is prohibited without the prior permission of Ordnance Survey.

Do not scale the drawing. Use figured dimensions in all cases. Check all dimensions on site. Report any discrepancies in writing to Ryder before proceeding.

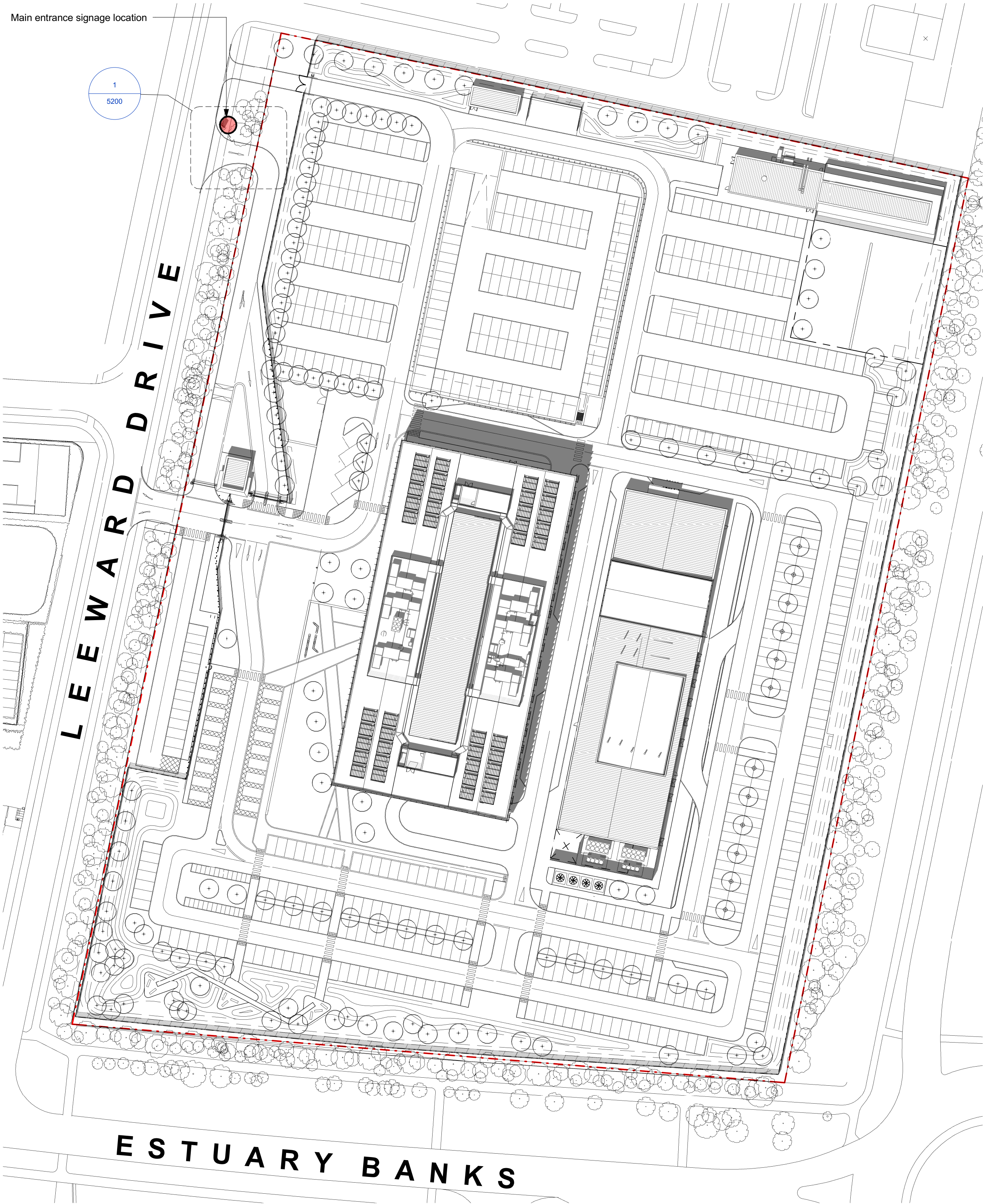
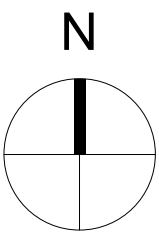

Signage Location - Site Plan
1 : 750

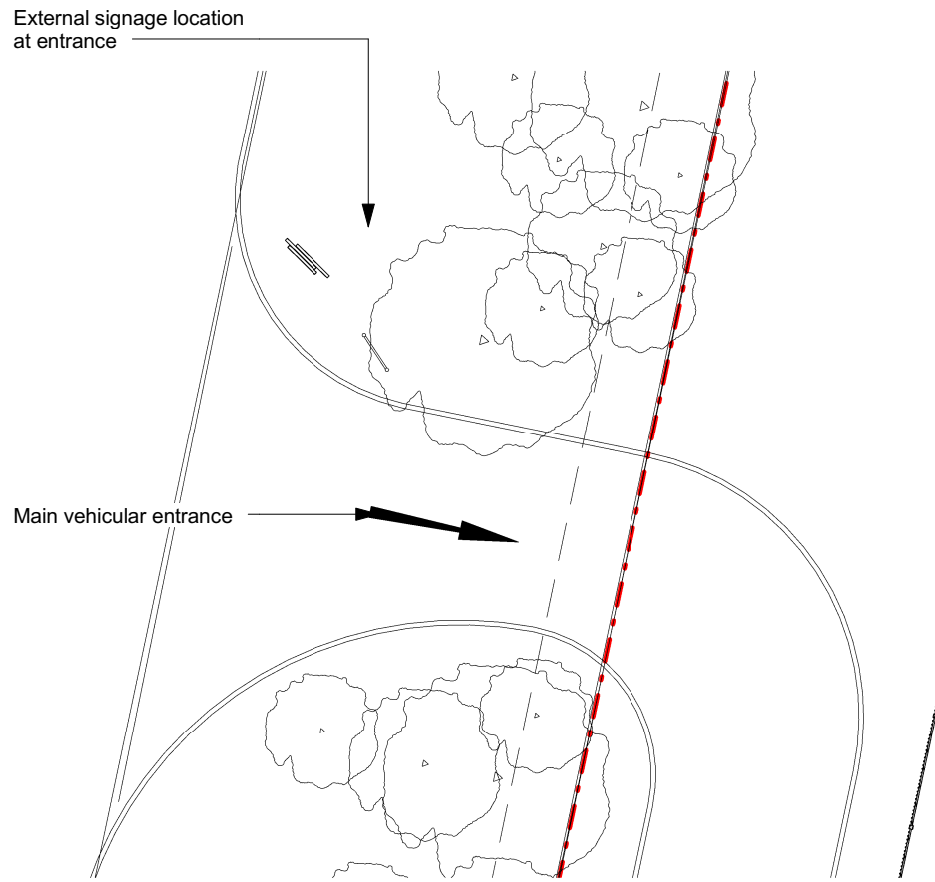

Signage Location - Site Entrance
1 : 200

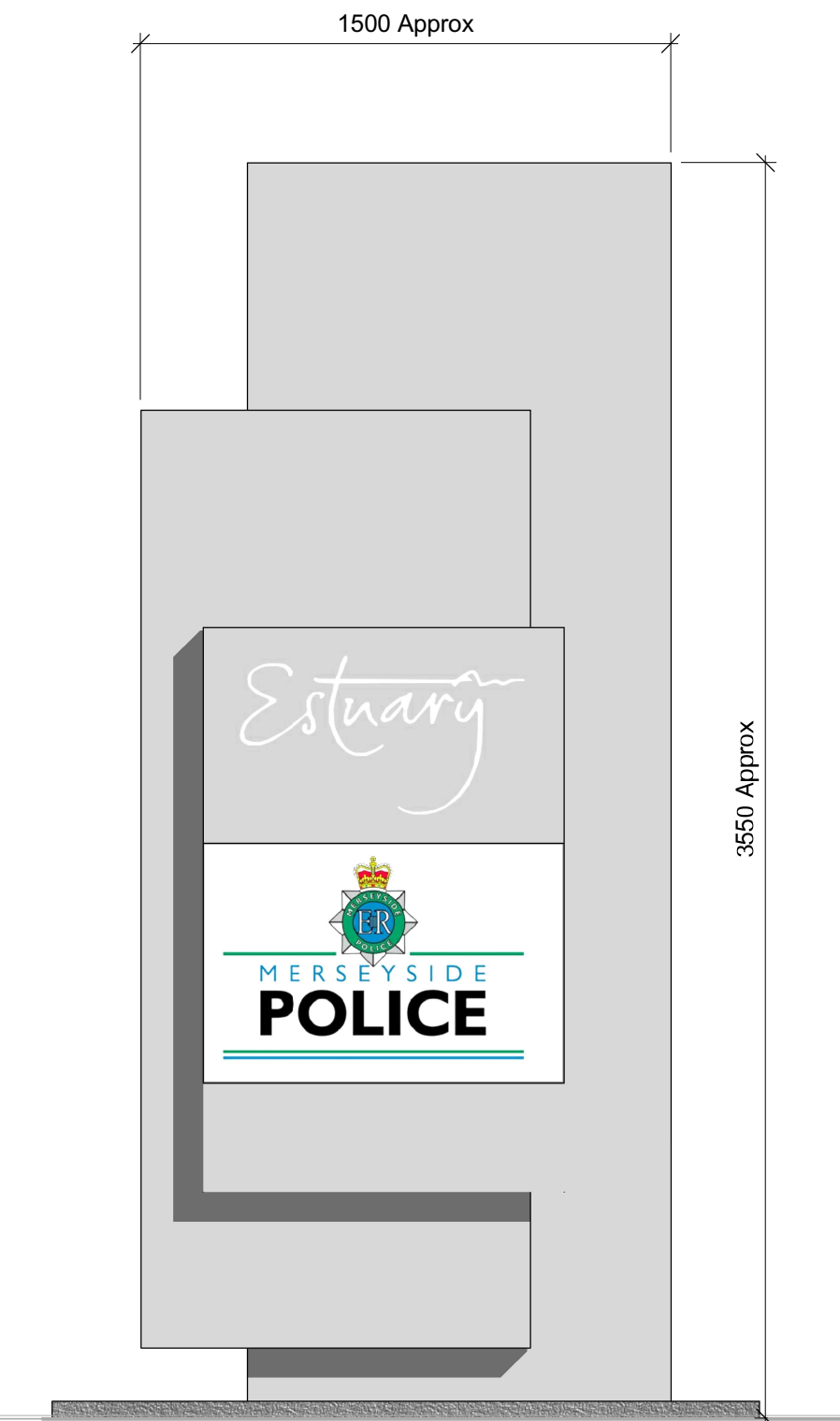

Signage Elevation
1 : 20



Existing totem signage at Estuary banks business park. Proposed signage to match. Exact dimensions to be confirmed with signage provider.

Revision	Date	Drawn by	Checked by
P1.0	15/07/2015	AYo	JSe

First issue
Issued for planning

Amendment

Purpose of issue

Information

Project

Police and Crime Commissioner for Merseyside

OCC

Drawing

Signage Information

Drawing No.

Project ID

OCC

Ryder Project No.

2789-00

As indicated

AYo

S2

P1.0

Revision

Status

Drawn By

Scale at A1

Zone

Level

Type

Role

Number

AYo

ZZ - DR - A

00 - 00 - ZZ - DR - A

Ryder

info@ryderarchitecture.com

www.ryderarchitecture.com