

3.0 | **Comfort and microclimate**

The scheme design has been assessed in relation to sun-path, view orientation and prevailing wind, to ensure that sheltered, sunny locations are provided at each landscape level and terrace.

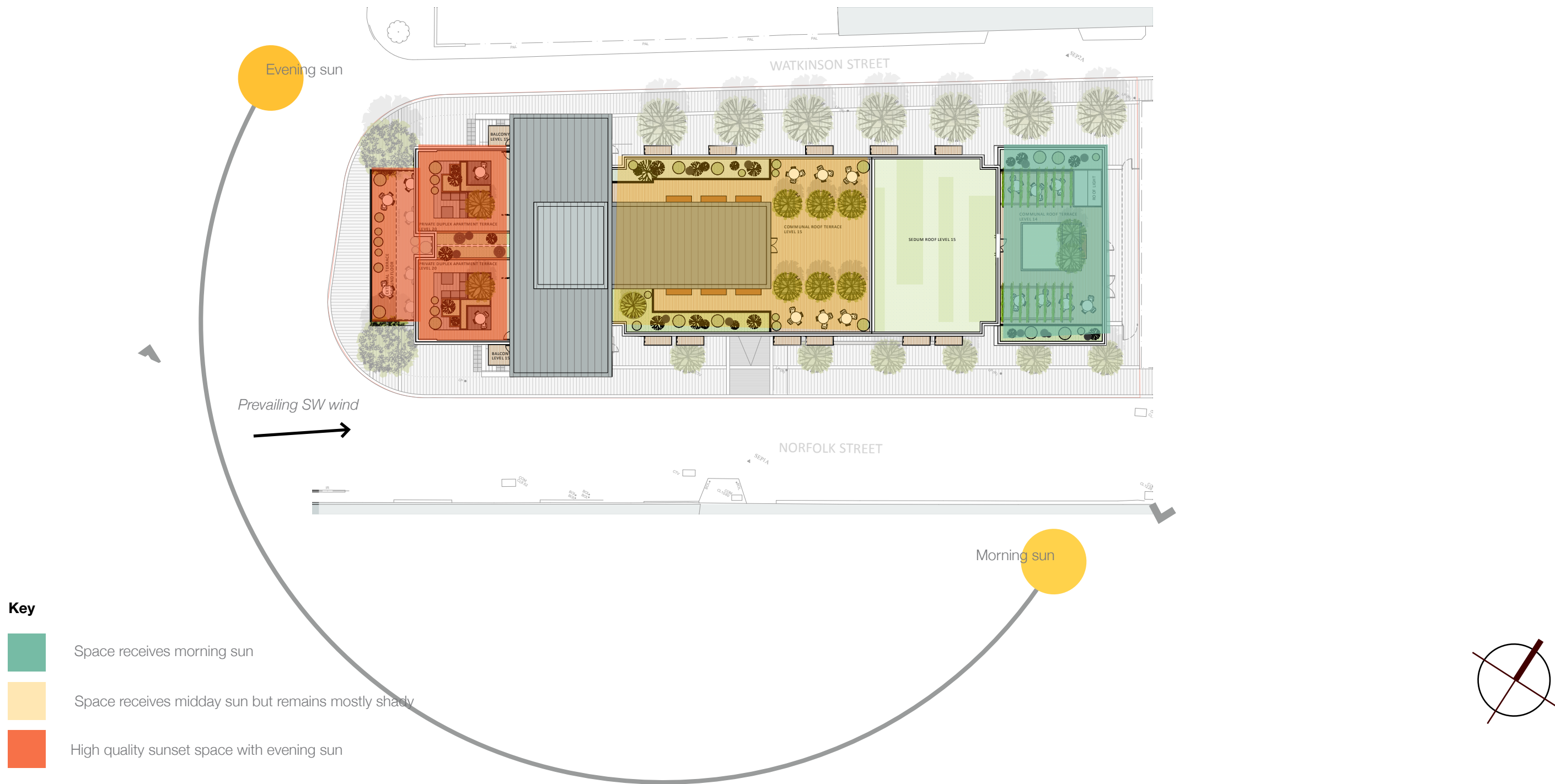

Open space along the west of the development will be thoughtfully designed to optimise the capture of light throughout the day with an emphasis on views to the west where users will benefit from a pleasant atmosphere and attractive space to enjoy the evening sun.

The courtyards will see spaces designed to capture as much light as possible. Lighting will be designed thoughtfully so not to obstruct views over the cityscape; in enclosed areas soft, warm light will create a comfortable and intimate atmosphere.



3.1 Design Analysis | Routes

Key

-  Vehicular Lane 1
-  Vehicular Lane 2
-  Pedestrian Movement

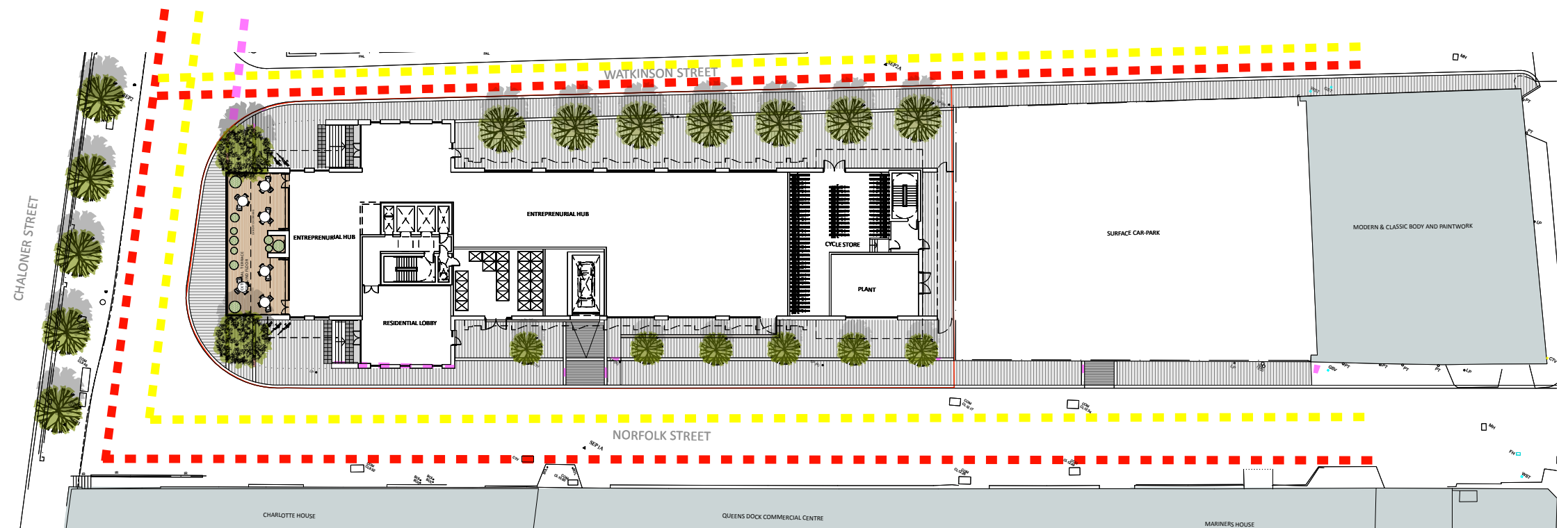

3.2 Design Analysis | Adoption

Key

-  Space for Adoption

