

SINGLE PLY ROOF MEMBRANE COLOUR _____
TO APPROVAL

P.P.C. PRESSED METAL FASCA _____

TIMBER 'PERGOLA' TYPE ENTRANCE FEATURE _____

RENDERED EXTERNAL WALL COLOUR _____
TO APPROVAL

P.P.C. ALUMINIUM FRAMED DOORS /
WINDOWS, COLOUR TO APPROVAL _____

FACING BRICK COLOUR TO APPROVAL _____

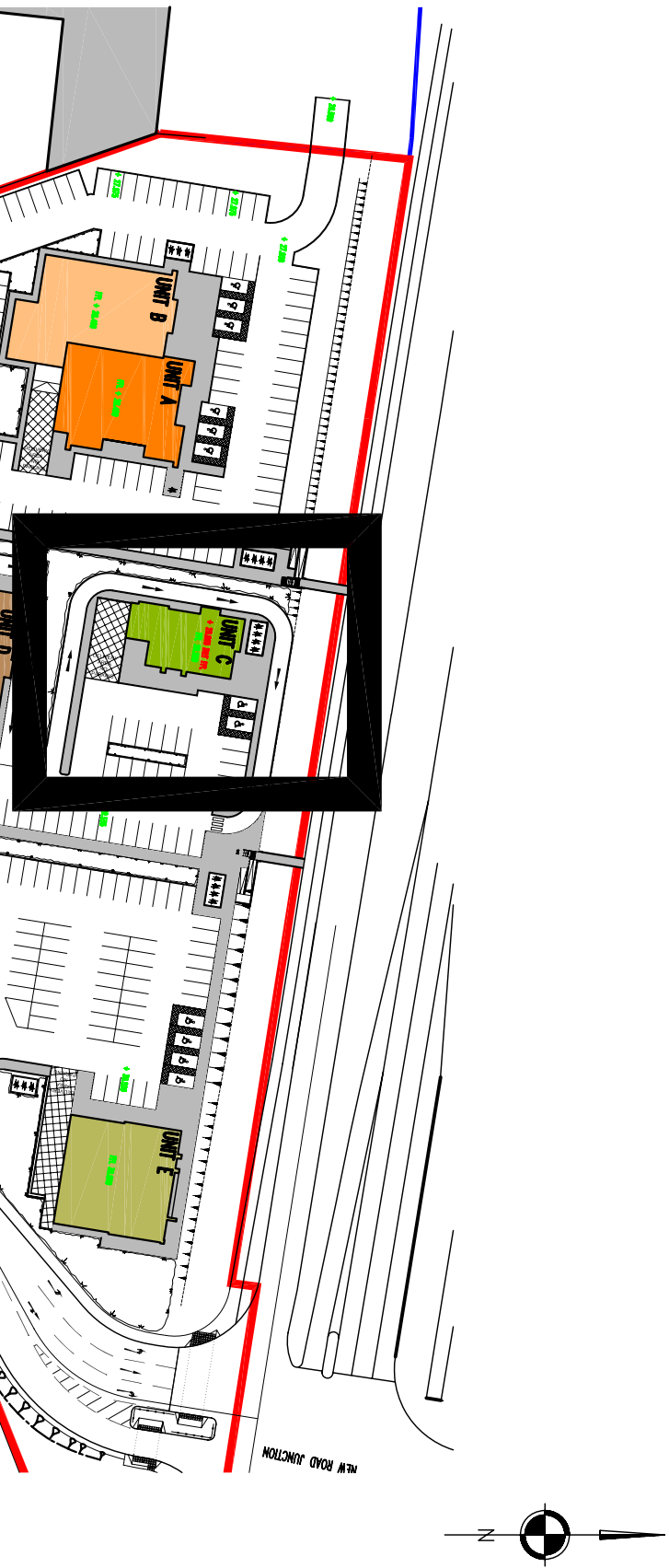

01 Proposed East Elevation

Scale 1:100 @ A2

SINGLE PLY ROOF MEMBRANE COLOUR _____
TO APPROVAL

P.P.C. PRESSED METAL FASCA _____

RENDERED EXTERNAL WALL COLOUR _____
TO APPROVAL

P.P.C. ALUMINIUM FRAMED WINDOWS,
COLOUR TO APPROVAL _____

FACING BRICK COLOUR TO APPROVAL _____

TIMBER CLADDING _____

05 Key Plan

Scale 1:1250 @ A2

02 Proposed West Elevation

Scale 1:100 @ A2

SINGLE PLY ROOF MEMBRANE COLOUR _____
TO APPROVAL

P.P.C. PRESSED METAL FASCA _____

TIMBER 'PERGOLA' TYPE ENTRANCE FEATURE _____

RENDERED EXTERNAL WALL COLOUR _____
TO APPROVAL

P.P.C. ALUMINIUM FRAMED DOORS /
WINDOWS, COLOUR TO APPROVAL _____

FACING BRICK COLOUR TO APPROVAL _____

TIMBER CLADDING _____

SINGLE PLY ROOF MEMBRANE COLOUR _____
TO APPROVAL

P.P.C. PRESSED METAL FASCA _____

TIMBER 'PERGOLA' TYPE ENTRANCE FEATURE _____

P.P.C. ALUMINIUM FRAMED WINDOWS,
COLOUR TO APPROVAL _____

FACING BRICK COLOUR TO APPROVAL _____

03 Proposed North Elevation

Scale 1:100 @ A2

04 Proposed South Elevation

Scale 1:100 @ A2

| | | | | |
|-----|--|----------|----|-----|
| D | DESIGN UPDATED. SITE PLAN AMENDED | 03.03.11 | WP | GB |
| C | RAMP ACCESS FROM S.B. INCLUDED | 16.09.10 | WP | GB |
| B | KEY PLAN AMENDED TO SUIT NEW SITE LEVELS | 10.09.10 | WP | GB |
| A | AMENDED TO SUIT NEW SITE LAYOUT | 18.08.10 | WP | GB |
| Rev | Description | Date | By | Chk |

| | | |
|--------------|--|-----------------------------------|
| Status | Purpose for Issue | |
| Planning | <input checked="" type="checkbox"/> Tender | <input type="checkbox"/> PLANNING |
| Construction | <input type="checkbox"/> As Built | <input type="checkbox"/> |

Client
PEEL DEVELOPMENTS (UK) LTD

Contract
PROPOSED DEVELOPMENT
WINGS
SPEKE, LIVERPOOL

Drawing
PROPOSED ELEVATIONS
DRIVE THRU 1

bateandtaylor

architects

macintosh house

4a cambridge street

manchester m1 5gg

tel: 01 61 236 0999

fax: 01 61 236 0404

mail@bate-taylor.co.uk

www.bate-taylor.co.uk

| | | | |
|-------------|-----------|----------|---------|
| Drawing No. | MH405-209 | Revision | D |
| Scales | 1:100@A2 | Date | JUL '10 |
| Drawn | WP | Checked | GB |

This drawing is the copyright of the Architect and may not be reproduced without licence.
DO NOT scale from this drawing.