

NOTE: PLEASE REFER TO LANDSCAPE ARCHITECT PROPOSAL FOR EXACT LOCATION OF PROPOSED TREES AND LANDSCAPE FEATURES.

SCHEDULE OF ACCOMMODATION

| | |
|-------------|--------------------------|
| <div></div> | UNIT A & B - DINER 1 & 2 |
| 825 SQM | 8877 SQ FT |
| <div></div> | UNIT C - DRIVE - THRU 1 |
| 208 SQM | 2238 SQ FT |
| <div></div> | UNIT D - DRIVE - THRU 2 |
| 297 SQM | 3196 SQM |
| <div></div> | UNIT E - PUBIC HOUSE |
| 405 SQM | 4358 SQ FT |

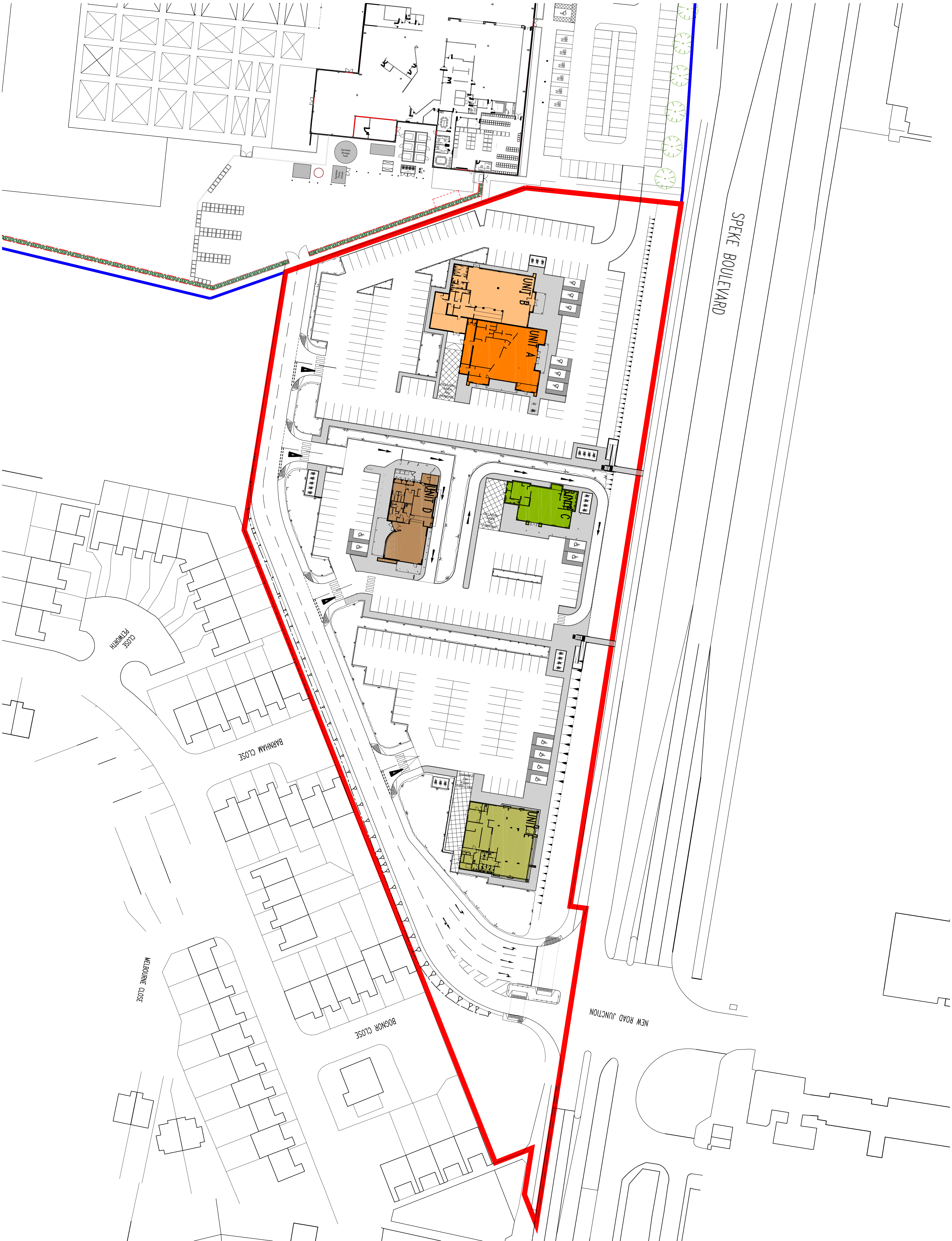

| | | | | |
|---|---|----------|----|----|
| J | BUILDING LAYOUTS, PARKING & ACCESS ROAD | 03.03.11 | PR | GB |
| I | UPDATED DOBBIE'S SITE UPDATED SCHEDULE OF ACCOMMODATION REVISED TO SUIT | | | |
| H | LAYOUT AMENDED TO SUIT BACKLOG | 21.09.10 | WP | GB |
| G | RAISED ACCESS LAYOUT AMENDED | 20.09.10 | WP | GB |
| F | RAISED ACCESS FROM S.E. INCLUDED | 16.09.10 | WP | GB |
| E | ACCESS FOOTPATH AMENDED | 15.09.10 | WP | GB |
| D | TREES REMOVED FROM PLAN | 13.09.10 | WP | GB |
| C | PLAN AMENDED TO SUIT NEW SITE DETAILS | 10.09.10 | WP | GB |
| B | PLAN AMENDED TO SUIT NEW LAYOUT | 18.08.10 | WP | GB |
| A | DRIVE THRU 1 FLOOR AREA AMENDED | 26.07.10 | WP | GB |

| Status | | Purpose for Issue | Date | By |
|--------------|--|-----------------------------------|------|----|
| Planning | <input checked="" type="checkbox"/> Tender | | | |
| Construction | <input type="checkbox"/> As Built | <input type="checkbox"/> PLANNING | | |

Client
PEEL DEVELOPMENTS (UK) LTD

Contract
PROPOSED DEVELOPMENT
WINGS
SPEKE, LIVERPOOL

Drawing
PROPOSED SITE LAYOUT PLAN

bateandtaylor
architects

macintosh house
40 cambridge street
manchester m1 5gg
tel: 0161 236 0999
fax: 0161 236 0404
moll@bate-taylor.co.uk
www.bate-taylor.co.uk