

NOTES

- All dimensions and levels are to be checked on site.
- Any discrepancies are to be reported to the architect before any work commences.
- The drawings are to be read in conjunction with the specification and the contract documents.
- Work to be carried out in accordance with the relevant British Standards.
- This drawing shall not be reproduced without express written permission from AEW.
- The existing drawings and ownership boundaries are provided for information only. AEW does not accept any liability for errors or omissions in the drawings or the information supplied to them.

DESIGN HAZARD IDENTIFICATION

- No significant hazards have been identified in this drawing

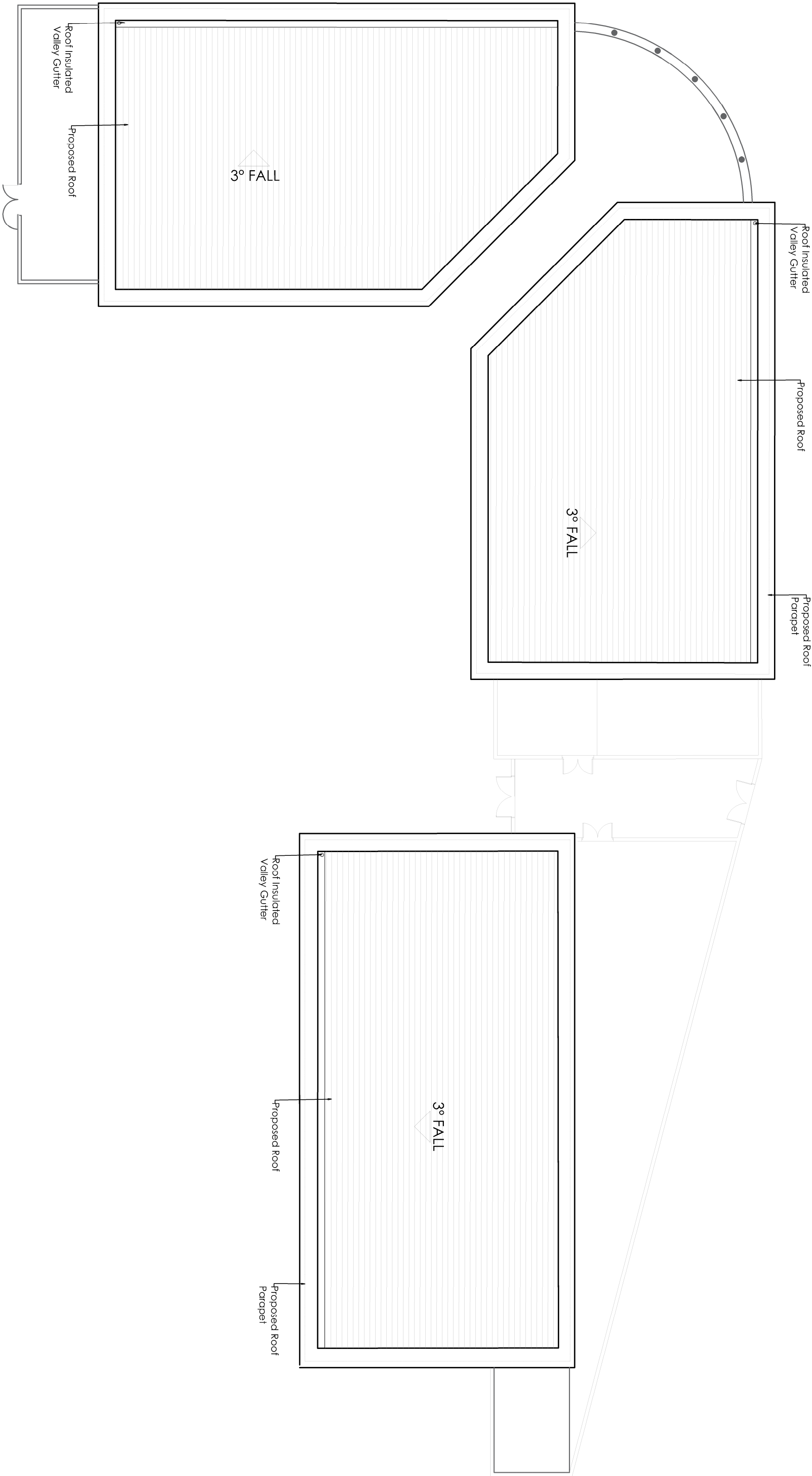
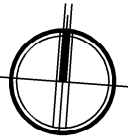
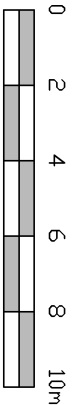

Units 2, 4, 6, 8,10 - Proposed Roof Plan
Scale 1:200

P4	10/02/2017	RK	RH
Updated to model toilet layout			
P3	01/12/2016	TS	RH
Updated Unit Number			
P2	06/11/2016	TS	RH
Updated for new plan			
P1	05/09/2016	TS	RH
Initial issue			
REV	Date	Drawn by:-	Checked by:-

Status For information

drawing stage	Preliminary
client	Derwent Estates

project	Liverpool Shopping Park Extension Units 2, 4, 6, 8, 10
drawing title	Proposed Roof Plan

date	05/09/2016	drawn	TS
scale	1:200	checked	RH