

4.7 Vehicle access

The diagram below shows the routes accessible to vehicles

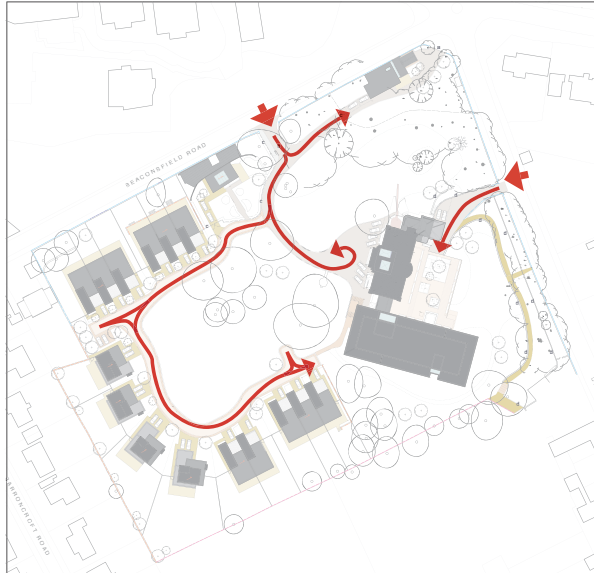

4.8 Refuse storage & collection

Refuse storage points are located throughout the estate. Access for refuse collection vehicles is from Beaconsfield Road is shown on the diagram below

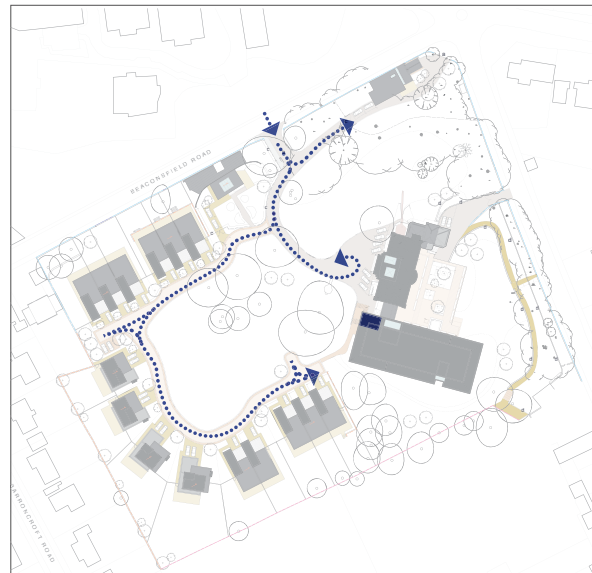

4.9 Parking

Parking for cars is provided in the following locations :

- 73 in underground car park (A)
- 4 in bespoke houses (B)
- 2 at NE corner of House (C)
- 22 in attached villas (D)
- 16 in detached villas (E)
- 9 Visitor spaces (V)
- 126 TOTAL



5.0 Proposed Tree Planting

The Knolle Park estate has a significant complement of mature trees which provide a perimeter screen, and additional groups and individual specimens which, together, contribute to the setting of the house, its wider landscape and the surrounding streetscape.

The trees are subject to a blanket tree preservation order; the trees were surveyed in summer 2015, (see Arborists report) and the size, condition and extent of Root Protection Areas were assessed. This information was used through the design process to assess and minimise impacts on existing trees.

As a result of construction as well as removal of dead or diseased trees, 15 trees are to be felled on site. See drawing LP458-003

| TREE REMOVALS | | | | |
|---------------|---|-------|--|-------------------------|
| Ref | Species | Value | Notes | Reason for removal |
| T3 | Sycamore | U | Limited long term prospects, low vitality, declining, leaning south, dieback in crown, low butt leaf density, major deadwood in crown, crown distorted due to group pressure | Arbor survey/ condition |
| T13 | Horse Chestnut | B1 | Tree located within hard surface area, major back-sweeping on stem, low branches over road/ footpath, branches touching highway light, cavity present in old pruning wound | To facilitate proposal |
| T19 | Sycamore | U | Dieback in crown, low butt leaf density, unbalanced crown shape, crown distorted due to group pressure, in heavily decline suspect rot/diseases present | Arbor survey/ condition |
| T101 | Taxus baccata | - | | To facilitate proposal |
| G9 (1) | Sycamore | B1 | Tree located in hard surface area, epicormics on stem, crown distorted due to group pressure, low branches over road/ footpath, group of three trees and one specimen, specimen in very poor condition | Arbor survey/ condition |
| G16 (1) | Sycamore | U | Limited long term prospects, low vitality, declining, unable to respond stem due to dry, dieback in crown, low butt leaf density, unbalanced crown shape, crown distorted due to group pressure, poor annual extension | Arbor survey/ condition |
| G16 (2) | Sycamore | U | | Arbor survey/ condition |
| G16 (3) | Sycamore | U | | Arbor survey/ condition |
| G16 (4) | Sycamore | U | | Arbor survey/ condition |
| W25 (1) | Holly/ Field Maple/ Sweet Chestnut/ Beech | B3 | Area of woodland dominated by tall beech and lime, understory of laurel and holly, large collapsed dead horse-chestnut within, many stems require tree safety works adjacent to road | To facilitate proposal |
| W25 (2) | Holly/ Field Maple/ Sweet Chestnut/ Beech | B3 | | To facilitate proposal |
| W25 (3) | Holly/ Field Maple/ Sweet Chestnut/ Beech | B3 | | To facilitate proposal |
| W25 (4) | Holly/ Field Maple/ Sweet Chestnut/ Beech | B3 | | To facilitate proposal |
| W25 (5) | Holly/ Field Maple/ Sweet Chestnut/ Beech | B3 | | To facilitate proposal |
| W25 (6) | Holly/ Field Maple/ Sweet Chestnut/ Beech | B3 | | Arbor survey/ condition |

The Landscape Proposals include replacement tree planting at a ratio of 2 replacements for each tree removed. The species include small - medium trees (Apple, Pear and Holly) as well as medium - large trees (Field Maple, Oak, Chestnut and Beech).

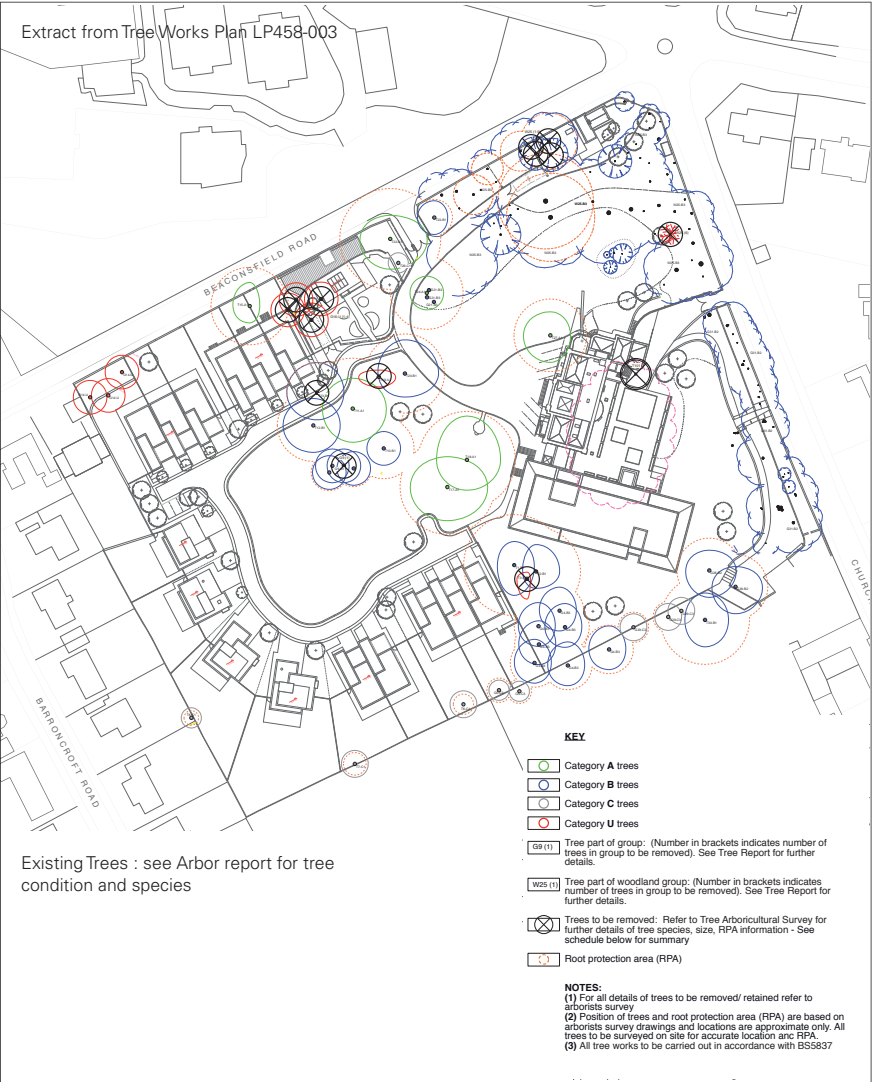

Proposed replacement Tree Species



Field Maple (*Acer campestre*)



Pear (*Pyrus communis*)



Turkey Oak (*Quercus cerris*)



Chestnut (*Castanea sativa*)



Beech (*Fagus sylvatica*)



Holly (*Ilex aquifolium*)

Tree Planting (extract from Drawing LP458-003)

**KEY****Soft landscape**

- 1. Gatehouse/ lodge garden:** Existing formal landscape arrangement to be retained and renovated. New planting to formal beds to include mix of shrubs and perennials.
- 2. Woodland understory: Understorey** groundcover to be enhanced with native and ornamental woodland groundcover planting: Primula, Bluebell, Red Campion, Ramsons, Campanula etc.
- 3. Formal lawn:** Mown lawn as existing grassland species.
- 4. Meadow:** Informal meadow area retained and species mix to be enhanced with mix of native and ornamental seasonal bulbs and flowering meadow species. Informal paths and spaces to be created through mowing.
- 5. Orangery garden:** Existing formal landscape arrangement (planting beds within lawn and rockery to orangery wall) to be retained and renovated. New planting to include mix of shrubs and perennials. Lawn to be relaid. Garden to be enclosed by low clipped formal hedge to frontage and taller hedge to enclose private rear gardens.
- 6. Private front gardens:** Low to medium height shrub planting; Hebe, Rosa, Lavandula, Philomis, Viburnum davidii, etc with mix of herbaceous planting including; Achilles, Tanacetum, Geum, Iris, Verbena, Allium, Sedum, Rudbeckia etc.
- 7. Private back gardens:** Domestic scale lawn areas and shrub/perennial planting beds within.
- 8. Private roof terrace:** Formal garden to roof terrace. Formal arrangement of clipped Box (Buxus) and Hornbeam (Carpinus) hedging and trees with lawn and herbaceous planting. Planting within upstand planting beds and planters to roof deck structure.
- 9. Existing boundary planting:** Existing boundary understory planting retained and enhanced with native and ornamental woodland groundcover planting.
- 10. Grotto / Fernery:** Grotto / fernery structure to be retained and renovated. Existing fern plants to be retained and supplemented with additional plants.

Trees:

Existing tree retained (refer to drawing LP458.412 for tree management and protection proposals)

Existing tree removed (refer to drawing LP458.410 for tree removals)

Proposed trees: (refer to drawing LP458.411 for tree mitigation proposals)

PT01: Acer campestre / 20-25cm

PT02: Acer japonica / 20-25cm

PT03: Castanea sativa / 20-25cm

PT04: Fagus sylvatica / 30-35cm

PT05: Ilex aquifolium / 20-25cm

PT06: Malus / 20-25cm

PT07: Prunus avium / 20-25cm

PT08: Prunus padus / 20-25cm

PT09: Quercus cerris / 30-35cm

PT10: Taxus baccata / 2m height

NOTES:

- (1) For all details of trees to be removed/ retained refer to arborists survey
- (2) Position of trees and root protection area (RPA) are based on arborists survey drawings and locations are approximate only. All trees to be surveyed on site for accurate location and RPA.
- (3) All tree works to be carried out in accordance with BS5837

6.0 Landscape management

The Knolle Park site landscape will be managed and maintained as follows:

- Common areas, communal landscapes, driveways, perimeter walls, gates and railings and lighting will be the maintainance and management responsibility of a private management company.
- Private gardens and boundaries will be the maintainance and management responsibility of private house owners.



Area to be maintained by Management company



Area to be maintained by private householder





- KEY**
1. Gatehouse/ Greek lodge
 2. Existing entrance drive
 3. New entrance drive
 4. Entrance woodland landscape
 5. Orangery
 6. Private garden
 7. Meadow
 8. Private roof deck
 9. Existing garden features to Church Road frontage
 10. Ridge woodland
 11. Grotto
 12. Fernery
 13. Knolle house
 14. Substation
 15. Site entrance

© All information contained within this document remains copyright of Landscape Projects Ltd. and shall not be reproduced without prior consent.

(1) Do not scale from drawings - use written dimensions only. (2) All dimensions are in millimetres unless noted. (3) All dimensions shall be verified on site before proceeding with the work. (4) Landscape Projects shall be notified of any discrepancies. (5) Engineer to specify all sub-bases. Any below ground construction is indicated.

| Landscapeprojects | | | | Project Title | | | | Drawing Title | | | |
|---|--|--|--|---------------------------------------|--|--|--|--------------------------|--|--|--|
| Landscape Architecture & Design | | | | St Gabriels Knolle Park, Liverpool | | | | Landscape proposals | | | |
| S1 Blackfrere Road Salford Manchester M5 7AN PHONE 0161 439 8336 FAX 0161 439 7155 EMAIL info@landscapeprojects.co.uk | | | | Drawn Date 2015-06-29 | | | | Drawn SB | | | |
| | | | | Scale 1:500 @ A1 / 1:1000 @ A3 | | | | Checked NCS | | | |
| | | | | | | | | Status For Planning | | | |
| | | | | | | | | Drawing No. 458 . 001 | | | |
| | | | | | | | | Revision B | | | |

Landscape Architecture & Design

l a n d s c a p e p r o j e c t s

31 Blackfriars Road Salford Manchester M3 7AQ
PHONE: 0161 839 8336 FAX: 0161 839 7155
EMAIL: post@landscapeprojects.co.uk