

60 x 60 x 8 FRP ANGLE (PTA1)

1 No. REQUIRED
APPROX. WEIGHT = 1.1kg
SCALE 1:10

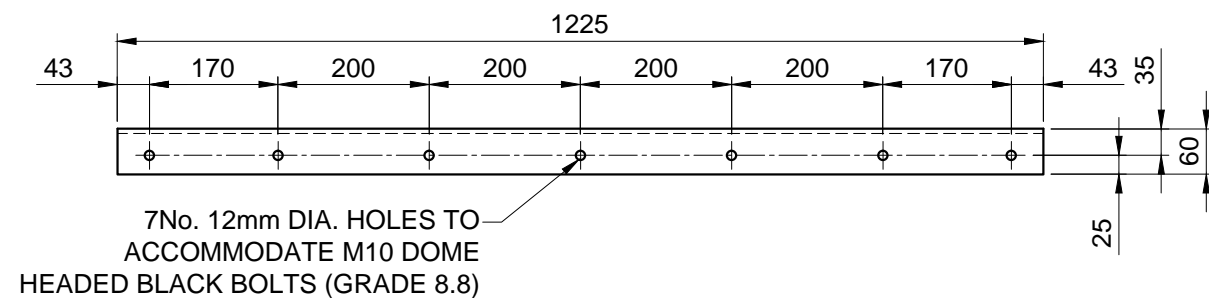

60 x 60 x 8 FRP ANGLE (PTA2)

13 No. REQUIRED
APPROX. WEIGHT = 1.8kg
SCALE 1:10

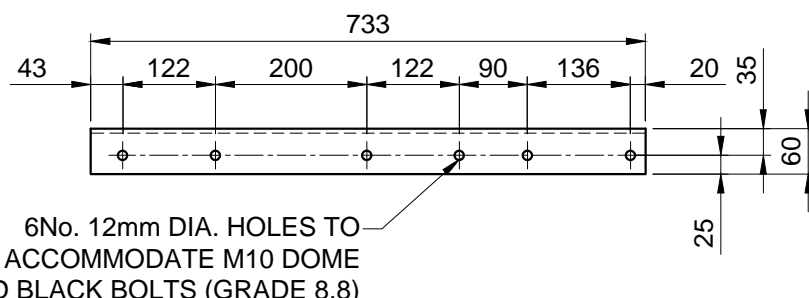

60 x 60 x 8 FRP ANGLE (PTA3)

1 No. THUS & 1 No. HANDED REQUIRED
APPROX. WEIGHT = 1.1kg
SCALE 1:10

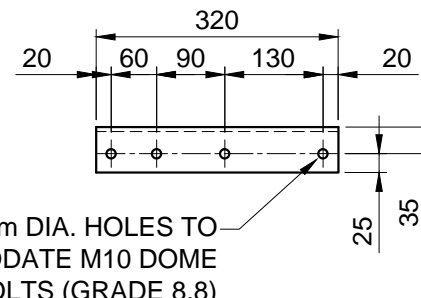

60 x 60 x 8 FRP ANGLE (PTA4)

1 No. THUS & 1 No. HANDED REQUIRED
APPROX. WEIGHT = 0.5kg
SCALE 1:10

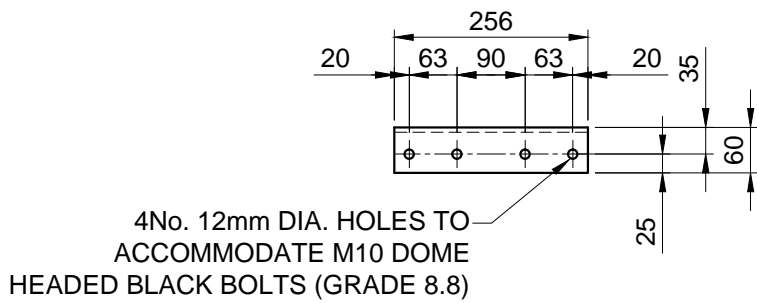

60 x 60 x 8 FRP ANGLE (PTA5)

1 No. REQUIRED
APPROX. WEIGHT = 0.4kg
SCALE 1:10

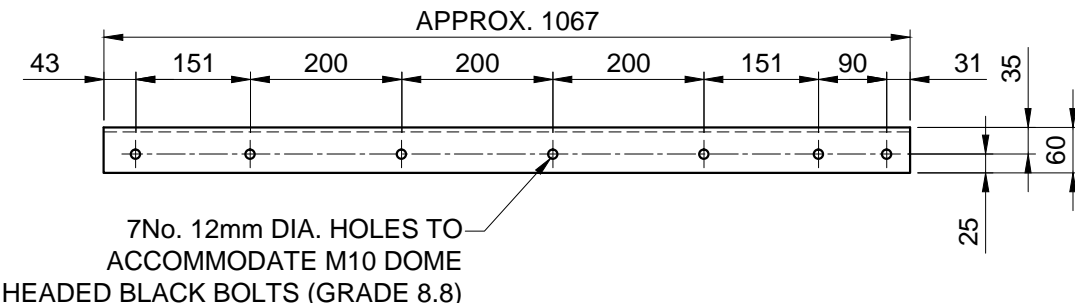

60 x 60 x 8 FRP ANGLE (PTA6)

1 No. REQUIRED
APPROX. WEIGHT = 1.6kg
SCALE 1:10

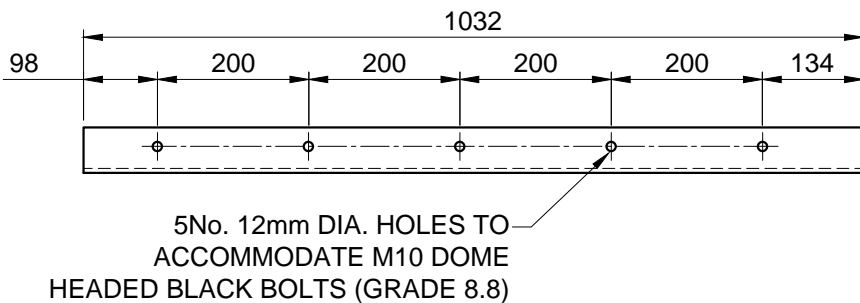

60 x 60 x 8 FRP ANGLE (PBA1)

1 No. REQUIRED
APPROX. WEIGHT = 1.6kg
SCALE 1:10

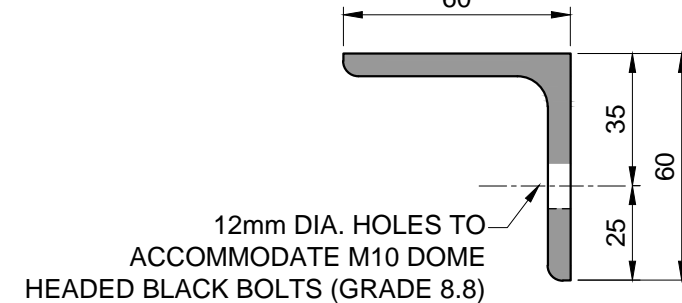

SECTION THROUGH 60 x 60 x 8 FRP ANGLE

SCALE 1:2



ELEVATION SHOWN ON ANGLES PBA1 & PTA1 - PTA6

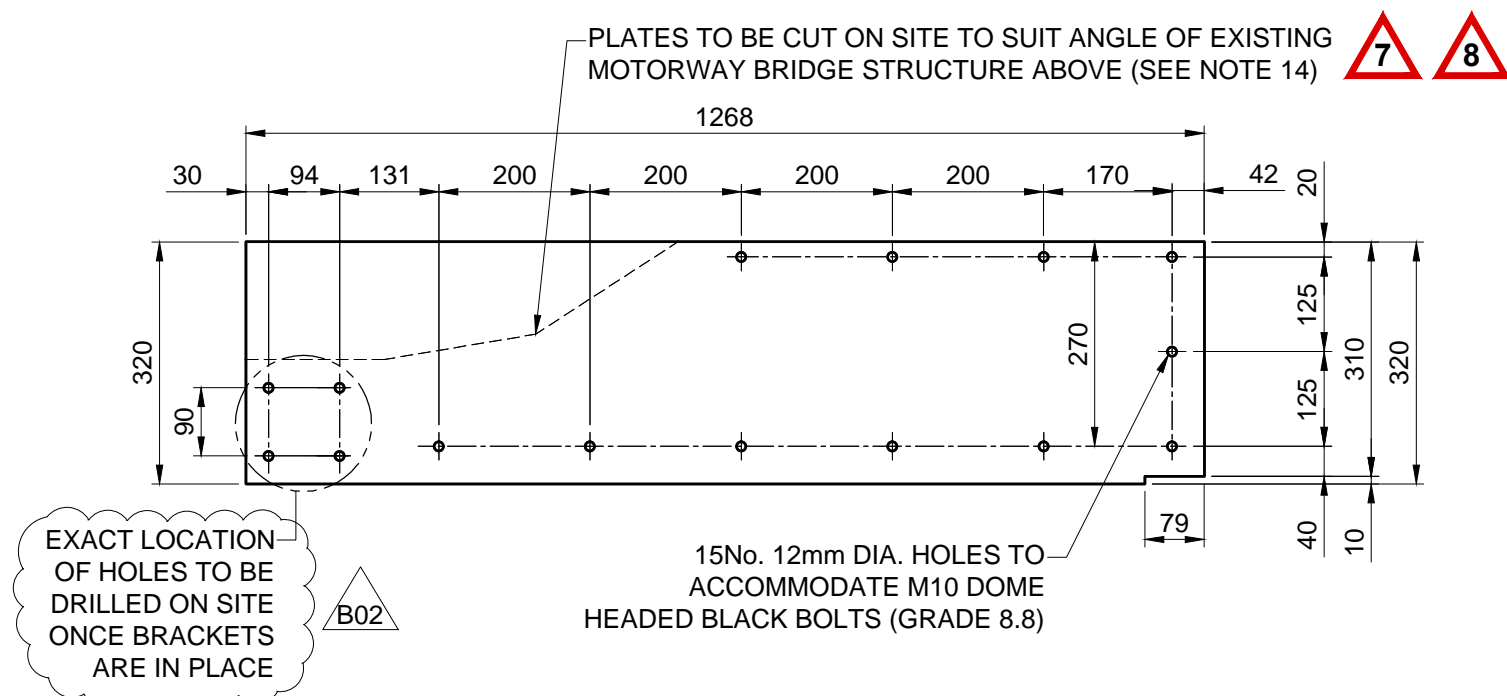

15mm THICK FRP PARAPET PLATE (FRP1)

1 No. REQUIRED
APPROX. WEIGHT = 11.5kg
SCALE 1:10

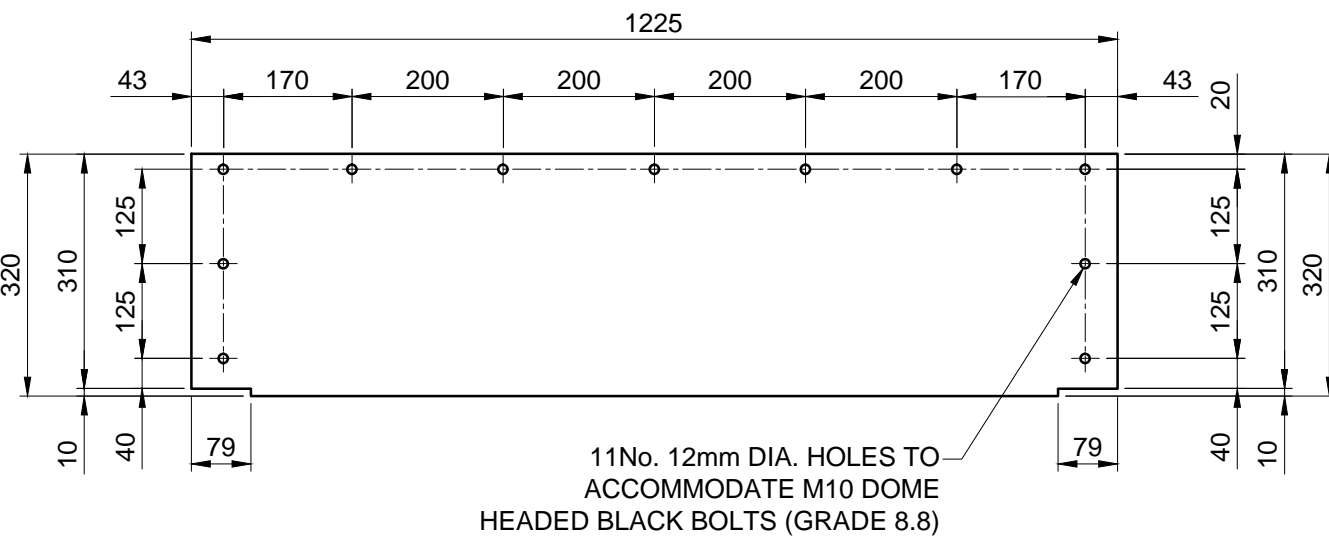

15mm THICK FRP PARAPET PLATE (FRP2)

13 No. REQUIRED
APPROX. WEIGHT = 11.2kg
SCALE 1:10

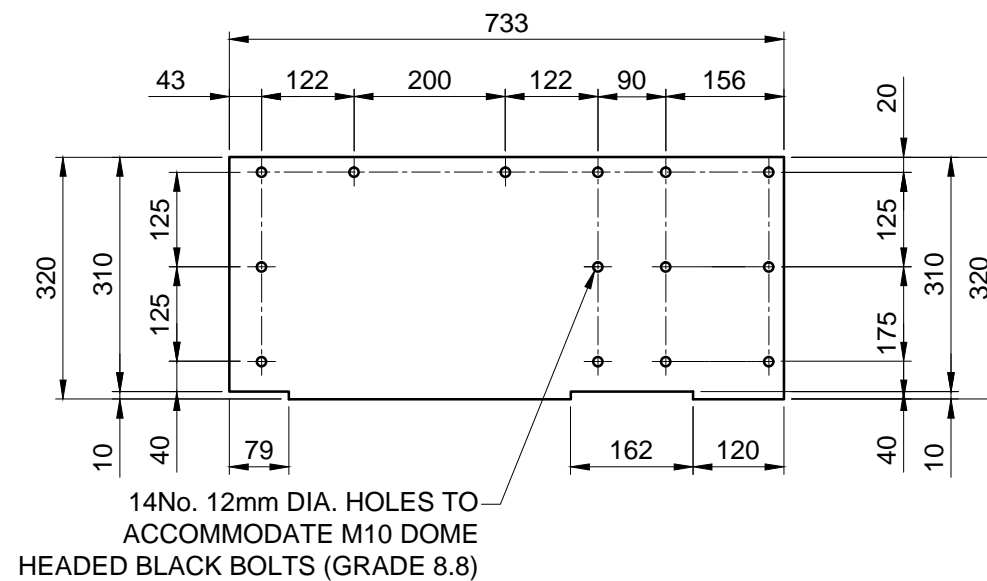

15mm THICK FRP PARAPET PLATE (FRP3)

1 No. THUS & 1 No. HANDED REQUIRED
APPROX. WEIGHT = 6.6kg
SCALE 1:10

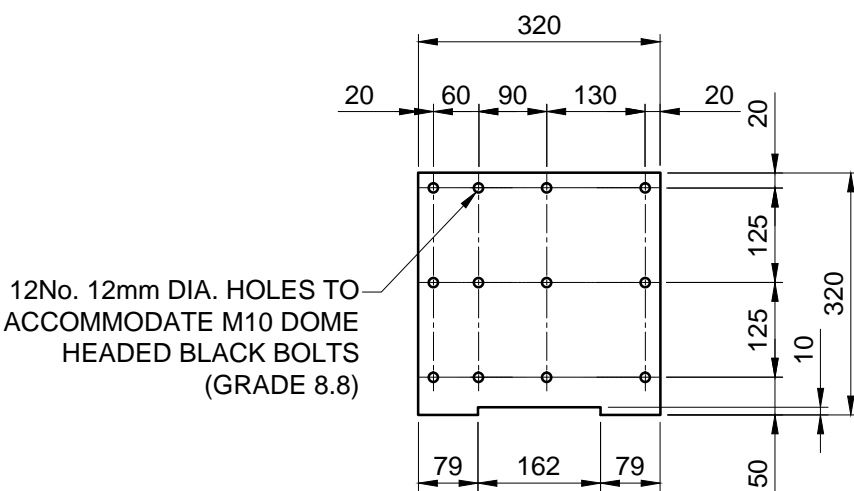

15mm THICK FRP PARAPET PLATE (FRP4)

2 No. REQUIRED
APPROX. WEIGHT = 2.9kg
SCALE 1:10

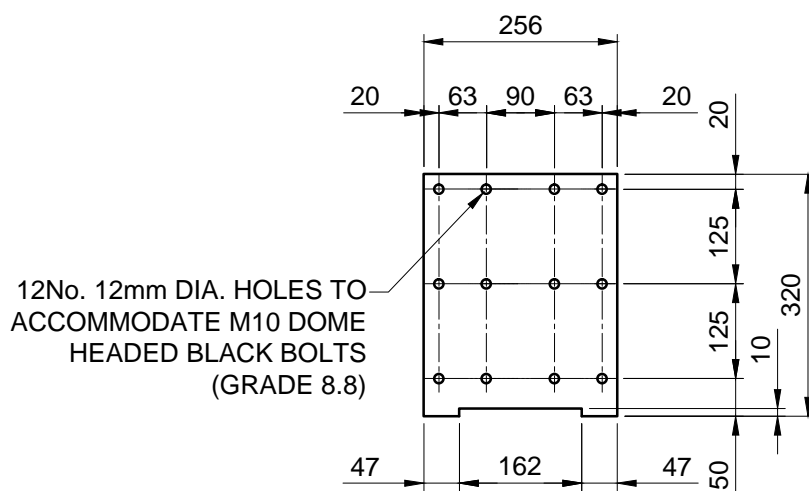

15mm THICK FRP PARAPET PLATE (FRP5)

1 No. REQUIRED
APPROX. WEIGHT = 2.3kg
SCALE 1:10

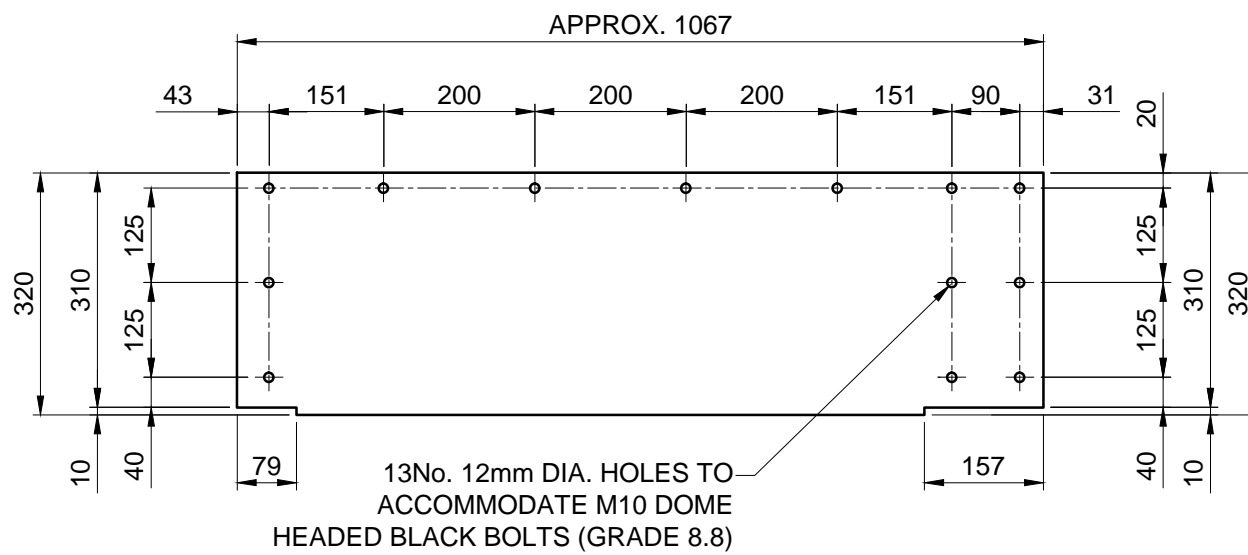

15mm THICK FRP PARAPET PLATE (FRP6)

1 No. REQUIRED
APPROX. WEIGHT = 9.7kg
SCALE 1:10

FOR BRACKETS, ANGLES AND FRP PANEL LOCATIONS REFER TO DRAWING 07

KEY

PBA1 - PARAPET BOTTOM ANGLE
PTA1 - PARAPET TOP ANGLE
FRP1 - FRP SOLID PANEL
TB1 - TEE BRACKET

RESIDUAL RISKS

- INJURY DUE TO WORKING AT HEIGHT.
- INJURY DUE TO WORKING WITH POWER TOOLS.
- INJURY DUE TO MANUAL HANDLING.
- DRILLING THROUGH REINFORCED CONCRETE.
- OLE BELOW STRUCTURE.
- ILLNESS DUE TO CHEMICALS WITHIN PAINT SYSTEMS AND SEALING RESIN.
- EXPOSURE TO FRP FIBRES FROM FIELD CUT EDGES.
- FITMENT OF FRP PLATES AND STEELWORK ELEMENTS.
- DAMAGE TO REINFORCED CONCRETE.

Rev	Date	Description of Revisions	Drawn	Chkd	Appr
B02	06/05/16	SECOND ISSUE	RD	RB	TC
B01	18/12/15	FIRST ISSUE	ET	RB	TC

Status: F003 - DETAILED DESIGN

Designers
Infrastructure Projects
Buildings & Civils
Civils Design Group
Manchester
Square One
4 Travis Street
Manchester
M1 2NY
Tel: 0161 880 3936



LIVERPOOL TO MANCHESTER DSE LINE ELECTRIFICATION WORKS

Drawing Title
DSE/39 QUEENS DRIVE
PROPOSED DETAILS
AREA 2 - CONCRETE PARAPET

Designer	R. TURNER	Signed		Date	18.12.2015
Drawn	E. THOMPSON	Signed		Date	18.12.2015
Checked	R. BRINNERS	Signed		Date	18.12.2015
Approved	T. CHEETHAM	Signed		Date	18.12.2015

Scale(s) at A1 Sheet Size A1 594 x 841 ELR & Mileage
AS SHOWN ELR : DSE 3m 0440yds

Drawing Number
LNW-124384-ECV-DRG-IAB-DSE-39-08

Revision
B02

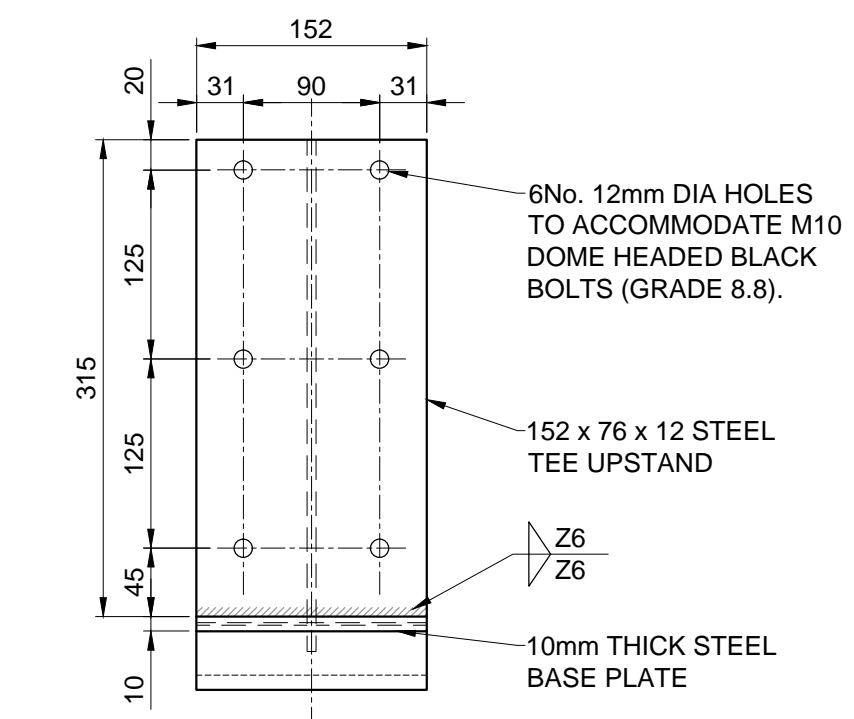

FRONT ELEVATION ON TEE BRACKET (TB1)

21 No. REQUIRED
APPROX. WEIGHT = 5.9kg
SCALE 1:5

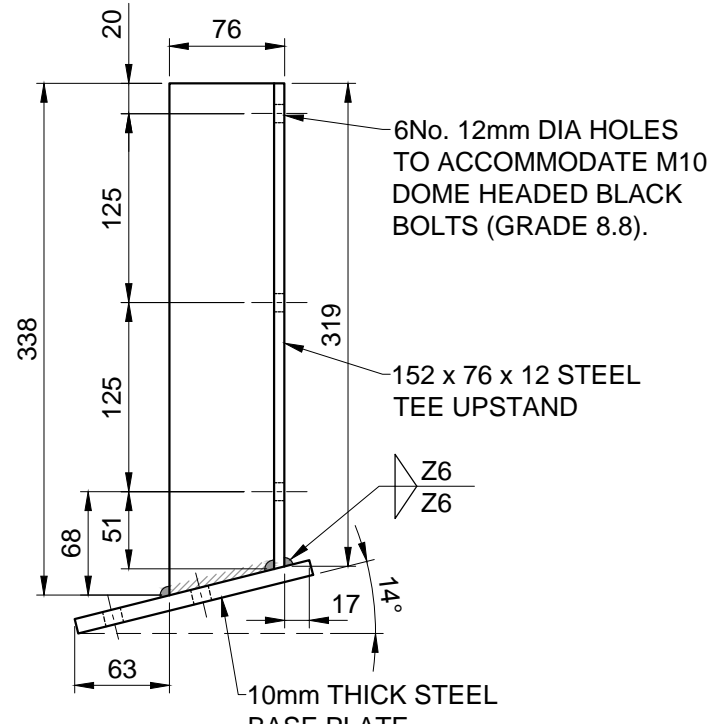

SIDE ELEVATION ON TEE BRACKET (TB1)

SCALE 1:5

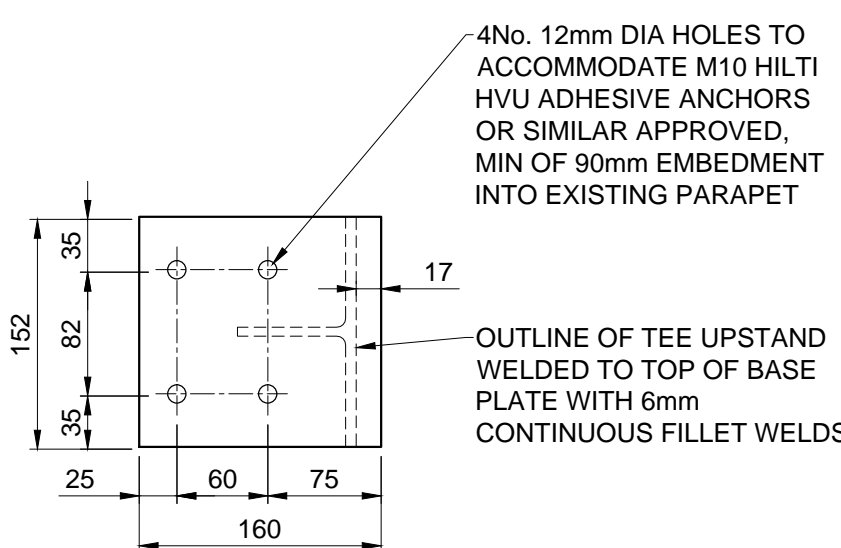

PLAN ON 10mm THICK STEEL BASE PLATE (TYPICAL)

SCALE 1:5

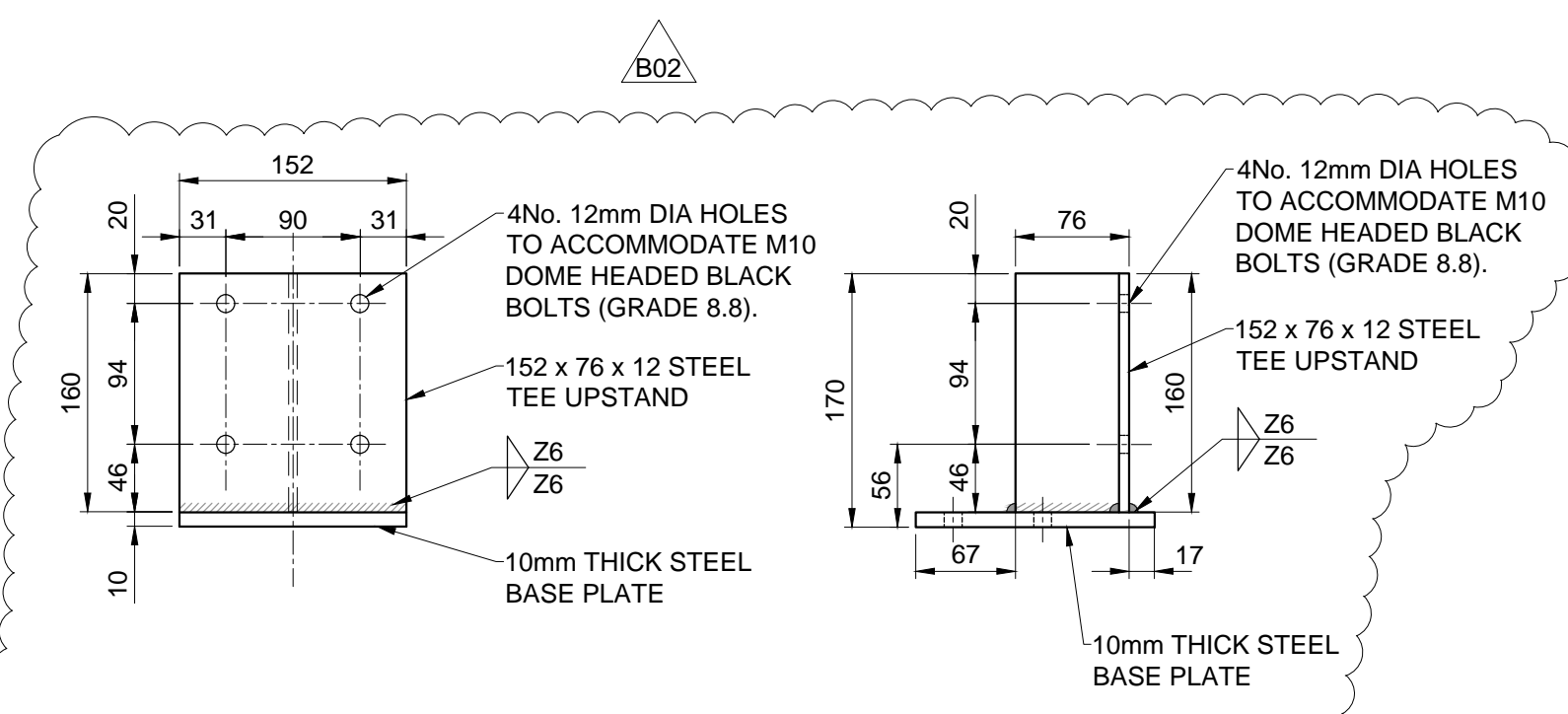

FRONT ELEVATION ON TEE BRACKET (TB2)

1 No. REQUIRED
APPROX. WEIGHT = 5.9kg
SCALE 1:5

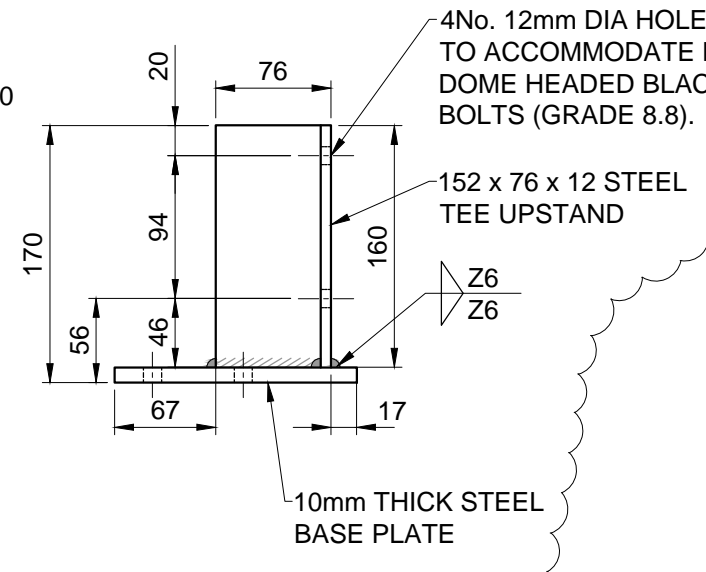

SIDE ELEVATION ON TEE BRACKET (TB2)

SCALE 1:5

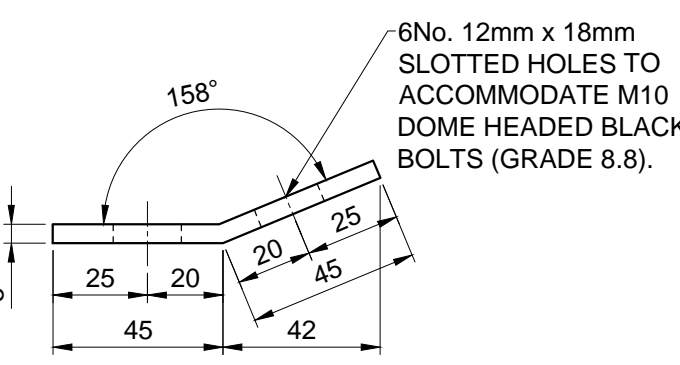

PLAN ON 5mm THICK STEEL REAR COVER PLATE

4 No. REQUIRED
APPROX. WEIGHT = 1.4kg
SCALE 1:2

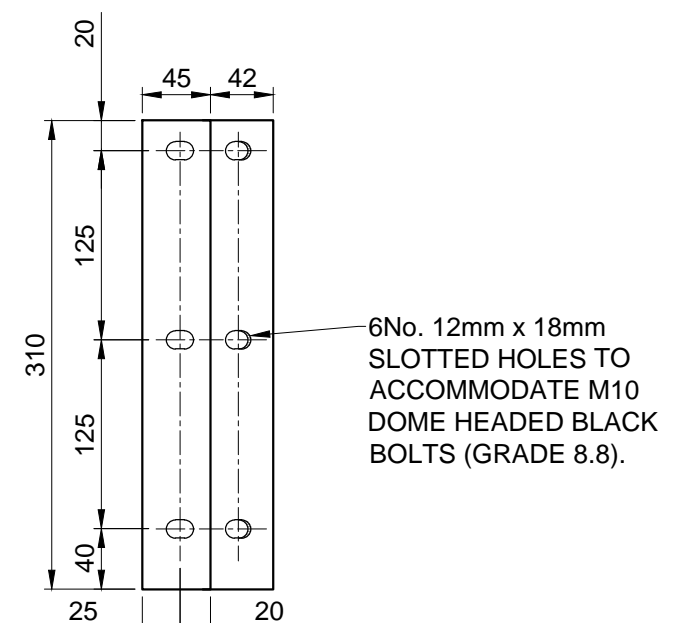

FRONT ELEVATION ON 5mm THICK STEEL REAR COVER PLATE

SCALE 1:5