

Typical Section A - through linkage to Stanley Park
1:10 @ A1

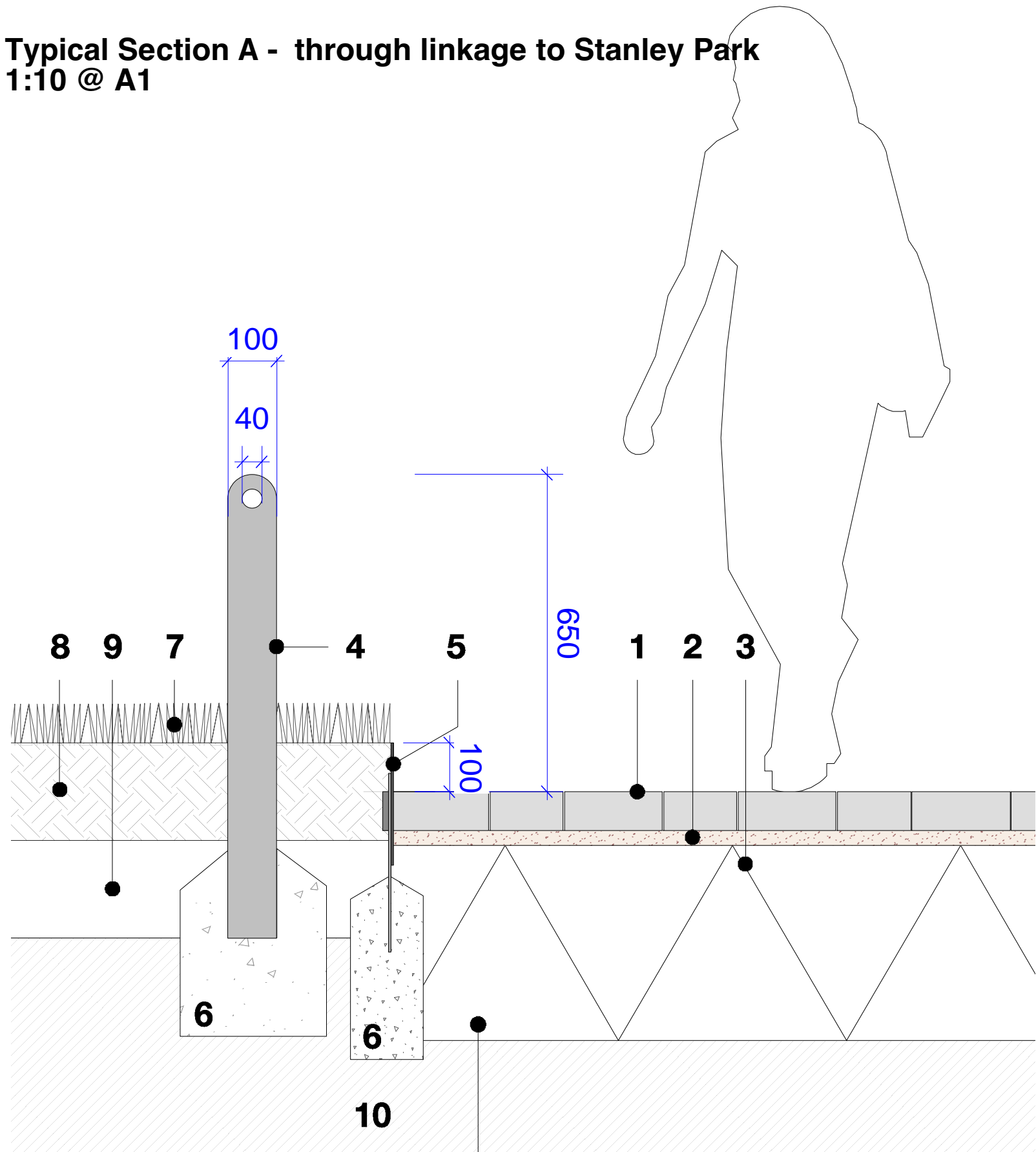

Casting and Specification
to Engineer's Detail

Typical Section B - Elevation through across edge North of Anfield Road
1:10 @ A1

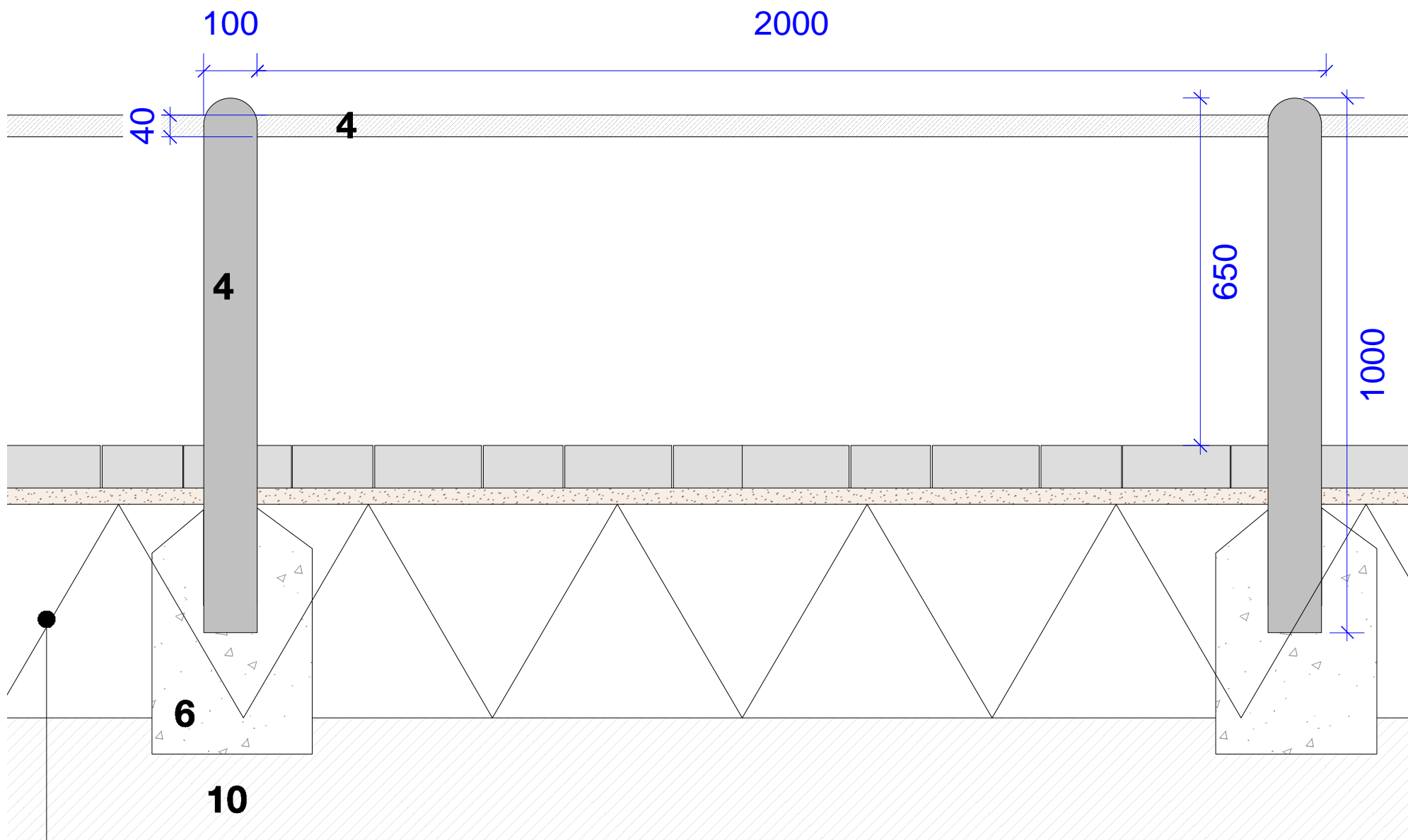

Refer to **PL1312.D.410**
For standaard interface details.

Knee Rail Specification

Quantity:
163 linear metre

Timber Post (supplied):
1000m High 125 x 75mm Inter Post - Rounded Top
(For 41.5mm Galvanised Tube)
- Corner posts and End posts to be used as required.
- Allow 1 post per 2m
- Post height installation above FFL: 650mm
- Planed finish and cured timber.

Top Rail:
6m Galvanized steel rails
41.5mm □D (With Tube Connector)
- Colour coating is an option

Supplier:
Jacksons or other similar approved.
W: Jacksons-fencing.co.uk
T: 0800 408 2234

Refer to Planit IE drawings for location:
PL1312.GA.005
PL1312.GA.007

1. Concrete Block Paving 'Boulevard' (to park link only)
2. Sand bedding layer to engineer's detail
3. DOT type 1 sub-base to engineer's detail
4. Timber post metal rail knee rail (see detailed spec)
5. Galvanised steel edge. 6mm thick. HG6 by Kinley Systems or similar and approved.
Pinned in place to concrete foundation
6. ST4 concrete haunching
7. Turf
8. 200mm depths of approved topsoil to BS3882:2015
9. 300mm depth of approved topsoil to BS8601:2013

Precedent Image



Materials



Section Location Plan

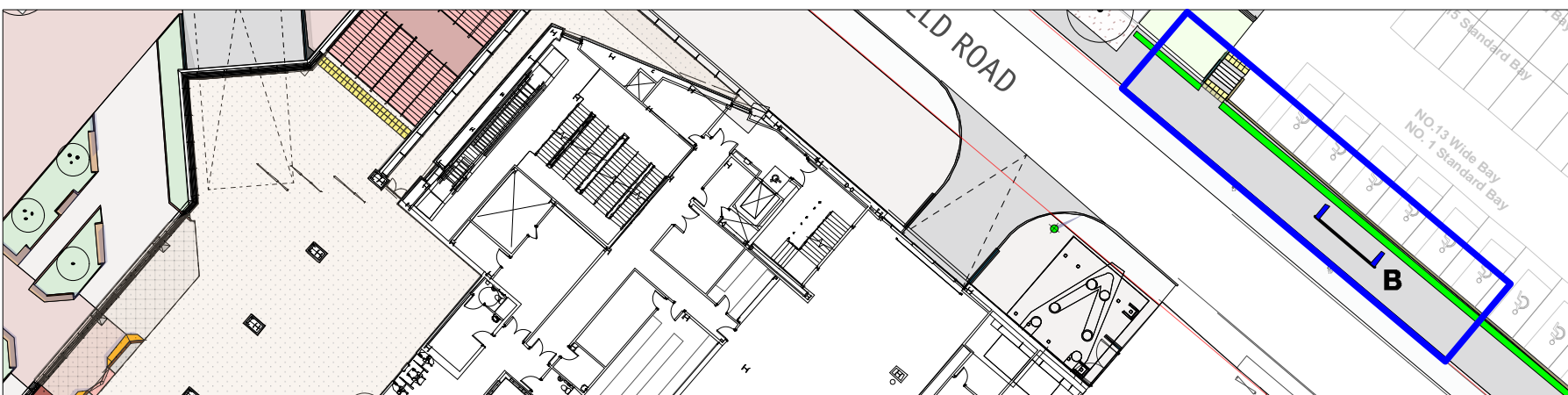
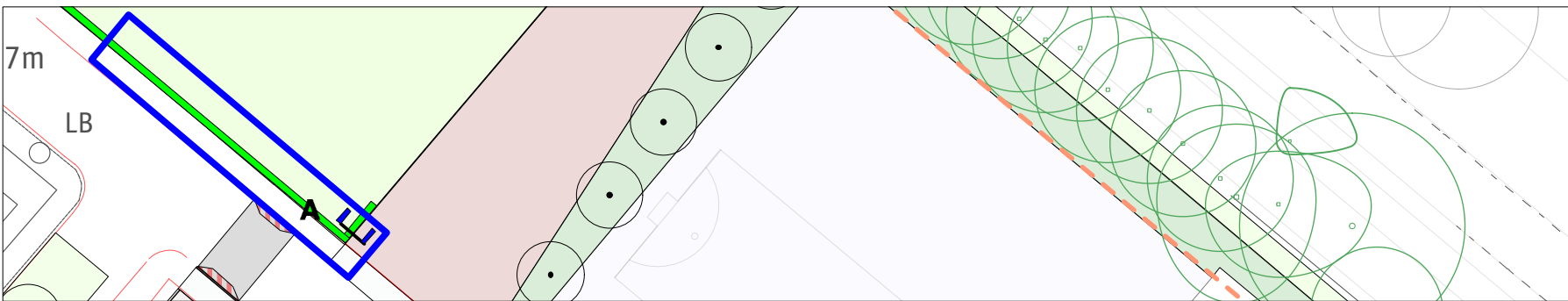

THIS DRAWING IS COPYRIGHT PROTECTED AND MAY NOT BE
REPRODUCED IN WHOLE OR PART WITHOUT WRITTEN
AUTHORITY FROM THE OWNER.

- NOTE:**
1. Do not scale from this drawing.
Always work to noted dimensions.
 2. All dimensions are in millimetres unless otherwise stated.
 3. All setting out, levels and dimensions to be agreed on site.
 4. The dimensions of all materials must be checked on site
before being laid out.
 5. This drawing must be read with the relevant specification
clauses and detail drawings.
 6. Order of construction and setting out to be agreed on site.

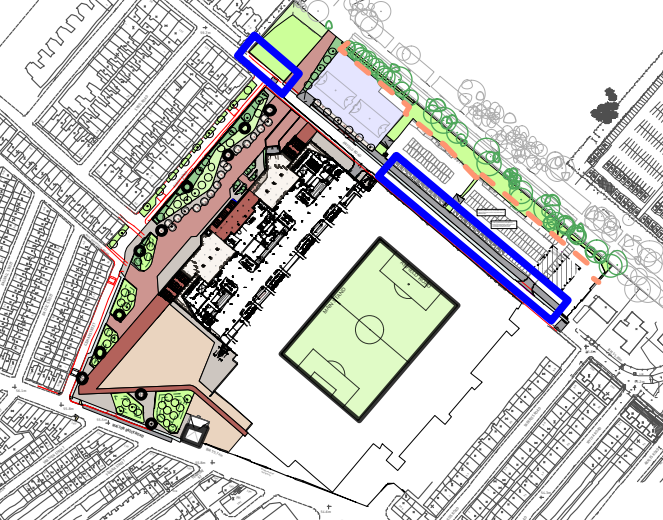

3	23.03.16	Planning Discharge	JT	LH
2	01.02.16	Construction	RM	LH
1	30.04.15	Planning Issue	RM	LH

Issue	Date	Status	Drawn	Apprvd.
-------	------	--------	-------	---------

Planit Intelligent Environments LLP
E: info@planit-ie.com W: planit-ie.com
MANCHESTER 2 Back Grafton St. Altrincham WA14 1DY T: 0161 928 9281
LONDON 18 Bowling Green Lane London EC1R 0BW T: 0207 253 5678

Client Liverpool Football Club

Project New Anfield

Drg Title Knee Rail Detail

Created on 22.01.2016 Created by JT Approved by LH

Scale 1:10 Size A1 Status Construction

Drg No. PL1312.D.409 Issue 00