

Seating Type 3 - SECTION: 1:10@A1
Clad Blockwork to Memorial Gardens - Timber Topped only

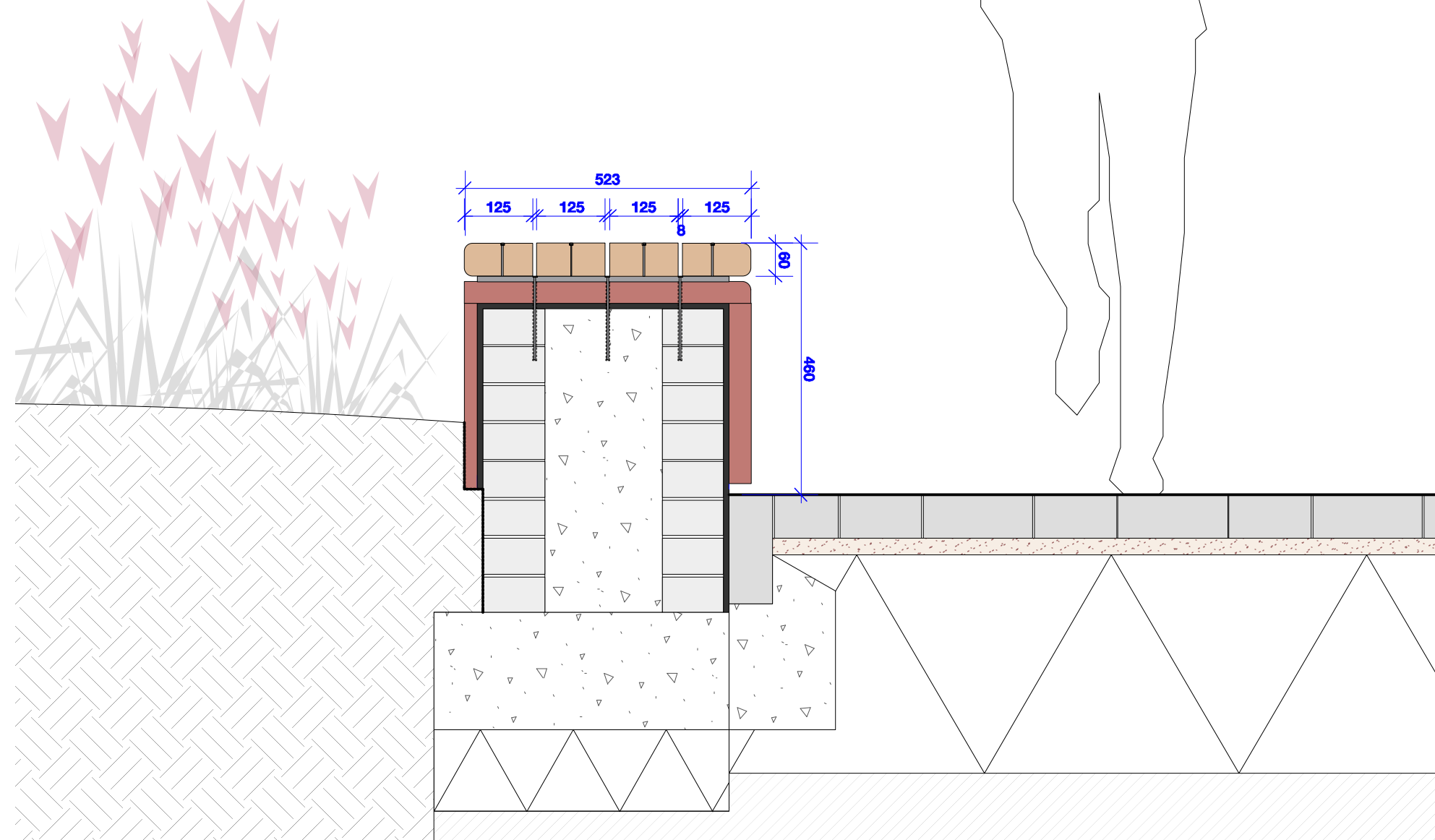

Seating Type 4 - SECTION: 1:10@A1
Clad Blockwork to Memorial Gardens - Timber Topped + Arm/Back rests

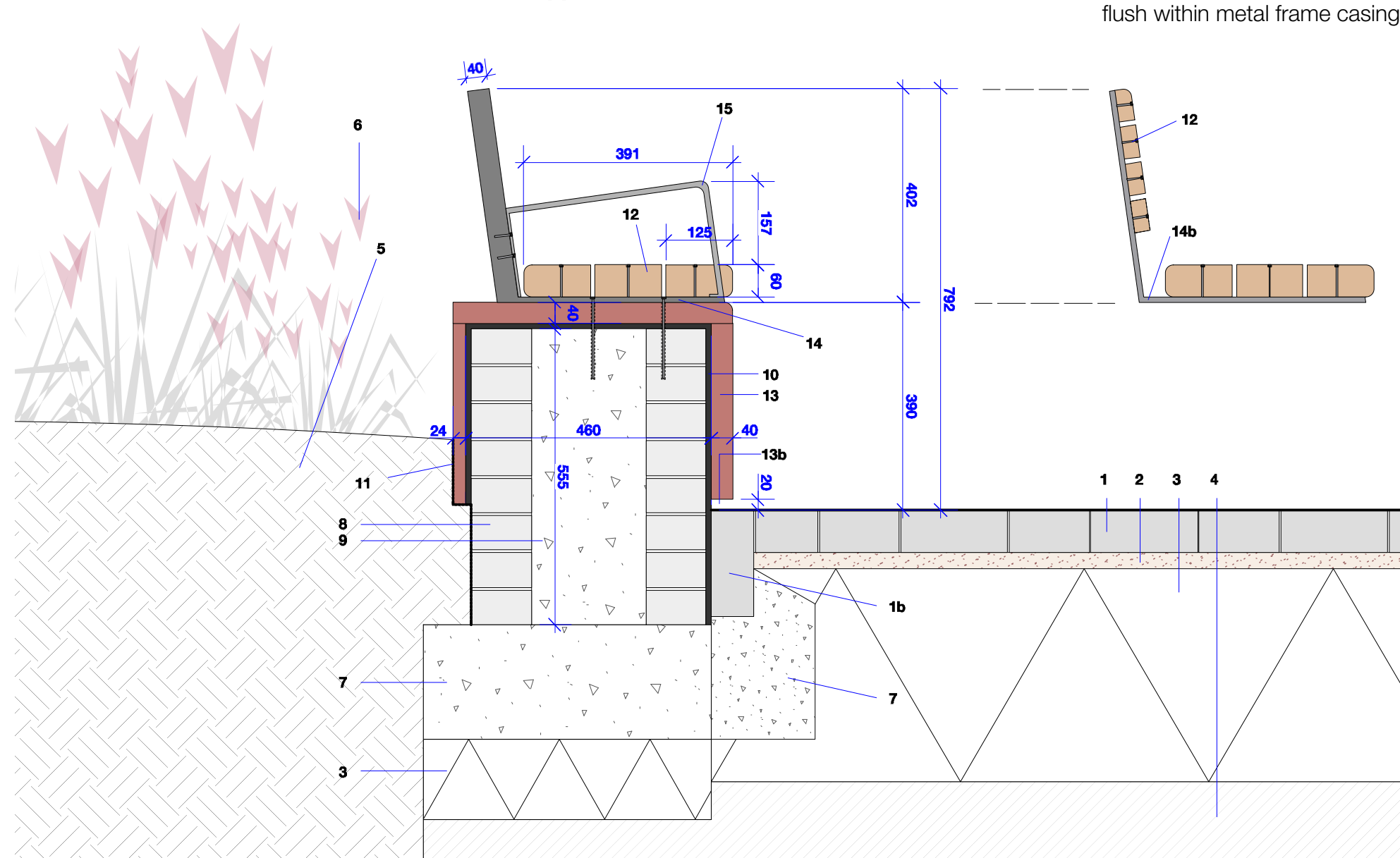

Seating Type 5 - SECTION: 1:10@A1
Clad Blockwork to Memorial - Memorial Bench

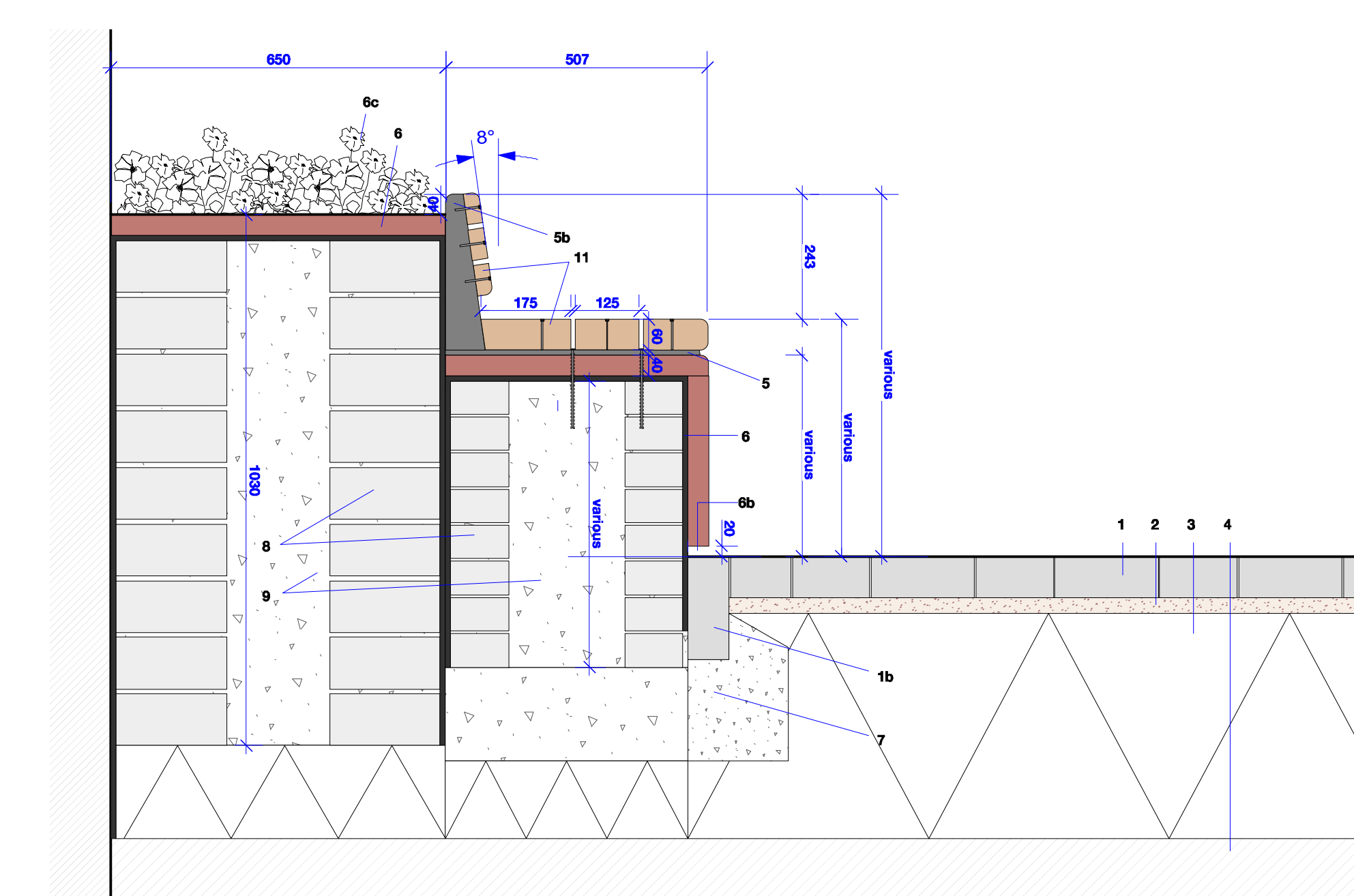

Seating Type 3/4 - SECTION: 1:10@A1
Bookends to clad blockwork.

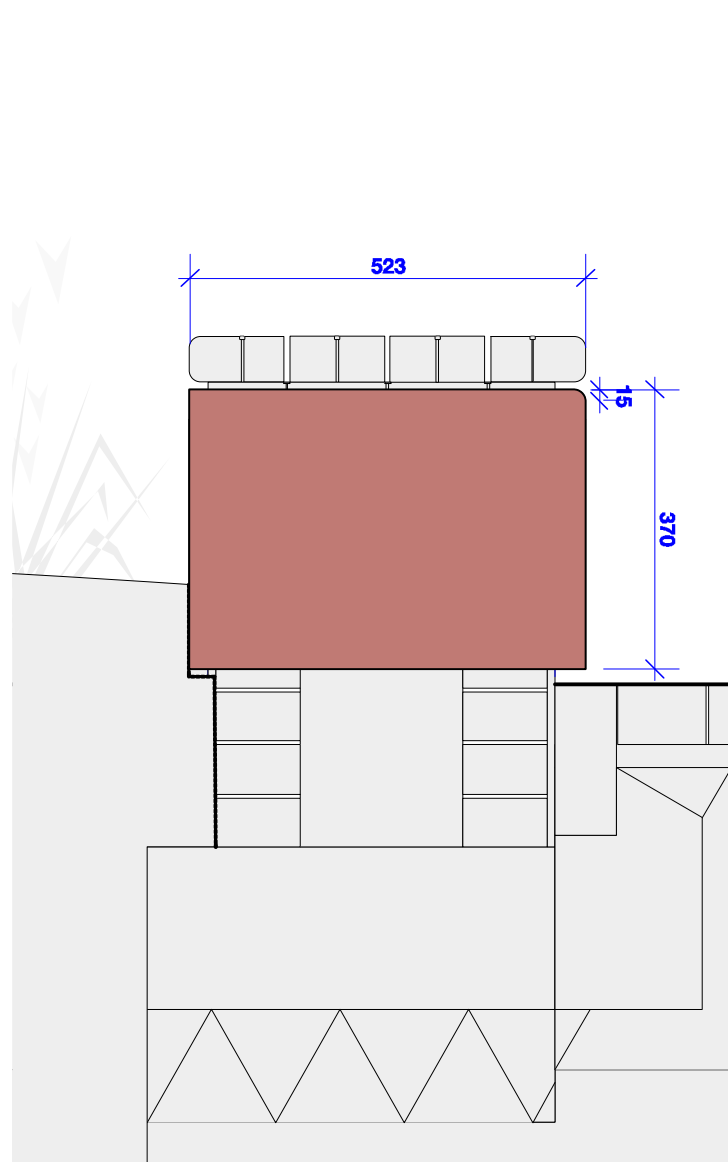

Seating Type 3/4 - ELEVATION: 1:10@A1
Bookends to clad blockwork.

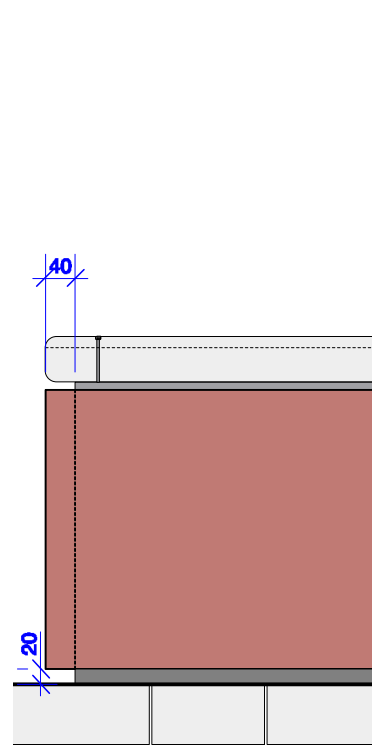

Memorial Bench Plan: 1:25@A1

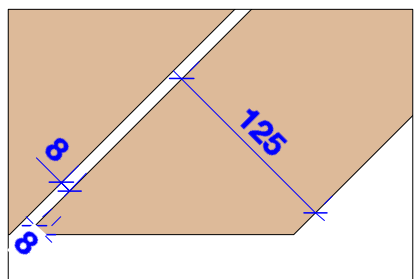
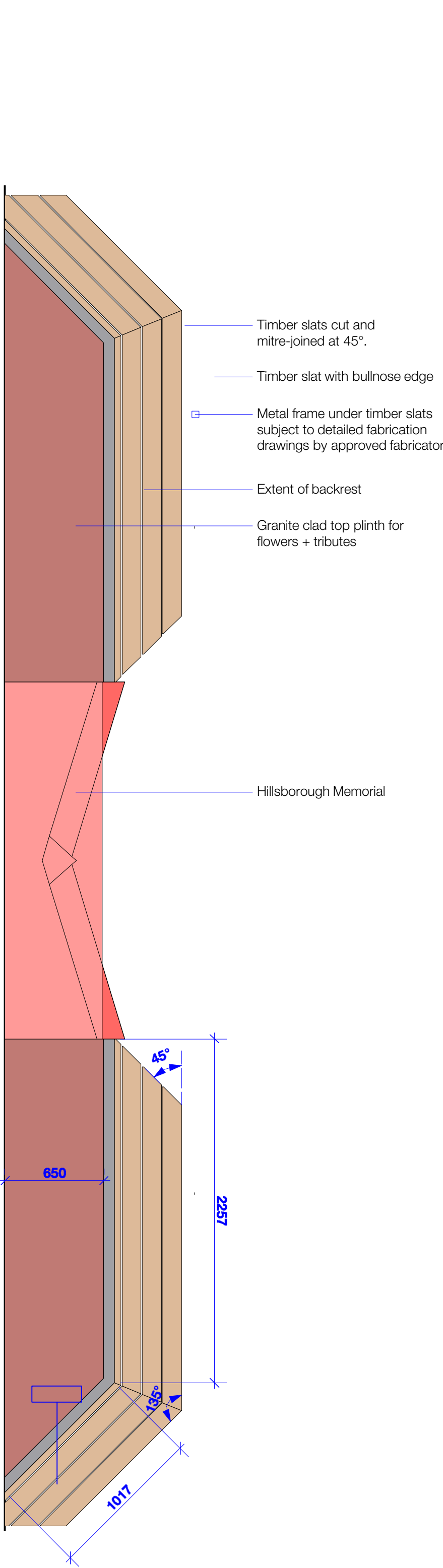

Timber chamfer detail : 1:5@A1

KEY

- 'Boulevard' concrete block paving. Concrete block paving, 200(W) x 150(L) x 80mm, cashel colour (to Q25)
- End block paving module laid flush as an upstand edge
- Sand bedding (to Q25)
- DoT Type 1 compacted sub-base to engineers details.
- Existing ground
- Topsoil to planting beds (to Q28)
- Planting - refer to PL1312.GA.109 Softworks
- ST4 Concrete Foundation to engineer's detail
- Concrete blockwork wall
- Concrete infill to blockwork wall (to E10)
- Epoxy mortar / stainless steel anchor tie to fix cladding to carcass. Contractor's choice.
- Gel coat to all blockwork faces exposed to soil backfill to avoid water seepage.
- Treated hardwood battens with 15mm bullnosing as shown and mechanically fixed to metal frame. (to Q50)
- Granite cladding fixed to blockwork. Mortared or stainless steel anchor ties to fix cladding to carcass - contractor's choice. (to M40)
- Shadow gap nominally 20mm to take variances in level changes across length of bench.
- Metal frame fixed to top of plinth. Edges of frames to form casing for timber slats to sit flush against. Outer edge frames. (to Q50)
- Intermediate bench frames to support timber battens.
- Metal armrests with rounded corners as shown and fixed to metal frame with tamper-proof fixings. (to Q50)

KEY

- 'Boulevard' concrete block paving. Concrete block paving, 200(W) x 150(L) x 80mm, cashel colour (to Q25)
- End block paving module laid flush as an upstand edge
- Sand bedding (to Q25)
- DoT Type 1 compacted sub-base to engineers details.
- Existing ground
- Metal frame fixed to top of plinth. Edges of frames to form casing for timber slats to sit flush against. Outer edge frames. (to Q50)
- Top lip of metal frame, upstand and bullnosed to act as lip to edge of surface to leave flowers and tributes on top plinth.
- Granite cladding fixed to blockwork. Mortared or stainless steel anchor ties to fix cladding to carcass - contractor's choice. (to M40)
- Shadow gap nominally 20mm to take variances in level changes across length of bench.
- Memorial surface to rest flowers and tributes
- ST4 Concrete Foundation to engineer's detail
- Concrete blockwork wall
- Concrete infill to blockwork wall (to E10)
- Epoxy mortar / stainless steel anchor tie to fix cladding to carcass. Contractor's choice.
- Treated hardwood battens with 15mm bullnosing as shown and mechanically fixed to metal frame. (to Q50)

THIS DRAWING IS COPYRIGHT PROTECTED AND MAY NOT BE REPRODUCED IN WHOLE OR PART WITHOUT WRITTEN AUTHORITY FROM THE OWNER.

- NOTE:**
- Do not scale from this drawing. Always work to noted dimensions.
 - All dimensions are in millimetres unless otherwise stated.
 - All setting out, levels and dimensions to be agreed on site.
 - The dimensions of all materials must be checked on site before being laid out.
 - This drawing must be read with the relevant specification clauses and detail drawings.
 - Order of construction and setting out to be agreed on site.

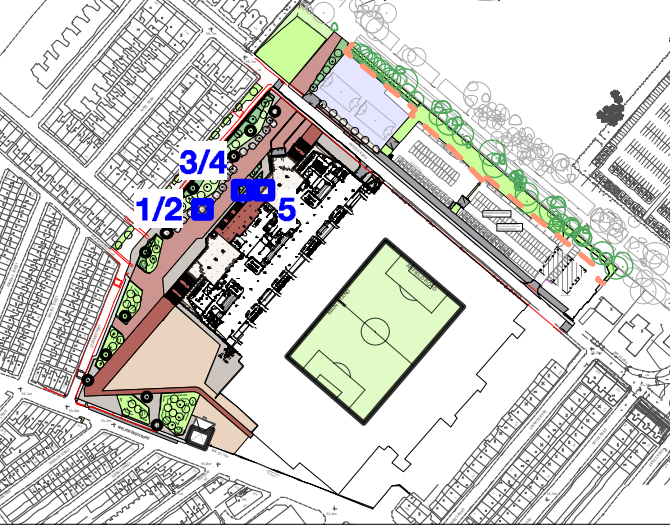

Refer to PL1312.GA.001-008 for Detail Locations

Note:

- Refer to specification E10/E41/Q50 for all materials and finishes
- Set below ground to allow for installation of paving materials.
- Seating designs are indicative and provided to give guidance on material + aesthetics.
- Detailed proposals are to be developed with the selected supplier.
- Test samples to be provide to ensure specification and required high quality finishes are achieved.

Paving:

For typical paving buildups refer to PL1312.D.410

02	23.03.16	Planning Discharge	JT	LH
01	04.03.16	Design Intent	JT	LH
00	01.02.16	Design Intent	JT	LH
Issue	Date	Status	Drawn	Apprvd.

Planit Intelligent Environments LLP
E: info@planit-ie.com W: planit-ie.com
MANCHESTER 2 Back Grafton St, Altrincham, WA14 1DY, T: 0161 928 9281
LONDON 18 Bowling Green Lane, EC1R 0BW, T: 0207 253 5678

Client	Liverpool Football Club
Project	New Anfield

Drg Title	Detail Interface Seating - Memorial
-----------	-------------------------------------

Created on	Created by	Approved by
22.01.2016	JT	LH

Scale	Size	Status
VARIOUS	A1	Design Intent

Drg No.	Issue
PL1312.D.401	

DESIGN INTENT