

Door Type 2 - External Elevation
Ground Floor

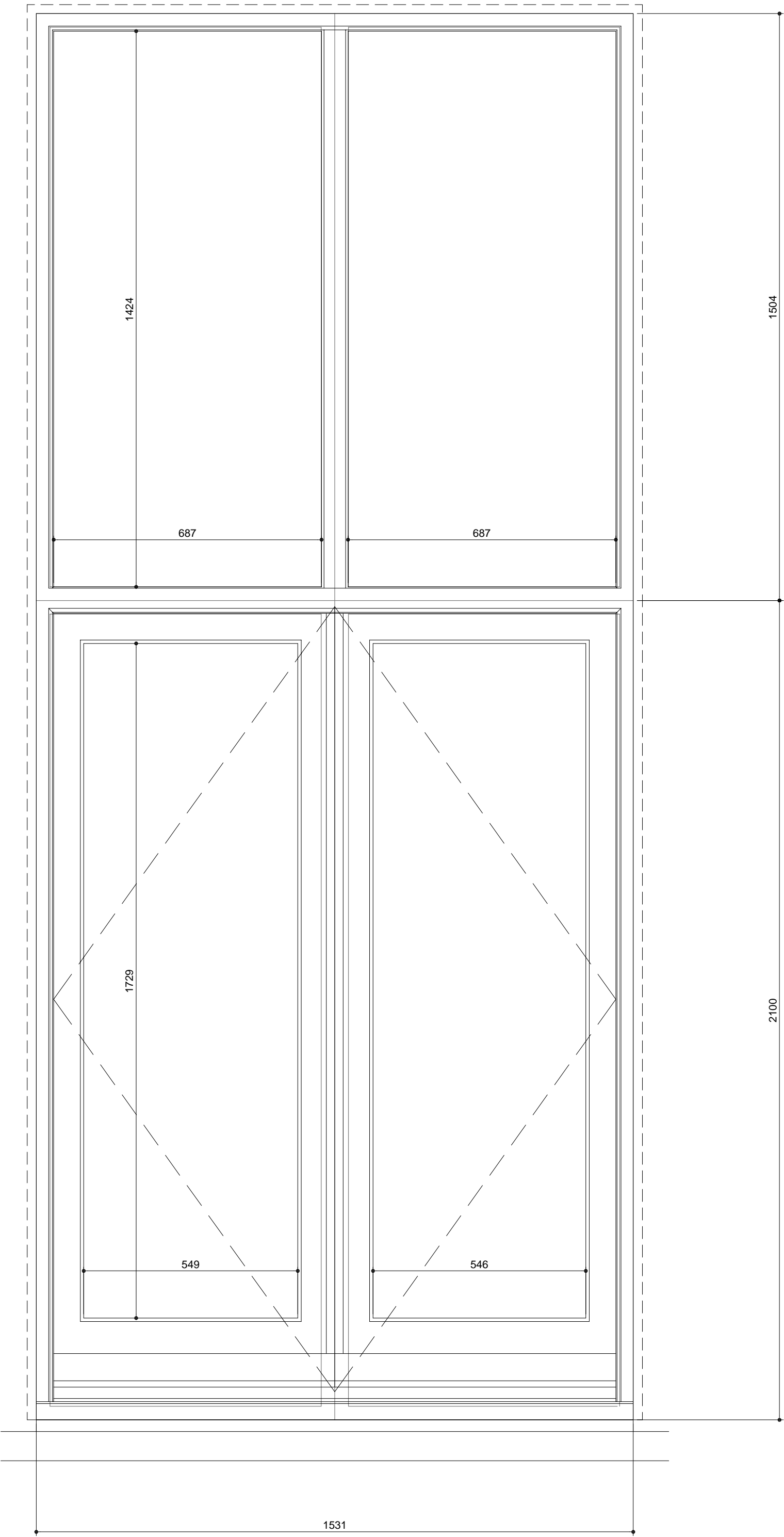

Door Type 3 - External Elevation
First Floor

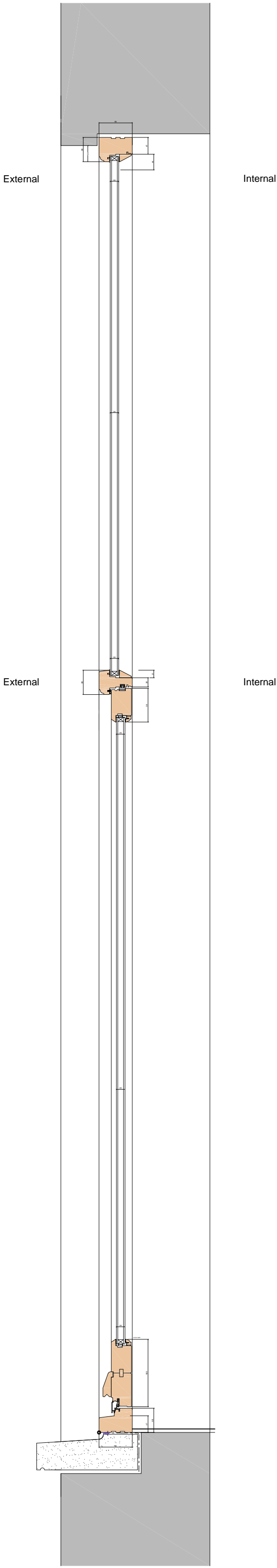

Door Types 2 & 3 - Vertical Section

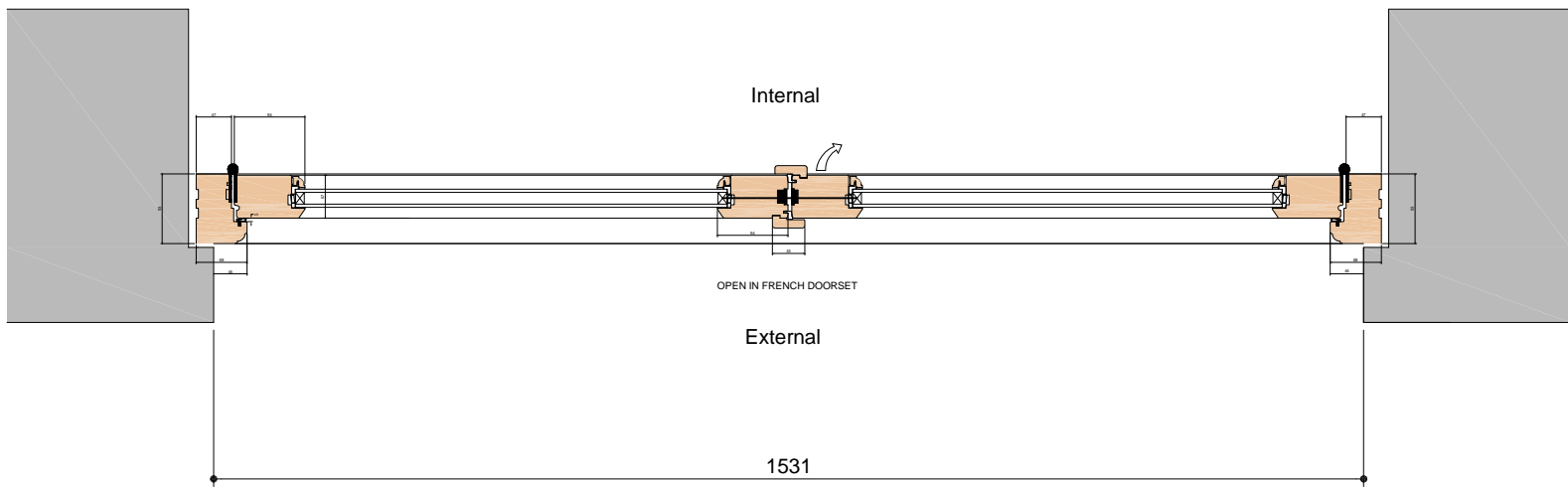

Door Types 2 & 3 - Horizontal Sections

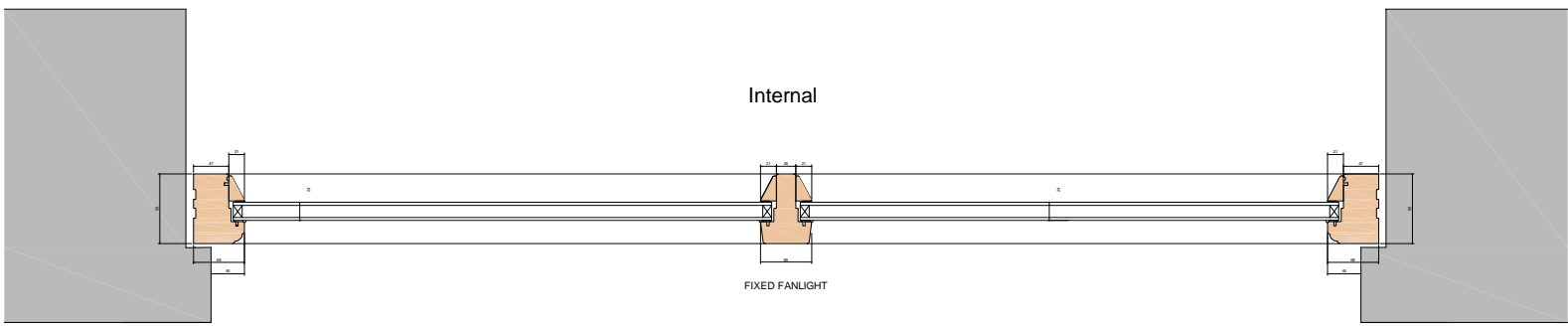

All dimensions to be checked on site.
Figured dimensions to be read in preference to scaled.

BCA accepts no responsibility for any unauthorised amendments to the drawing and does not permit unauthorised copying of the drawing.

This drawing is copyright and remains the property of BCA unless otherwise agreed.

Revisions			
Date	Rev	Description	Init.
23.12.2015	P01	PLANNING ISSUE	MPC

Notes

THE DOOR AND WINDOW COMPONENT SECTIONS ARE BASED ON MINIFORD & WOOD LIMITED CONSERVATION FRENCH DOORSETS INWARD OPENING BALCONY DOOR RANGE IN TRADITIONAL PROFILES TO COMPLEMENT THE CONSERVATION BOX SASH WINDOW PRODUCTS.

FOR LOCATIONS OF DOOR TYPES 2 & 3 REFER TO DRAWING NO 15.013/L(32)001.

PLANNING

Client	Countryside Properties/Liverpool Mutual Homes	Scale	1:10	Drawn	MPC	Checked	MPC	Date	Dec 2015
Job title	Ogdens Building	Job number	15.013	Drawing number	L(32)002	Issue	P01		
Drawing title	New External Door Types - Sheet 2 of 2								

Brock Carmichael Architects

19 OLD HALL STREET
LIVERPOOL
L3 9JD
TELEPHONE +44 (0)151 242 6222
FACSIMILE +44 (0)151 236 4467
OFFICE 0151 236 4467
WWW.BROCKCARMICHAEL.CO.UK