

31 Beechwood Road, Cressington, Liverpool, L19 0LA

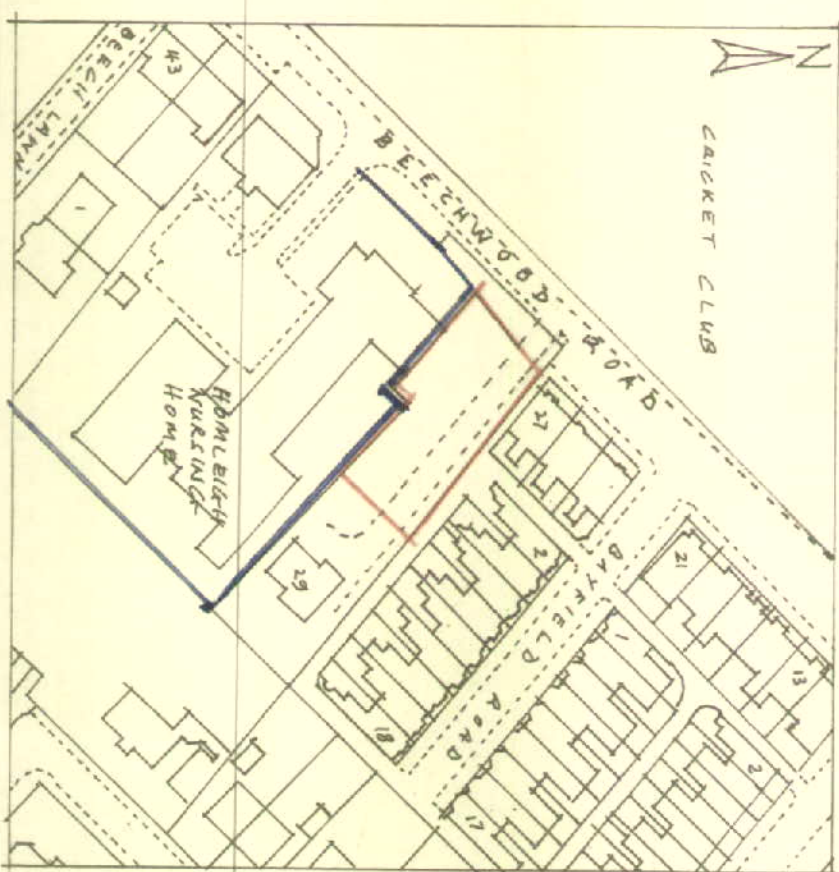

FORMER LOCATION PLAN (Scale 1: 1250)



EXISTING LOCATION PLAN (Scale 1: 1250)

Map shows area bounded by: 338949, 28,385373, 28,339090, 72,38514, 72 (at a scale of 1:1250). The representation of a road, track or path is no evidence of a right of way. The representation of features as lines is no evidence of a property boundary.

Produced on 18 July 2014 from the Ordnance Survey National Geographic Database and incorporating surveyed revision available at this time. Reproduction in whole or part is prohibited without the prior permission of Ordnance Survey. © Crown copyright 2014. Supplied by JKPlanningMaps.com a licensed Ordnance Survey partner (100054135). Unique plan reference: pz/12291/15006

Ordnance Survey and the OS Symbol are registered trademarks of Ordnance Survey, the national mapping agency of Great Britain. JKPlanningMaps logo and other designs are Copyright © copla ltd 2014

146/2570
24/10/14

PROPOSED 3 STOREY 1 BED APARTMENTS
at
31 Beechwood Road, Aigburth, Liverpool, L19 0LA
for
Doyle Developments Limited
October 2014

Drwg No 100/01