

## Appendix 5.1

### Daylight and Sunlight Availability Figures

## Daylight Availability (VSC)

Baseline Scenario

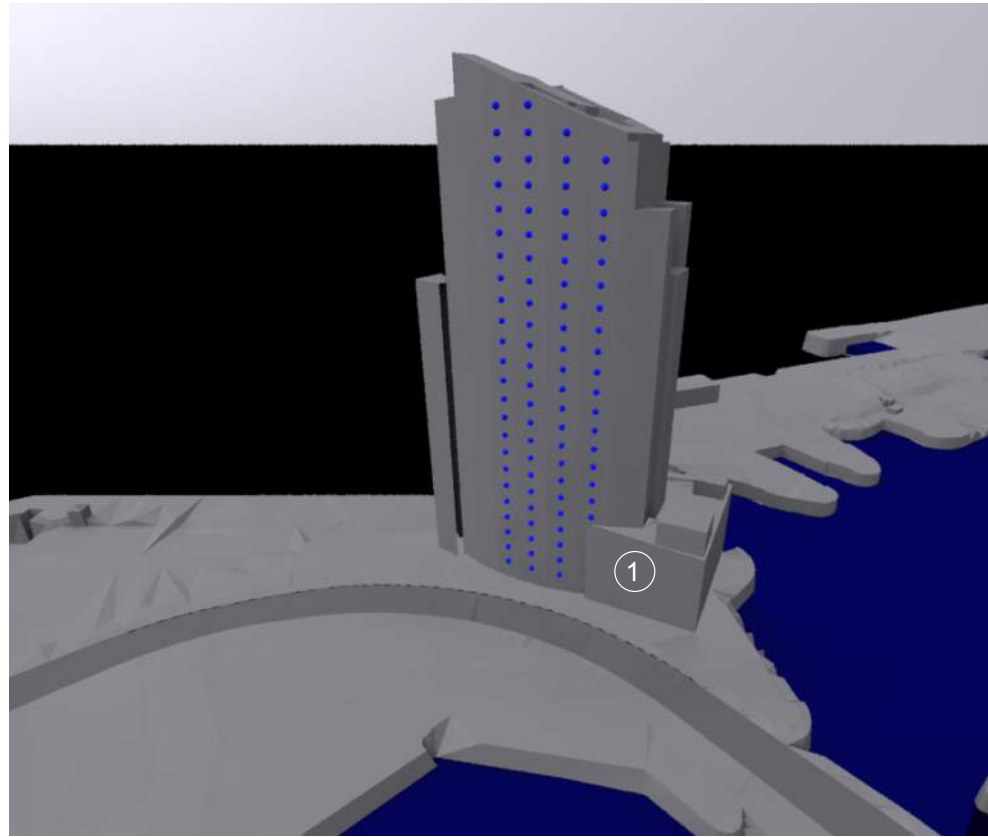

Development Scenario 1

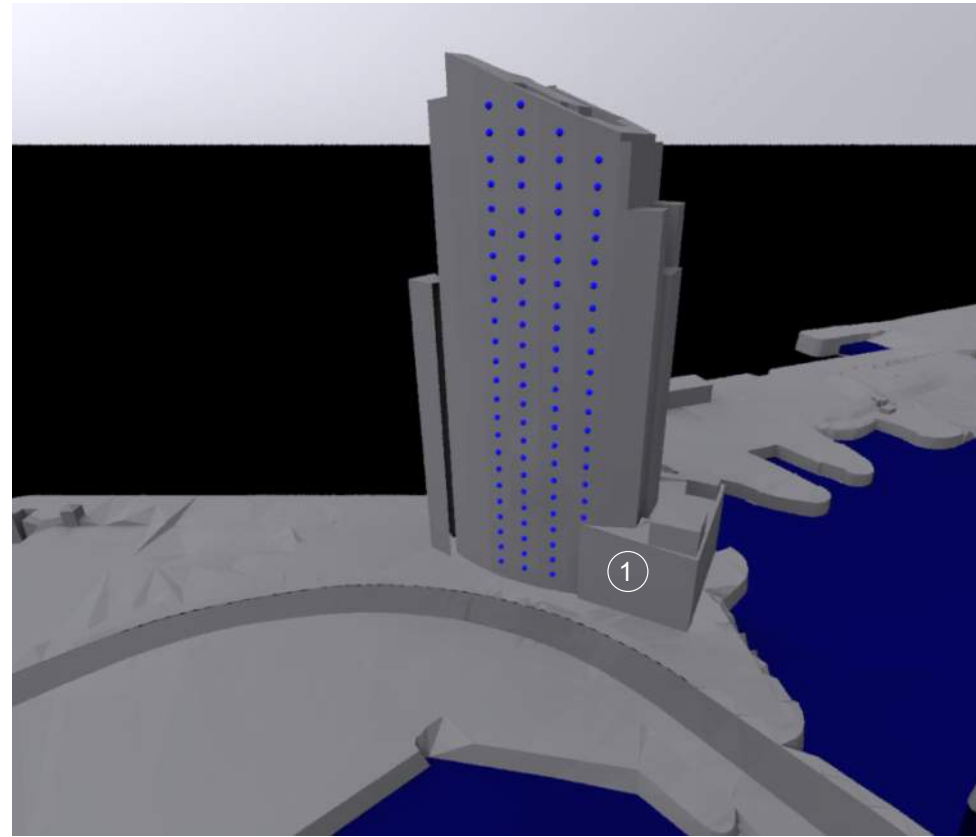

Development Scenario 2

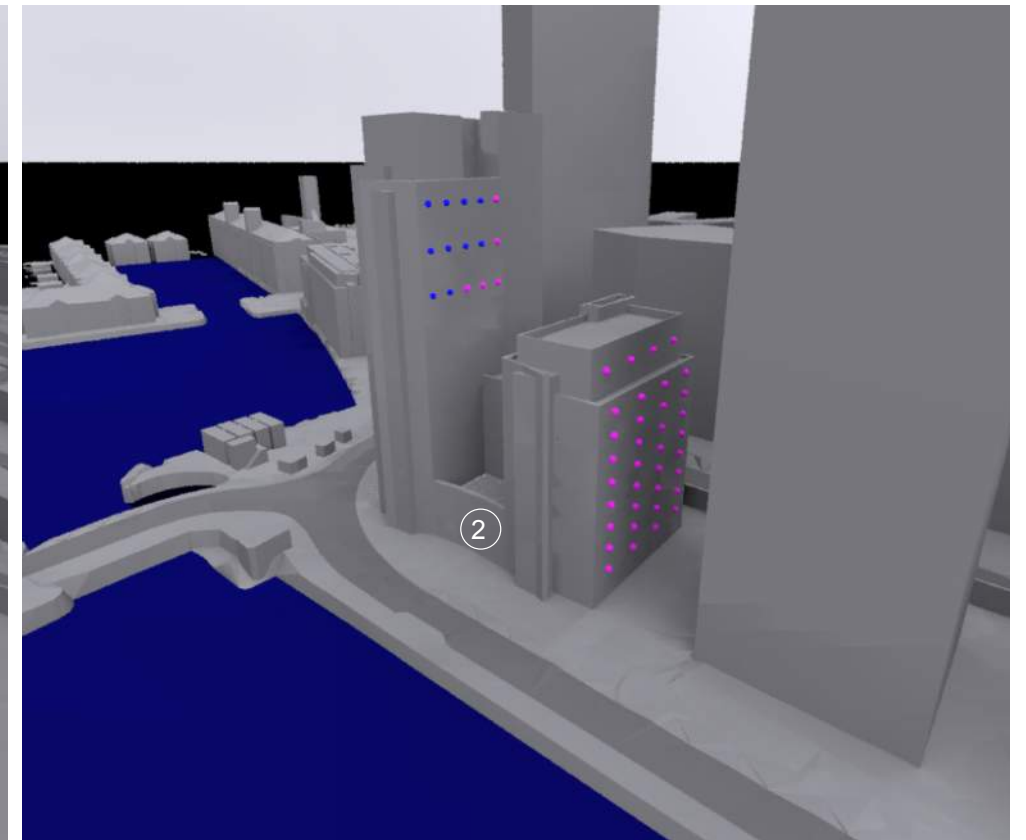
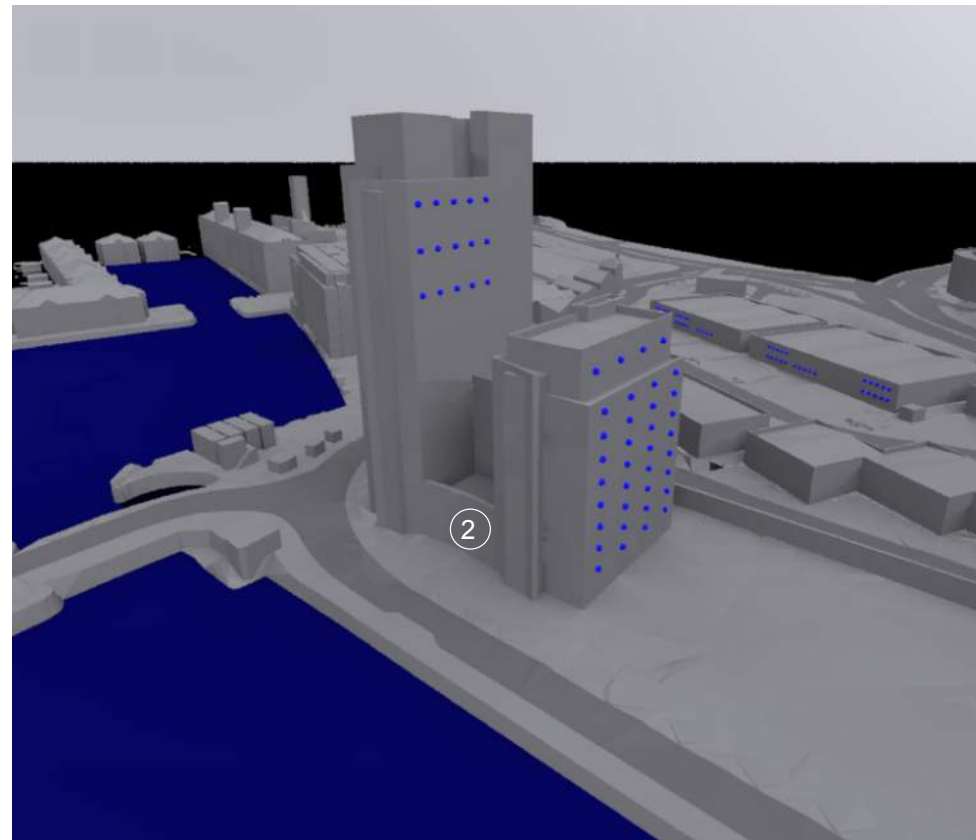
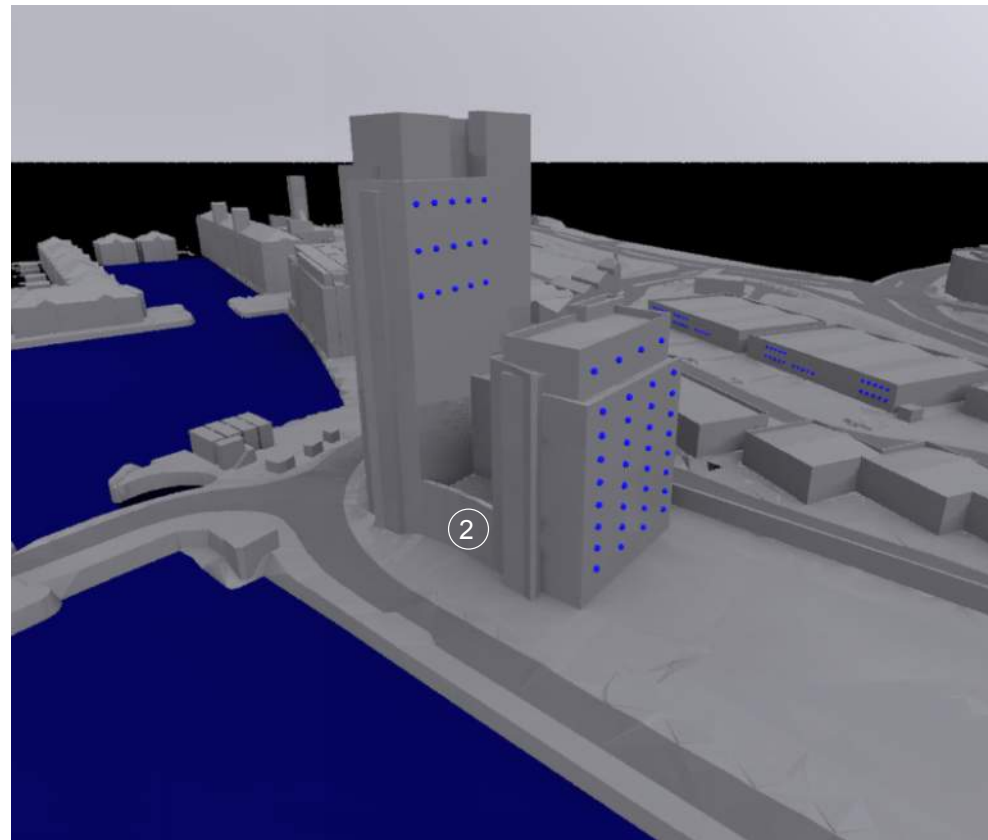
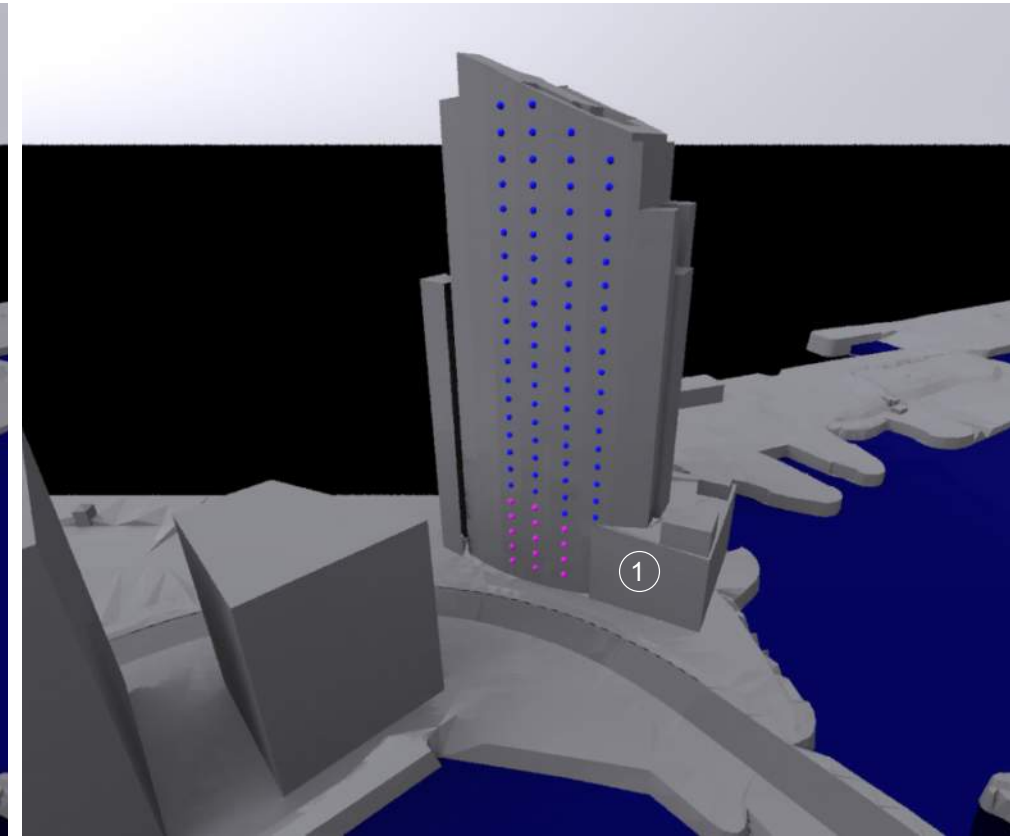

### Building References:

(1) Alexandra Tower, (2) No. 1 Princes Dock, (3) No. 20-24 Gibraltar Way, (4) No. 14-18 Gibraltar Way, (5) No. 10-12 Gibraltar Way, (6) No. 04-08 Gibraltar Way, (7) Radisson Hotel (8) HM Passport Office, (9) West Tower, (10) Metropolitan House, (11) Liverpool Echo Offices, (12) No. 10 Princes Parade, (13) No. 12 Princes Parade,

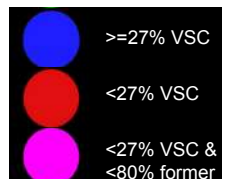

Daylight Availability (VSC)

Baseline Scenario

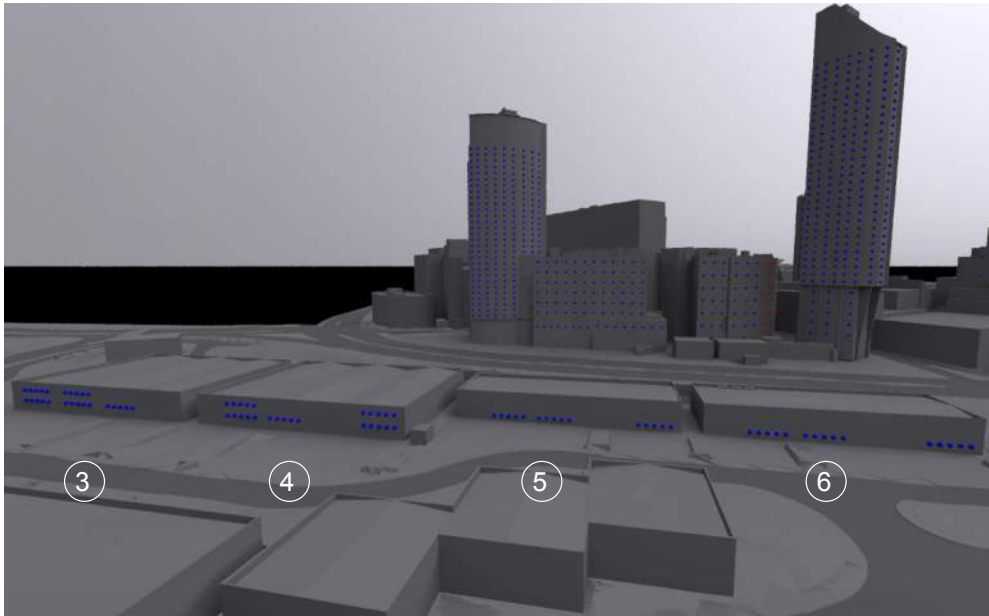

Development Scenario 1

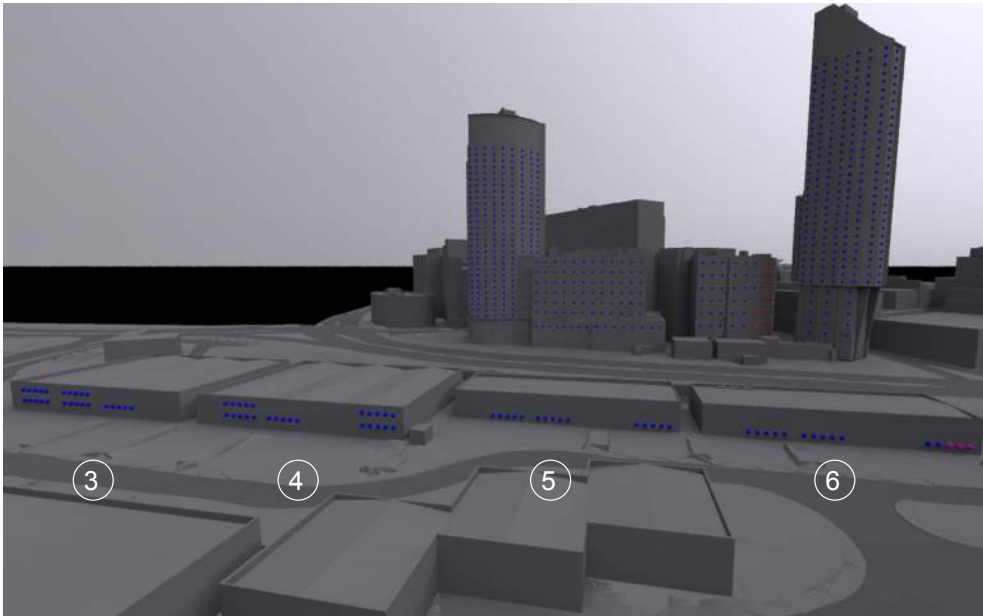

Development Scenario 2

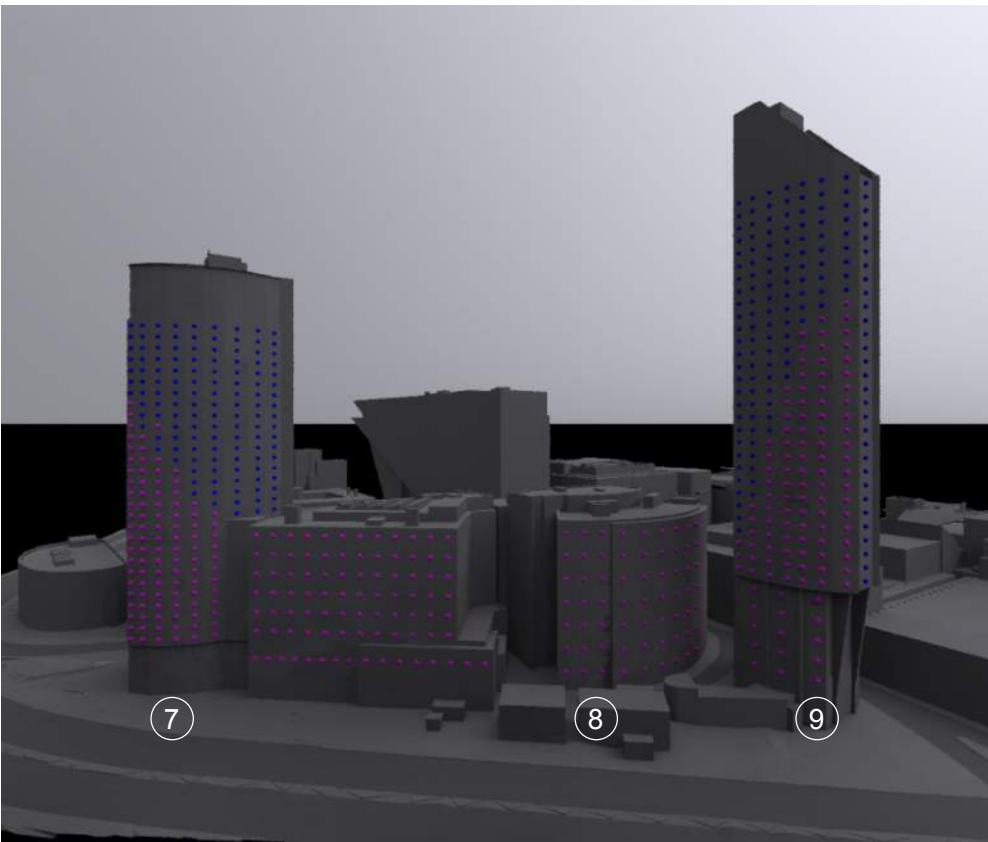
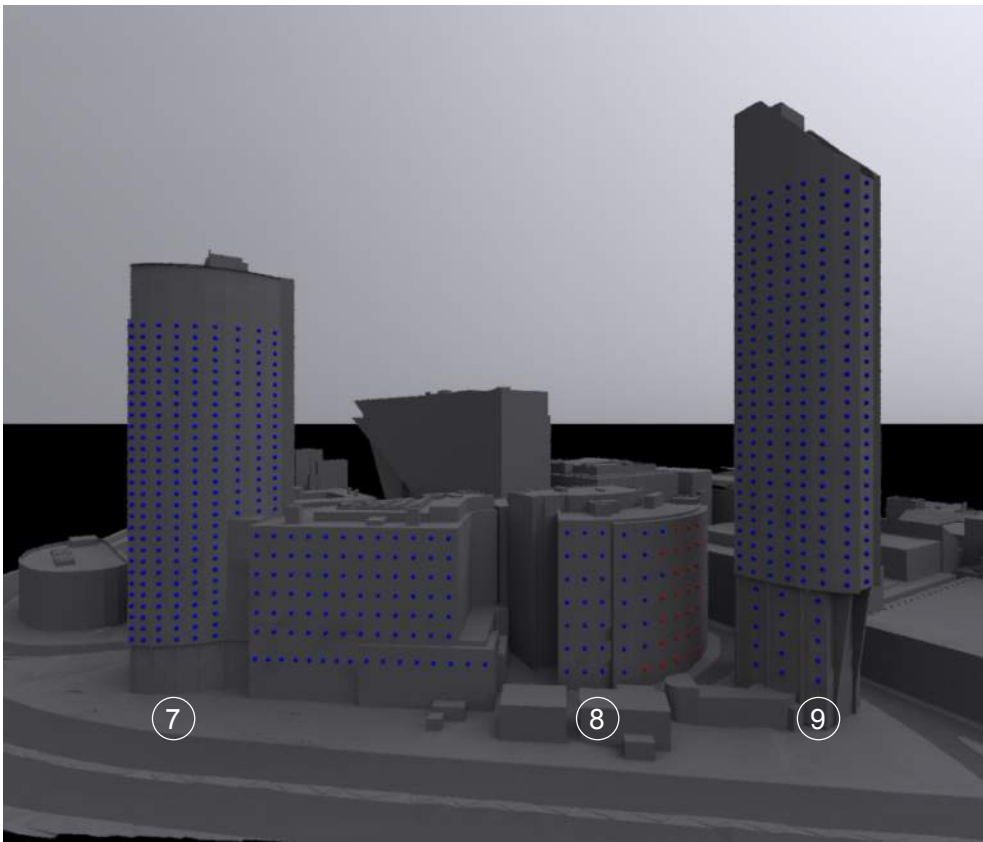
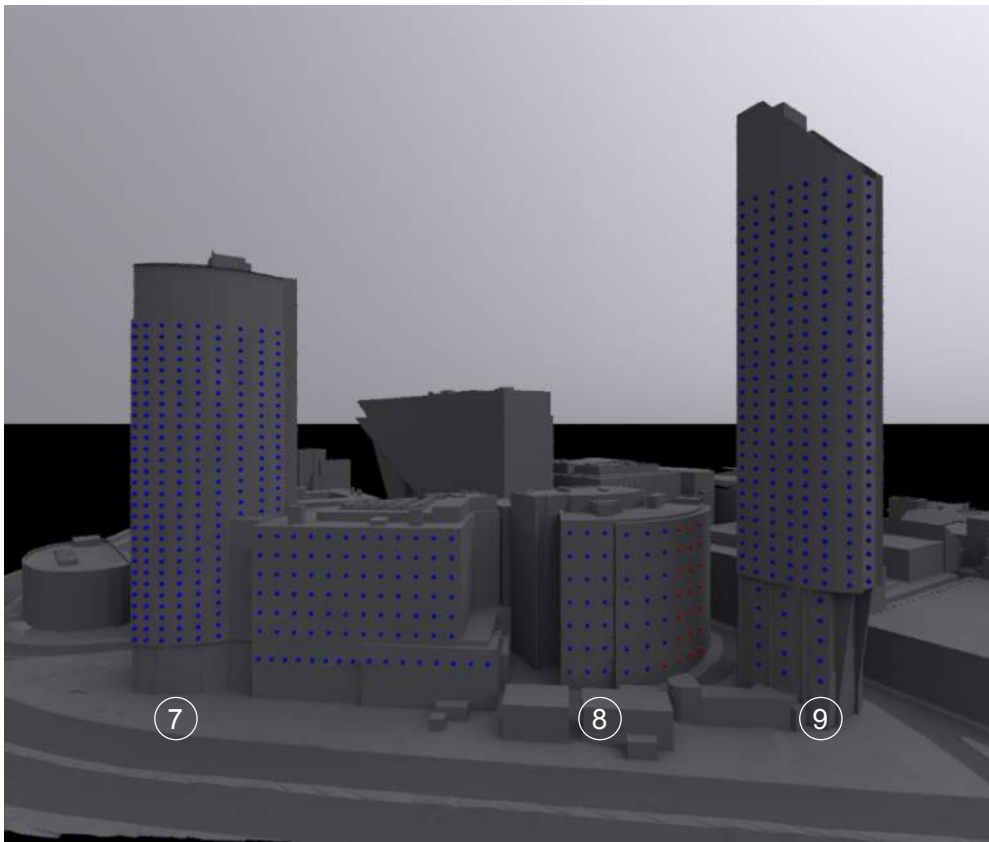
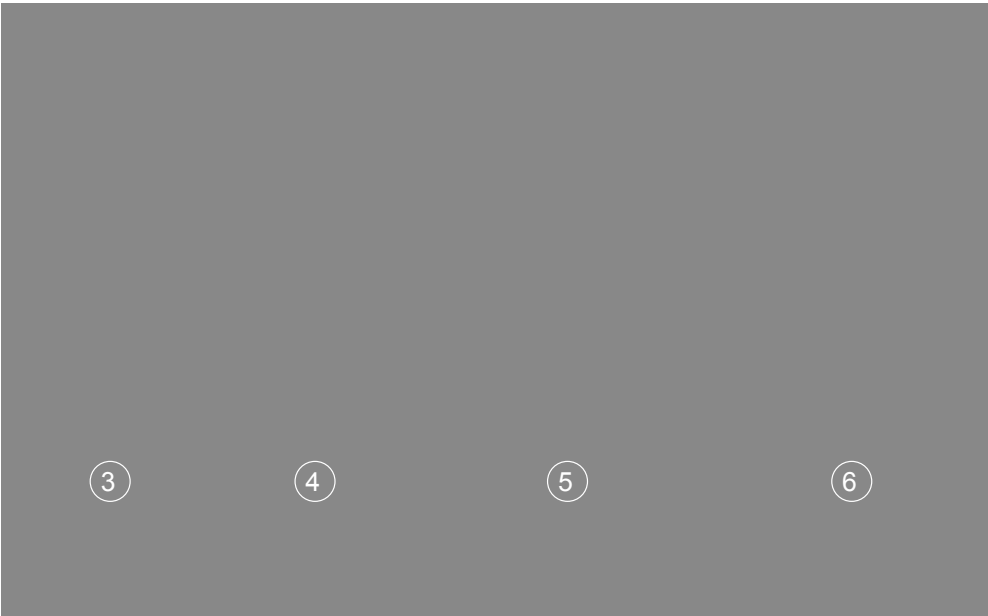

Building References:

(1) Alexandra Tower, (2) No. 1 Princes Dock, (3) No. 20-24 Gibraltar Way,(4) No. 14-18 Gibraltar Way, (5) No. 10-12 Gibraltar Way, (6) No. 04-08 Gibraltar Way, (7) Radisson Hotel (8) HM Passport Office, (9) West Tower, (10) Metropolitan House, (11) Liverpool Echo Offices, (12) No. 10 Princes Parade, (13) No. 12 Princes Parade,

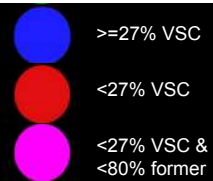



Daylight Availability (VSC)

Baseline Scenario

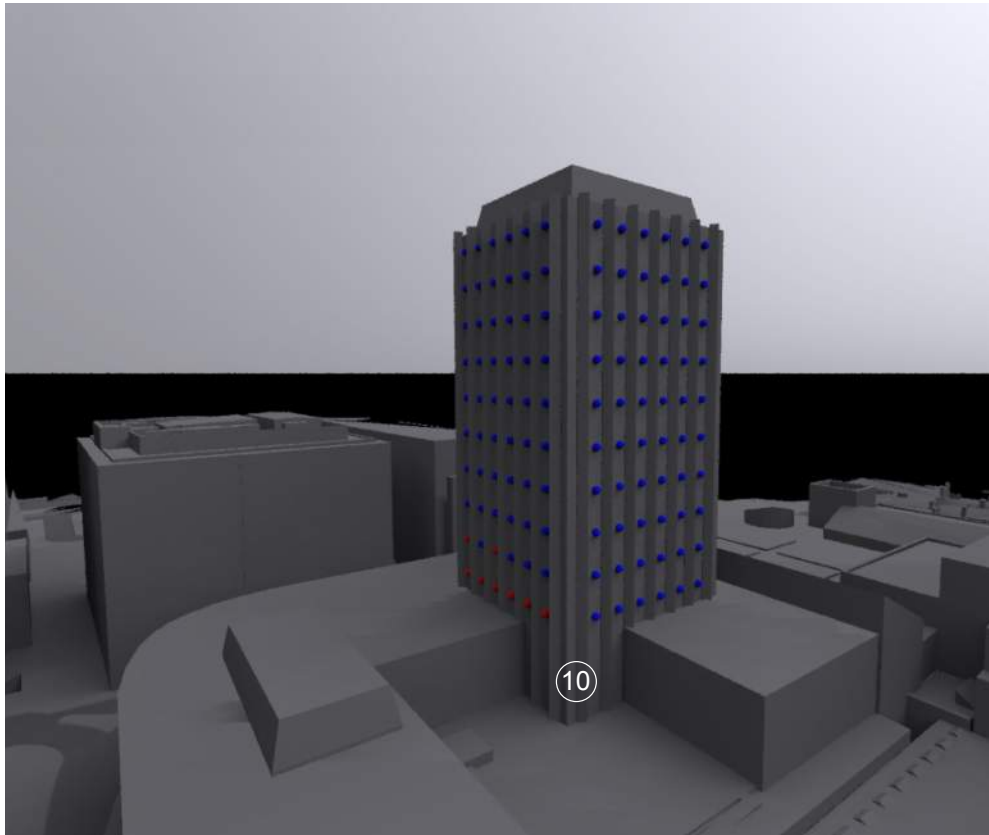

Development Scenario 1

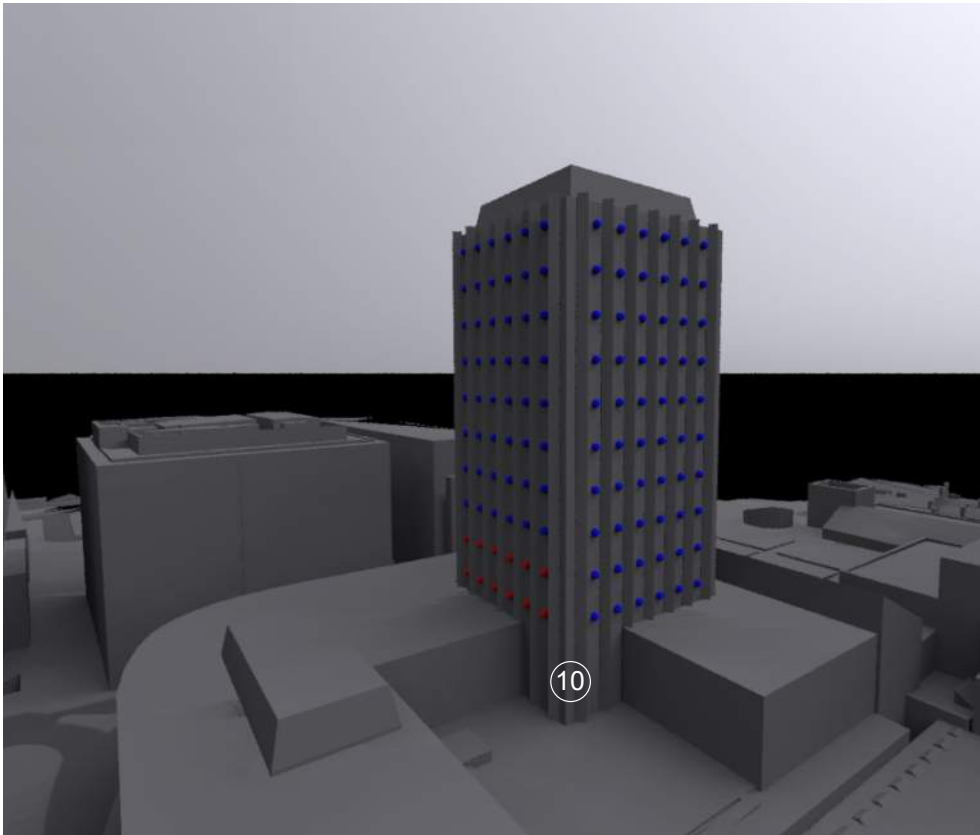

Development Scenario 2

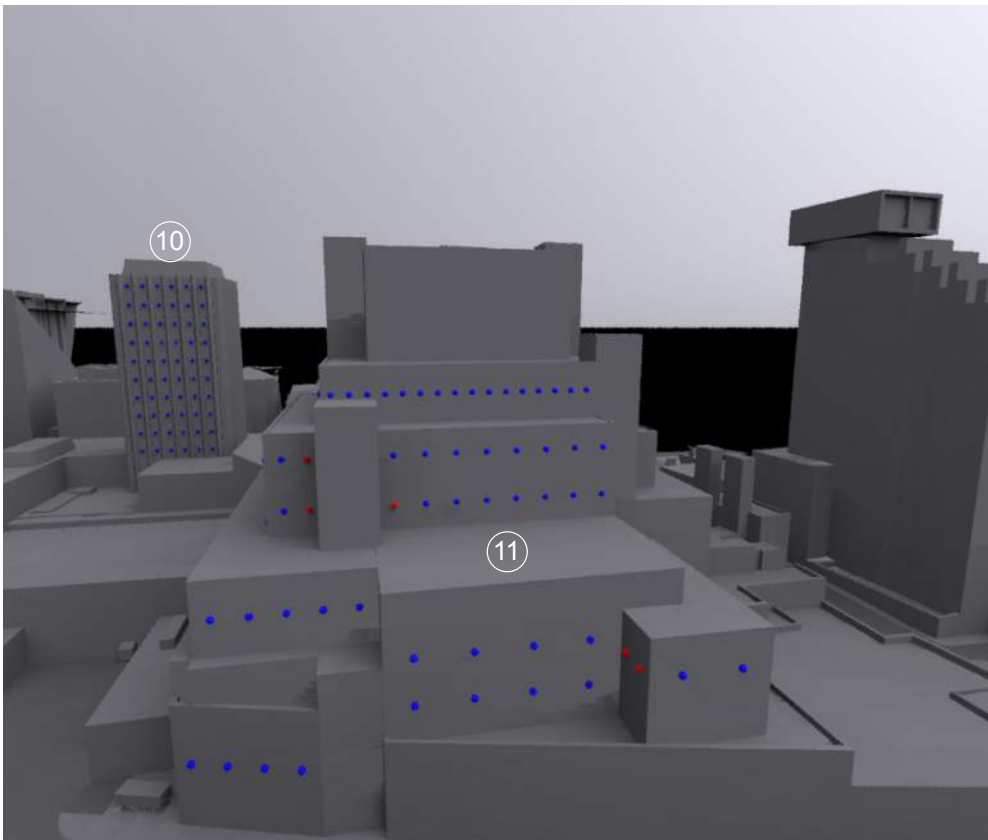
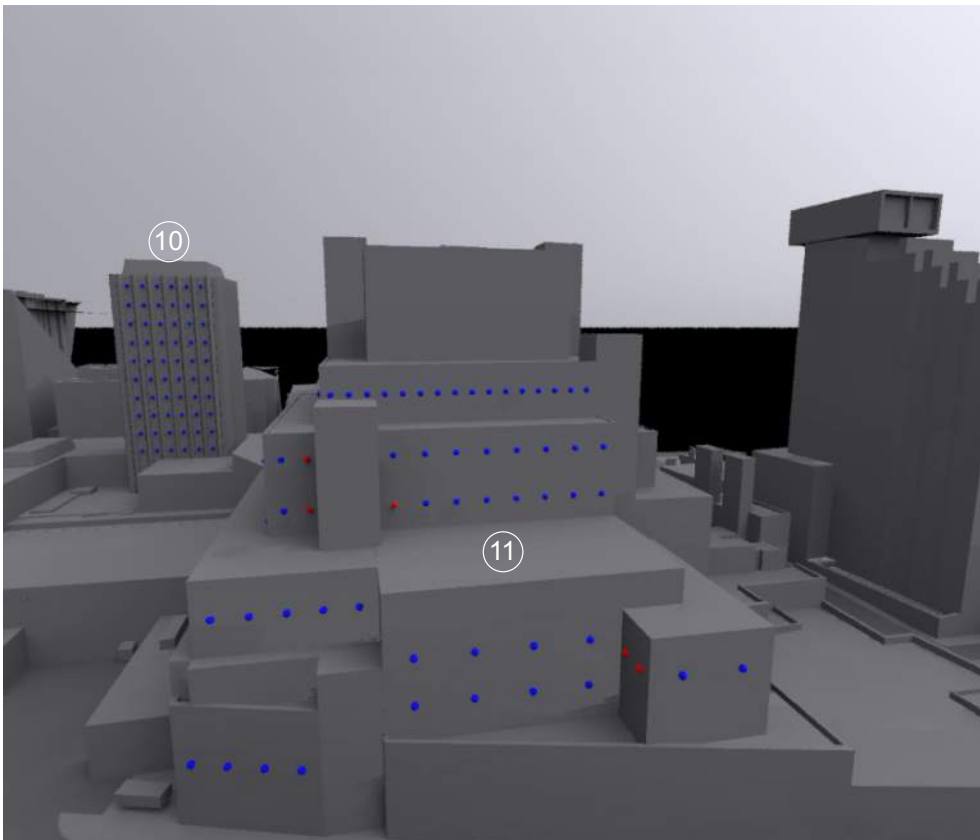
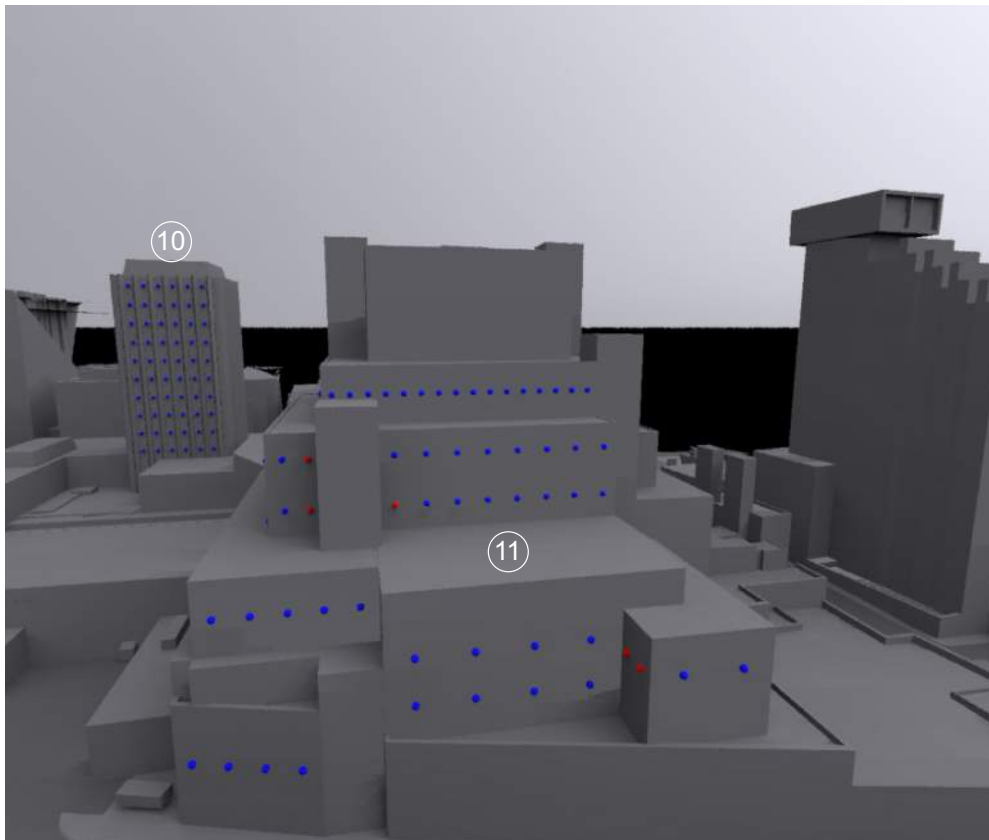
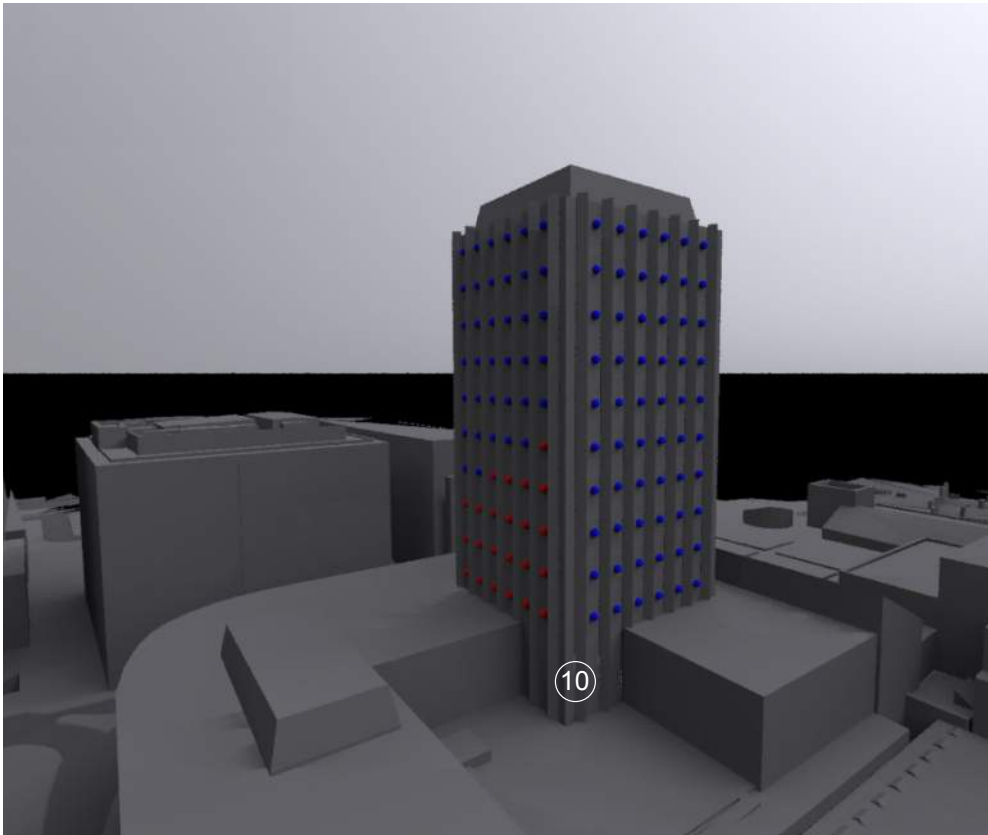

Building References:

(1) Alexandra Tower, (2) No. 1 Princes Dock, (3) No. 20-24 Gibraltar Way,(4) No. 14-18 Gibraltar Way, (5) No. 10-12 Gibraltar Way, (6) No. 04-08 Gibraltar Way, (7) Radisson Hotel (8) HM Passport Office, (9) West Tower, (10) Metropolitan House, (11) Liverpool Echo Offices, (12) No. 10 Princes Parade, (13) No. 12 Princes Parade,

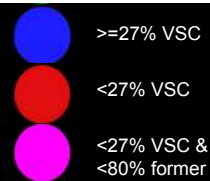

Daylight Availability (VSC)

Baseline Scenario

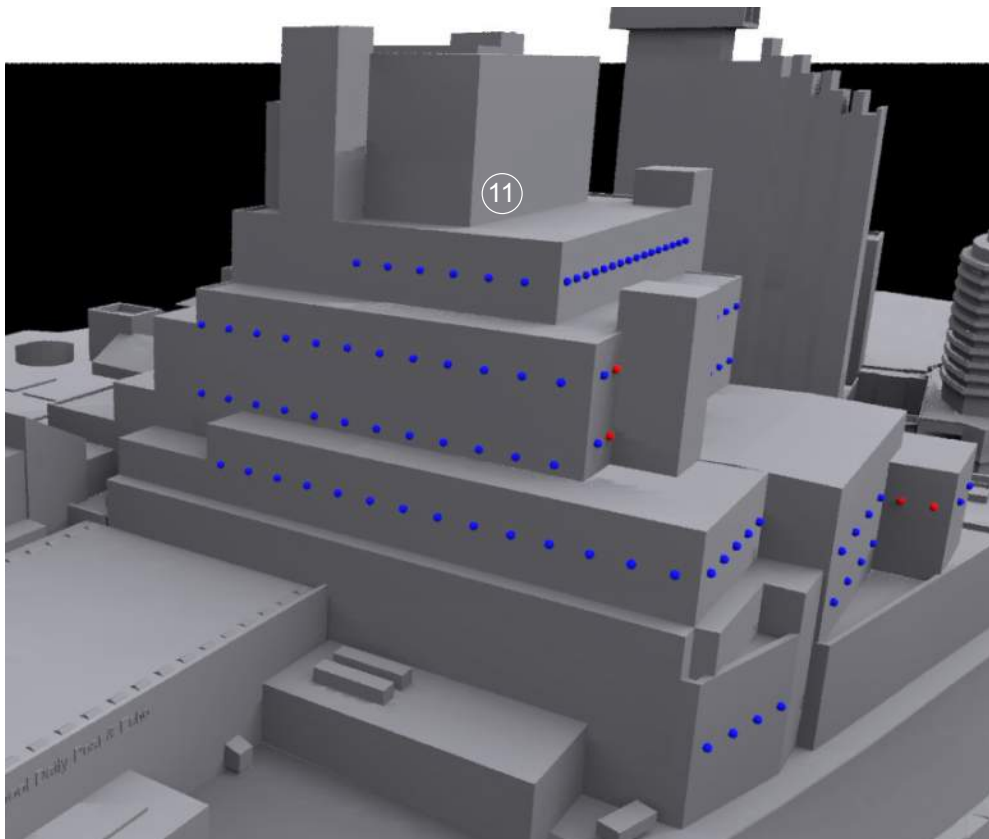

Development Scenario 1

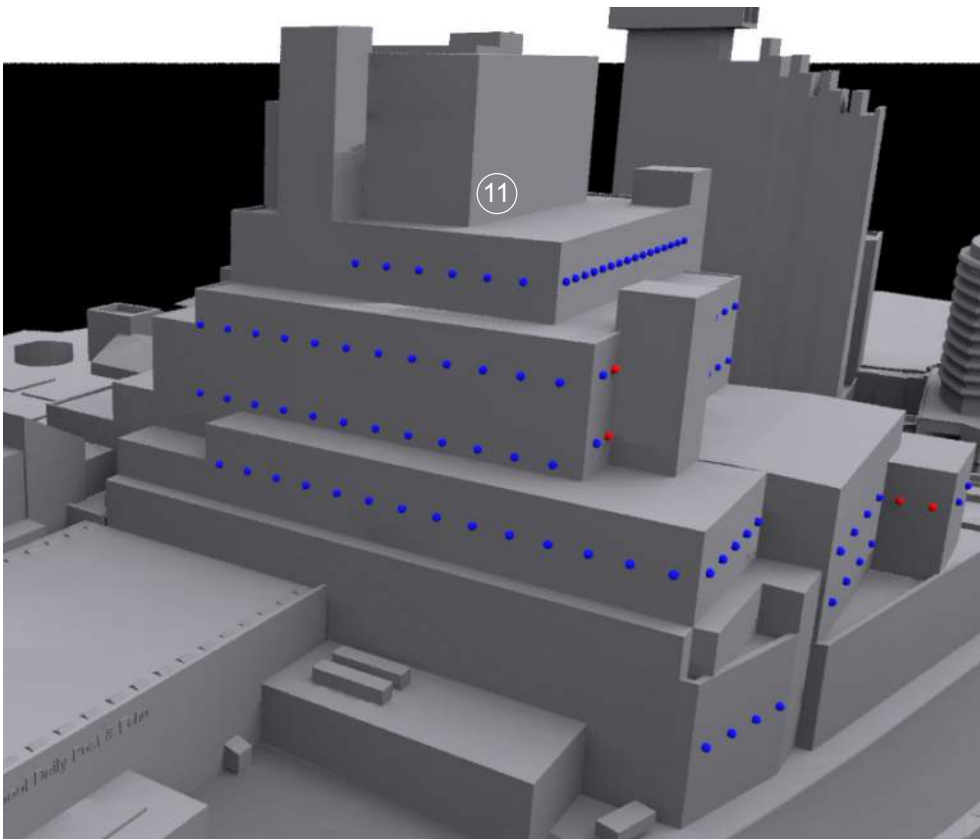

Development Scenario 2

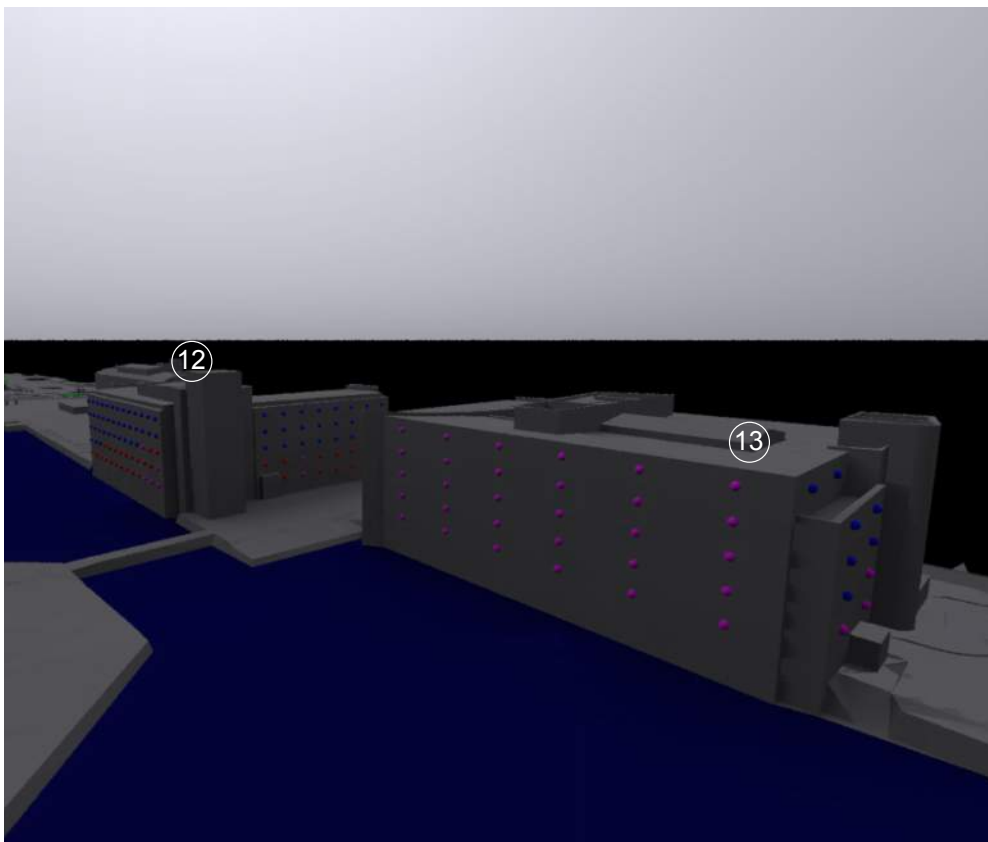
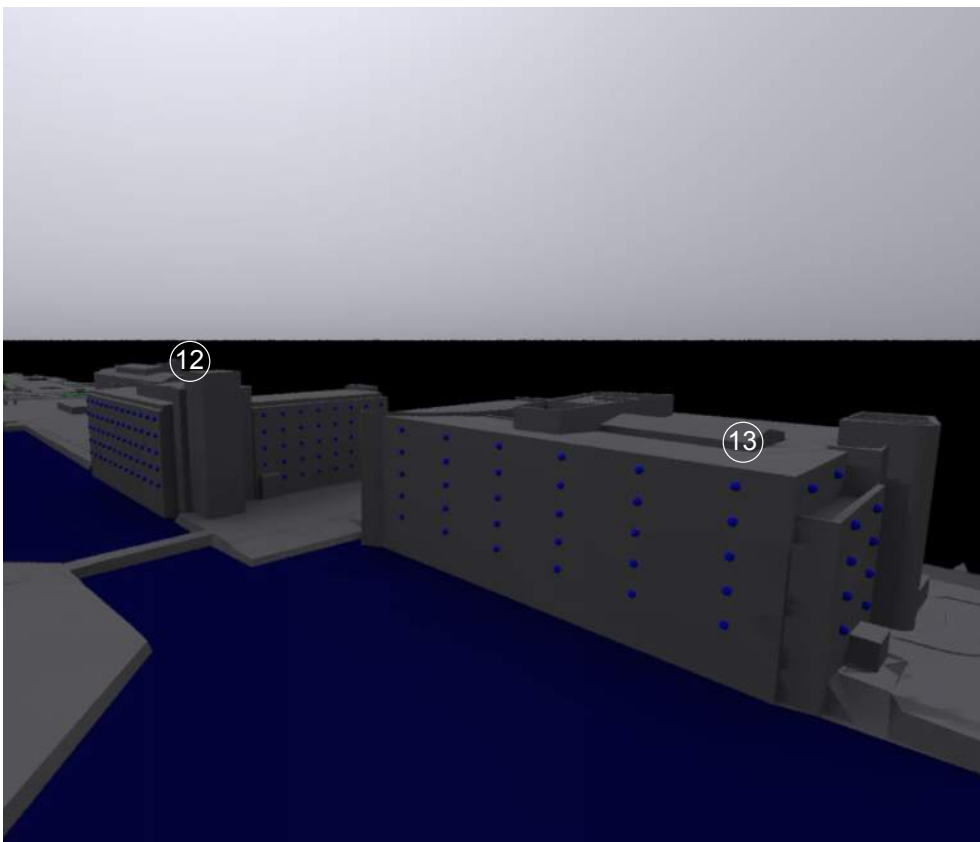
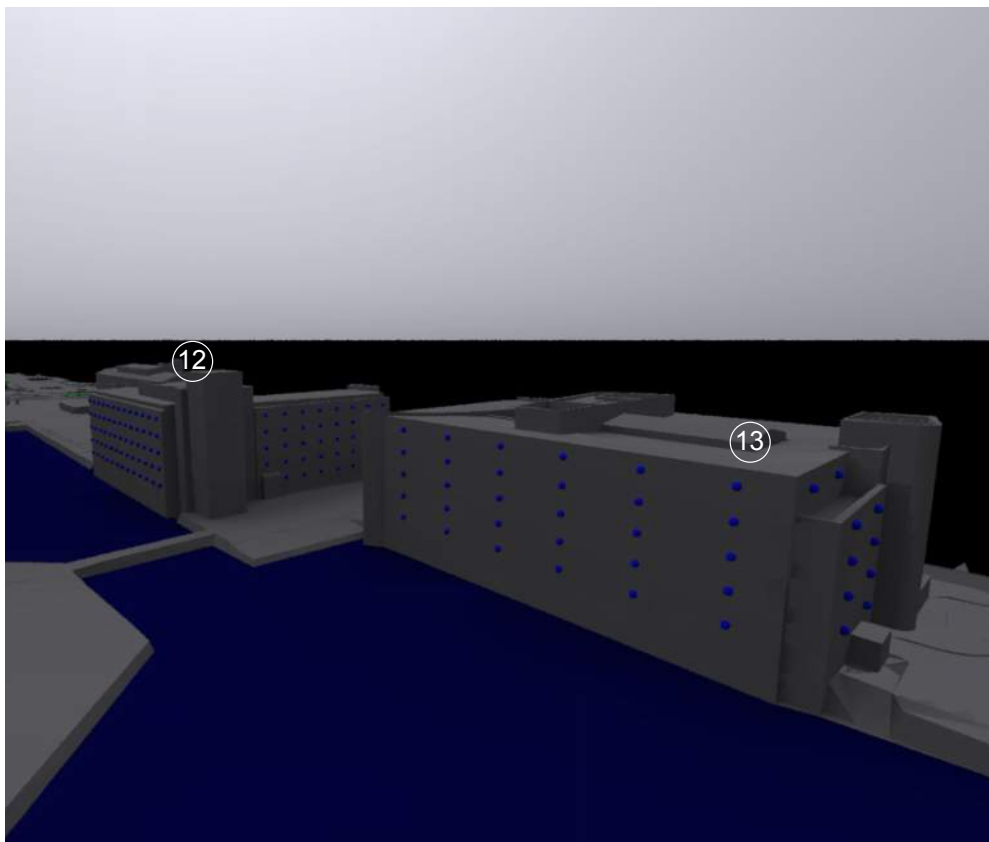
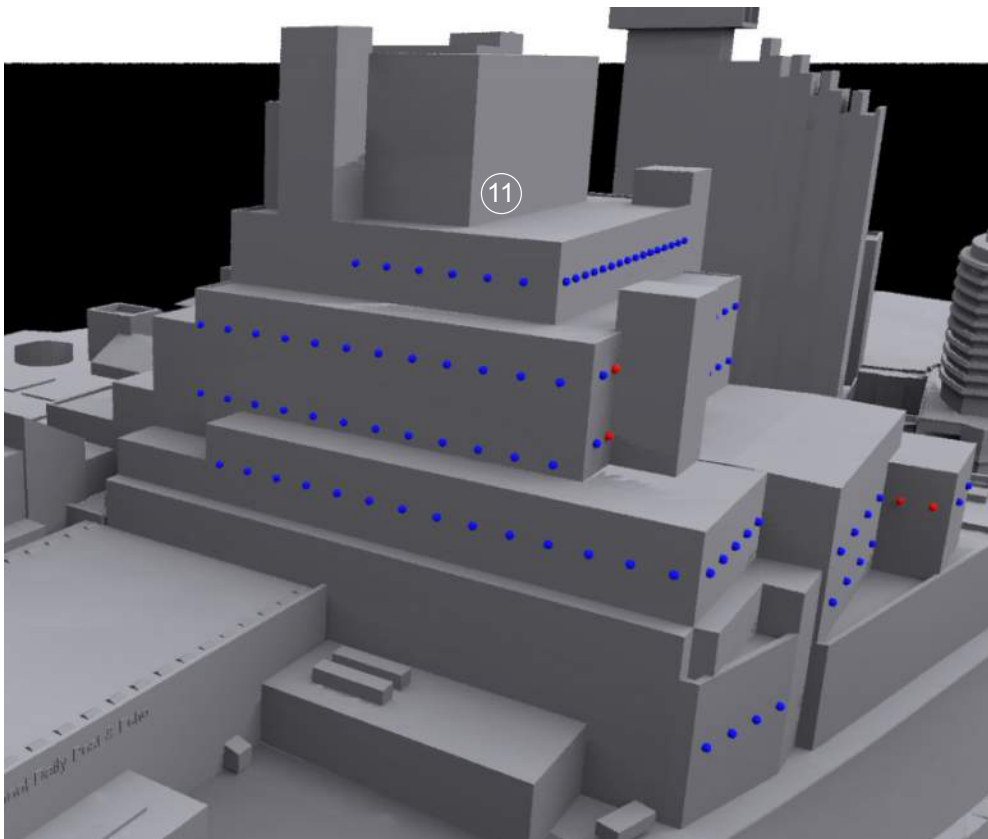

Building References:

(1) Alexandra Tower, (2) No. 1 Princes Dock, (3) No. 20-24 Gibraltar Way, (4) No. 14-18 Gibraltar Way, (5) No. 10-12 Gibraltar Way, (6) No. 04-08 Gibraltar Way, (7) Radisson Hotel (8) HM Passport Office, (9) West Tower, (10) Metropolitan House, (11) Liverpool Echo Offices, (12) No. 10 Princes Parade, (13) No. 12 Princes Parade,

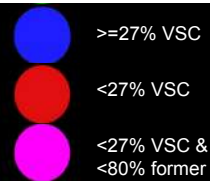



## Sunlight Availability (APSH)

Baseline Scenario

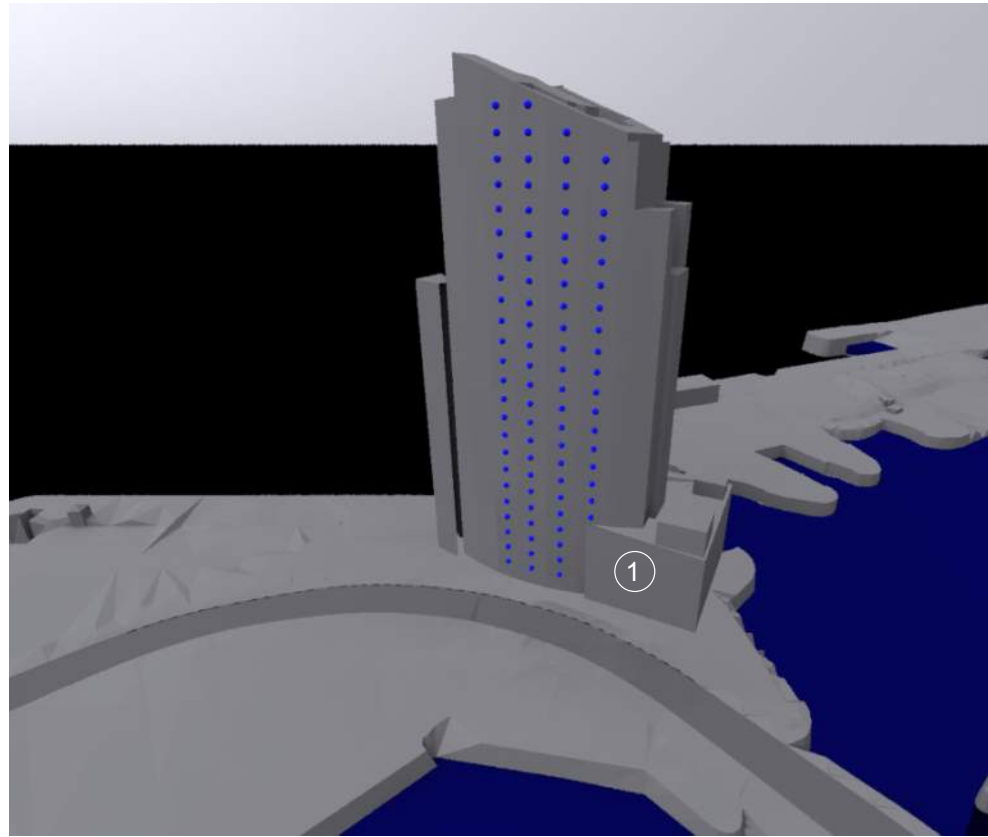

Development Scenario 1

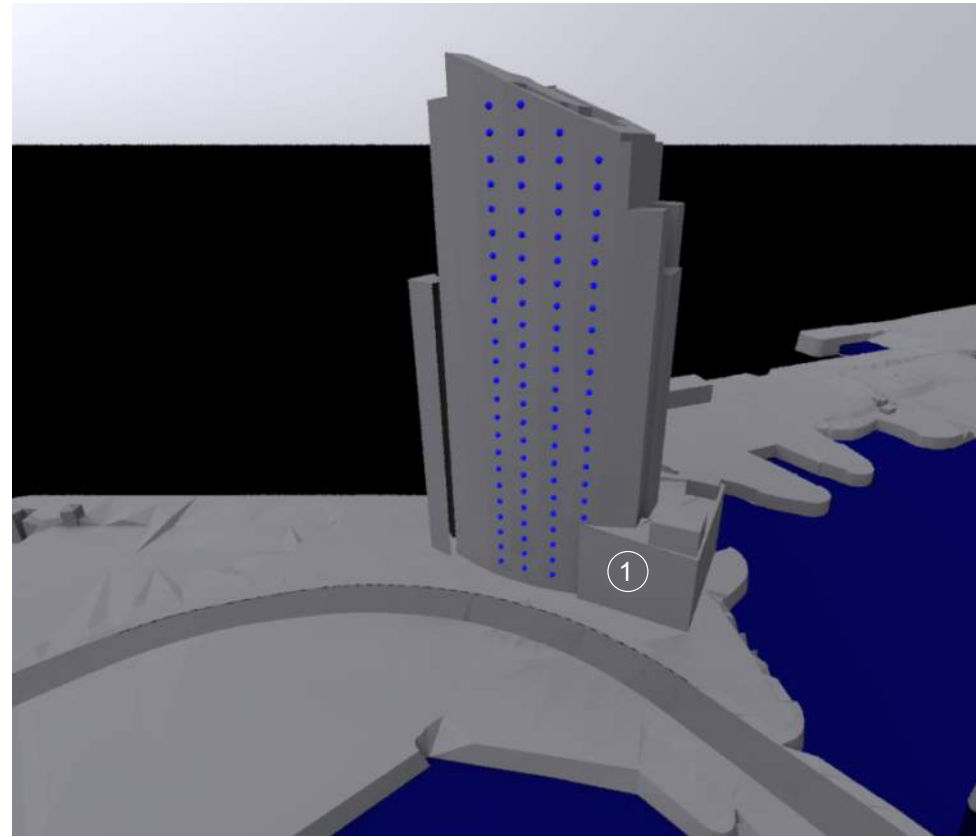

Development Scenario 2

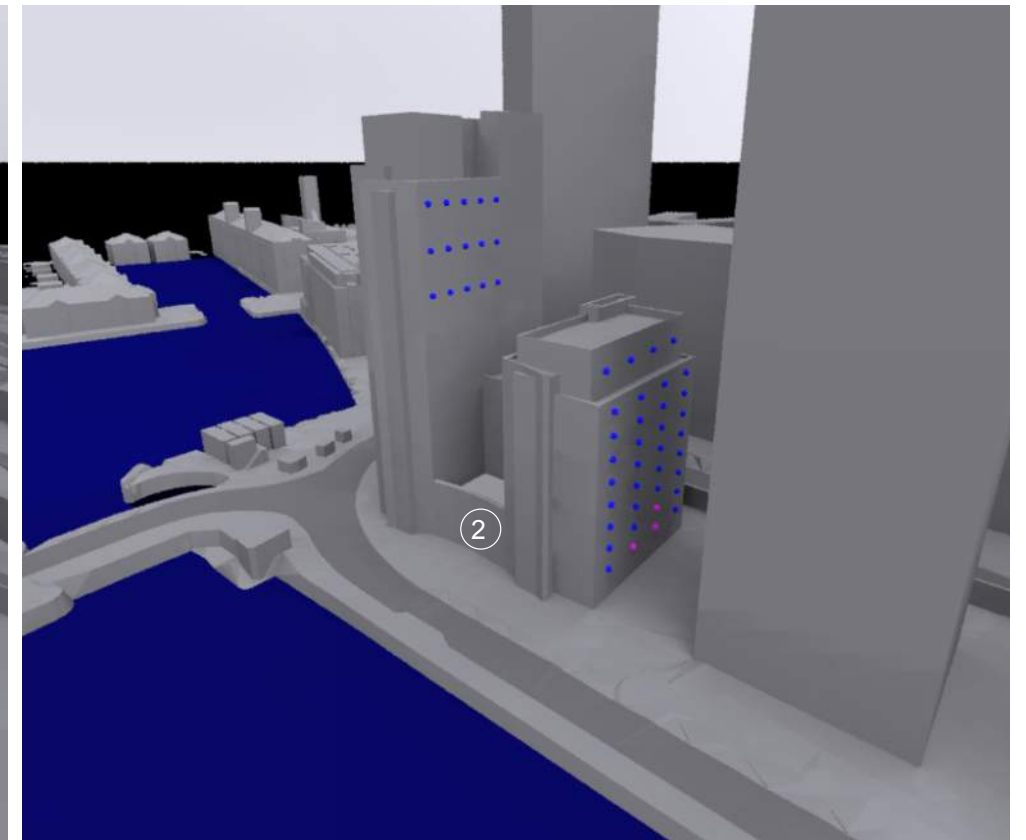
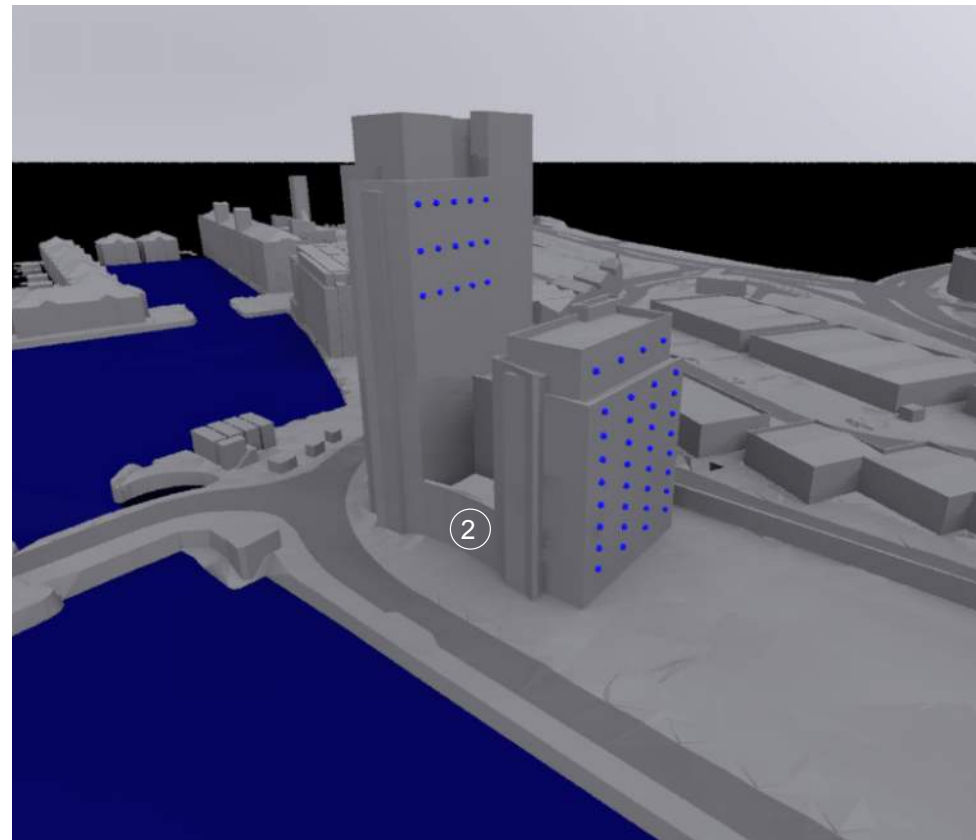
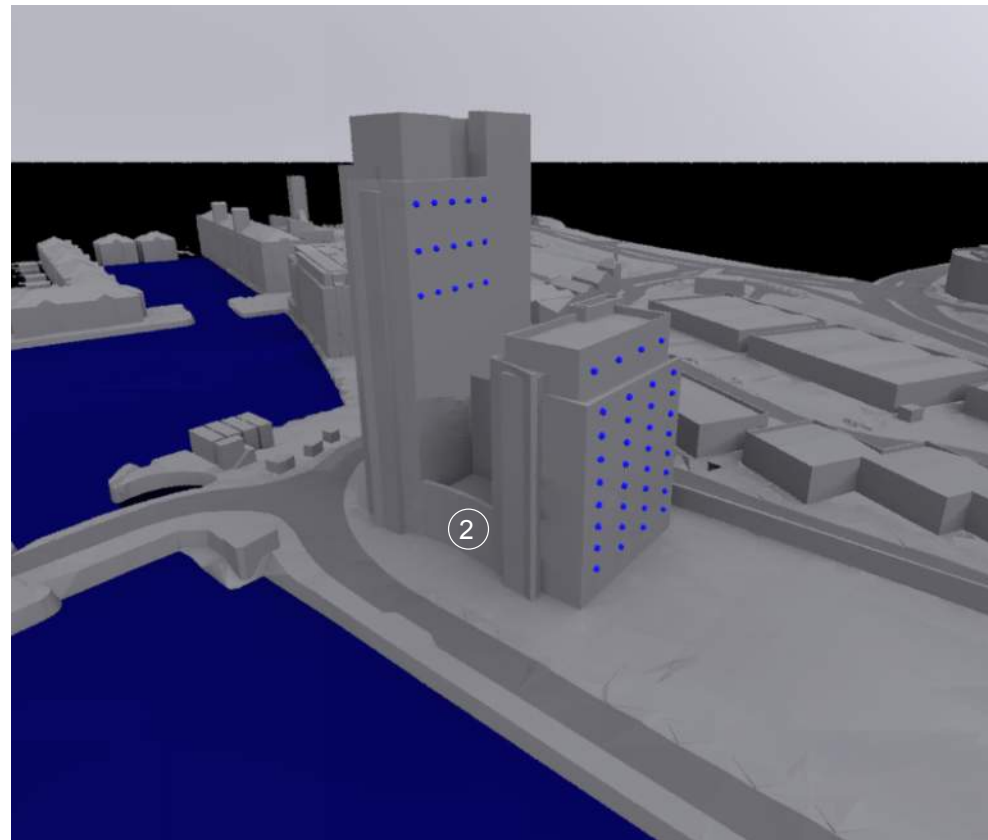
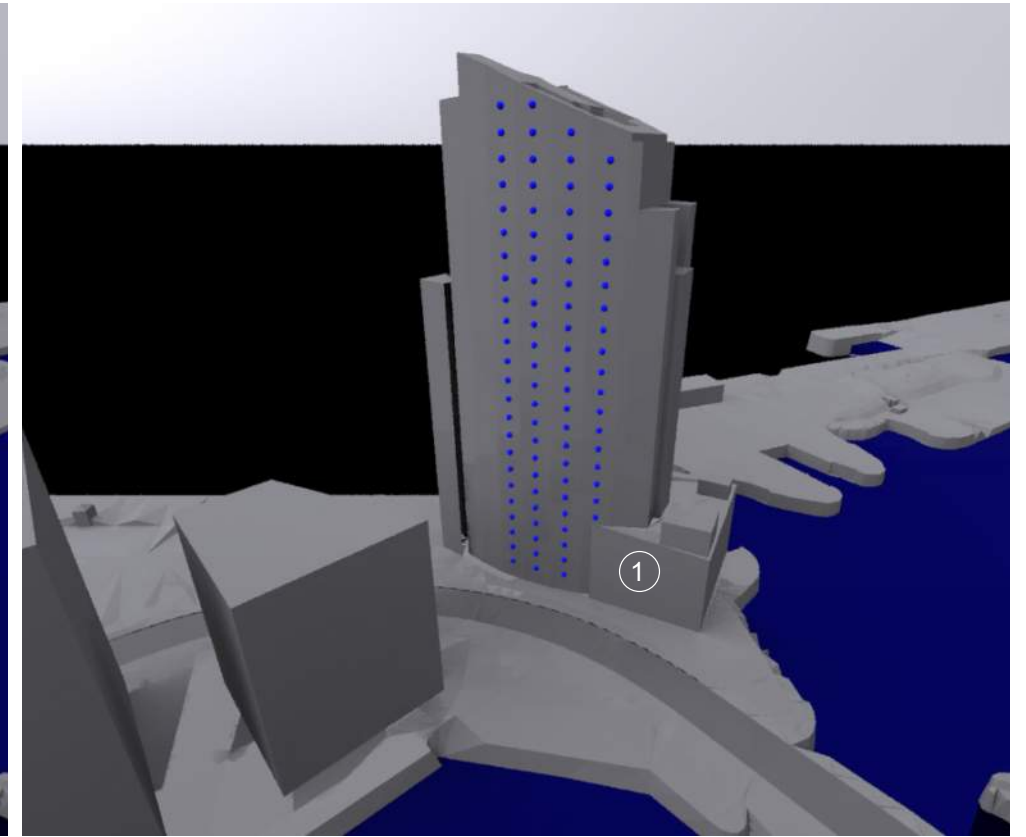

Note: Windows are only considered where they face within 90° of due south.

### Building References:

(1) Alexandra Tower, (2) No. 1 Princes Dock, (3) No. 20-24 Gibraltar Way, (4) No. 14-18 Gibraltar Way, (5) No. 10-12 Gibraltar Way, (6) No. 04-08 Gibraltar Way, (7) Radisson Hotel (8) HM Passport Office, (9) West Tower, (10) Metropolitan House, (11) Liverpool Echo Offices, (12) No. 10 Princes Parade, (13) No. 12 Princes Parade,



Sunlight Availability (APSH)

Baseline Scenario

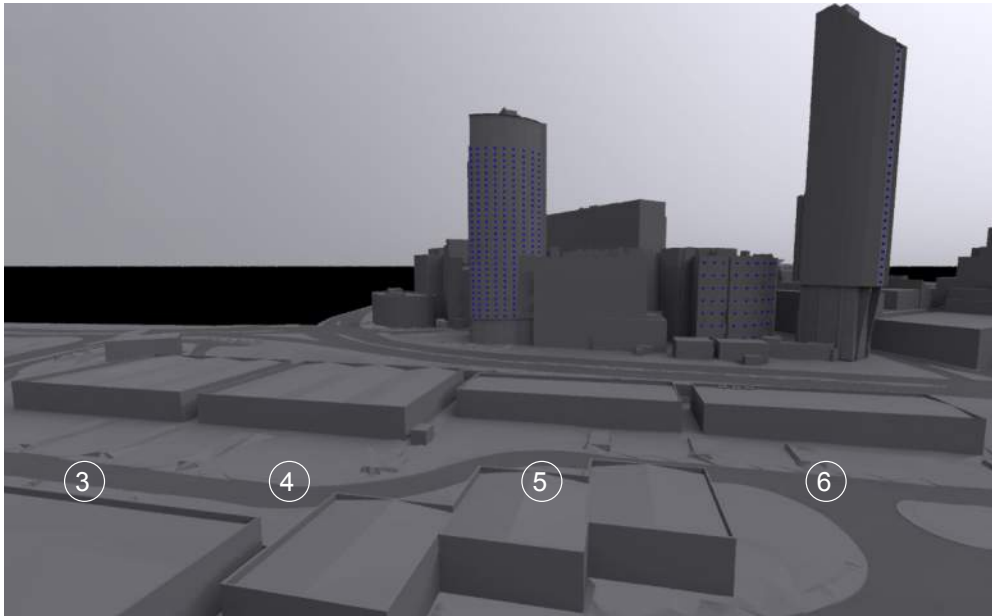

Development Scenario 1

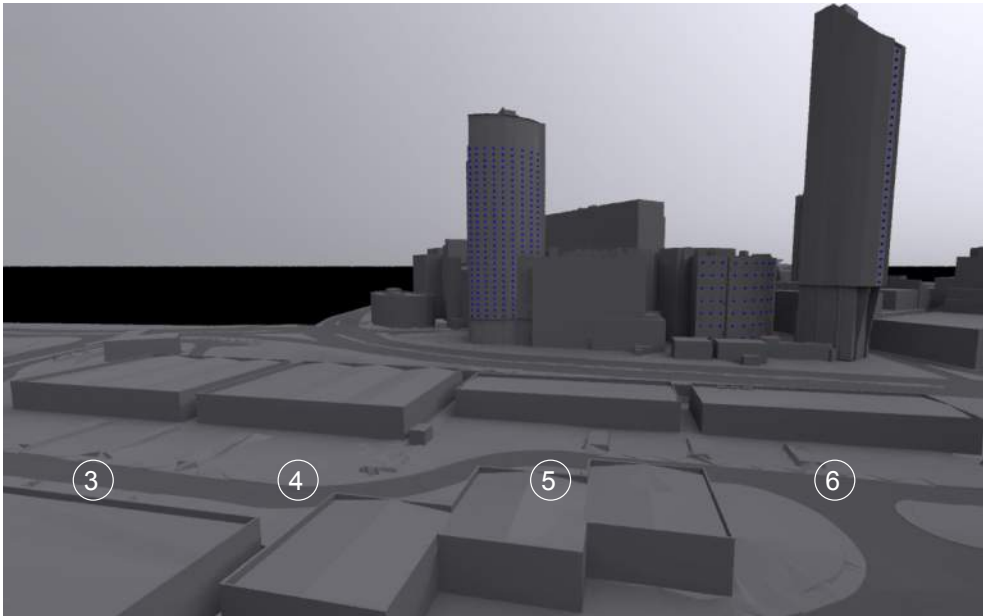

Development Scenario 2

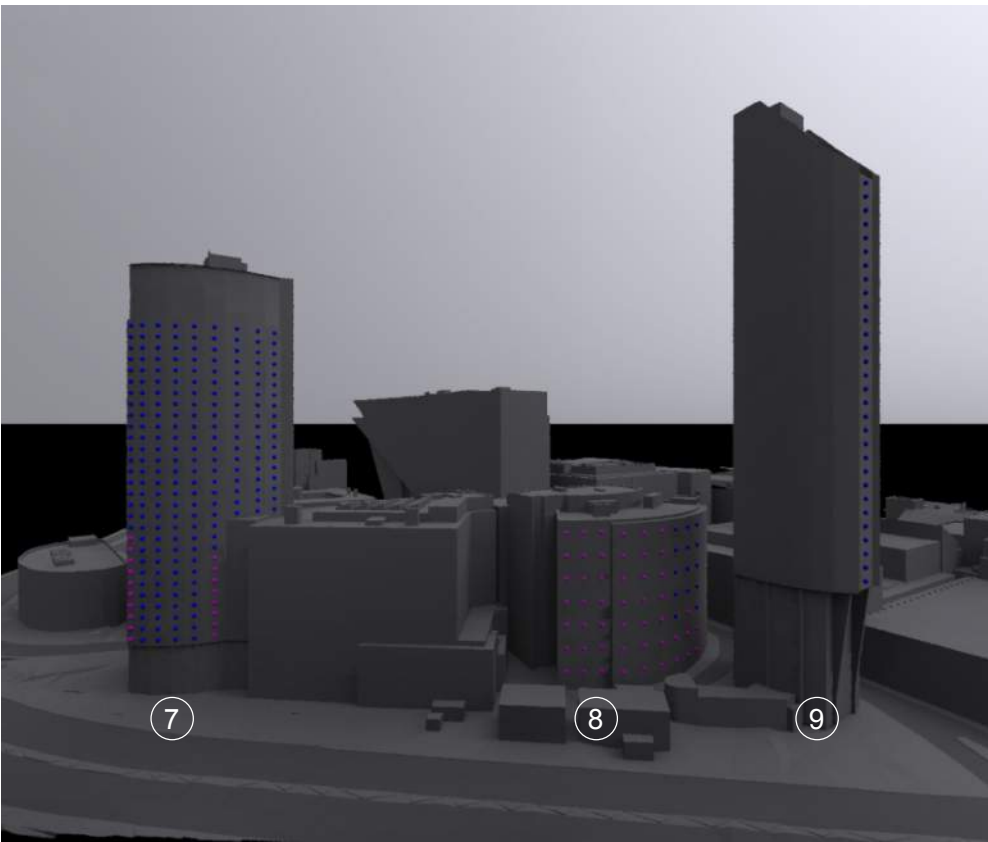
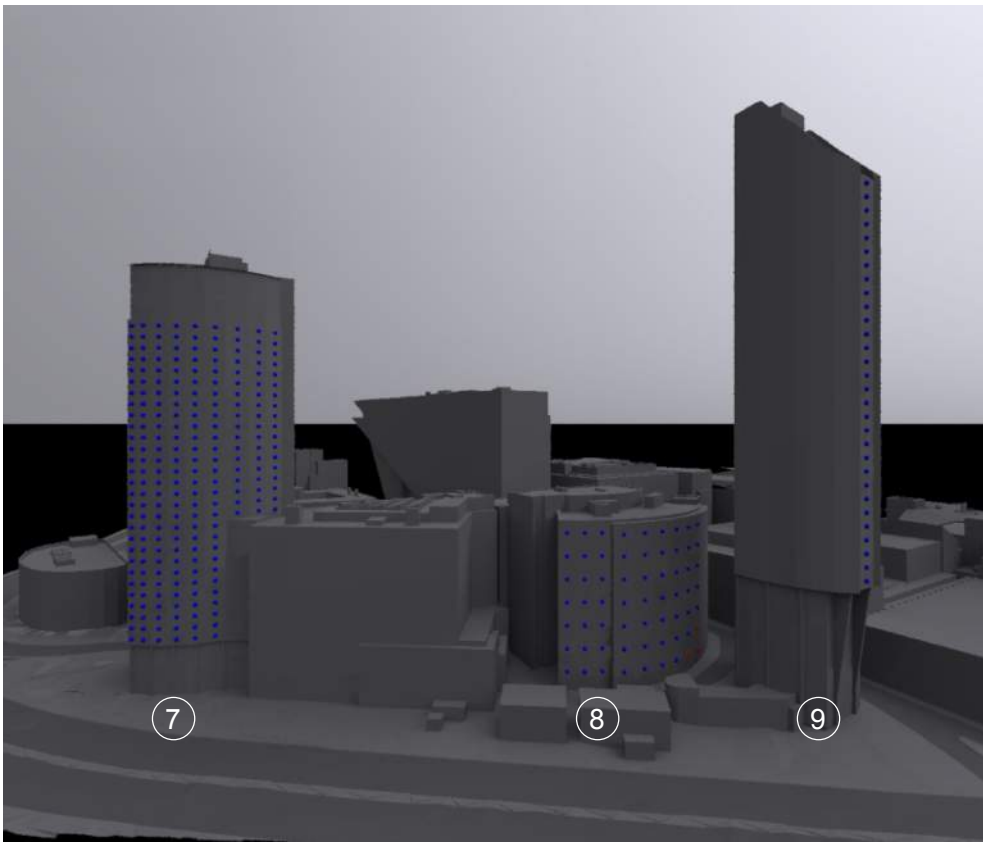
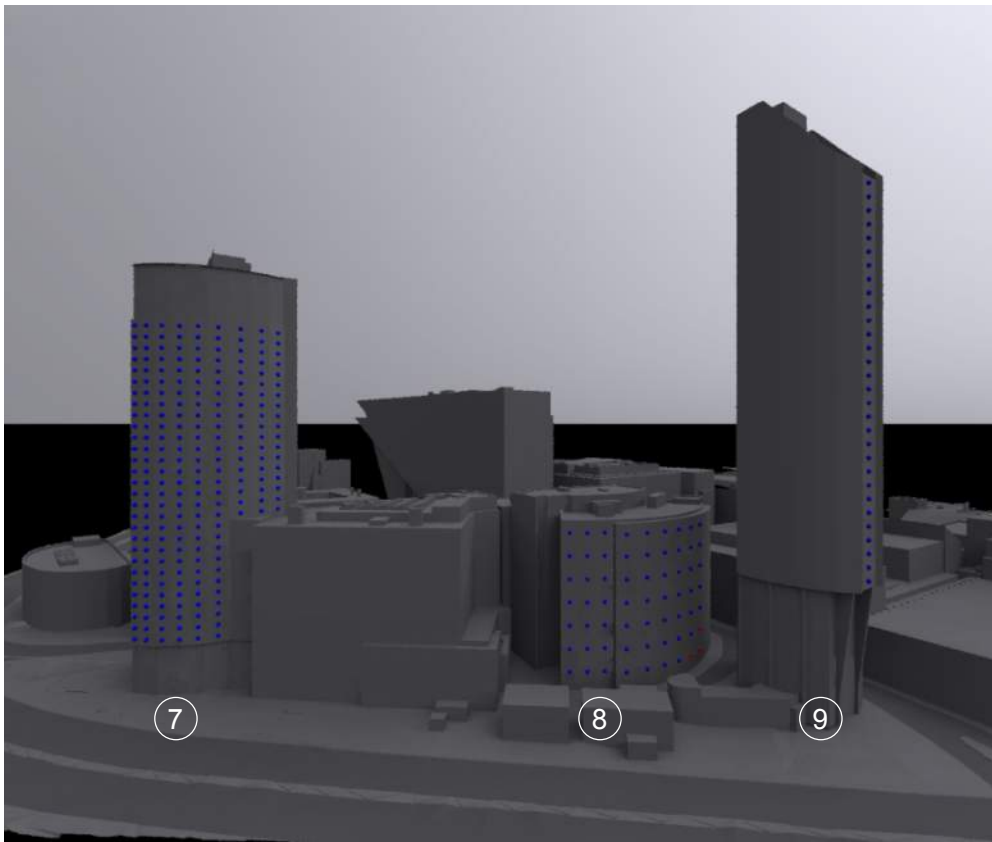
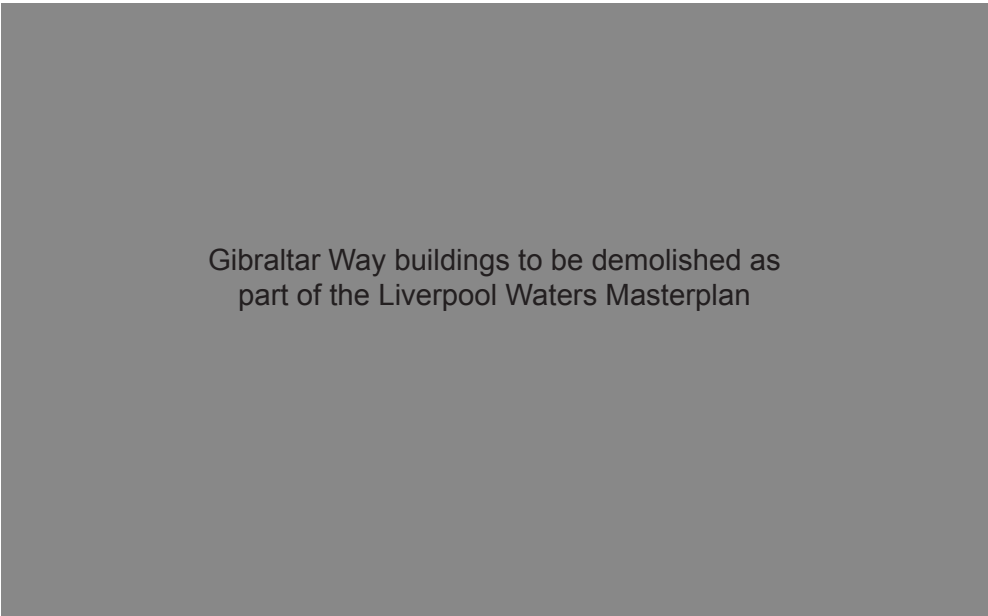

Note: Windows are only considered where they face within 90° of due south.

Building References:

(1) Alexandra Tower, (2) No. 1 Princes Dock, (3) No. 20-24 Gibraltar Way, (4) No. 14-18 Gibraltar Way, (5) No. 10-12 Gibraltar Way, (6) No. 04-08 Gibraltar Way, (7) Radisson Hotel (8) HM Passport Office, (9) West Tower, (10) Metropolitan House, (11) Liverpool Echo Offices, (12) No. 10 Princes Parade, (13) No. 12 Princes Parade,





Sunlight Availability (APSH)

Baseline Scenario

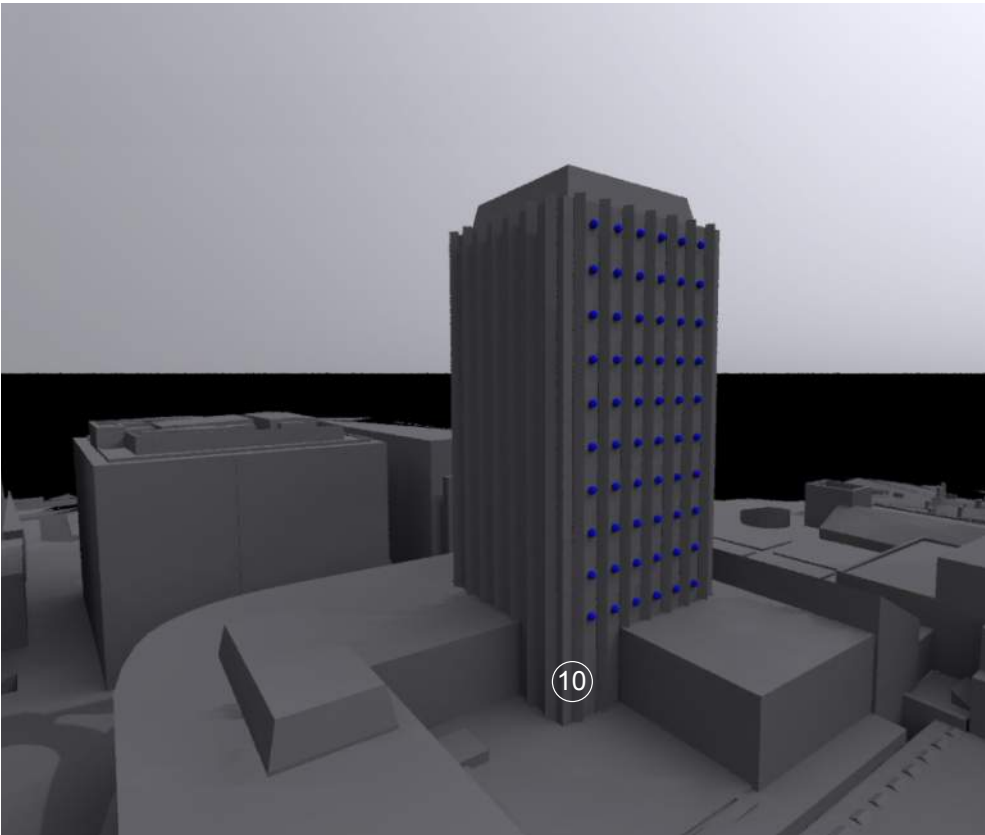

Development Scenario 1

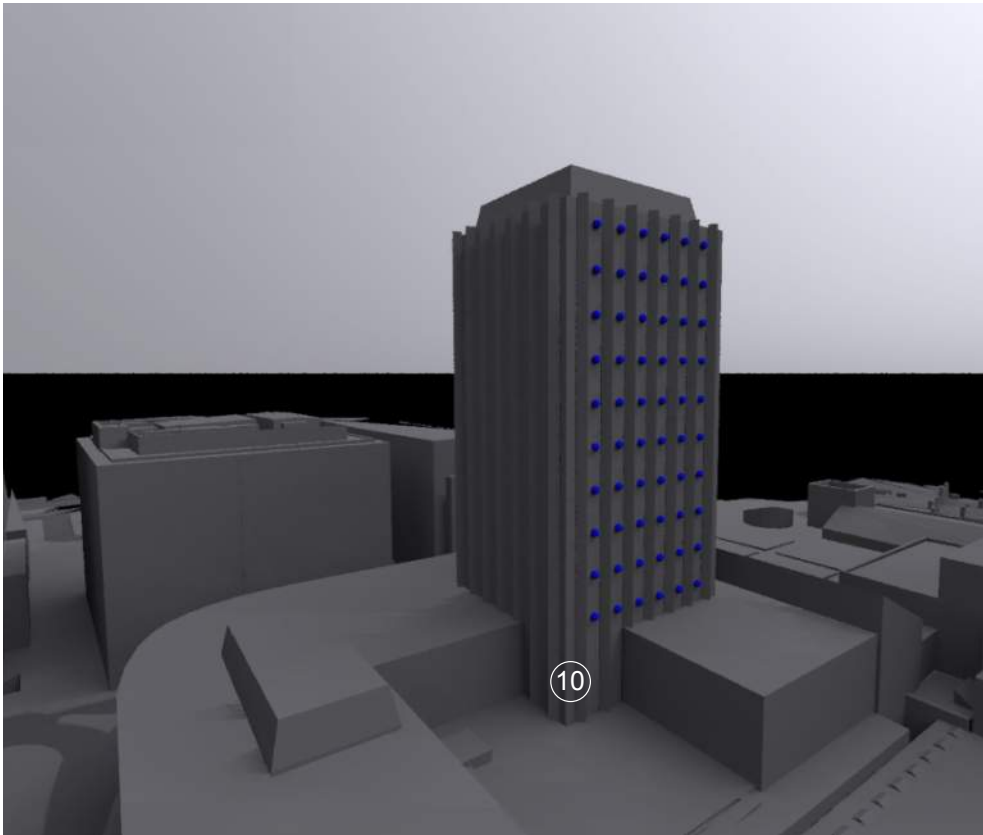

Development Scenario 2

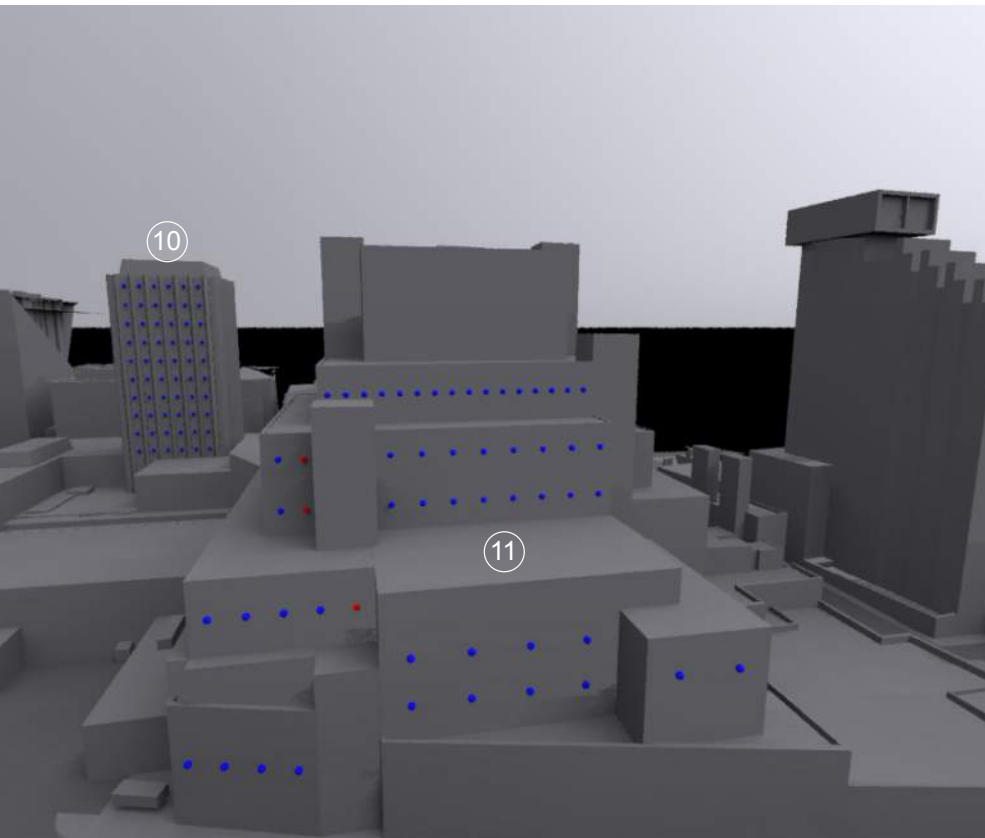
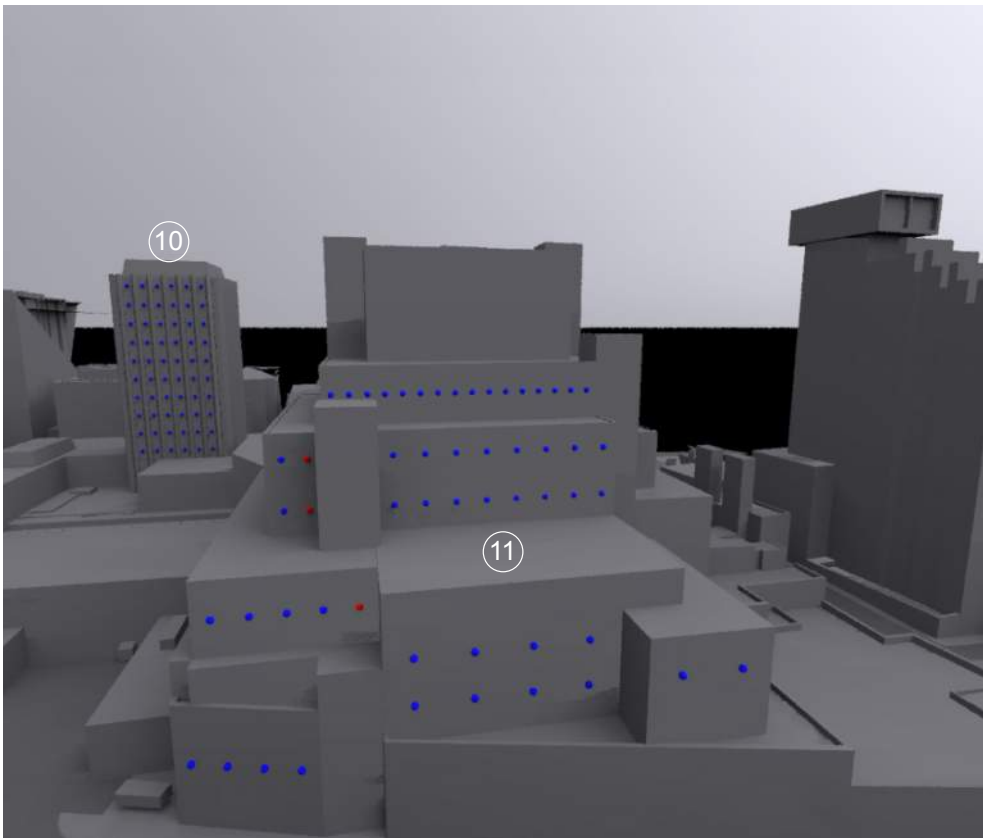
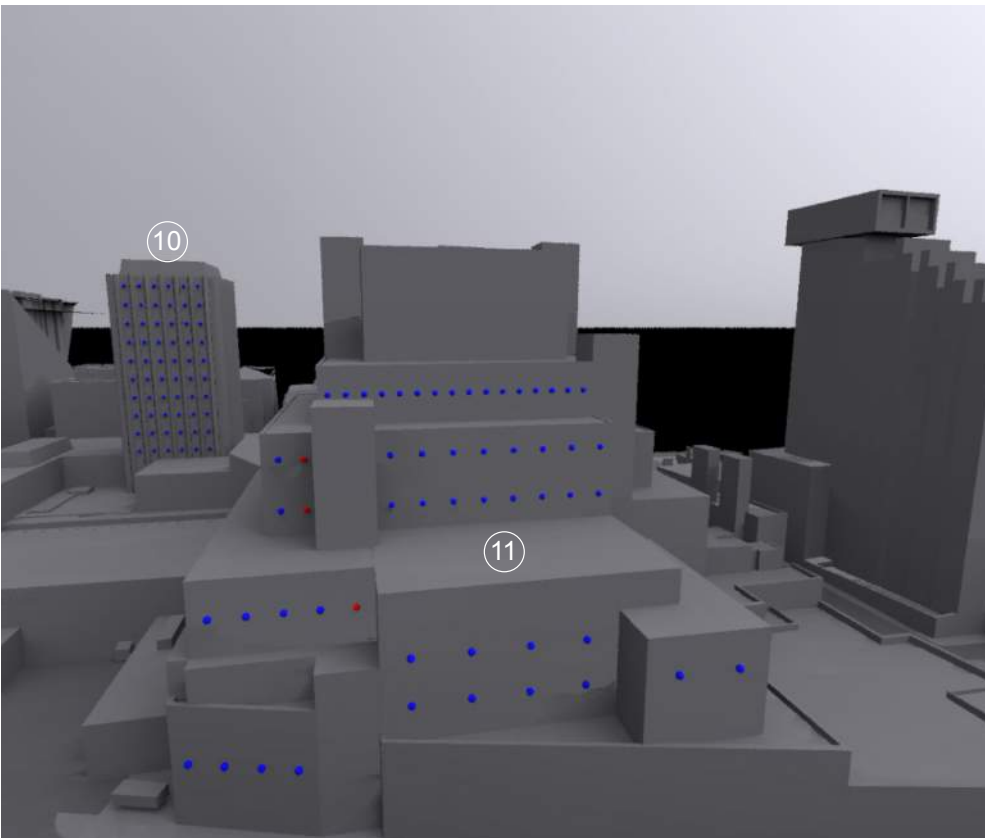
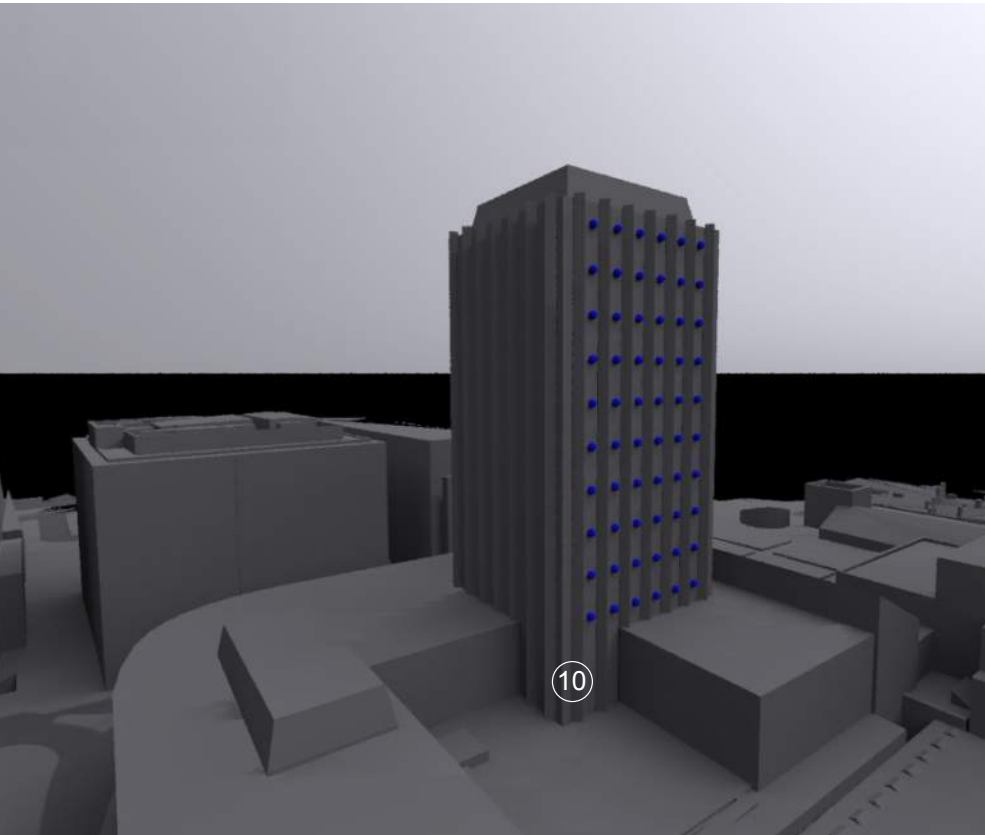

Note: Windows are only considered where they face within 90° of due south.

Building References:

(1) Alexandra Tower, (2) No. 1 Princes Dock, (3) No. 20-24 Gibraltar Way, (4) No. 14-18 Gibraltar Way, (5) No. 10-12 Gibraltar Way, (6) No. 04-08 Gibraltar Way, (7) Radisson Hotel (8) HM Passport Office, (9) West Tower, (10) Metropolitan House, (11) Liverpool Echo Offices, (12) No. 10 Princes Parade, (13) No. 12 Princes Parade,





Sunlight Availability (APSH)

Baseline Scenario

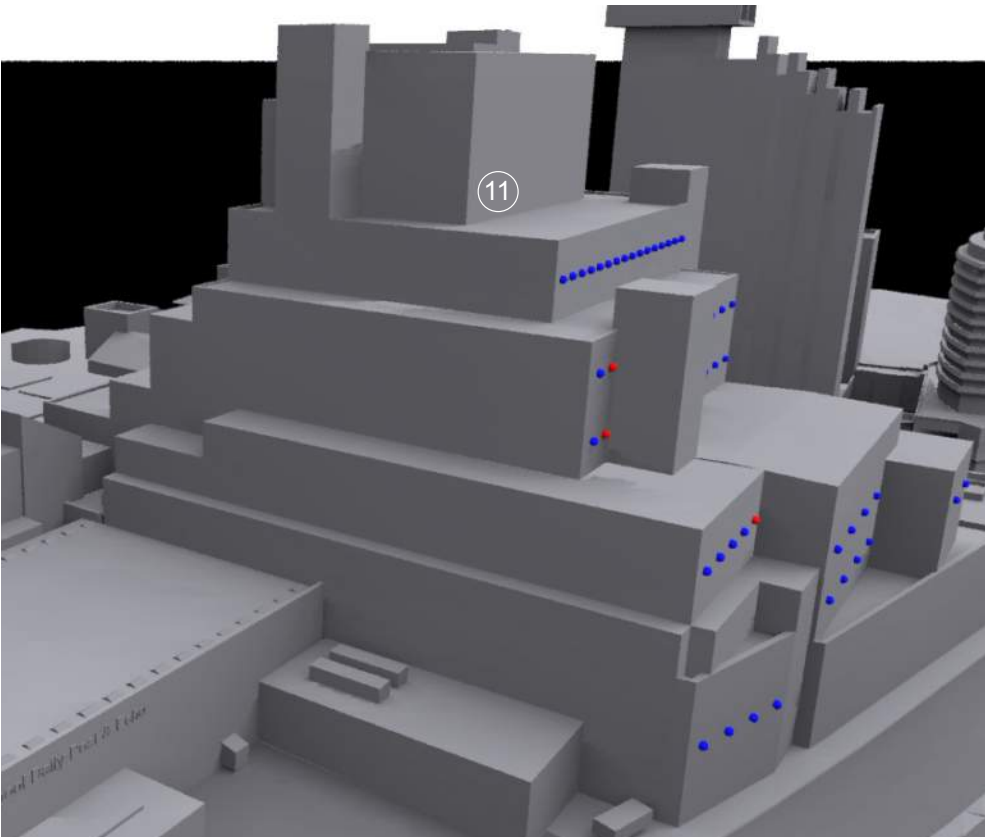

Development Scenario 1

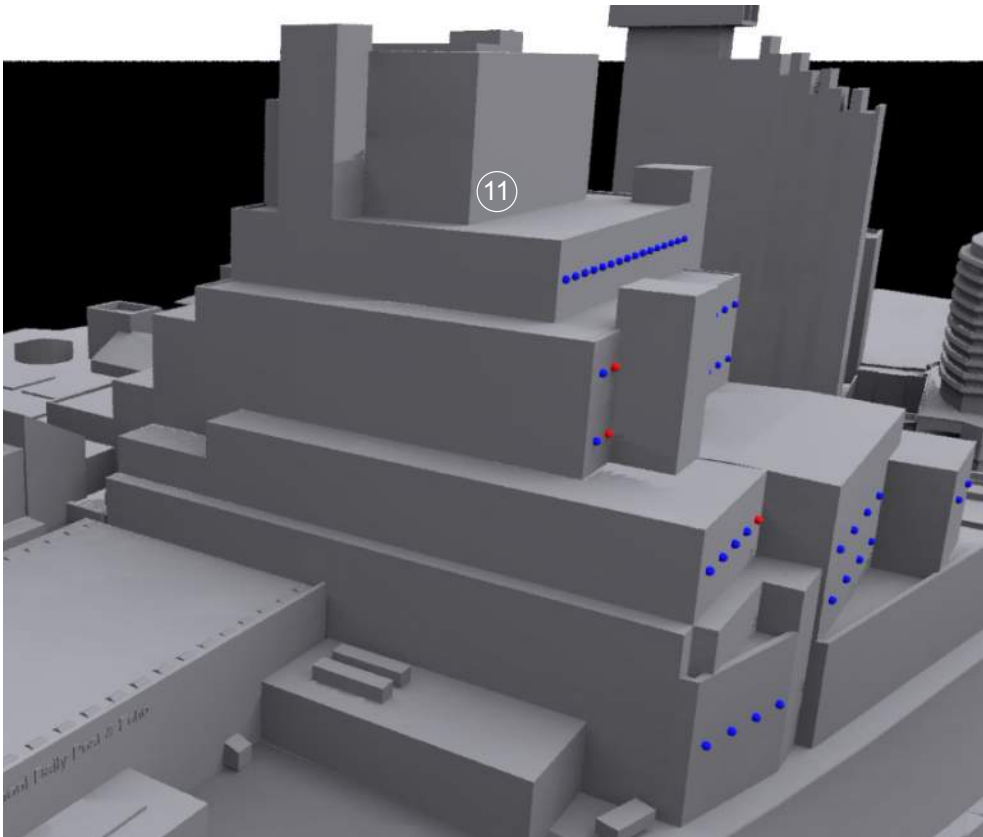

Development Scenario 2

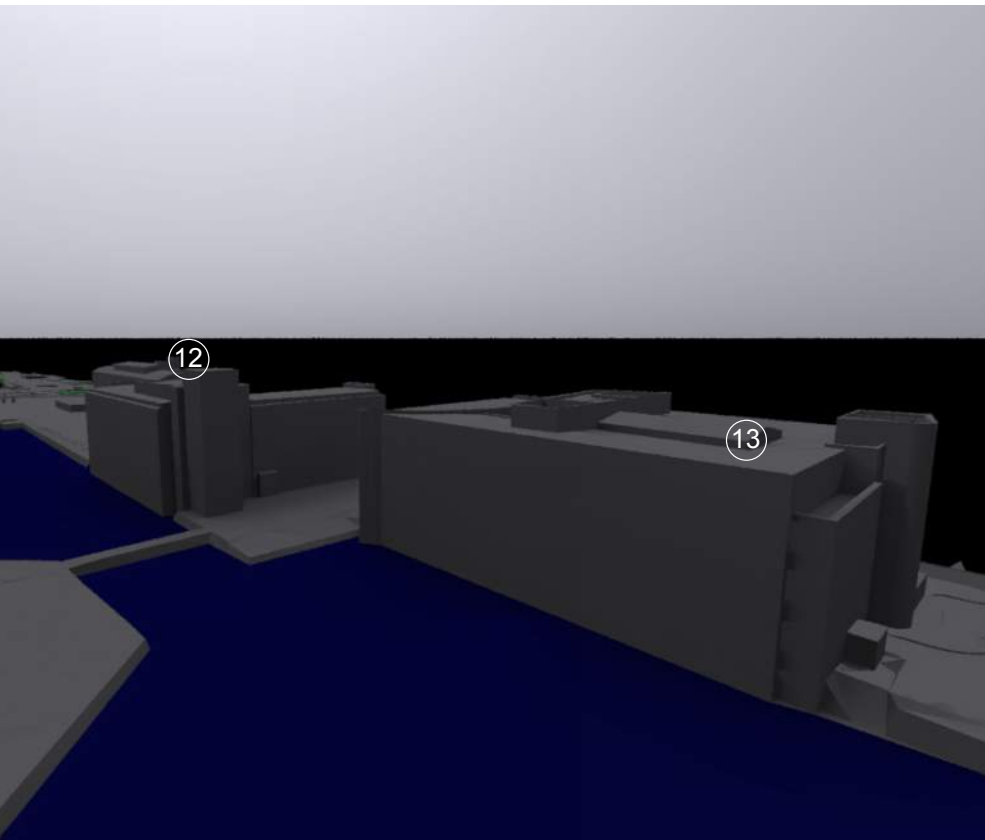
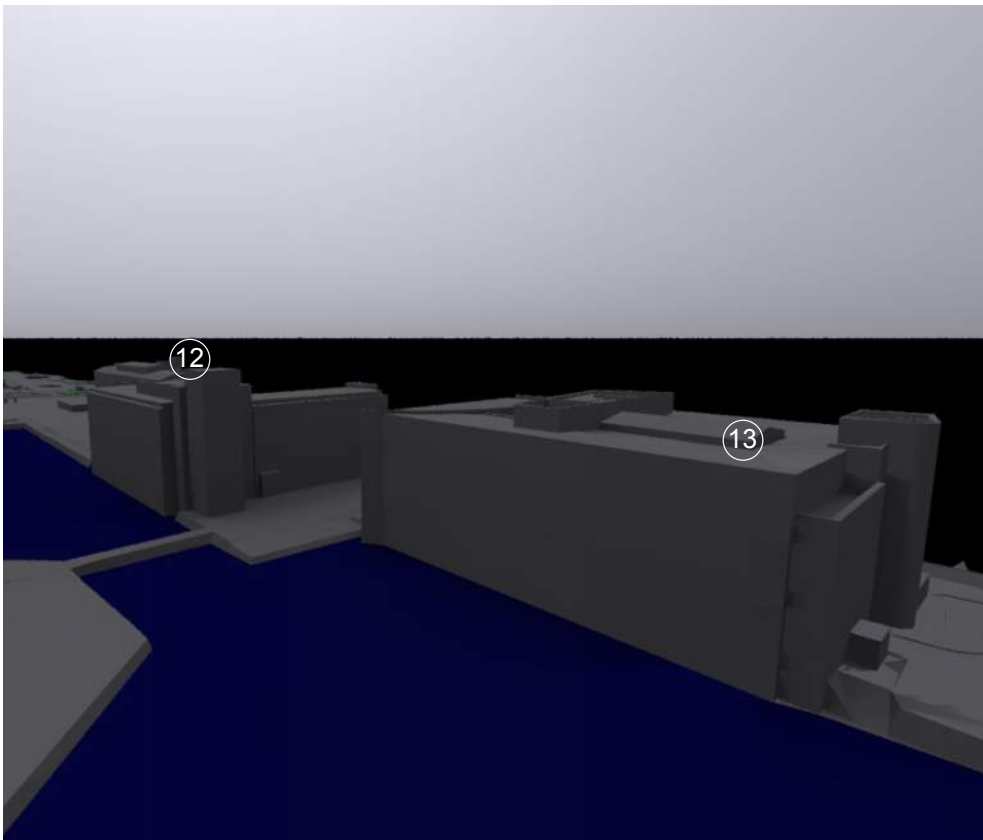
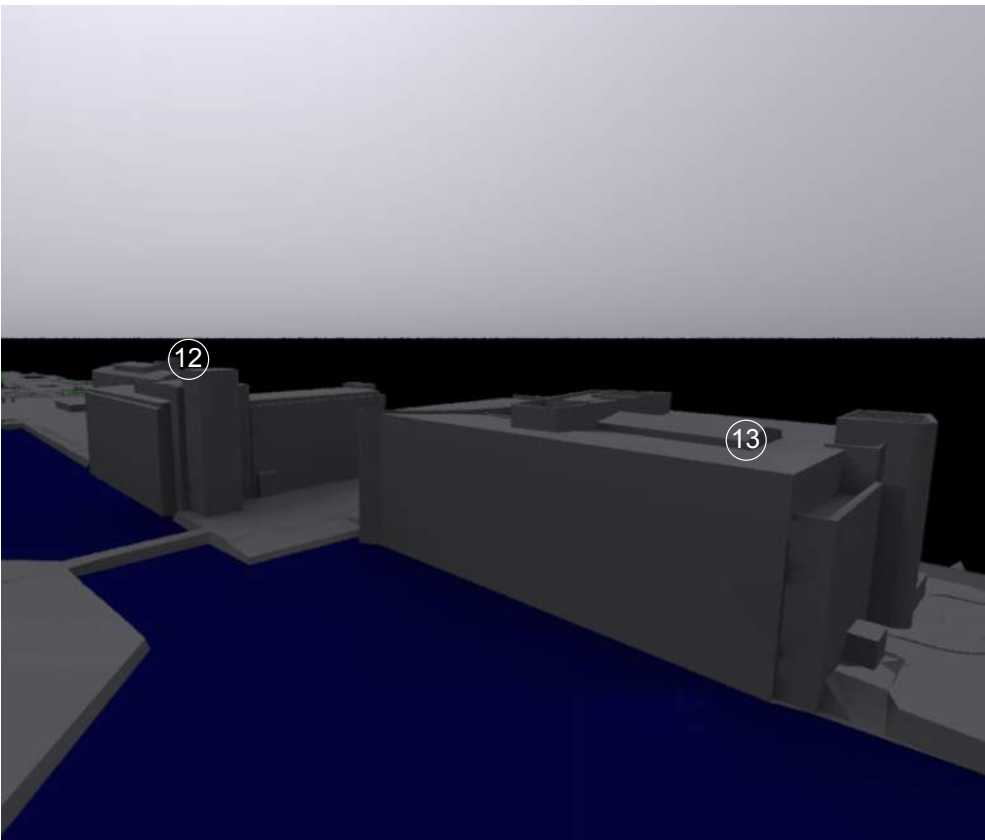
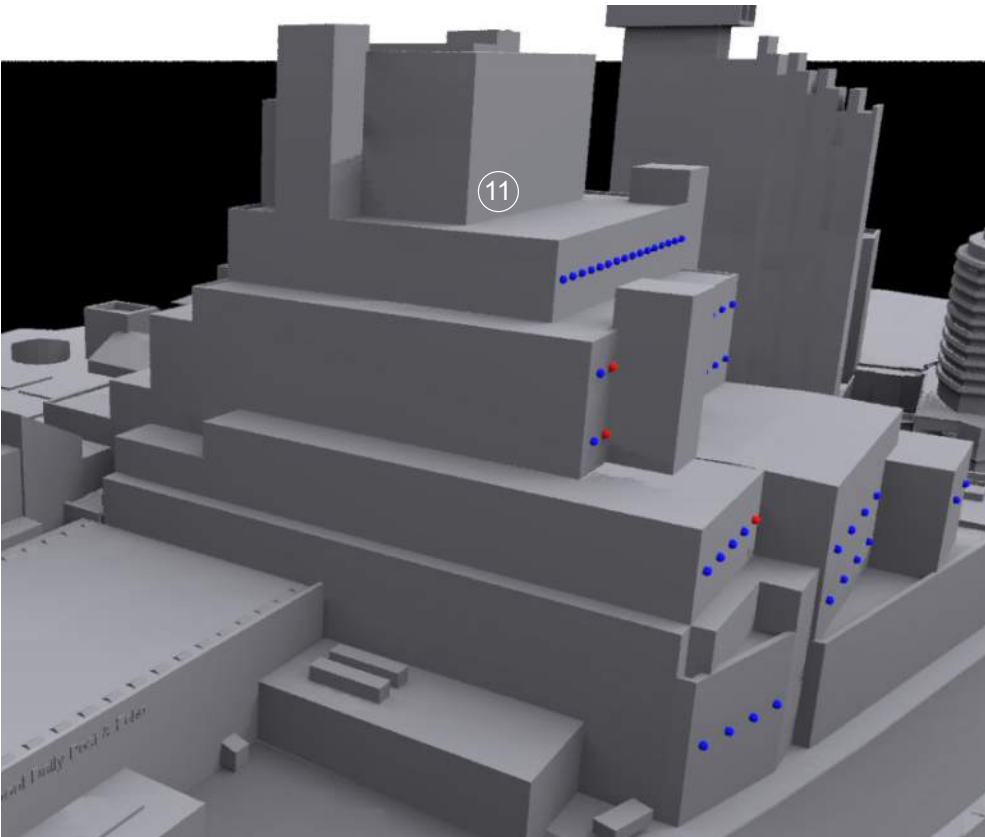

Note: Windows are only considered where they face within 90° of due south.

Building References:

(1) Alexandra Tower, (2) No. 1 Princes Dock, (3) No. 20-24 Gibraltar Way,(4) No. 14-18 Gibraltar Way, (5) No. 10-12 Gibraltar Way, (6) No. 04-08 Gibraltar Way, (7) Radisson Hotel (8) HM Passport Office, (9) West Tower, (10) Metropolitan House, (11) Liverpool Echo Offices, (12) No. 10 Princes Parade, (13) No. 12 Princes Parade,





## Amenity Space Sunlight Exposure (21 March clear sky)

Baseline Scenario

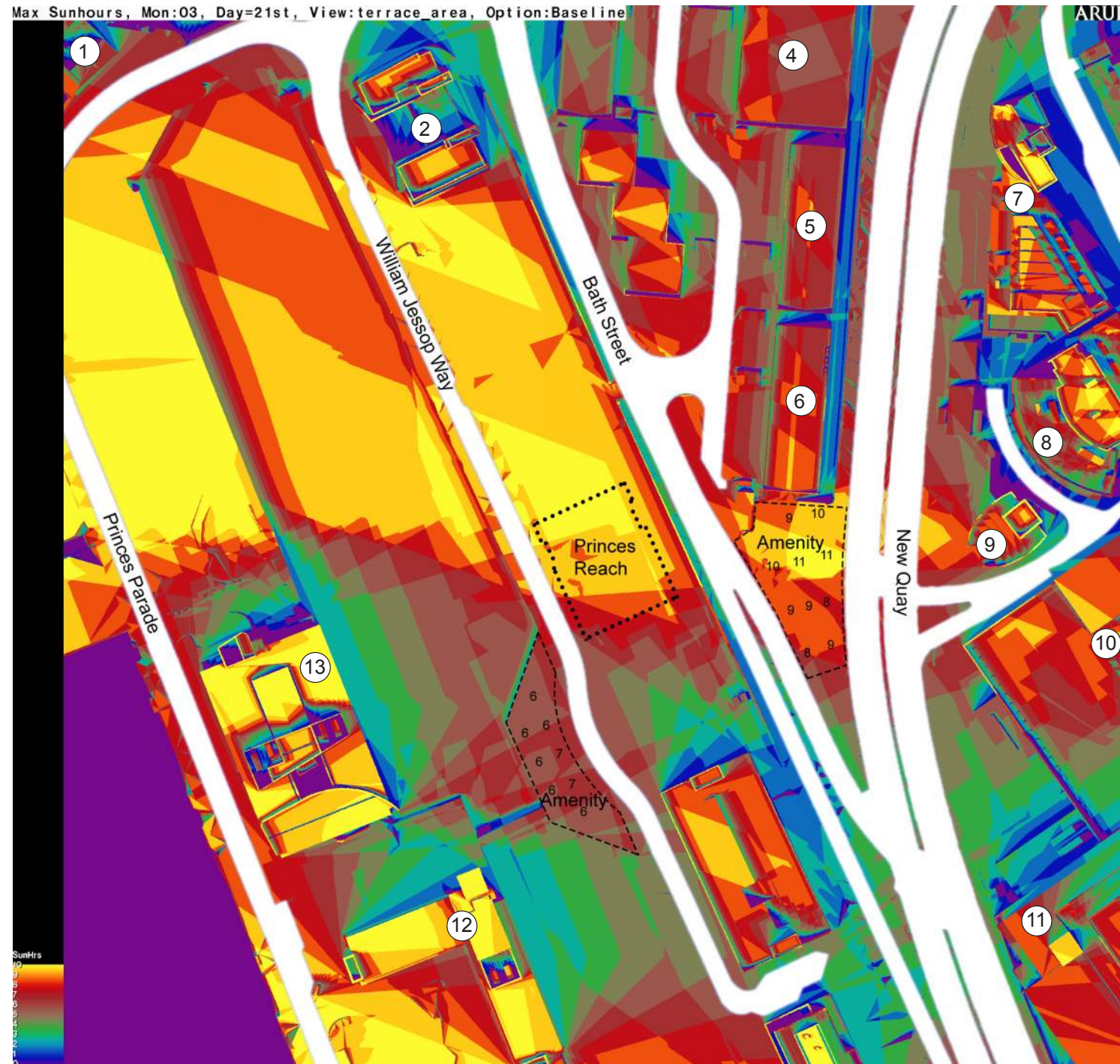

Development Scenario 1

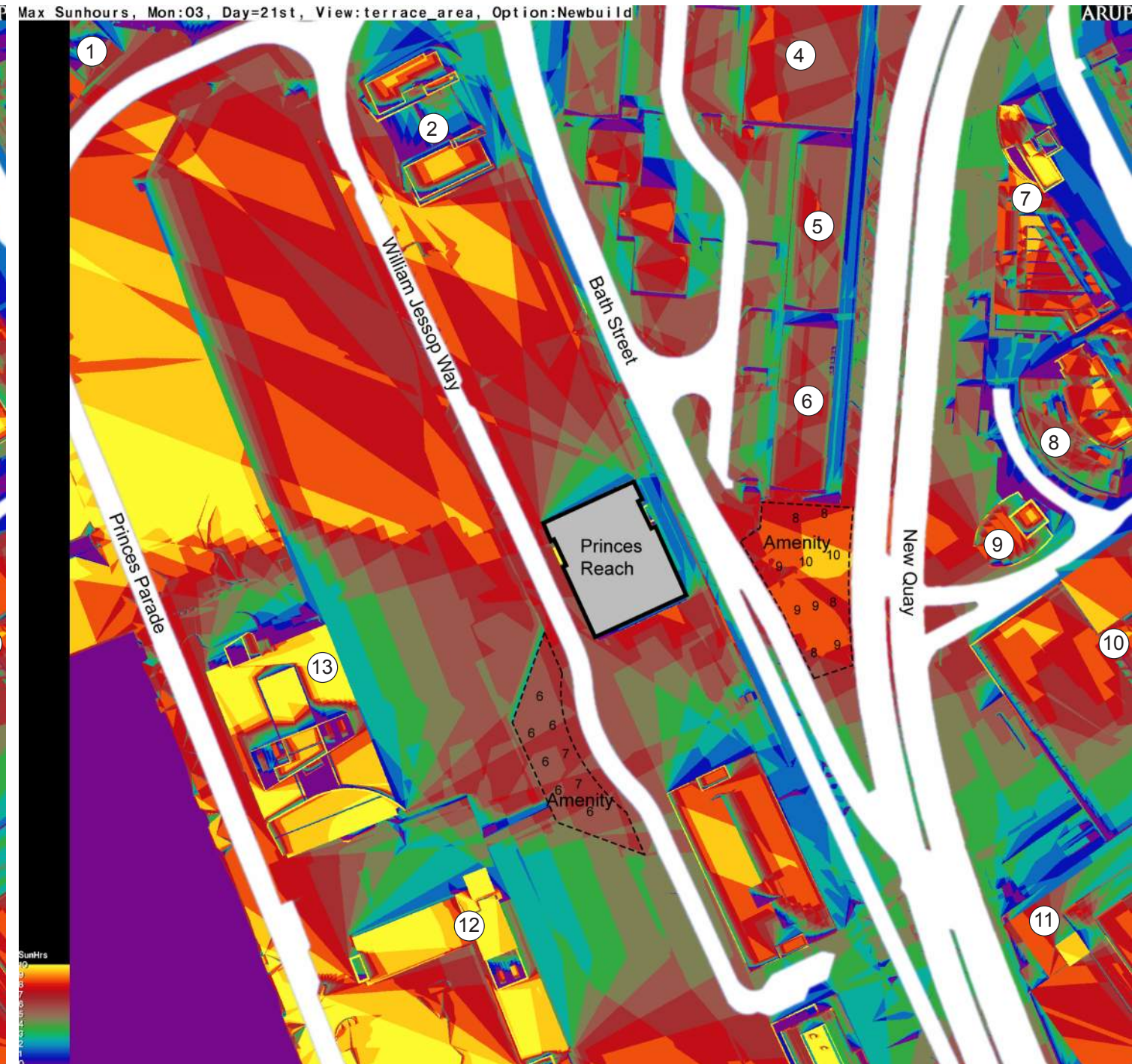

### Building References:

(1) Alexandra Tower, (2) No. 1 Princes Dock, (3) No. 20-24 Gibraltar Way, (4) No. 14-18 Gibraltar Way, (5) No. 10-12 Gibraltar Way, (6) No. 04-08 Gibraltar Way, (7) Radisson Hotel (8) HM Passport Office, (9) West Tower, (10) Metropolitan House, (11) Liverpool Echo Offices, (12) No. 10 Princes Parade, (13) No. 12 Princes Parade,



## Amenity Space Sunlight Exposure (21 March clear sky)

Baseline Scenario

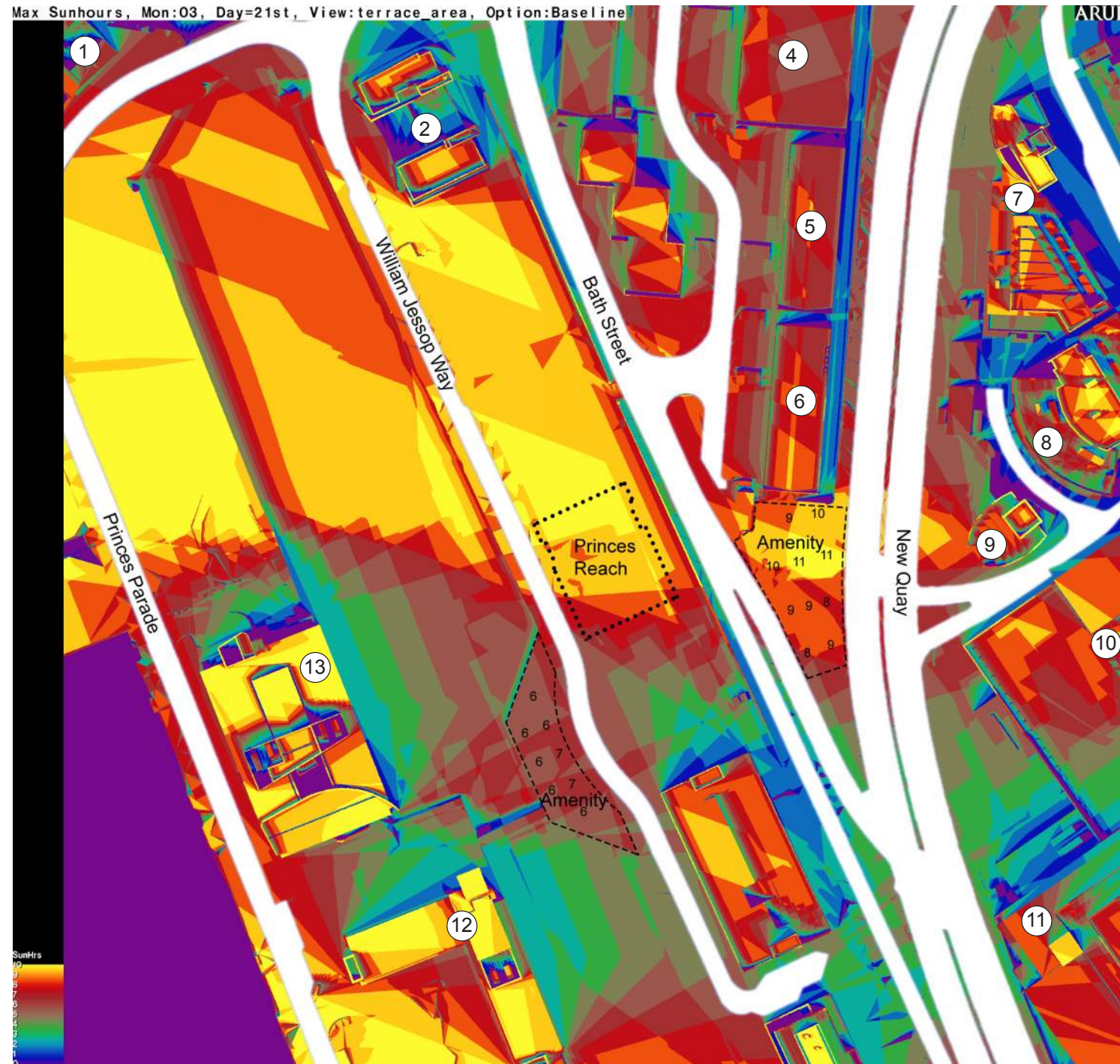

Development Scenario 2

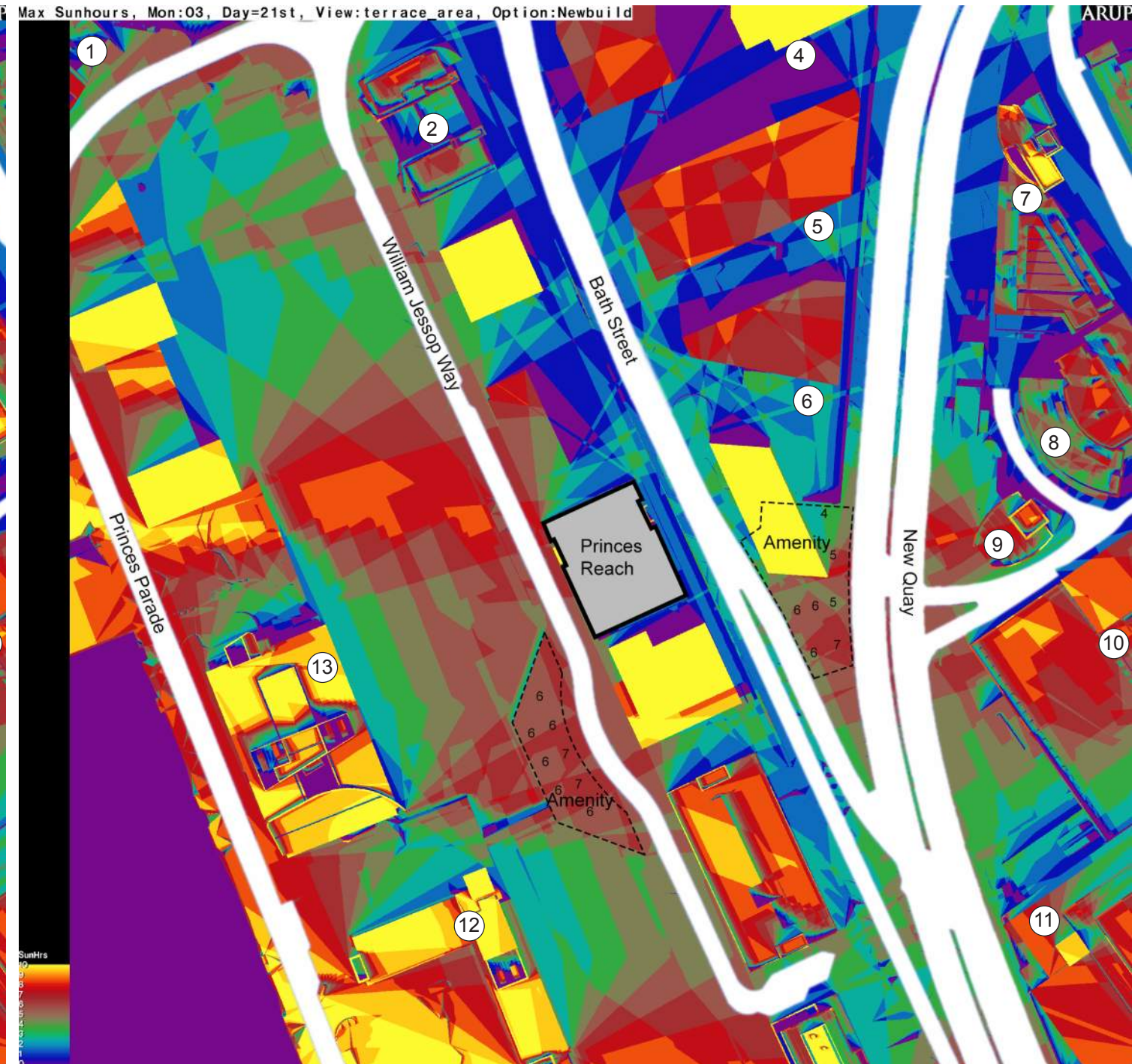

### Building References:

(1) Alexandra Tower, (2) No. 1 Princes Dock, (3) No. 20-24 Gibraltar Way, (4) No. 14-18 Gibraltar Way, (5) No. 10-12 Gibraltar Way, (6) No. 04-08 Gibraltar Way, (7) Radisson Hotel (8) HM Passport Office, (9) West Tower, (10) Metropolitan House, (11) Liverpool Echo Offices, (12) No. 10 Princes Parade, (13) No. 12 Princes Parade,