

BHC2001

BHC2004

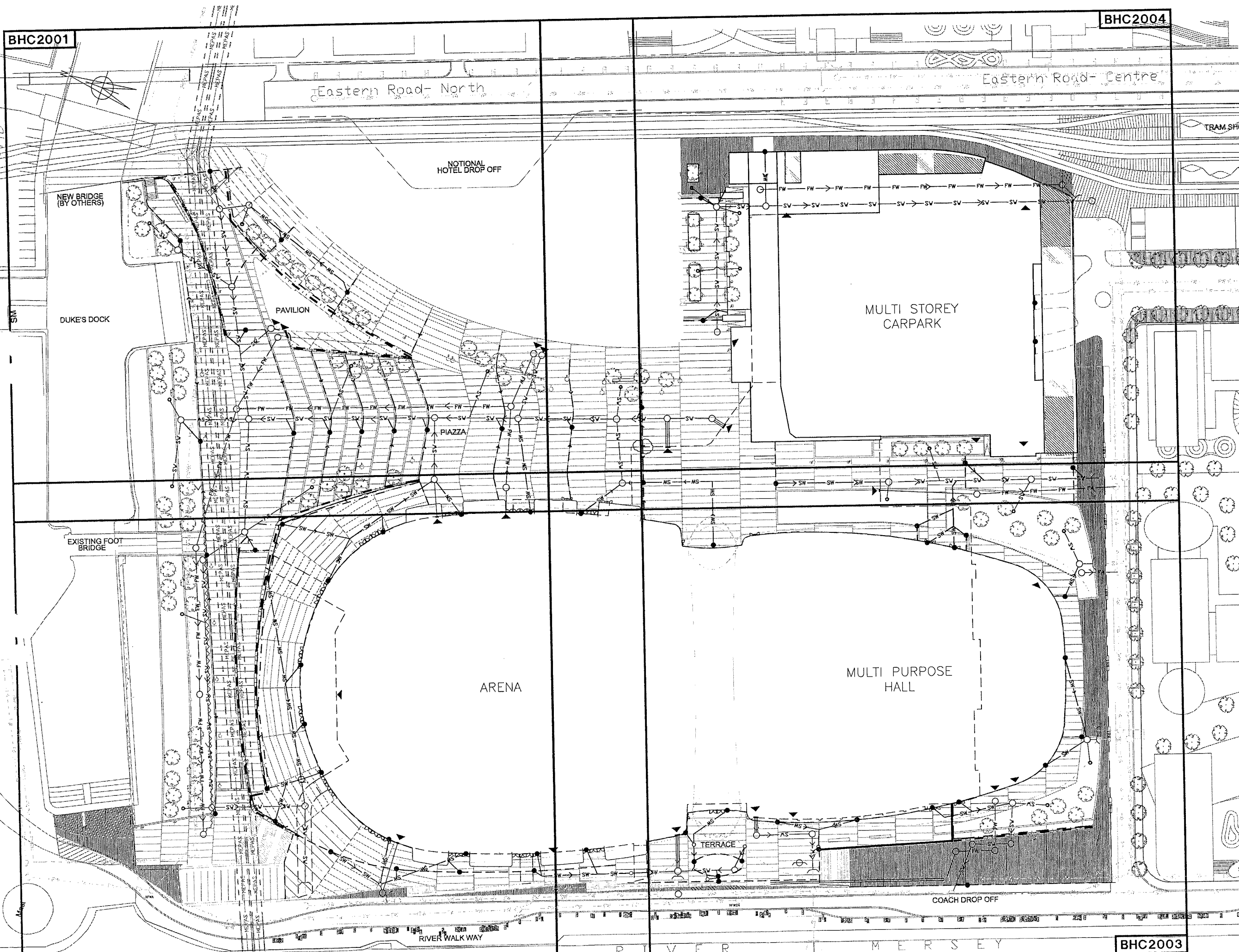

DO NOT SCALE THIS DRAWING

Notes

- DO NOT SCALE FROM THIS DRAWING.
- REFER TO DRG BHC2020-21 FOR STANDARD DETAILS.
- REFER TO MANHOLE SCHEDULE FOR MANHOLE AND INVERT LEVEL INFORMATION.
- REFER TO BHC1500 AND BHC1510 FOR EXISTING DRAINAGE AND ABANDONMENT WORKS.
- REFER TO BHC2030 FOR LINEAR DRAINAGE NETWORK DETAILS.
- REFER TO BHC3000 SERIES DRAWINGS FOR BELOW SLAB DRAINAGE.
- LANDSCAPE DRAINAGE BY OTHERS.
- PROPOSED DRAINAGE CONNECTIONS AWAITING CONFIRMATION FROM MASTERPLAN AND UNITED UTILITIES APPROVAL.
- POSITION OF DRAINAGE LINES AND MANHOLES TO BE CONFIRMED WITH LANDSCAPE ARCHITECT.
- "MERSEY ESTUARY POLLUTION ALLEVIATION SCHEME" (MEPAS).
WARNING: MEPAS TWIN 2700mm SEWERS LOCATED AS SHOWN. CONTRACTOR IS TO FAMILIARISE HIMSELF WITH SEWER LOCATION AND ASSOCIATED CONTROL EQUIPMENT. ALL WORK WITHIN IMMEDIATE VICINITY TO BE DISCUSSED WITH UNITED UTILITIES AND APPROVED PRIOR TO COMMENCEMENT.

LEGEND

- PROPOSED EXTERNAL MANHOLE
- SV → SV PROPOSED SURFACE WATER
- FW → FW PROPOSED FOUL WATER
- FM → FM EXISTING FOUL RISING MAIN
- ▲ BUILDING DISCHARGE POINT (REFER TO BHC3000 SERIES)
- INDICATIVE LANDSCAPE DRAINAGE CATCHPIT (INCOMING LANDSCAPE DRAINAGE BY OTHERS)
- LINEAR DRAINAGE SUMP
- LINEAR DRAINAGE (REFER TO BHC 2030)
- PERFORATED DRAIN FROM RETAINING WALLS
- CONNECTION TO SEWERS

02	FOR TENDER	13.06.05	RMAB
01	TENDER ISSUE	12.05.05	RMAB
00	ORIGINAL ISSUE	04.04.05	RMAB

Rev	Description	Date	Checked
-----	-------------	------	---------

FOR TENDER	JUNE 05
Issued only for purpose indicated	Date

17 Newman Street
London
W1P 3HD

Tel 0171 927 9700
Fax 0171 927 9701

Architect: WILKINSONEY ARCHITECTS

Project: KINGS WATERFRONT
PROPOSED DRAINAGE
GENERAL LAYOUT AND KEY PLAN

Buro Happold
Consulting Engineers

Scale: 1:500 @ A1	Job No. 008636
Drawn by: ASK	Drawing No. BHC2000
Checked by: RMAB	Rev. 02
Date: MAY 2005	

BHC2002

BHC2003

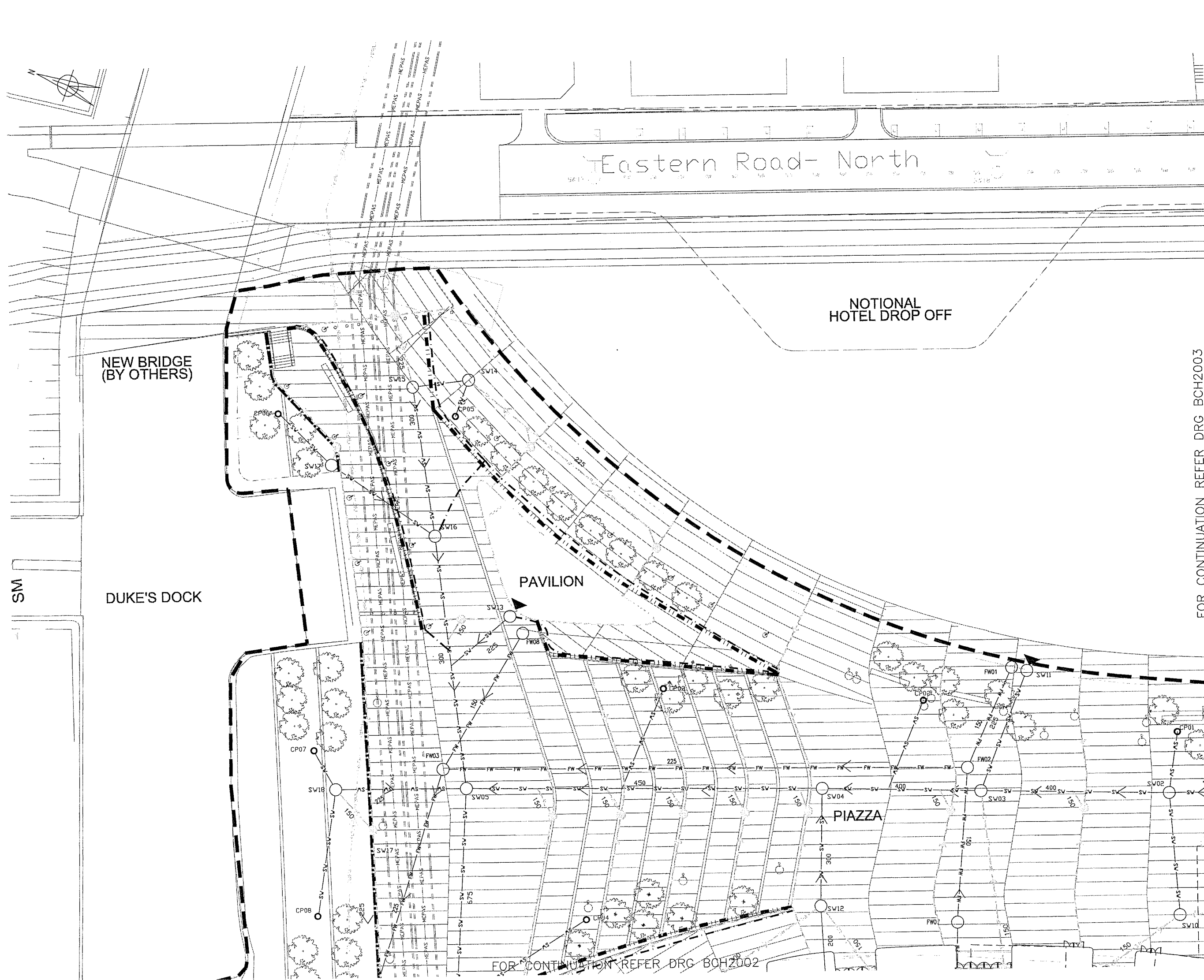

DO NOT SCALE THIS DRAWING

Notes

1. DO NOT SCALE FROM THIS DRAWING.
2. FOR GENERAL NOTES ON EXTERNAL DRAINAGE REFER TO BHC2000.
3. REFER TO DRG BHC2020-21 FOR STANDARD DETAILS.
4. REFER TO MANHOLE SCHEDULE FOR MANHOLE AND INVERT LEVEL INFORMATION.
5. LANDSCAPE DRAINAGE BY OTHERS.

LEGEND

- PROPOSED EXTERNAL MANHOLE
- SV— PROPOSED SURFACE WATER
- FW— PROPOSED FOUL WATER
- ... EXISTING FOUL RISING MAIN
- ▲ BUILDING DISCHARGE POINT (REFER TO BHC3000 SERIES)
- INDICATIVE LANDSCAPE DRAINAGE CATCHPIT (INCOMING LANDSCAPE DRAINAGE BY OTHERS)
- LINEAR DRAINAGE SUMP
- LINEAR DRAINAGE (REFER TO BHC 2030's SERIES)
- PERFORATED DRAIN FROM RETAINING WALLS
- ⌋ CONNECTION TO SEWERS

FOR CONTINUATION REFER DRG BCH2003

Rev	Description	Date	Checked
02	FOR TENDER	13.06.05	RMAB
01	TENDER ISSUE	12.05.05	RMAB
00	ORIGINAL ISSUE	04.04.05	RMAB

FOR TENDER
Issued only for purpose indicated

JUNE 05
Date

17 Newmen Street
London
W1P 3HD

Tel 0171 927 9700
Fax 0171 927 9701

Architect WILKINSONEYRE ARCHITECTS

Project KINGS WATERFRONT
EXTERNAL DRAINAGE LAYOUT
SHEET 1 OF 4

Scale 1:250 @ A1

Drawn by ASK

Checked by RMAB

Date MAY 2005

Job No. 008636

Drawing No. BHC2001

Rev 02

Buro Happold
Consulting Engineers

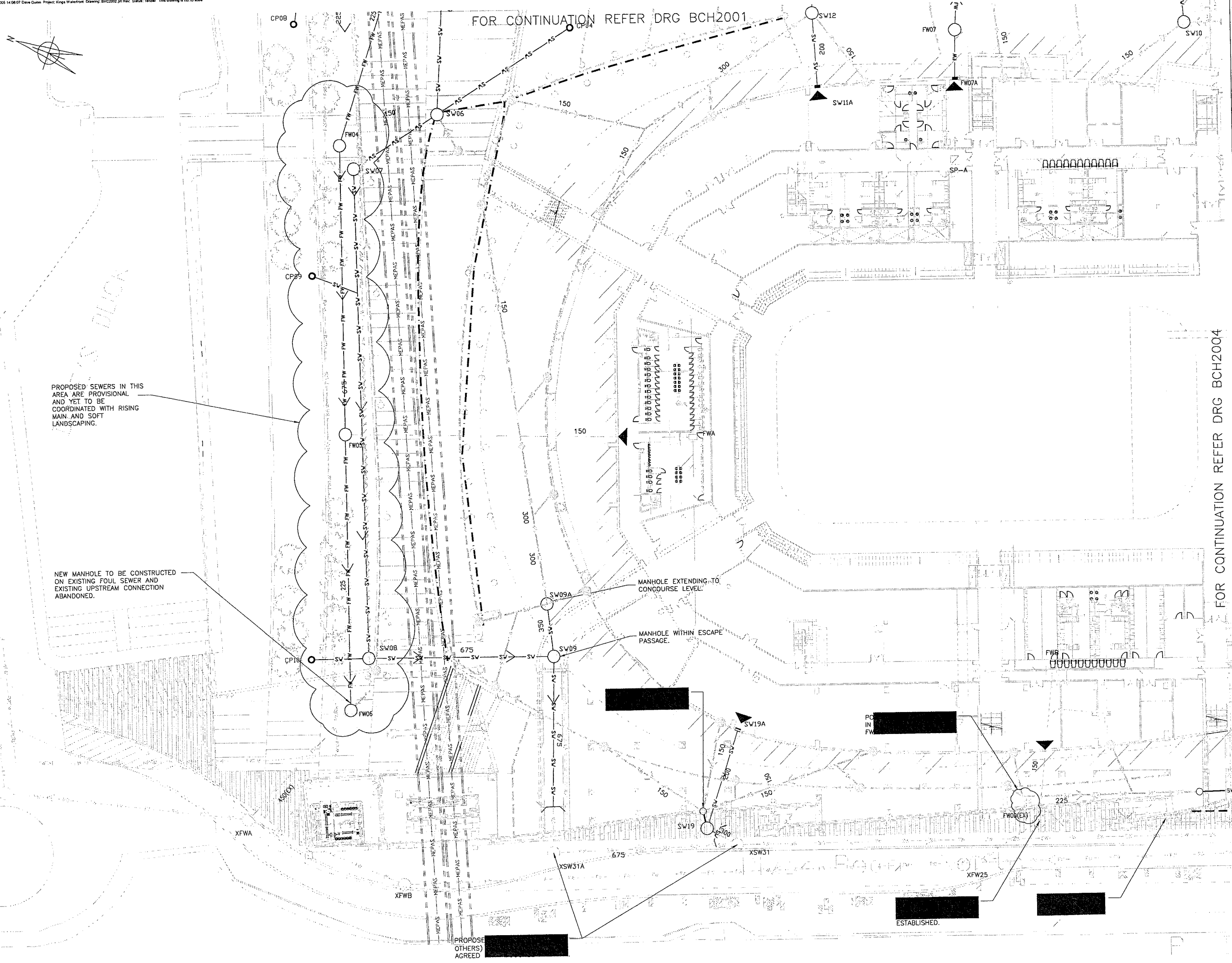

DO NOT SCALE THIS DRAWING

Notes

1. DO NOT SCALE FROM THIS DRAWING.
2. FOR GENERAL NOTES ON EXTERNAL DRAINAGE REFER TO BHC2000.
3. REFER TO DRG BHC2020-21 FOR STANDARD DETAILS.
4. REFER TO MANHOLE SCHEDULE FOR MANHOLE AND INVERT LEVEL INFORMATION.
5. LANDSCAPE DRAINAGE BY OTHERS.
6. CONTRACTOR TO CONFIRM EXACT LOCATION OF RISING MAIN PRIOR TO START OF WORKS.

LEGEND

- PROPOSED EXTERNAL MANHOLE
- SV— PROPOSED SURFACE WATER
- FW— PROPOSED FOUL WATER
- - - - - EXISTING FOUL RISING MAIN
- ▲ BUILDING DISCHARGE POINT (REFER TO BHC3000 SERIES)
- INDICATIVE LANDSCAPE DRAINAGE CATCHPIT (INCOMING LANDSCAPE DRAINAGE BY OTHERS)
- LINEAR DRAINAGE SUMP
- - - - - LINEAR DRAINAGE (REFER TO BHC 2030's SERIES)
- - - - - PERFORATED DRAIN FROM RETAINING WALLS
- └┐ CONNECTION TO SEWERS

02	FOR TENDER	13.06.05	RMAB
01	TENDER ISSUE	12.05.05	RMAB
00	ORIGINAL ISSUE	04.04.05	RMAB

Rev	Description	Date	Checked
-----	-------------	------	---------

FOR TENDER	JUNE 05
Issued only for purposes indicated	Date

17 Newmarket Street
London
W1P 3HD

Tel 0171 927 9700
Fax 0171 927 9701

Architect WILKINSONEYRE ARCHITECTS

Project KINGS WATERFRONT
EXTERNAL DRAINAGE LAYOUT
SHEET 2 OF 4

Scale 1:250 @ A1
Drawn by ASK
Checked by RMAB
Date MAR 2005

Job No. 008636
Drawing No. BHC2002
Rev 02

Buro Happold
Consulting Engineers

OR CONTINUATION REFER DRG BCH2000

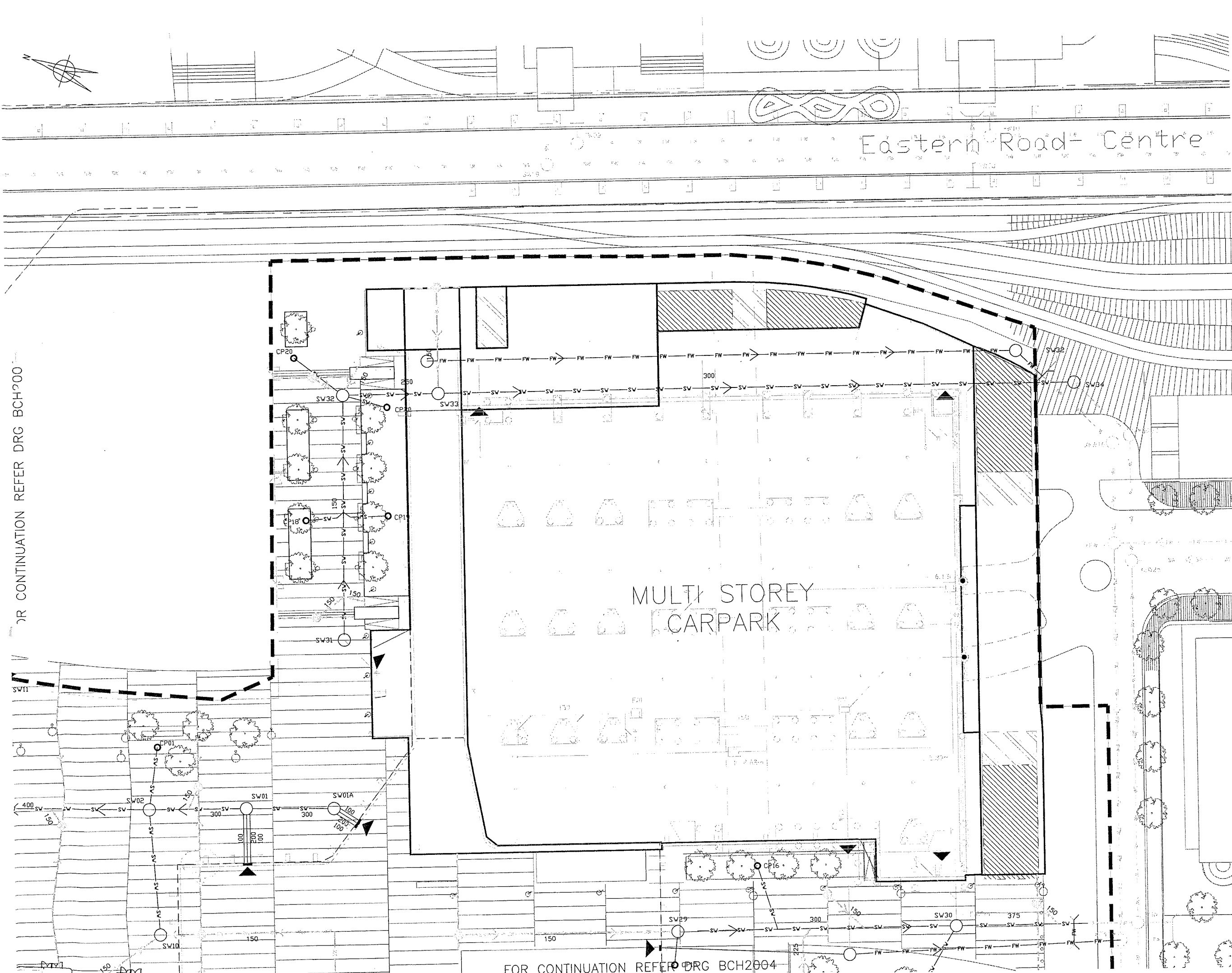

DO NOT SCALE THIS DRAWING

Notes

- DO NOT SCALE FROM THIS DRAWING.
- FOR GENERAL NOTES ON EXTERNAL DRAINAGE REFER TO BHC2000.
- REFER TO DRG BHC2020-21 FOR STANDARD DETAILS.
- REFER TO MANHOLE SCHEDULE FOR MANHOLE AND INVERT LEVEL INFORMATION.
- LANDSCAPE DRAINAGE BY OTHERS.

LEGEND

- PROPOSED EXTERNAL MANHOLE
- SV → SV PROPOSED SURFACE WATER
- FW → FW PROPOSED FOUL WATER
- EXISTING FOUL RISING MAIN
- ▲ BUILDING DISCHARGE POINT (REFER TO BHC3000 SERIES)
- INDICATIVE LANDSCAPE DRAINAGE CATCHPIT (INCOMING LANDSCAPE DRAINAGE BY OTHERS)
- LINEAR DRAINAGE SUMP
- LINEAR DRAINAGE (REFER TO BHC 2030's SERIES)
- PERFORATED DRAIN FROM RETAINING WALLS
- CONNECTION TO SEWERS

02	FOR TENDER	13.06.05	RMAE
01	TENDER ISSUE	12.05.05	RMAE
00	ORIGINAL ISSUE	04.04.05	RMAE

Rev	Description	Date	Checked

FOR TENDER

Issued only for purpose indicated

JUNE 05

Date

17 Newman Street
London
W1P 3HD

Tel 0171 927 9700
Fax 0171 927 9701

Architect WILKINSONMEYER ARCHITECTS

Project KINGS WATERFRONT
EXTERNAL DRAINAGE LAYOUT
SHEET 3 OF 4

Buro Happold
Consulting Engineer

Scale 1:250 @ A1	Job No. 008636
Drawn by ASK	Drawing No. BHC2004
Checked by RMAE	Rev 02
Date MAR 2005	

FOR CONTINUATION REFER DRG BCH2004

