

APPENDICES

Appendix 1 – Proposed Development Layout

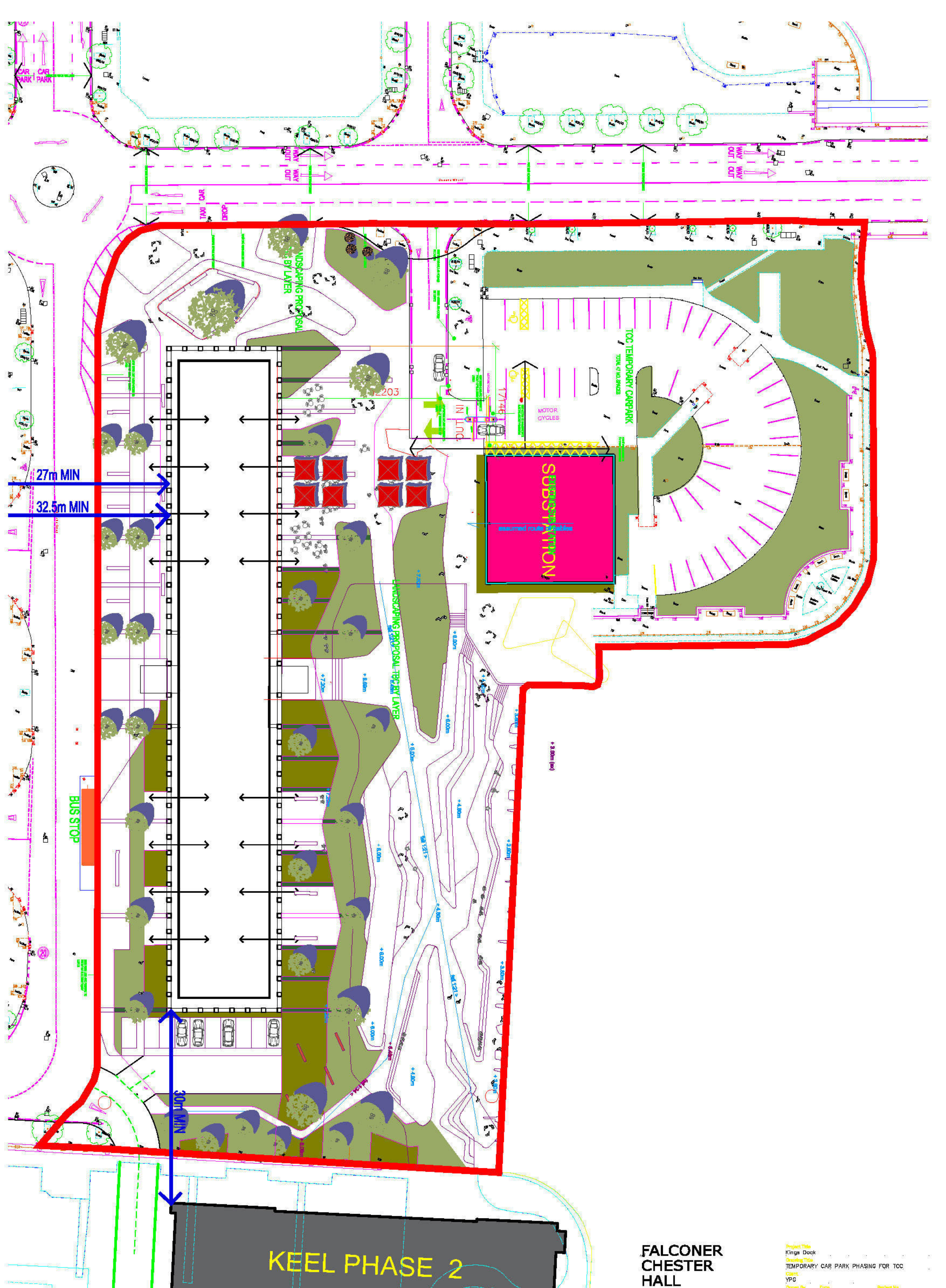

FALCONER
CHESTER
HALL



London | Liverpool | Kuala Lumpur | Telephone +44(0)151 243 5888 | info@falconerhalls.com

Project Title
Kings Dock
Drawing Title
TEMPORARY CAR PARK PHASING FOR TCC
Client
YPG
Drawn By
SLF
Date
22.02.2017
Scale
1:500 @ A3
Project No.
P16-144
Drawing No.
02-02-003

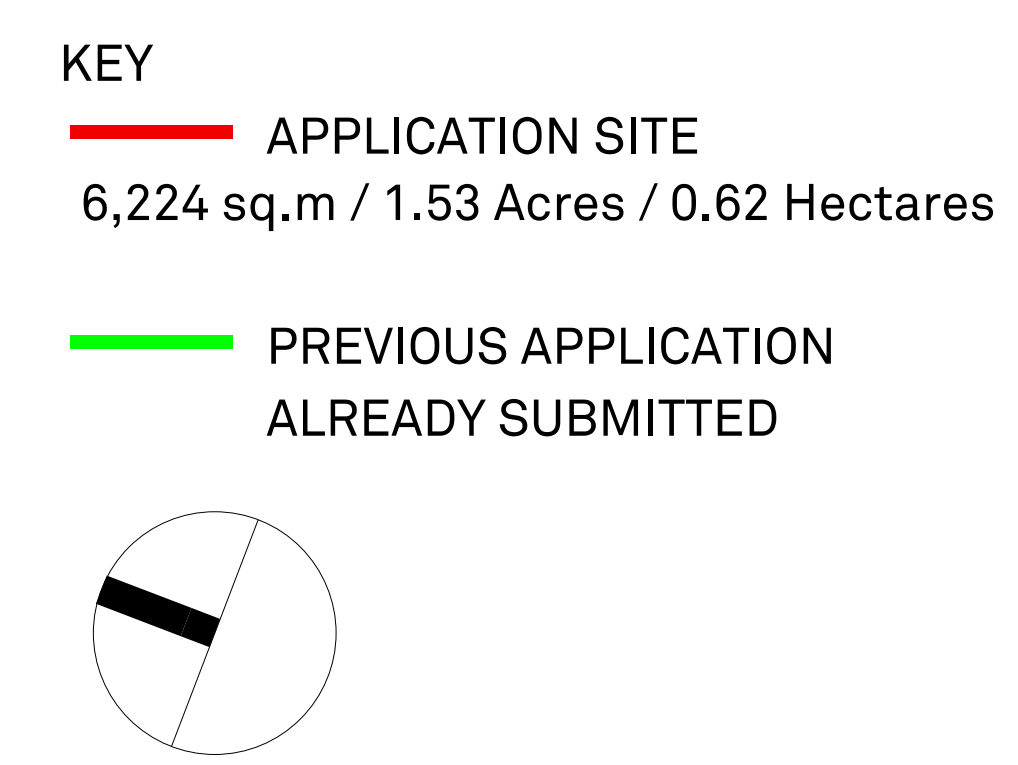

Rev C - 14.03.18 Application site boundary updated
Rev A - 16.10.17 Building 3 and landscaping updated
Rev A - 02.10.17 Building 2 and access
Project Title Kings Dock
Drawing Title Drawing 1b
Proposed site plan - Application 1b
Client YFS Developments
Drawing No. 02/1017
Scale 1:1250 @ A1
02-02-007C
www.fharchitects.com
44400151 243 5800

Appendix 2 – United Utilities Asset Plans

ENZYGO LTD
Samuel House,
5 Fox Valley Way

SHEFFIELD
S36 2AA

FAO: Richard Hughes

Dear Sirs

Location: PLOT TEMP SUPPLY QUEENS WHARF LIVERPOOL

I acknowledge with thanks your request dated 03/01/17 for information on the location of our services.

Please find enclosed plans showing the approximate position of our apparatus known to be in the vicinity of this site.

The enclosed plans are being provided to you subject to the United Utilities terms and conditions for both the wastewater and water distribution plans which are shown attached.

If you are planning works anywhere in the North West, please read our access statement before you start work to check how it will affect our network.

<http://www.unitedutilities.com/work-near-asset.aspx>.

I trust the above meets with your requirements and look forward to hearing from you should you need anything further.

If you have any queries regarding this matter please telephone us on 0370 7510101.

Yours Faithfully,



Amanda Simmonds
Property Searches Manager

United Utilities Water Limited
Property Searches
Ground Floor Grasmere House
Lingley Mere Business Park
Great Sankey
Warrington
WA5 3LP
DX 715568 Warrington
Telephone 0370 751 0101

Property.searches@uu plc.co.uk

Your Ref: SHF 1380 001
Our Ref: 16/ 1258801
Date: 4/1/2017

TERMS AND CONDITIONS - WASTERWATER & WATER DISTRIBUTION PLANS

These provisions apply to the public sewerage, water distribution and telemetry systems (including sewers which are the subject of an agreement under Section 104 of the Water Industry Act 1991 and mains installed in accordance with the agreement for the self-construction of water mains) (UUWL apparatus) of United Utilities Water Limited "(UUWL)".

TERMS AND CONDITIONS:

1. This Map and any information supplied with it is issued subject to the provisions contained below, to the exclusion of all others and no party relies upon any representation, warranty, collateral contract or other assurance of any person (whether party to this agreement or not) that is not set out in this agreement or the documents referred to in it.
2. This Map and any information supplied with it is provided for general guidance only and no representation, undertaking or warranty as to its accuracy, completeness or being up to date is given or implied.
3. In particular, the position and depth of any UUWL apparatus shown on the Map are approximate only and given in accordance with the best information available. The nature of the relevant system and/or its actual position may be different from that shown on the plan and UUWL is not liable for any damage caused by incorrect information provided save as stated in section 199 of the Water Industry Act 1991. UUWL strongly recommends that a comprehensive survey is undertaken in addition to reviewing this Map to determine and ensure the precise location of any UUWL apparatus. The exact location, positions and depths should be obtained by excavation trial holes.
4. The location and position of private drains, private sewers and service pipes to properties are not normally shown on this Map but their presence must be anticipated and accounted for and you are strongly advised to carry out your own further enquiries and investigations in order to locate the same.
5. The position and depth of UUWL apparatus is subject to change and therefore this Map is issued subject to any removal or change in location of the same. The onus is entirely upon you to confirm whether any changes to the Map have been made subsequent to issue and prior to any works being carried out.
6. This Map and any information shown on it or provided with it must not be relied upon in the event of any development, construction or other works (including but not limited to any excavations) in the vicinity of UUWL apparatus or for the purpose of determining the suitability of a point of connection to the sewerage or other distribution systems.
7. No person or legal entity, including any company shall be relieved from any liability howsoever and whensoever arising for any damage caused to UUWL apparatus by reason of the actual position and/or depths of UUWL apparatus being different from those shown on the Map and any information supplied with it.
8. If any provision contained herein is or becomes legally invalid or unenforceable, it will be taken to be severed from the remaining provisions which shall be unaffected and continue in full force and affect.
9. This agreement shall be governed by English law and all parties submit to the exclusive jurisdiction of the English courts, save that nothing will prevent UUWL from bringing proceedings in any other competent jurisdiction, whether concurrently or otherwise.

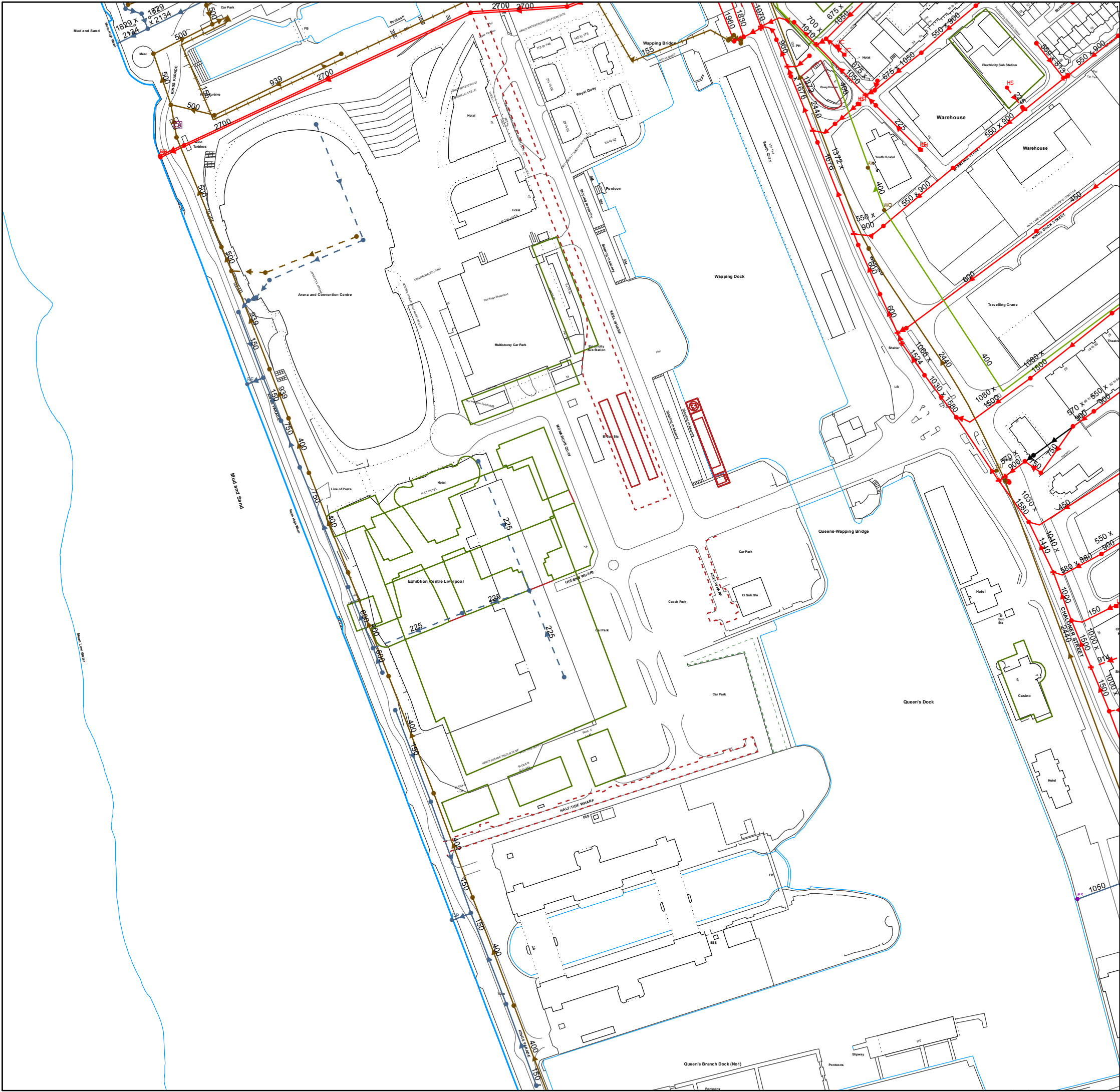

Extract from Map of Public Sewers

The position of underground apparatus shown on this plan is approximate only and is given in accordance with the best information currently available.

The actual positions may be different from those shown on the plan and private pipes, sewers or drains may not be recorded.

United Utilities will not accept any liability for any damage caused by the actual positions being different from those shown.

United Utilities Water Limited 2014
The plan is based upon the Ordnance Survey Map with the sanction of the Controller of H.M. Stationery Office. Crown and United Utilities copyrights are reserved. Unauthorised reproduction will infringe these copyrights.

**PLOT TEMP SUPPLY QUEENS WHARF
LIVERPOOL**

Printed By: Property Searches Date: 04/01/2017

DO NOT SCALE
Approximate Scale: 1:2500



TERMS AND CONDITIONS - WASTERWATER & WATER DISTRIBUTION PLANS

These provisions apply to the public sewerage, water distribution and telemetry systems (including sewers which are the subject of an agreement under Section 104 of the Water Industry Act 1991 and mains installed in accordance with the agreement for the self-construction of water mains) (UUWL apparatus) of United Utilities Water Limited "(UUWL)".

TERMS AND CONDITIONS:

1. This Map and any information supplied with it is issued subject to the provisions contained below, to the exclusion of all others and no party relies upon any representation, warranty, collateral contract or other assurance of any person (whether party to this agreement or not) that is not set out in this agreement or the documents referred to in it.
2. This Map and any information supplied with it is provided for general guidance only and no representation, undertaking or warranty as to its accuracy, completeness or being up to date is given or implied.
3. In particular, the position and depth of any UUWL apparatus shown on the Map are approximate only. UUWL strongly recommends that a comprehensive survey is undertaken in addition to reviewing this Map to determine and ensure the precise location of any UUWL apparatus. The exact location, positions and depths should be obtained by excavation trial holes.
4. The location and position of private drains, private sewers and service pipes to properties are not normally shown on this Map but their presence must be anticipated and accounted for and you are strongly advised to carry out your own further enquiries and investigations in order to locate the same.
5. The position and depth of UUWL apparatus is subject to change and therefore this Map is issued subject to any removal or change in location of the same. The onus is entirely upon you to confirm whether any changes to the Map have been made subsequent to issue and prior to any works being carried out.
6. This Map and any information shown on it or provided with it must not be relied upon in the event of any development, construction or other works (including but not limited to any excavations) in the vicinity of UUWL apparatus or for the purpose of determining the suitability of a point of connection to the sewerage or other distribution systems.
7. No person or legal entity, including any company shall be relieved from any liability howsoever and whensoever arising for any damage caused to UUWL apparatus by reason of the actual position and/or depths of UUWL apparatus being different from those shown on the Map and any information supplied with it.
8. If any provision contained herein is or becomes legally invalid or unenforceable, it will be taken to be severed from the remaining provisions which shall be unaffected and continue in full force and affect.
9. This agreement shall be governed by English law and all parties submit to the exclusive jurisdiction of the English courts, save that nothing will prevent UUWL from bringing proceedings in any other competent jurisdiction, whether concurrently or otherwise.

WASTE WATER SYMBOLOGY

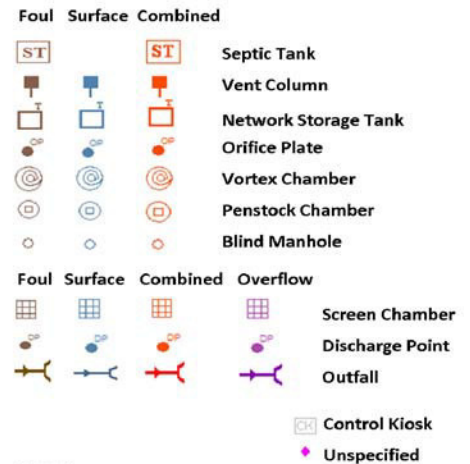
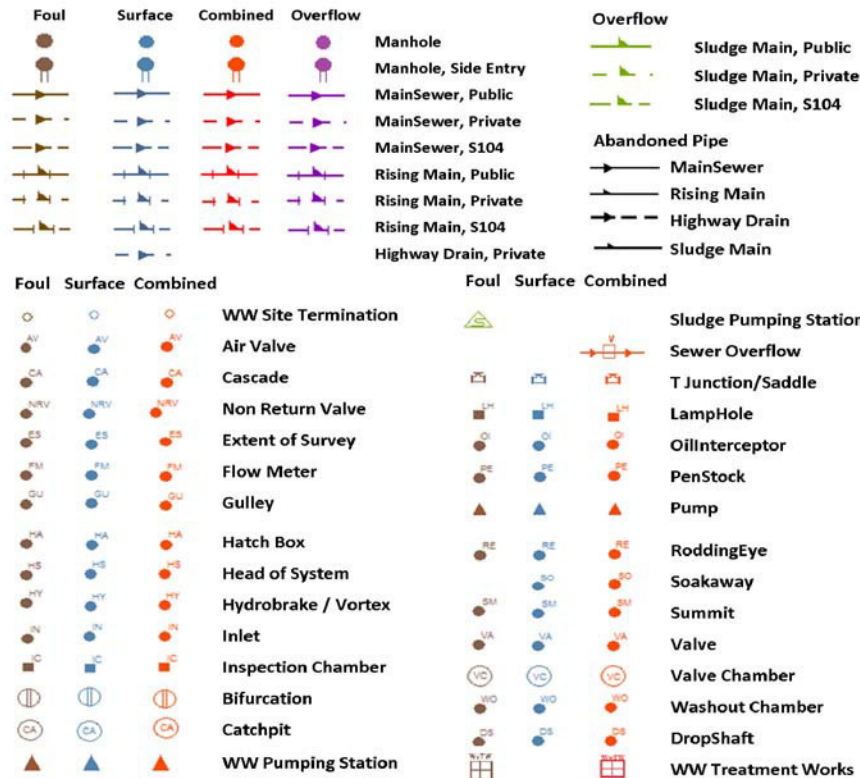

Legend			
MANHOLE FUNCTION		SEWER SHAPE	
FO	Foul	CI	Circular
SW	Surface Water	EO	Egg
CO	Combined	OV	Oval
OV	Overflow	FT	Flat Top
		RE	Rectangular
		SQ	Square
		TR	Trapezoidal
		AR	Arch
		BA	Barrel
		HO	HorseShoe
		UN	Unspecified
SEWER MATERIAL			
AC	Asbestos Cement	DI	Ductile Iron
BR	Brick	VC	Vitrified Clay
CO	Concrete	PP	Polypropylene
CSB	Concrete Segment	PF	Pitched Fibre
CSU	Concrete Segment	MA	Masonry, Coursed
CC	Concrete Box Culverted	MA	Masonry, Random
PSC	Plastic / Steel	RP	Reinforced Plastic
GR	Glass Reinforced	CI	Cast Iron
GRP	Glass Reinforced	SI	Spun Iron
PVC	Polyvinyl Chloride	ST	Steel
PE	Polyethylene	U	Unspecified

CLEAN WATER SYMBOLOGY

PIPE WORK



ABANDONED PIPE

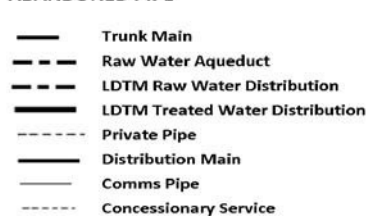

PROPERTY TYPES



NODES/FURNITURES

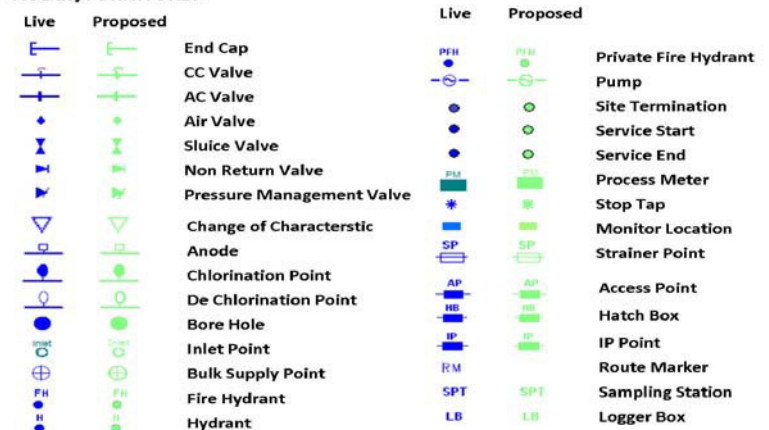

Legend	
MATERIAL TYPES	LINING TYPES
AC ASBESTOS CEMENT	CL CEMENT LINING
CI CAST IRON	TB TAR OR BITUMEN
CU COPPER	ERL EPOXY RESIN
CO CONCRETE	
DI DUCTILE IRON	INSERTION TYPES
GI GALVANISED IRON	DD DIE DRAWN
GR GREY IRON	DR DIRECTIONAL DRILLING
OT OTHERS	MO MOLING
PB LEAD	PI PIPELINE
PV UPVC	SL SLIP LINED
SI SPUN IRON	
ST STEEL	
UN UNKNOWN	
PE POLYETHYLENE	