

Maximum depth from cover level to soffit of pipe 3.0 m

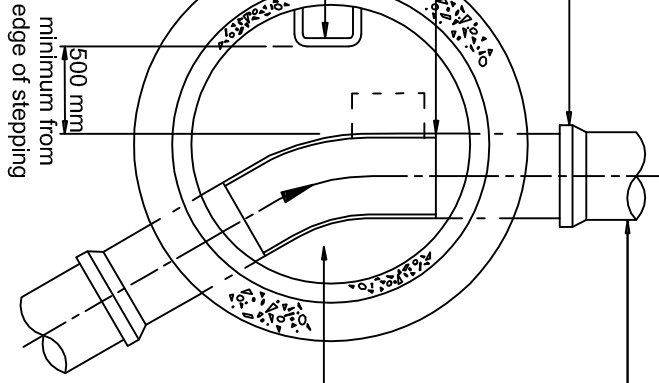

Maximum depth from cover level to soffit of pipe 3.0 m

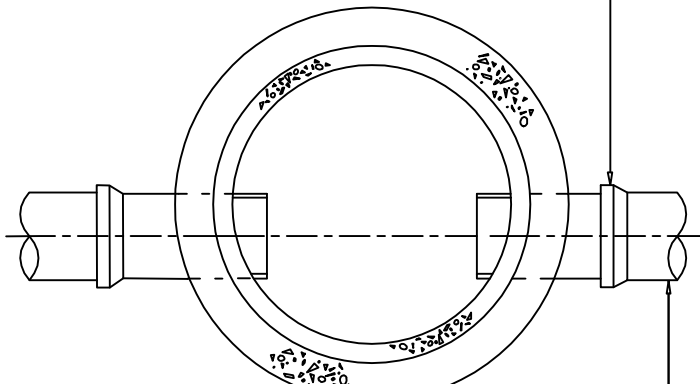

Maximum depth from cover level to soffit of pipe in areas subject to vehicle loading 3 m, non-entry

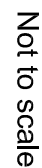

Granular bed and surround as

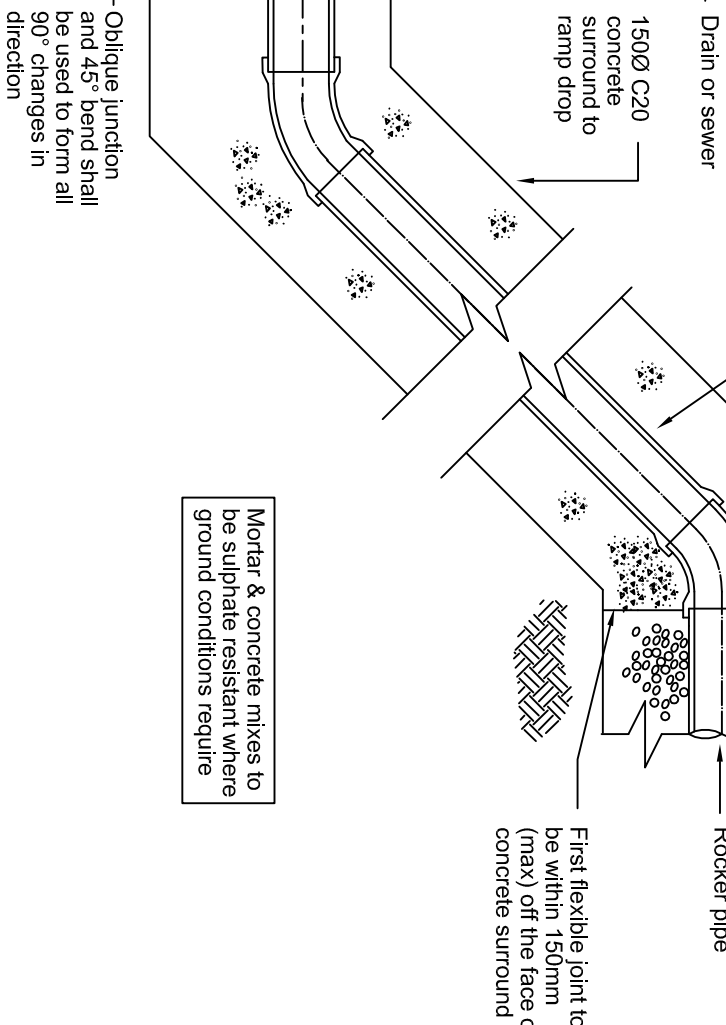

(< 600mm PEDESTRIAN AREAS

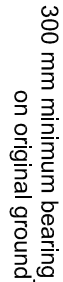

TYPICAL ARRANGEMENT OF PIPE JUNCTIONS WITHIN MANHOLES

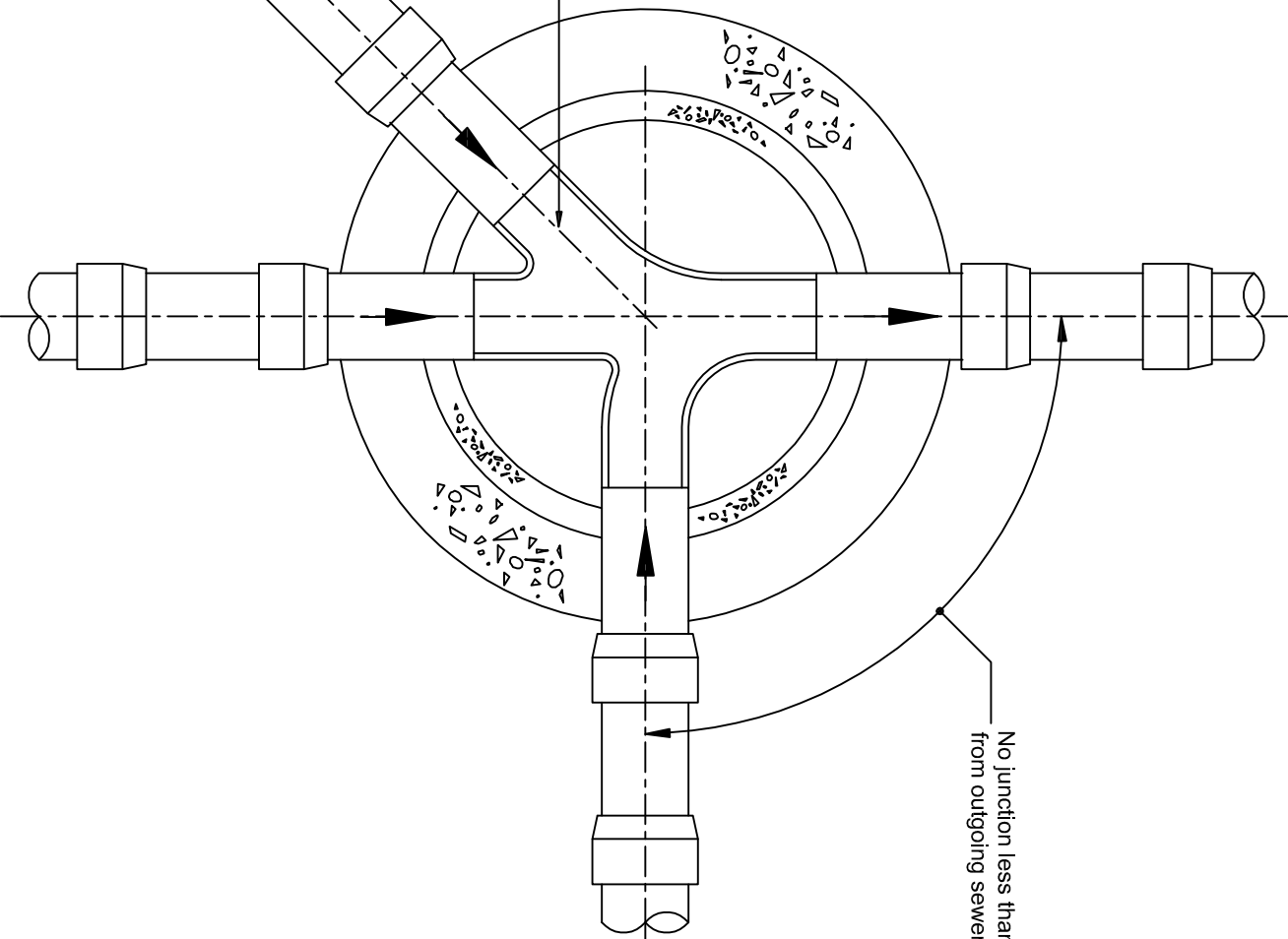

Nominal diameter (mm)	Maximum effective length (m)
150 - 600	0.6
601 - 750	1.00
over 750	1.25

Note: Steeper gradients are preferred to the use of backdrops

