

Ordnance Survey (c) Crown Copyright 2014. All rights reserved. Licence number 100022432

Notation:

|    |                   |     |              |
|----|-------------------|-----|--------------|
| AB | Air Brick         | JNB | Junction Box |
| AV | Air Valve         | KL  | Keep Left    |
| BB | Building Section  | KD  | Keep Right   |
| BN | Building Boundary | L1  | Level 1      |
| BN | Boundary          | LP  | Level 2      |
| BN | Boundary          | LP  | Level 3      |
| BN | Boundary          | LP  | Level 4      |
| BN | Boundary          | LP  | Level 5      |
| BN | Boundary          | LP  | Level 6      |
| BN | Boundary          | LP  | Level 7      |
| BN | Boundary          | LP  | Level 8      |
| BN | Boundary          | LP  | Level 9      |
| BN | Boundary          | LP  | Level 10     |
| BN | Boundary          | LP  | Level 11     |
| BN | Boundary          | LP  | Level 12     |
| BN | Boundary          | LP  | Level 13     |
| BN | Boundary          | LP  | Level 14     |
| BN | Boundary          | LP  | Level 15     |
| BN | Boundary          | LP  | Level 16     |
| BN | Boundary          | LP  | Level 17     |
| BN | Boundary          | LP  | Level 18     |
| BN | Boundary          | LP  | Level 19     |
| BN | Boundary          | LP  | Level 20     |
| BN | Boundary          | LP  | Level 21     |
| BN | Boundary          | LP  | Level 22     |
| BN | Boundary          | LP  | Level 23     |
| BN | Boundary          | LP  | Level 24     |
| BN | Boundary          | LP  | Level 25     |
| BN | Boundary          | LP  | Level 26     |
| BN | Boundary          | LP  | Level 27     |
| BN | Boundary          | LP  | Level 28     |
| BN | Boundary          | LP  | Level 29     |
| BN | Boundary          | LP  | Level 30     |
| BN | Boundary          | LP  | Level 31     |
| BN | Boundary          | LP  | Level 32     |
| BN | Boundary          | LP  | Level 33     |
| BN | Boundary          | LP  | Level 34     |
| BN | Boundary          | LP  | Level 35     |
| BN | Boundary          | LP  | Level 36     |
| BN | Boundary          | LP  | Level 37     |
| BN | Boundary          | LP  | Level 38     |
| BN | Boundary          | LP  | Level 39     |
| BN | Boundary          | LP  | Level 40     |
| BN | Boundary          | LP  | Level 41     |
| BN | Boundary          | LP  | Level 42     |
| BN | Boundary          | LP  | Level 43     |
| BN | Boundary          | LP  | Level 44     |
| BN | Boundary          | LP  | Level 45     |
| BN | Boundary          | LP  | Level 46     |
| BN | Boundary          | LP  | Level 47     |
| BN | Boundary          | LP  | Level 48     |
| BN | Boundary          | LP  | Level 49     |
| BN | Boundary          | LP  | Level 50     |
| BN | Boundary          | LP  | Level 51     |
| BN | Boundary          | LP  | Level 52     |
| BN | Boundary          | LP  | Level 53     |
| BN | Boundary          | LP  | Level 54     |
| BN | Boundary          | LP  | Level 55     |
| BN | Boundary          | LP  | Level 56     |
| BN | Boundary          | LP  | Level 57     |
| BN | Boundary          | LP  | Level 58     |
| BN | Boundary          | LP  | Level 59     |
| BN | Boundary          | LP  | Level 60     |
| BN | Boundary          | LP  | Level 61     |
| BN | Boundary          | LP  | Level 62     |
| BN | Boundary          | LP  | Level 63     |
| BN | Boundary          | LP  | Level 64     |
| BN | Boundary          | LP  | Level 65     |
| BN | Boundary          | LP  | Level 66     |
| BN | Boundary          | LP  | Level 67     |
| BN | Boundary          | LP  | Level 68     |
| BN | Boundary          | LP  | Level 69     |
| BN | Boundary          | LP  | Level 70     |
| BN | Boundary          | LP  | Level 71     |
| BN | Boundary          | LP  | Level 72     |
| BN | Boundary          | LP  | Level 73     |
| BN | Boundary          | LP  | Level 74     |
| BN | Boundary          | LP  | Level 75     |
| BN | Boundary          | LP  | Level 76     |
| BN | Boundary          | LP  | Level 77     |
| BN | Boundary          | LP  | Level 78     |
| BN | Boundary          | LP  | Level 79     |
| BN | Boundary          | LP  | Level 80     |
| BN | Boundary          | LP  | Level 81     |
| BN | Boundary          | LP  | Level 82     |
| BN | Boundary          | LP  | Level 83     |
| BN | Boundary          | LP  | Level 84     |
| BN | Boundary          | LP  | Level 85     |
| BN | Boundary          | LP  | Level 86     |
| BN | Boundary          | LP  | Level 87     |
| BN | Boundary          | LP  | Level 88     |
| BN | Boundary          | LP  | Level 89     |
| BN | Boundary          | LP  | Level 90     |
| BN | Boundary          | LP  | Level 91     |
| BN | Boundary          | LP  | Level 92     |
| BN | Boundary          | LP  | Level 93     |
| BN | Boundary          | LP  | Level 94     |
| BN | Boundary          | LP  | Level 95     |
| BN | Boundary          | LP  | Level 96     |
| BN | Boundary          | LP  | Level 97     |
| BN | Boundary          | LP  | Level 98     |
| BN | Boundary          | LP  | Level 99     |
| BN | Boundary          | LP  | Level 100    |

Survey Control

|      | -E-X-      | -N-Y-      | -H-Z-  |
|------|------------|------------|--------|
| STN1 | 338116.027 | 391233.275 | 46.569 |
| STN2 | 338153.459 | 391233.038 | 46.569 |
| STN3 | 338154.531 | 391212.302 | 46.502 |
| STN4 | 338193.210 | 391212.315 | 46.502 |
| STN5 | 338260.936 | 391222.029 | 46.554 |
| STN6 | 338166.207 | 391146.466 | 46.594 |
| STN7 | 338173.476 | 391108.336 | 47.315 |
| STN8 | 338138.097 | 391199.611 | 47.557 |

Relative to Ordnance Survey Grid & Level via interpolation of Digital OS Data.

LEGEND

|                             |            |
|-----------------------------|------------|
| PROPOSED ROUTE              | —          |
| AS BUILT                    | —          |
| ELECTRIC                    | —ELEC—     |
| EXTRA HIGH VOLTAGE ELECTRIC | —EHV—ELEC— |
| HIGH VOLTAGE ELECTRIC       | —HV—ELEC—  |
| LOW VOLTAGE ELECTRIC        | —LV—ELEC—  |
| STREET LIGHTING CABLES      | —SL—       |
| GAS                         | —GAS—      |
| HIGH PRESSURE GAS           | —HP—GAS—   |
| MEDIUM PRESSURE GAS         | —MP—GAS—   |
| INTERMEDIATE PRESSURE GAS   | —IP—GAS—   |
| WATER                       | —WTR—      |
| BT                          | —BT—       |
| COMMS                       | —COMMS—    |
| DRAINAGE                    | —DRAIN—    |
| ASSUMED DRAINAGE            | —ADRAIN—   |
| OIL PIPELINE                | —OIL—      |
| MISCELLANEOUS               | —MISC—     |
| UNKNOWN UTILITY             | —UNK—      |
| END OF TRACE                | —          |
| NO DEPTH RECORDED           | —          |
| DEPTH OF UTILITY            | —          |
| Diameter                    | —          |
| GPR                         | —          |

SHEET LAYOUT

|         |         |
|---------|---------|
| Sheet 1 | Sheet 2 |
| Sheet 3 | Sheet 4 |

SURVEY INFORMATION

Title:  
**Former Police Athletics Club  
Prescott Road  
Liverpool**

Always Exercise Caution When Excavating

A range of detection methods are used to obtain the underground information produced in this drawing. Variations in ground conditions can affect the quality of the data and therefore an absolute affirmation cannot be guaranteed.  
**IF IN ANY DOUBT ASK**

|                        |  |
|------------------------|--|
| Client :               | Bellway Homes                              |
| Project Title :        | Former Police Athletics Club - Prescott Rd |
| Drawing Title :        | Topographical Survey                       |
| Surveyed By and Date : | DRLT July 2014                             |
| Drawn By and Date :    | JD - 20-07-2014                            |
| Approved By and Date : | DRLT - 21-07-2014                          |
| Drawing Number :       | CUB - WCG - BWH-010                        |
| Sheet Number:          | 1 of 4                                     |
| Scale: A0:             | 1:200                                      |



TEL 0870 7550093  
E. SALES@CUBESURVEYS.CO.UK



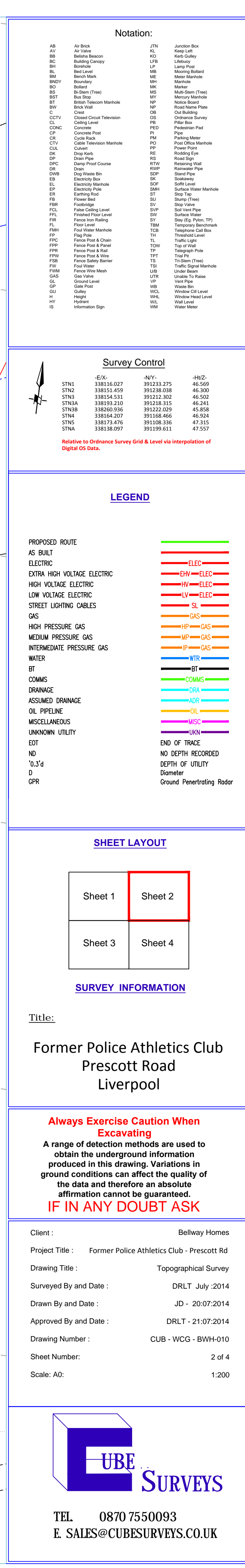

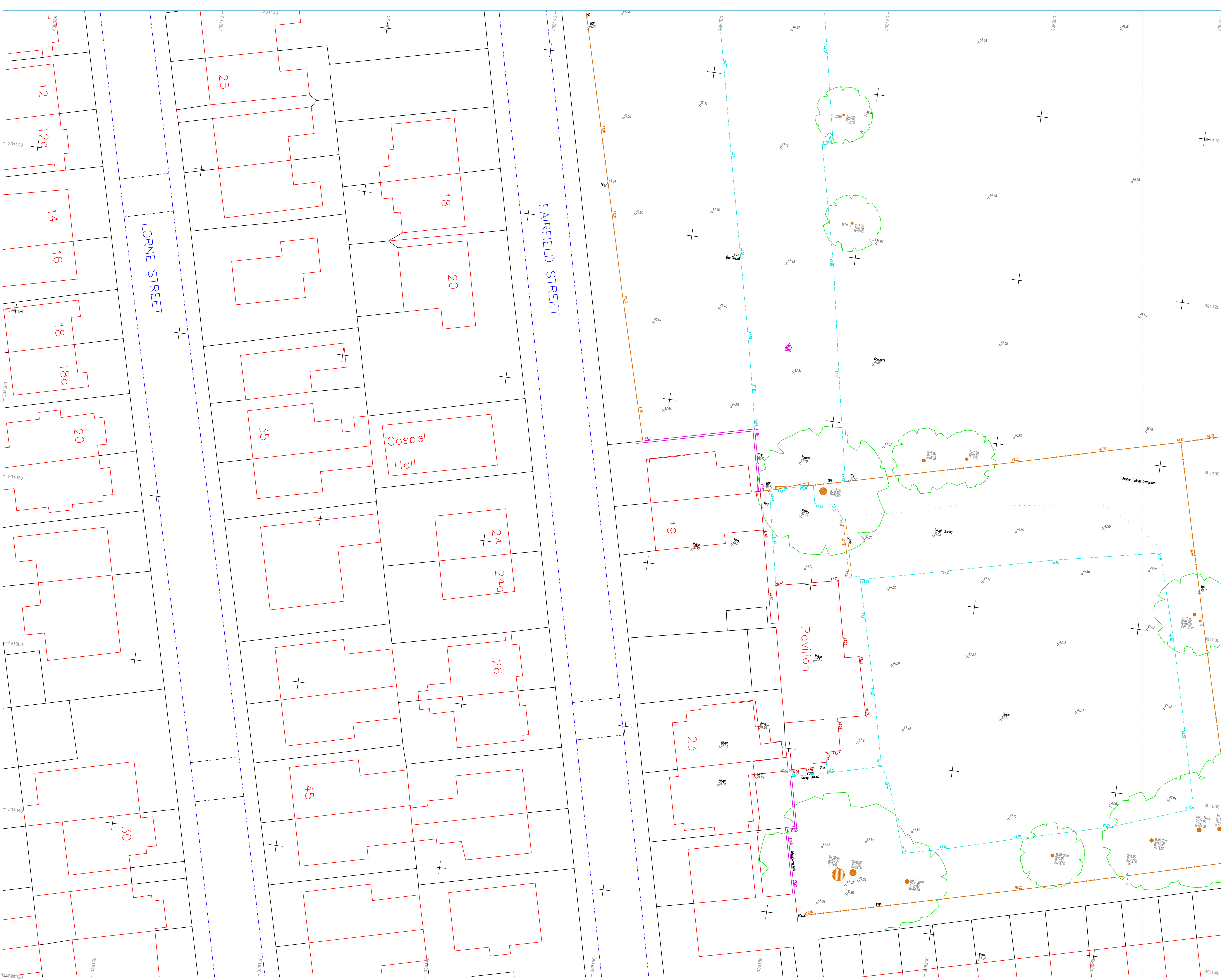

[illegible]

|       | <u>Survey Control</u> |                        |
|-------|-----------------------|------------------------|
|       | -E/X-                 | -N/Y-      -H/Z-       |
| STN1  | 338116.027            | 391233.275      46.569 |
| STN2  | 338151.250            | 391238.038      46.300 |
| STN3  | 338154.531            | 391212.082      46.502 |
| STN3A | 338193.219            | 391128.315      46.341 |
| STN3B | 338260.936            | 391222.029      45.858 |
| STN4  | 338164.207            | 391168.466      46.924 |
| STN5  | 338173.476            | 391108.336      47.315 |
| STN6  | 338138.097            | 391199.611      47.557 |

Digital to Ordinate Survey Grid & Level via interpolation of  
 Relative OS Data.

**LEGEND**

|                               |      |
|-------------------------------|------|
| POSED ROUTE                   | ———— |
| BUILT                         | ———— |
| ELECTRIC                      | ———— |
| 15 kV HIGH VOLTAGE ELECTRIC   | ———— |
| 24 kV HIGH VOLTAGE ELECTRIC   | ———— |
| 34.5 kV HIGH VOLTAGE ELECTRIC | ———— |
| 48 kV HIGH VOLTAGE ELECTRIC   | ———— |
| STREET LIGHTING CABLES        | ———— |
| SEWER                         | ———— |
| SEWER PRESSURE GAS            | ———— |
| WATER PRESSURE GAS            | ———— |
| INTERMEDIATE PRESSURE GAS     | ———— |
| WATER                         | ———— |
| BT                            | ———— |
| COMMS                         | ———— |
| PIPELINE                      | ———— |
| UNSEWERED DRAINAGE            | ———— |
| PIPELINE                      | ———— |
| CELLULOSE                     | ———— |
| UNKNOWN UTILITY               | ———— |
| UNKNOWN UTILITY               | ———— |
| END OF TRACE                  | ———— |
| NO DEPTH RECORD               | ———— |
| DEPTH OF UTILITY              | ———— |
| Diameter                      | ———— |
| Ground Penetration            | ———— |

**SHEET LAYOUT**

|         |         |
|---------|---------|
| Sheet 1 | Sheet 2 |
| Sheet 3 | Sheet 4 |

## SURVEY INFORMATION

Title:

Former Police Athletics Club  
Prescott Road  
Liverpool

**Always Exercise Caution When Excavating**

A range of detection methods are used to obtain the underground information produced in this drawing. Variations in ground conditions can affect the quality of the data and therefore an absolute affirmation cannot be guaranteed.

**IF IN ANY DOUBT ASK**

Client : Bellway Homes  
Project Title : Former Police Athletics Club - Prescot  
Drawing Title : Topographical Survey  
Surveyed By and Date : DRLT - July 2007  
Drawn By and Date : JD - 20/07  
Approved By and Date : DRLT - 21/07  
Drawing Number : CUB - WCG - BWH  
Sheet Number :  
Scale: A0:

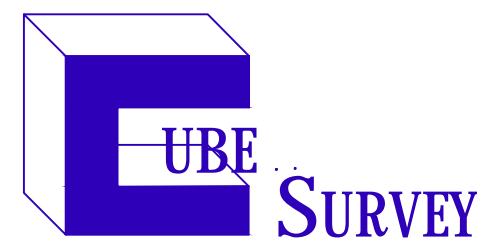

TEL 0870 7550093  
E. SALES@CUBESURVEYS.CO.UK

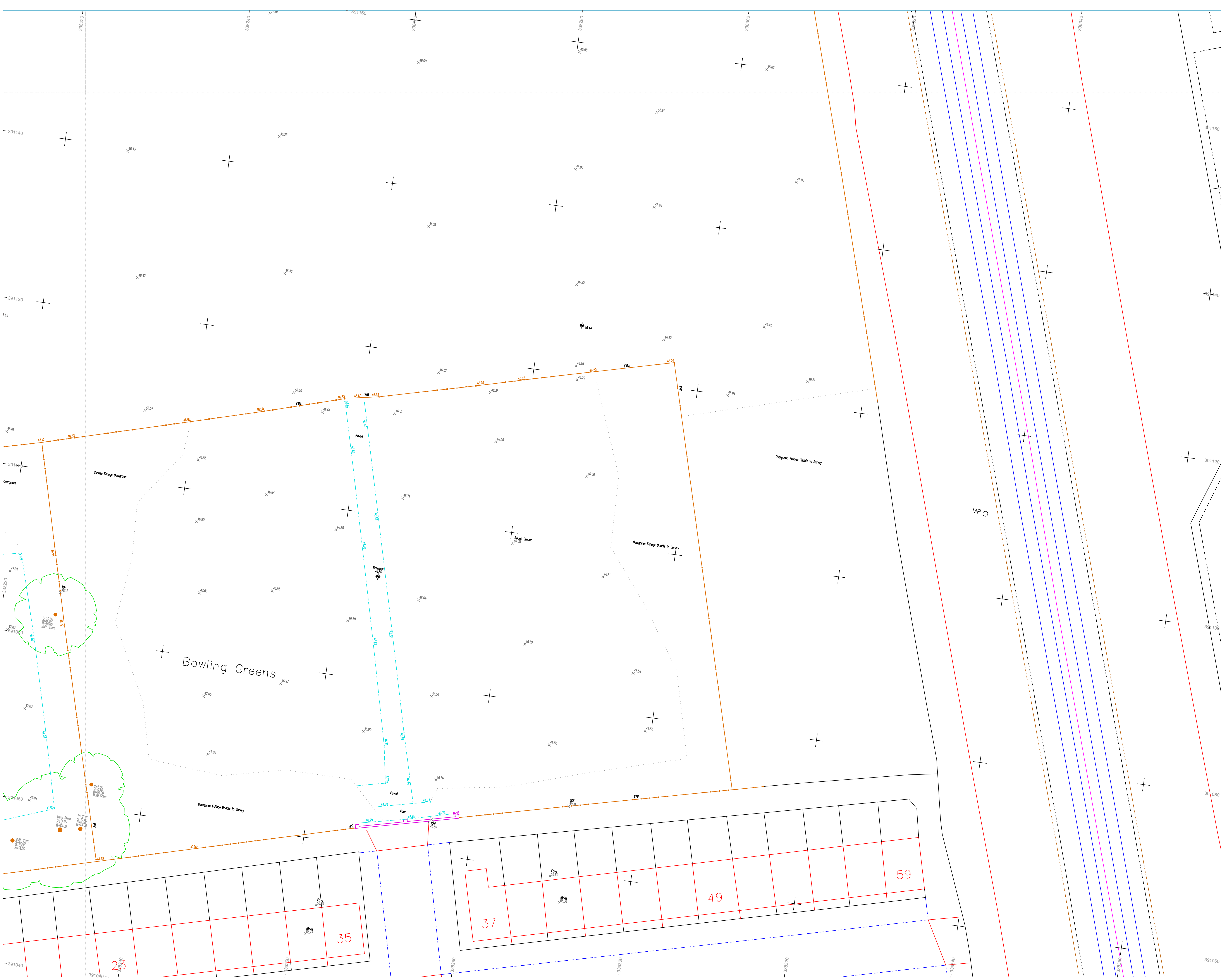

[illegible]

### Survey Control

|       |            |            |        |
|-------|------------|------------|--------|
|       | -E-X       | -N-Y       | -W-Z   |
| STN1  | 338116.027 | 391233.275 | 46.569 |
| STN2  | 338151.459 | 391238.038 | 46.300 |
| STN3  | 338154.531 | 391212.302 | 46.502 |
| STN3A | 338193.210 | 391218.315 | 46.241 |
| STN3B | 338260.236 | 391222.029 | 45.858 |
| STN4  | 338154.207 | 391168.466 | 46.904 |
| STN5  | 338173.476 | 391108.336 | 47.315 |
| STNA  | 338138.097 | 391199.611 | 47.557 |

**Relative to Ordnance Survey Grid & Level via interpolation of  
Rectified OS Data**

**LEGEND**

|                                  |          |
|----------------------------------|----------|
| PROPOSED ROUTE                   | —        |
| BUILT                            | —        |
| ELECTRIC                         | —        |
| 15 KV HIGH VOLTAGE ELECTRIC      | —ELEC    |
| 138 KV HIGH VOLTAGE ELECTRIC     | —HV ELEC |
| 5 KV HIGH VOLTAGE ELECTRIC       | —LV ELEC |
| STREET LIGHTING CABLES           | —SL      |
| GAS                              | —        |
| 15 PSI HIGH PRESSURE GAS         | —HP GAS  |
| 10 PSI HIGH PRESSURE GAS         | —HP GAS  |
| 10 PSI INTERMEDIATE PRESSURE GAS | —IP GAS  |
| WATER                            | —        |
| 10" DIAMETER                     | —WTR     |
| 8" DIAMETER                      | —BT      |
| 6" DIAMETER                      | —COMMS   |
| 4" DIAMETER                      | —DRA     |
| 3" DIAMETER                      | —ADR     |
| 2" DIAMETER                      | —SL      |
| 1" DIAMETER                      | —MISC    |
| UNKNOWN UTILITY                  | —UNK     |
| END OF TRACE                     | —        |
| NO DEPTH RECORD                  | —        |
| DEPTH OF UTILITY                 | —        |
| Diameter                         | —        |
| Ground Penetration               | —        |

**SHEET LAYOUT**

|         |         |
|---------|---------|
| Sheet 1 | Sheet 2 |
| Sheet 3 | Sheet 4 |

Title:  
Former Police Athletics Club  
Prescott Road  
Liverpool

**Always Exercise Caution When Excavating**

A range of detection methods are used to obtain the underground information produced in this drawing. Variations in ground conditions can affect the quality of the data and therefore an absolute affirmation cannot be guaranteed.

**IF IN ANY DOUBT ASK**

Client : Bellway Homes  
Project Title : Former Police Athletics Club - Prescot  
Drawing Title : Topographical Survey  
Surveyed By and Date : DRLT July 2007  
Drawn By and Date : JD - 20:07  
Approved By and Date : DRLT - 21:07  
Drawing Number : CUB - WCG - BWG  
Sheet Number:  
Scale: A0:

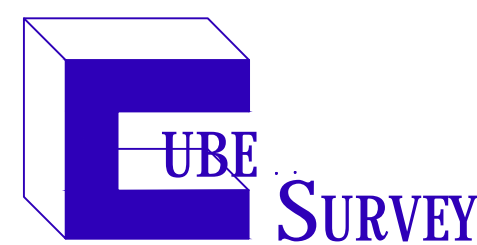

TEL 0870 7550093  
E. SALES@CUBESURVEYS.CO.UK