

Historical Mapping Legends

Ordnance Survey County Series 1:10,560

	Gravel Pit		Sand Pit		Other Pits
	Quarry		Shingle		Orchard
	Osiers		Reeds		Marsh
	Mixed Wood		Deciduous		Brushwood
	Fir		Furze		Rough Pasture
	Arrow denotes flow of water		Trigonometrical Station		
	Site of Antiquities		Bench Mark		
	Pump, Guide Post, Signal Post		Well, Spring, Boundary Post		
	Surface Level				
	Sketched Contour		Instrumental Contour		
	Main Roads		Minor Roads		
	Sunken Road		Raised Road		
	Road over Railway		Railway over River		
	Railway over Road		Level Crossing		
	Road over River or Canal		Road over Stream		
	Road over Stream				
	County Boundary (Geographical)				
	County & Civil Parish Boundary				
	Administrative County & Civil Parish Boundary				
	County Borough Boundary (England)				
	County Burgh Boundary (Scotland)				
	Rural District Boundary				
	Civil Parish Boundary				

Ordnance Survey Plan 1:10,000

	Chalk Pit, Clay Pit or Quarry		Gravel Pit
	Sand Pit		Disused Pit or Quarry
	Refuse or Slag Heap		Lake, Loch or Pond
	Dunes		Boulders
	Coniferous Trees		Non-Coniferous Trees
	Orchard		Scrub
	Bracken		Heath
	Marsh		Reeds
	Marsh		Saltings
	Building		Direction of Flow of Water
	Glasshouse		Shingle
	Sloping Masonry		Sand
	Pylon		Electricity Transmission Line
	Pole		
	Cutting		Embankment
	Road Under		Road Over
	Level Crossing		Foot Bridge
	Siding, Tramway or Mineral Line		
	Narrow Gauge		
	Geographical County		
	Administrative County, County Borough or County of City		
	Municipal Borough, Urban or Rural District, Burgh or District Council		
	Borough, Burgh or County Constituency Shown only when not coincident with other boundaries		
	Civil Parish Shown alternately when coincidence of boundaries occurs		
	Boundary Post or Stone		Police Station
	Church		Post Office
	Club House		Public Convenience
	Fire Engine Station		Public House
	Foot Bridge		Signal Box
	Fountain		Spring
	Guide Post		Telephone Call Box
	Mile Post		Telephone Call Post
	Mile Stone		Well

1:10,000 Raster Mapping

	Gravel Pit		Refuse tip or slag heap
	Rock		Rock (scattered)
	Boulders		Boulders (scattered)
	Shingle		Mud
	Sand		Sand Pit
	Slopes		Top of cliff
	General detail		Underground detail
	Overhead detail		Narrow gauge railway
	Multi-track railway		Single track railway
	County boundary (England only)		Civil, parish or community boundary
	District, Unitary, Metropolitan, London Borough boundary		Constituency boundary
	Area of wooded vegetation		Non-coniferous trees
	Non-coniferous trees (scattered)		Coniferous trees
	Coniferous trees (scattered)		Positioned tree
	Orchard		Coppice or Osiers
	Rough Grassland		Heath
	Scrub		Marsh, Salt Marsh or Reeds
	Water feature		Flow arrows
	Mean high water (springs)		Mean low water (springs)
	Telephone line (where shown)		Electricity transmission line (with poles)
	Bench mark (where shown)		Triangulation station
	Point feature (e.g. Guide Post or Mile Stone)		Pylon, flare stack or lighting tower
	Site of (antiquity)		Glasshouse
	General Building		Important Building



Historical Mapping & Photography included:

Mapping Type	Scale	Date	Pg
Lancashire And Furness	1:10,560	1851	3
Cheshire	1:10,560	1882	4
Lancashire And Furness	1:10,560	1894	5
Cheshire	1:10,560	1899 - 1900	6
Lancashire And Furness	1:10,560	1909 - 1910	7
Cheshire	1:10,560	1913	8
Cheshire	1:10,560	1927 - 1928	9
Lancashire And Furness	1:10,560	1928	10
Lancashire And Furness	1:10,560	1928	11
Lancashire And Furness	1:10,560	1938	12
Cheshire	1:10,560	1938	13
Ordnance Survey Plan	1:10,000	1956 - 1957	14
Ordnance Survey Plan	1:10,000	1956	15
Ordnance Survey Plan	1:10,000	1965 - 1968	16
Ordnance Survey Plan	1:10,000	1973 - 1977	17
Liverpool	1:10,000	1974	18
Ordnance Survey Plan	1:10,000	1984 - 1989	19
Ordnance Survey Plan	1:10,000	1990 - 1991	20
10K Raster Mapping	1:10,000	1999	21
10K Raster Mapping	1:10,000	2006	22
VectorMap Local	1:10,000	2017	23

Historical Map - Slice A

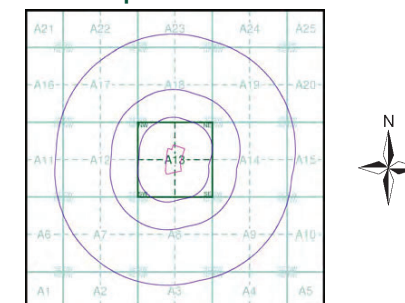

Order Details

Order Number: 138830569_1_1
 Customer Ref: A100795-1
 National Grid Reference: 335900, 393960
 Slice: A
 Site Area (Ha): 3.19
 Search Buffer (m): 1000

Site Details

Everton Football Club, Goodison Park, Goodison Road, Liverpool, L4 4EL

Landmark
 INFORMATION GROUP

Tel: 0844 844 9952
 Fax: 0844 844 9951
 Web: www.envirocheck.co.uk

Russian Military Mapping Legends

1:5,000 and 1:10,000 mapping

a. Not drawn to scale b. Drawn to scale

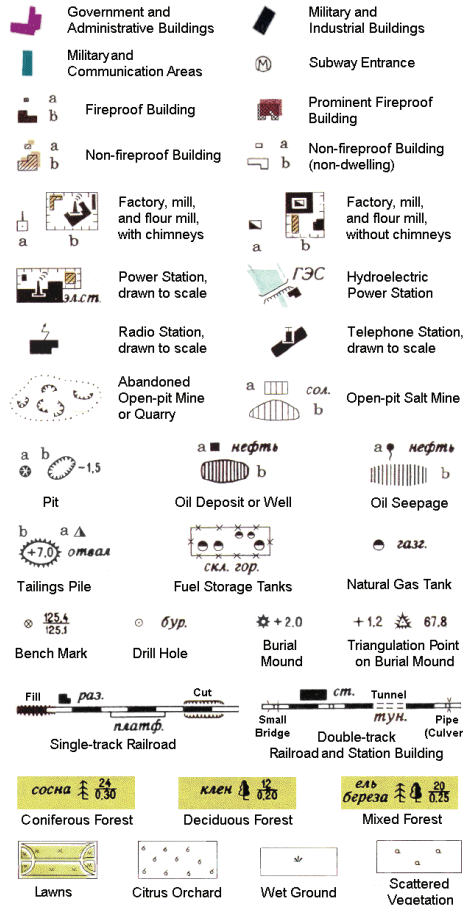

243.8 Values for prominent elevations

186.0 Numbers for spot elevations, depth soundings, contour lines, etc.

0.2 Velocity of the current, width of river bed, depth of river

Fractional terms: length and capacity of bridges; depth of fords and condition of the river bottom; height of forest and the diameter of trees

Russian Alphabet (For reference and phonetic interpretation of map text)

А а (A)	З з (Z)	П п (P)	Ч ч (CH)
Б б (B)	И и (I)	Р р (R)	Ш ш (SH)
В в (V)	Й й (Y)	С с (S)	Щ щ (SHCH)
Г г (G)	К к (K)	Т т (T)	Ъ (-)
Д д (D)	Л л (L)	У у (U)	Ы (Y)
Е е (E)	М м (M)	Ф ф (F)	Ь (')
Ё ё (YO)	Н н (N)	Х х (KH)	Э э (E)
Ж ж (ZH)	О о (O)	Ц ц (TS)	Ю ю (YU or IU)
			Я я (YA or IA)

1:25,000 mapping

a. Not drawn to scale b. Drawn to scale

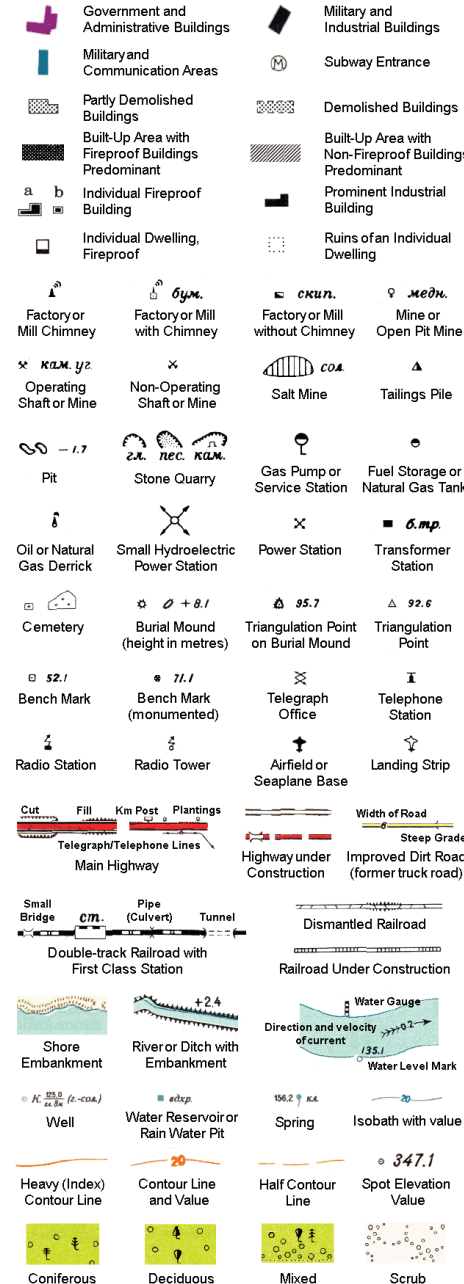

Key to Numbers on Mapping



Historical Mapping & Photography included:

Mapping Type	Scale	Date	Pg
Lancashire And Furness	1:10,560	1851	3
Cheshire	1:10,560	1882	4
Lancashire And Furness	1:10,560	1894	5
Cheshire	1:10,560	1899 - 1900	6
Lancashire And Furness	1:10,560	1909 - 1910	7
Cheshire	1:10,560	1913	8
Cheshire	1:10,560	1927 - 1928	9
Lancashire And Furness	1:10,560	1928	10
Lancashire And Furness	1:10,560	1928	11
Lancashire And Furness	1:10,560	1938	12
Cheshire	1:10,560	1938	13
Ordnance Survey Plan	1:10,000	1956 - 1957	14
Ordnance Survey Plan	1:10,000	1956	15
Ordnance Survey Plan	1:10,000	1965 - 1968	16
Ordnance Survey Plan	1:10,000	1973 - 1977	17
Liverpool	1:10,000	1974	18
Ordnance Survey Plan	1:10,000	1984 - 1989	19
Ordnance Survey Plan	1:10,000	1990 - 1991	20
10K Raster Mapping	1:10,000	1999	21
10K Raster Mapping	1:10,000	2006	22
VectorMap Local	1:10,000	2017	23

Russian Map - Slice A

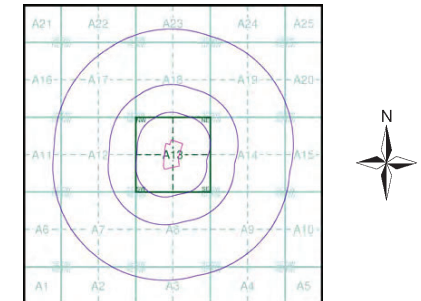

Order Details

Order Number: 138830569_1_1

Customer Ref: A100795-1

National Grid Reference: 335900, 393960

Slice: A

Site Area (Ha): 3.19

Search Buffer (m): 1000

Site Details

Everton Football Club, Goodison Park, Goodison Road, Liverpool, L4 4EL

Landmark
INFORMATION GROUP

Tel: 0844 844 9952
Fax: 0844 844 9951
Web: www.envirocheck.co.uk

334800 334800 335000 335200 335400 335600 335800 336000 336200 336400 336600 336800 337000 337200

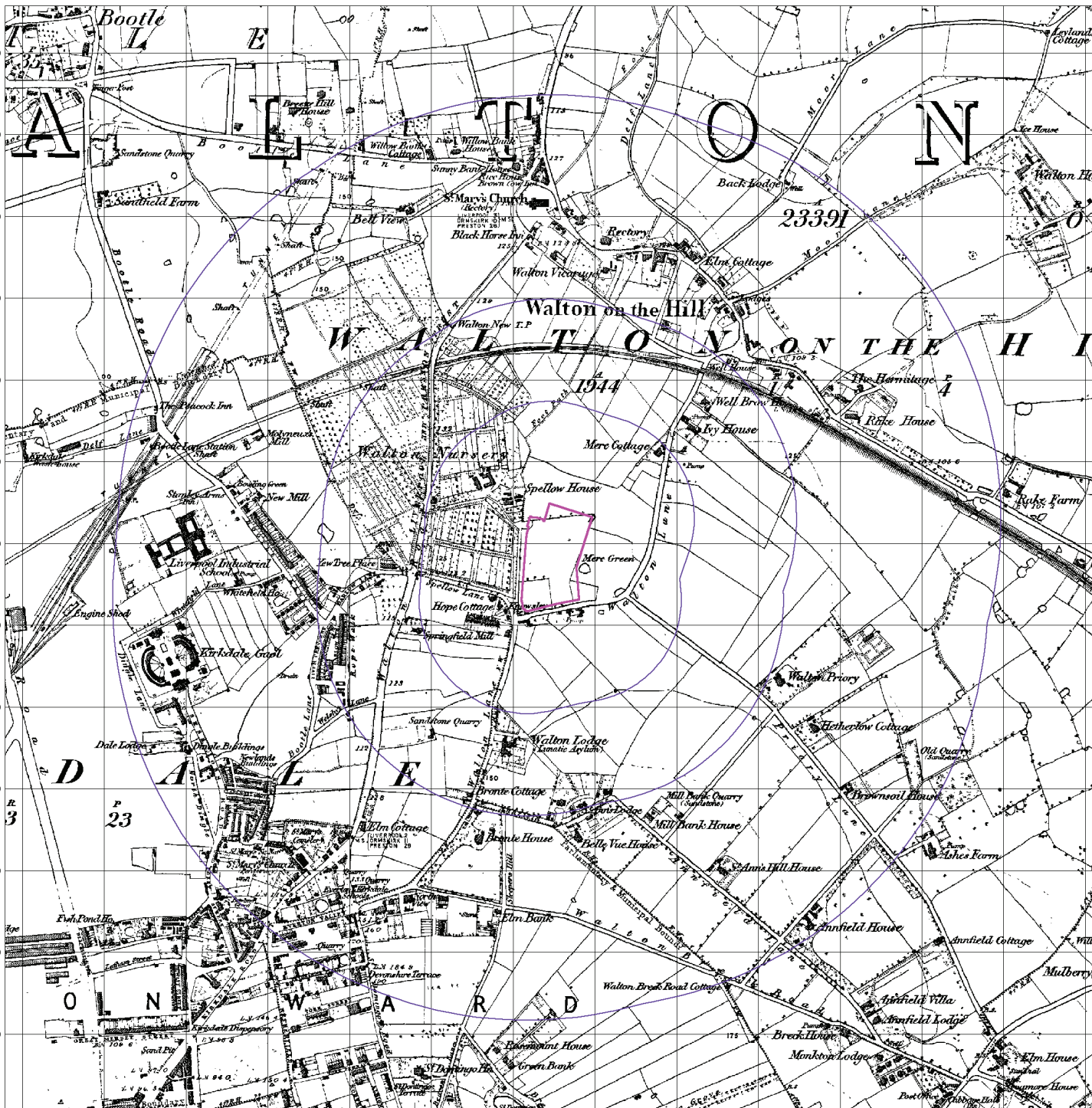

© Crown copyright and Landmark Information Group Limited 2015. All Rights Reserved.



Lancashire And Furness

Published 1851

Source map scale - 1:10,560

The historical maps shown were reproduced from maps predominantly held at the scale adopted for England, Wales and Scotland in the 1840's. In 1854 the 1:2,500 scale was adopted for mapping urban areas; these maps were used to update the 1:10,560 maps. The published date given therefore is often some years later than the surveyed date. Before 1938, all OS maps were based on the Cassini Projection, with independent surveys of a single county or group of counties, giving rise to significant inaccuracies in outlying areas. In the late 1940's, a Provisional Edition was produced, which updated the 1:10,560 mapping from a number of sources. The maps appear unfinished - with all military camps and other strategic sites removed. These maps were initially overprinted with the National Grid. In 1970, the first 1:10,000 maps were produced using the Transverse Mercator Projection. The revision process continued until recently, with new editions appearing every 10 years or so for urban areas.

Map Name(s) and Date(s)

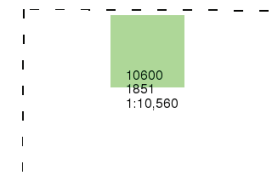

Historical Map - Slice A

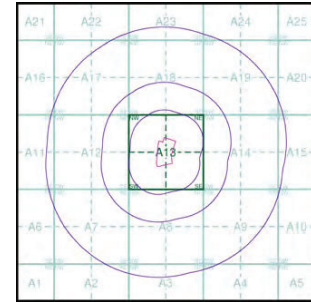

Order Details

Order Number: 138830569_1_1
Customer Ref: A100795-1
National Grid Reference: 335900, 393960
Slice: A
Site Area (Ha): 3.19
Search Buffer (m): 1000

Site Details

Everton Football Club, Goodison Park, Goodison Road, Liverpool, L4 4EL



Tel: 0844 844 9952
Fax: 0844 844 9951
Web: www.envirocheck.co.uk



Cheshire

Published 1882

Source map scale - 1:10,560

The historical maps shown were reproduced from maps predominantly held at the scale adopted for England, Wales and Scotland in the 1840's. In 1854 the 1:2,500 scale was adopted for mapping urban areas; these maps were used to update the 1:10,560 maps. The published date given therefore is often some years later than the surveyed date. Before 1938, all OS maps were based on the Cassini Projection, with independent surveys of a single county or group of counties, giving rise to significant inaccuracies in outlying areas. In the late 1940's, a Provisional Edition was produced, which updated the 1:10,560 mapping from a number of sources. The maps appear unfinished - with all military camps and other strategic sites removed. These maps were initially overprinted with the National Grid. In 1970, the first 1:10,000 maps were produced using the Transverse Mercator Projection. The revision process continued until recently, with new editions appearing every 10 years or so for urban areas.

Map Name(s) and Date(s)

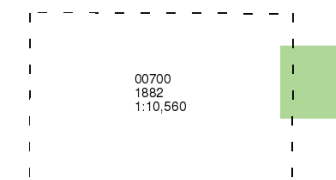

Historical Map - Slice A

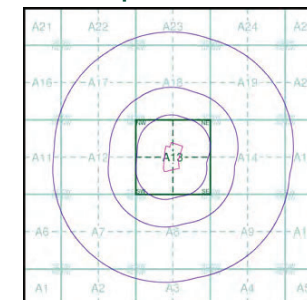

Order Details

Order Number: 138830569_1_1
Customer Ref: A100795-1
National Grid Reference: 335900, 393960
Slice: A
Site Area (Ha): 3.19
Search Buffer (m): 1000

Site Details

Everton Football Club, Goodison Park, Goodison Road,
Liverpool, L4 4EL

Landmark
INFORMATION GROUP

Tel: 0844 844 9952
Fax: 0844 844 9951
Web: www.envirocheck.co.uk

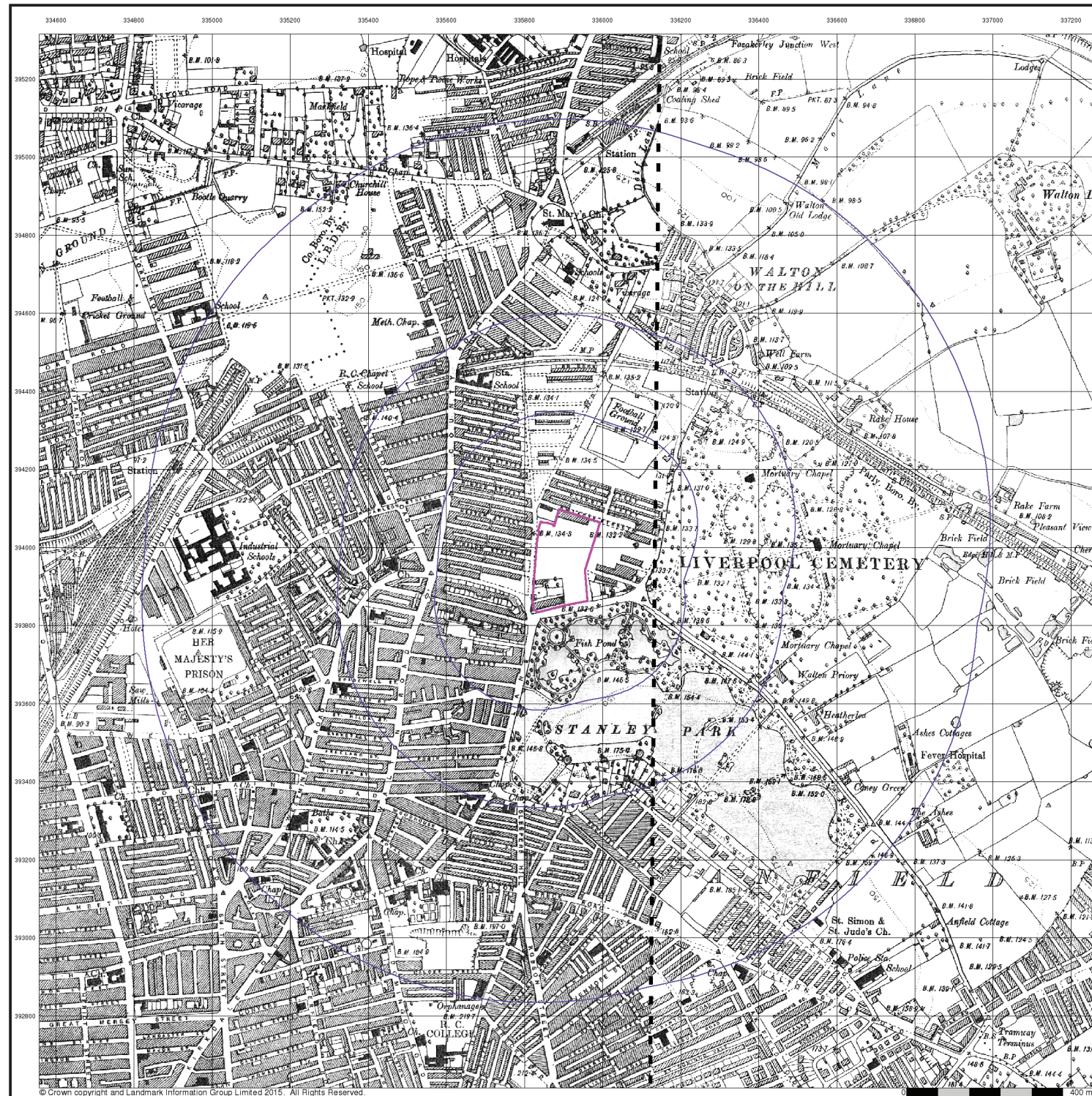

Lancashire And Furness

Published 1894

Source map scale - 1:10,560

The historical maps shown were reproduced from maps predominantly held at the scale adopted for England, Wales and Scotland in the 1840's. In 1854 the 1:2,500 scale was adopted for mapping urban areas; these maps were used to update the 1:10,560 maps. The published date given therefore is often some years later than the surveyed date. Before 1938, all OS maps were based on the Cassini Projection, with independent surveys of a single county or group of counties, giving rise to significant inaccuracies in outlying areas. In the late 1940's, a Provisional Edition was produced, which updated the 1:10,560 mapping from a number of sources. The maps appear unfinished - with all military camps and other strategic sites removed. These maps were initially overprinted with the National Grid. In 1970, the first 1:10,000 maps were produced using the Transverse Mercator Projection. The revision process continued until recently, with new editions appearing every 10 years or so for urban areas.

Map Name(s) and Date(s)

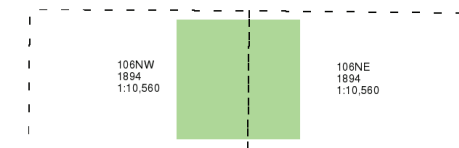

Historical Map - Slice A

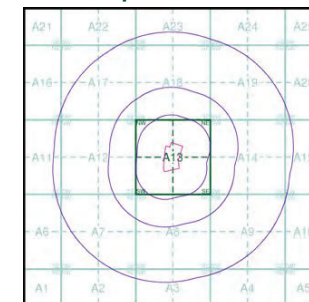

Order Details

Order Number: 138830569_1_1
Customer Ref: A100795-1
National Grid Reference: 335900, 393960
Slice: A
Site Area (Ha): 3.19
Search Buffer (m): 1000

Site Details

Everton Football Club, Goodison Park, Goodison Road, Liverpool, L4 4EL

Landmark
INFORMATION GROUP

Tel: 0844 844 9952
Fax: 0844 844 9951
Web: www.envirocheck.co.uk



Cheshire

Published 1899 - 1900

Source map scale - 1:10,560

The historical maps shown were reproduced from maps predominantly held at the scale adopted for England, Wales and Scotland in the 1840's. In 1854 the 1:2,500 scale was adopted for mapping urban areas; these maps were used to update the 1:10,560 maps. The published date given therefore is often some years later than the surveyed date. Before 1938, all OS maps were based on the Cassini Projection, with independent surveys of a single county or group of counties, giving rise to significant inaccuracies in outlying areas. In the late 1940's, a Provisional Edition was produced, which updated the 1:10,560 mapping from a number of sources. The maps appear unfinished - with all military camps and other strategic sites removed. These maps were initially overprinted with the National Grid. In 1970, the first 1:10,000 maps were produced using the Transverse Mercator Projection. The revision process continued until recently, with new editions appearing every 10 years or so for urban areas.

Map Name(s) and Date(s)

007NE 1899 1:10,560	
007SE 1900 1:10,560	

Historical Map - Slice A

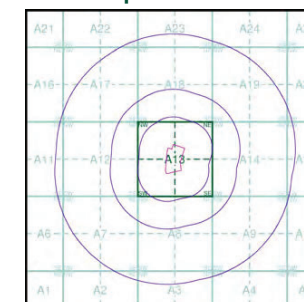

Order Details

Order Number: 138830569_1_1
Customer Ref: A100795-1
National Grid Reference: 335900, 393960
Slice: A
Site Area (Ha): 3.19
Search Buffer (m): 1000

Site Details

Everton Football Club, Goodison Park, Goodison Road,
Liverpool, L4 4EL

Landmark
INFORMATION GROUP

Tel: 0844 844 9952
Fax: 0844 844 9951
Web: www.envirocheck.co.uk

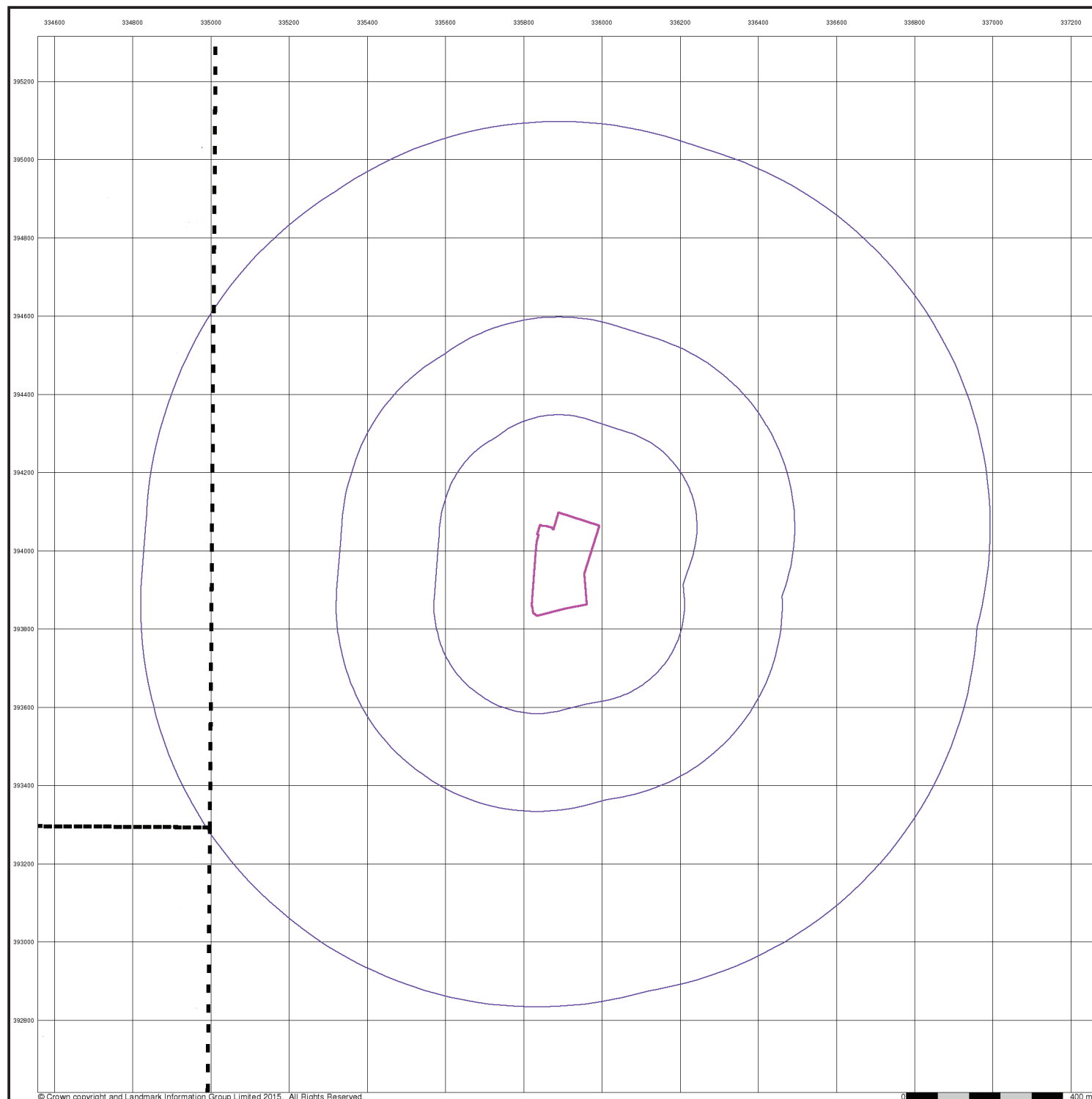

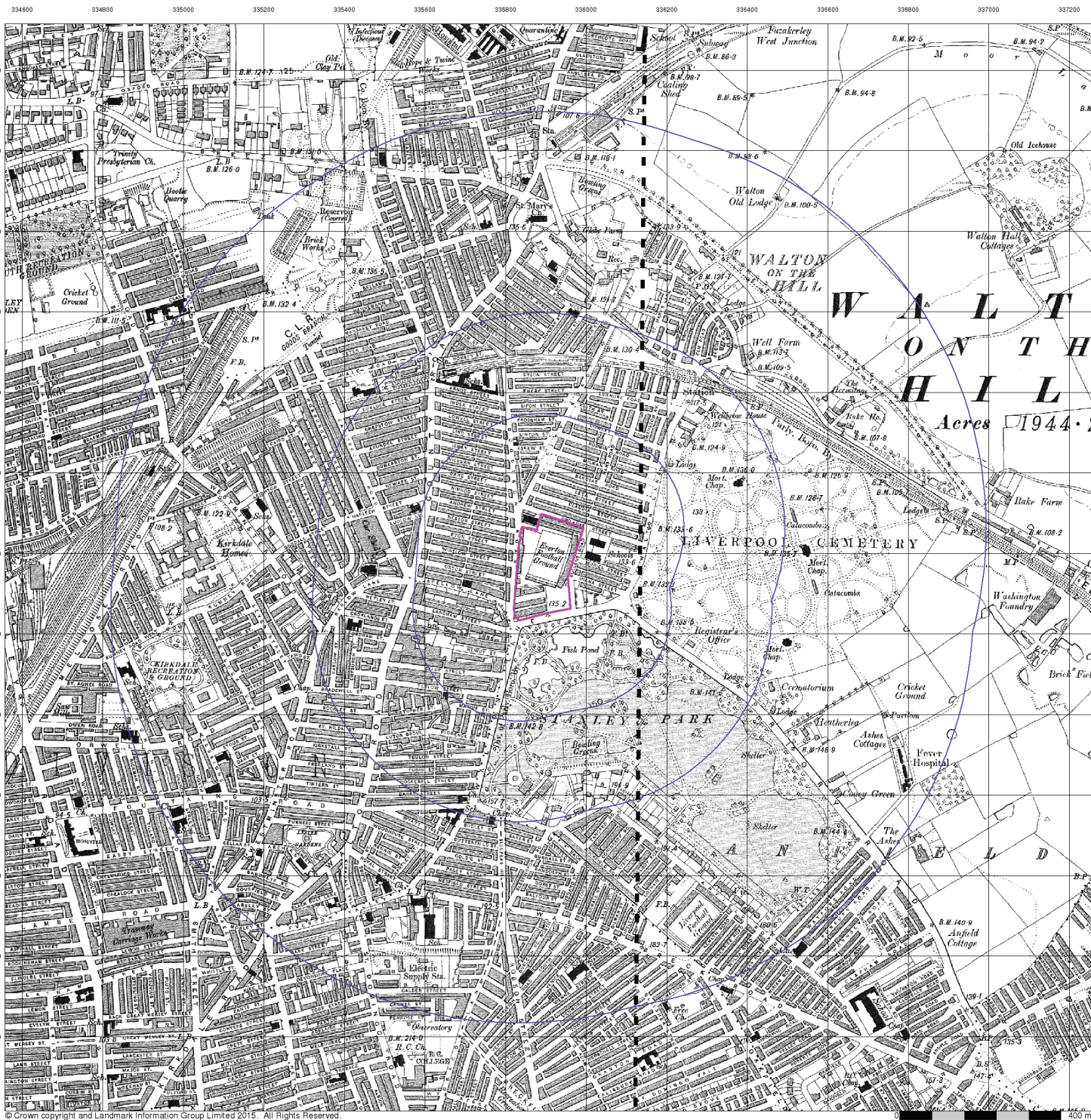

Lancashire And Furness

Published 1909 - 1910

Source map scale - 1:10,560

The historical maps shown were reproduced from maps predominantly held at the scale adopted for England, Wales and Scotland in the 1840's. In 1854 the 1:2,500 scale was adopted for mapping urban areas; these maps were used to update the 1:10,560 maps. The published date given therefore is often some years later than the surveyed date. Before 1938, all OS maps were based on the Cassini Projection, with independent surveys of a single county or group of counties, giving rise to significant inaccuracies in outlying areas. In the late 1940's, a Provisional Edition was produced, which updated the 1:10,560 mapping from a number of sources. The maps appear unfinished - with all military camps and other strategic sites removed. These maps were initially overprinted with the National Grid. In 1970, the first 1:10,000 maps were produced using the Transverse Mercator Projection. The revision process continued until recently, with new editions appearing every 10 years or so for urban areas.

Map Name(s) and Date(s)

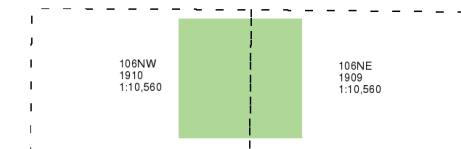

Historical Map - Slice A

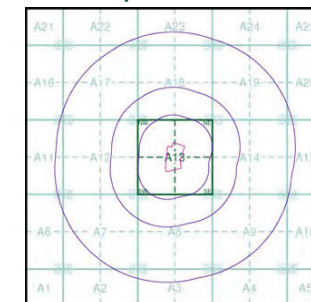

Order Details

Order Number: 138830569_1_1
 Customer Ref: A100795-1
 National Grid Reference: 335900, 393960
 Slice: A
 Site Area (Ha): 3.19
 Search Buffer (m): 1000

Site Details

Everton Football Club, Goodison Park, Goodison Road, Liverpool, L4 4EL

Landmark
 INFORMATION GROUP

Tel: 0844 844 9952
 Fax: 0844 844 9951
 Web: www.envirocheck.co.uk



Cheshire

Published 1913

Source map scale - 1:10,560

The historical maps shown were reproduced from maps predominantly held at the scale adopted for England, Wales and Scotland in the 1840's. In 1854 the 1:2,500 scale was adopted for mapping urban areas; these maps were used to update the 1:10,560 maps. The published date given therefore is often some years later than the surveyed date. Before 1938, all OS maps were based on the Cassini Projection, with independent surveys of a single county or group of counties, giving rise to significant inaccuracies in outlying areas. In the late 1940's, a Provisional Edition was produced, which updated the 1:10,560 mapping from a number of sources. The maps appear unfinished - with all military camps and other strategic sites removed. These maps were initially overprinted with the National Grid. In 1970, the first 1:10,000 maps were produced using the Transverse Mercator Projection. The revision process continued until recently, with new editions appearing every 10 years or so for urban areas.

Map Name(s) and Date(s)

007NE 1913 1:10,560	
007SE 1913 1:10,560	

Historical Map - Slice A

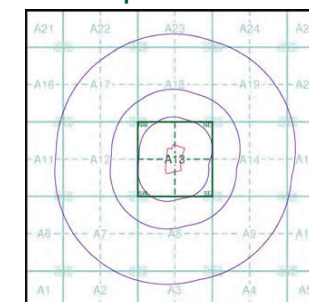

Order Details

Order Number: 138830569_1_1
Customer Ref: A100795-1
National Grid Reference: 335900, 393960
Slice: A
Site Area (Ha): 3.19
Search Buffer (m): 1000

Site Details

Everton Football Club, Goodison Park, Goodison Road,
Liverpool, L4 4EL

Landmark
INFORMATION GROUP

Tel: 0844 844 9952
Fax: 0844 844 9951
Web: www.envirocheck.co.uk



Cheshire

Published 1927 - 1928

Source map scale - 1:10,560

The historical maps shown were reproduced from maps predominantly held at the scale adopted for England, Wales and Scotland in the 1840's. In 1854 the 1:2,500 scale was adopted for mapping urban areas; these maps were used to update the 1:10,560 maps. The published date given therefore is often some years later than the surveyed date. Before 1938, all OS maps were based on the Cassini Projection, with independent surveys of a single county or group of counties, giving rise to significant inaccuracies in outlying areas. In the late 1940's, a Provisional Edition was produced, which updated the 1:10,560 mapping from a number of sources. The maps appear unfinished - with all military camps and other strategic sites removed. These maps were initially overprinted with the National Grid. In 1970, the first 1:10,000 maps were produced using the Transverse Mercator Projection. The revision process continued until recently, with new editions appearing every 10 years or so for urban areas.

Map Name(s) and Date(s)

007NE 1928 1:10,560	
007SE 1927 1:10,560	

Historical Map - Slice A

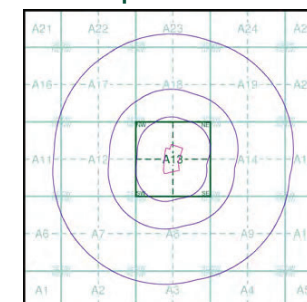

Order Details

Order Number: 138830569_1_1
Customer Ref: A100795-1
National Grid Reference: 335900, 393960
Slice: A
Site Area (Ha): 3.19
Search Buffer (m): 1000

Site Details

Everton Football Club, Goodison Park, Goodison Road,
Liverpool, L4 4EL

Landmark
INFORMATION GROUP

Tel: 0844 844 9952
Fax: 0844 844 9951
Web: www.envirocheck.co.uk



Lancashire And Furness

Published 1928

Source map scale - 1:10,560

The historical maps shown were reproduced from maps predominantly held at the scale adopted for England, Wales and Scotland in the 1840's. In 1854 the 1:2,500 scale was adopted for mapping urban areas; these maps were used to update the 1:10,560 maps. The published date given therefore is often some years later than the surveyed date. Before 1938, all OS maps were based on the Cassini Projection, with independent surveys of a single county or group of counties, giving rise to significant inaccuracies in outlying areas. In the late 1940's, a Provisional Edition was produced, which updated the 1:10,560 mapping from a number of sources. The maps appear unfinished - with all military camps and other strategic sites removed. These maps were initially overprinted with the National Grid. In 1970, the first 1:10,000 maps were produced using the Transverse Mercator Projection. The revision process continued until recently, with new editions appearing every 10 years or so for urban areas.

Map Name(s) and Date(s)

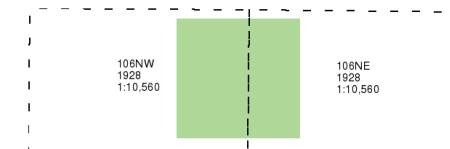

Historical Map - Slice A

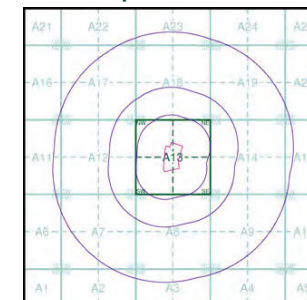

Order Details

Order Number: 138830569_1_1
Customer Ref: A100795-1
National Grid Reference: 335900, 393960
Slice: A
Site Area (Ha): 3.19
Search Buffer (m): 1000

Site Details

Everton Football Club, Goodison Park, Goodison Road, Liverpool, L4 4EL

Landmark
INFORMATION GROUP

Tel: 0844 844 9952
Fax: 0844 844 9951
Web: www.envirocheck.co.uk

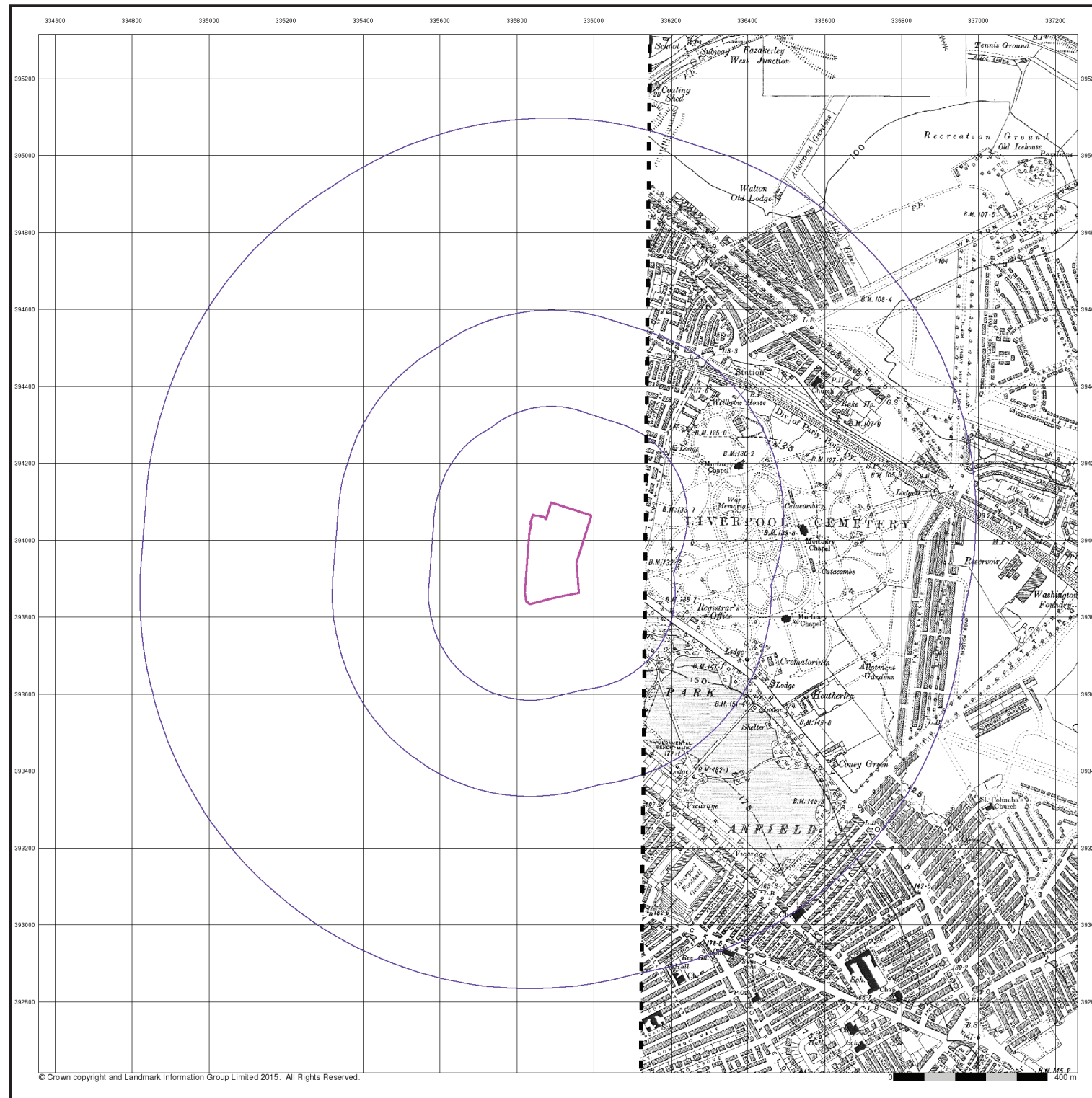

Lancashire And Furness

Published 1928

Source map scale - 1:10,560

The historical maps shown were reproduced from maps predominantly held at the scale adopted for England, Wales and Scotland in the 1840's. In 1854 the 1:2,500 scale was adopted for mapping urban areas; these maps were used to update the 1:10,560 maps. The published date given therefore is often some years later than the surveyed date. Before 1938, all OS maps were based on the Cassini Projection, with independent surveys of a single county or group of counties, giving rise to significant inaccuracies in outlying areas. In the late 1940's, a Provisional Edition was produced, which updated the 1:10,560 mapping from a number of sources. The maps appear unfinished - with all military camps and other strategic sites removed. These maps were initially overprinted with the National Grid. In 1970, the first 1:10,000 maps were produced using the Transverse Mercator Projection. The revision process continued until recently, with new editions appearing every 10 years or so for urban areas.

Map Name(s) and Date(s)

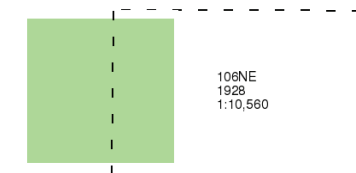

Historical Map - Slice A

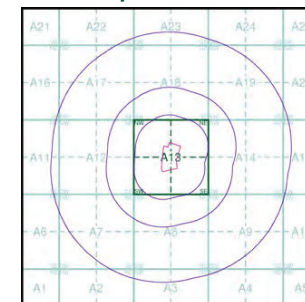

Order Details

Order Number: 138830569_1_1
 Customer Ref: A100795-1
 National Grid Reference: 335900, 393960
 Slice: A
 Site Area (Ha): 3.19
 Search Buffer (m): 1000

Site Details

Everton Football Club, Goodison Park, Goodison Road, Liverpool, L4 4EL

Landmark
 INFORMATION GROUP

Tel: 0844 844 9952
 Fax: 0844 844 9951
 Web: www.envirocheck.co.uk

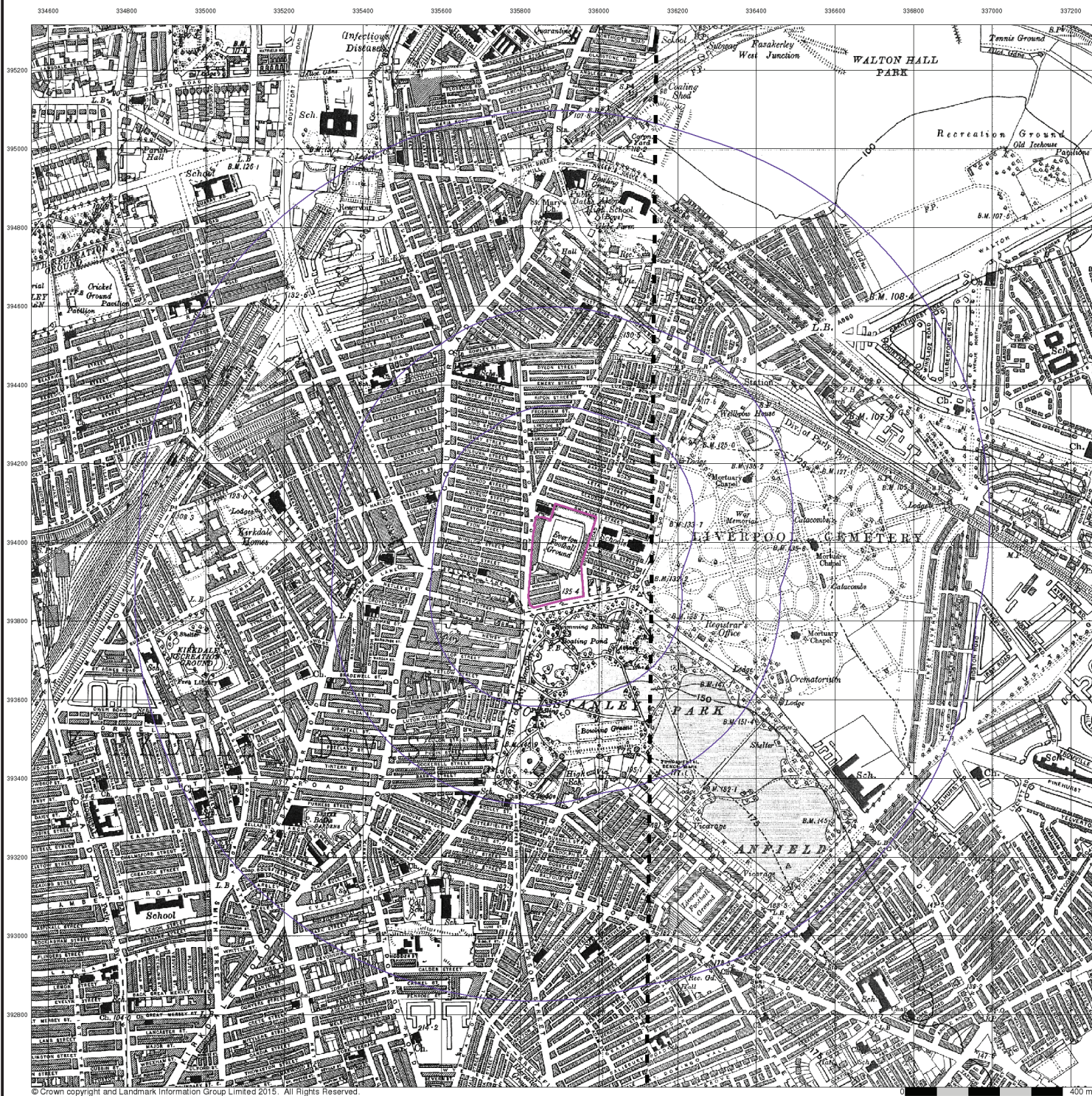

Lancashire And Furness

Published 1938

Source map scale - 1:10,560

The historical maps shown were reproduced from maps predominantly held at the scale adopted for England, Wales and Scotland in the 1840's. In 1854 the 1:2,500 scale was adopted for mapping urban areas; these maps were used to update the 1:10,560 maps. The published date given therefore is often some years later than the surveyed date. Before 1938, all OS maps were based on the Cassini Projection, with independent surveys of a single county or group of counties, giving rise to significant inaccuracies in outlying areas. In the late 1940's, a Provisional Edition was produced, which updated the 1:10,560 mapping from a number of sources. The maps appear unfinished - with all military camps and other strategic sites removed. These maps were initially overprinted with the National Grid. In 1970, the first 1:10,000 maps were produced using the Transverse Mercator Projection. The revision process continued until recently, with new editions appearing every 10 years or so for urban areas.

Map Name(s) and Date(s)

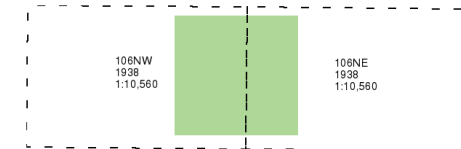

Historical Map - Slice A

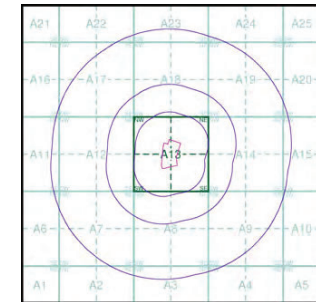

Order Details

Order Number: 138830569_1_1
 Customer Ref: A100795-1
 National Grid Reference: 335900, 393960
 Slice: A
 Site Area (Ha): 3.19
 Search Buffer (m): 1000

Site Details

Everton Football Club, Goodison Park, Goodison Road, Liverpool, L4 4EL

Landmark
 INFORMATION GROUP

Tel: 0844 844 9952
 Fax: 0844 844 9951
 Web: www.envirocheck.co.uk



Cheshire

Published 1938

Source map scale - 1:10,560

The historical maps shown were reproduced from maps predominantly held at the scale adopted for England, Wales and Scotland in the 1840's. In 1854 the 1:2,500 scale was adopted for mapping urban areas; these maps were used to update the 1:10,560 maps. The published date given therefore is often some years later than the surveyed date. Before 1938, all OS maps were based on the Cassini Projection, with independent surveys of a single county or group of counties, giving rise to significant inaccuracies in outlying areas. In the late 1940's, a Provisional Edition was produced, which updated the 1:10,560 mapping from a number of sources. The maps appear unfinished - with all military camps and other strategic sites removed. These maps were initially overprinted with the National Grid. In 1970, the first 1:10,000 maps were produced using the Transverse Mercator Projection. The revision process continued until recently, with new editions appearing every 10 years or so for urban areas.

Map Name(s) and Date(s)

007NE 1938 1:10,560	
007SE 1938 1:10,560	

Historical Map - Slice A

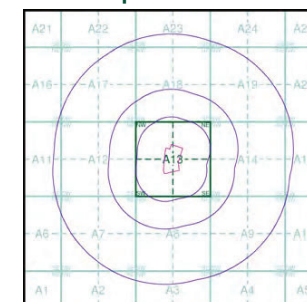

Order Details

Order Number: 138830569_1_1
Customer Ref: A100795-1
National Grid Reference: 335900, 393960
Slice: A
Site Area (Ha): 3.19
Search Buffer (m): 1000

Site Details

Everton Football Club, Goodison Park, Goodison Road,
Liverpool, L4 4EL

Landmark
INFORMATION GROUP

Tel: 0844 844 9952
Fax: 0844 844 9951
Web: www.envirocheck.co.uk