

## Appendix H – Bathymetric Survey



© Buro Happold Limited or its group companies.  
All Rights reserved. Buro Happold and its group companies assert (unless otherwise agreed in writing) their rights under s.77 to 88 of the Copyright, Designs and Patents Act 1988.

DO NOT SCALE THIS DRAWING.

**HEALTH AND SAFETY INFORMATION**  
IN ADDITION TO THE HAZARDS/RISKS NORMALLY ASSOCIATED WITH THE TYPES OF WORK DETAILED ON THIS DRAWING, NOTE THE FOLLOWING CONSTRUCTION.

MAINTENANCE/CLEANING/OPERATION.

DECOMMISSIONING/DEMOLITION.

**Notes**  
CONTOURS BASED ON PEELPORTS GROUP BATHYMETRIC SURVEY, DRAWING NO. LPD007\_1\_2016\_002, 20TH DECEMBER 2016.

00 TENDER	03.07.17	NG	NP
Rev	Description	Date	Dm Chd

INFORMATION

Status of drawing

BURO HAPPOLD

ENGINEERING

Camden Mill

Lower Bristol Road

Bath BA2 3DQ

UK

Tel: +44 (0)1225 320600

Fax: +44 (0)870 787 4148

Email: 0040026@burohappold.com

Web: www.burohappold.com

Architect

MEIS

Project

PROJECT BLUE

Drg Title

BATHYMETRIC SURVEY CONTOUR PLOT

Scales@A1 1:1000

Drawn by NG

Checked by NP

Date JULY 2017

Job No.

040026

Drawing No.

ES-BHE-ZX-LXX-DR-CG-0005

Rev

00

Not to be used for any other purpose without the written consent of Buro Happold Engineering - Site Investigation/3D Docking/Bathymetric Survey/CG-0005.dwg

## Appendix I – Buried Obstructions

Figure I-1 - Archive photo of Bramley-Moore Dock, with the High Level Coal Railway in the foreground [12]. Its relevance is for the nature of potential additional structures which may have residual foundations on the dock.

Figure I-2 - Archive photo of Bramley-Moore Dock, with the High Level coal Railway in the background [12]. Its relevance is for the nature of potential additional structures which may have residual foundations on the dock.

Figure I-3 - Archive drawing showing column foundations associated with current and former structures on the southern wharf.

Figure I-4 - Archive drawing showing footings associated with the former structure on the western wharf.

Figure I-5 - Archive drawing showing details of crane rail foundations on the eastern wharf.





**Figure I-1 - Archive photo of Bramley-Moore Dock, with the High Level Coal Railway in the foreground [12].**  
 Its relevance is for the nature of potential additional structures which may have residual foundations on the dock.

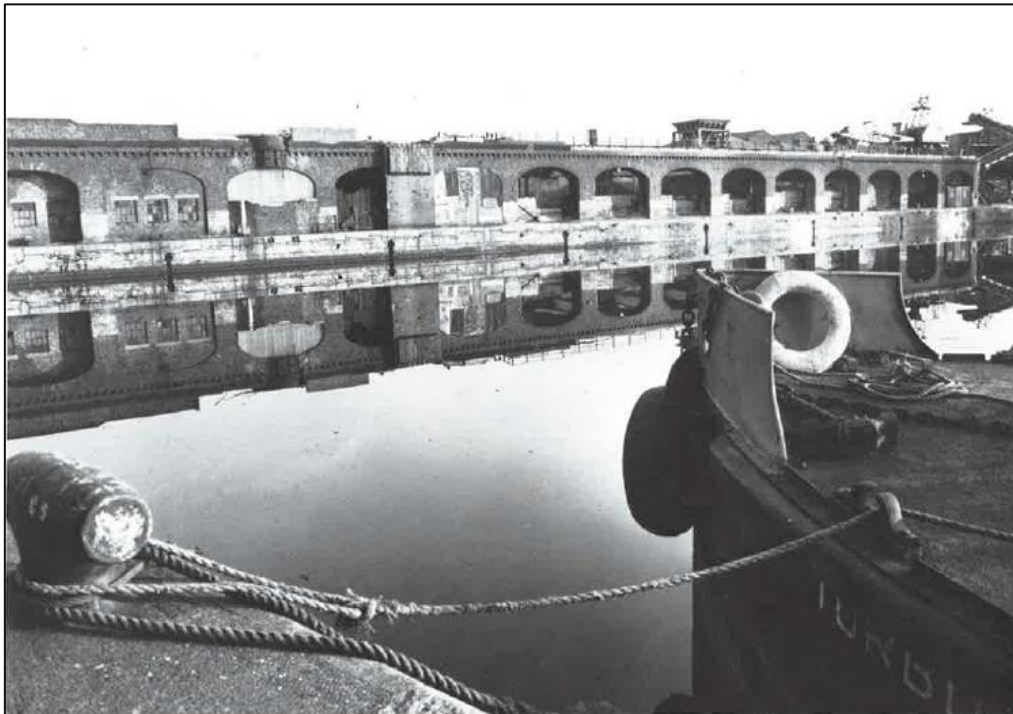

**Figure I-2 - Archive photo of Bramley-Moore Dock, with the High Level coal Railway in the background [12].**  
 Its relevance is for the nature of potential additional structures which may have residual foundations on the dock.

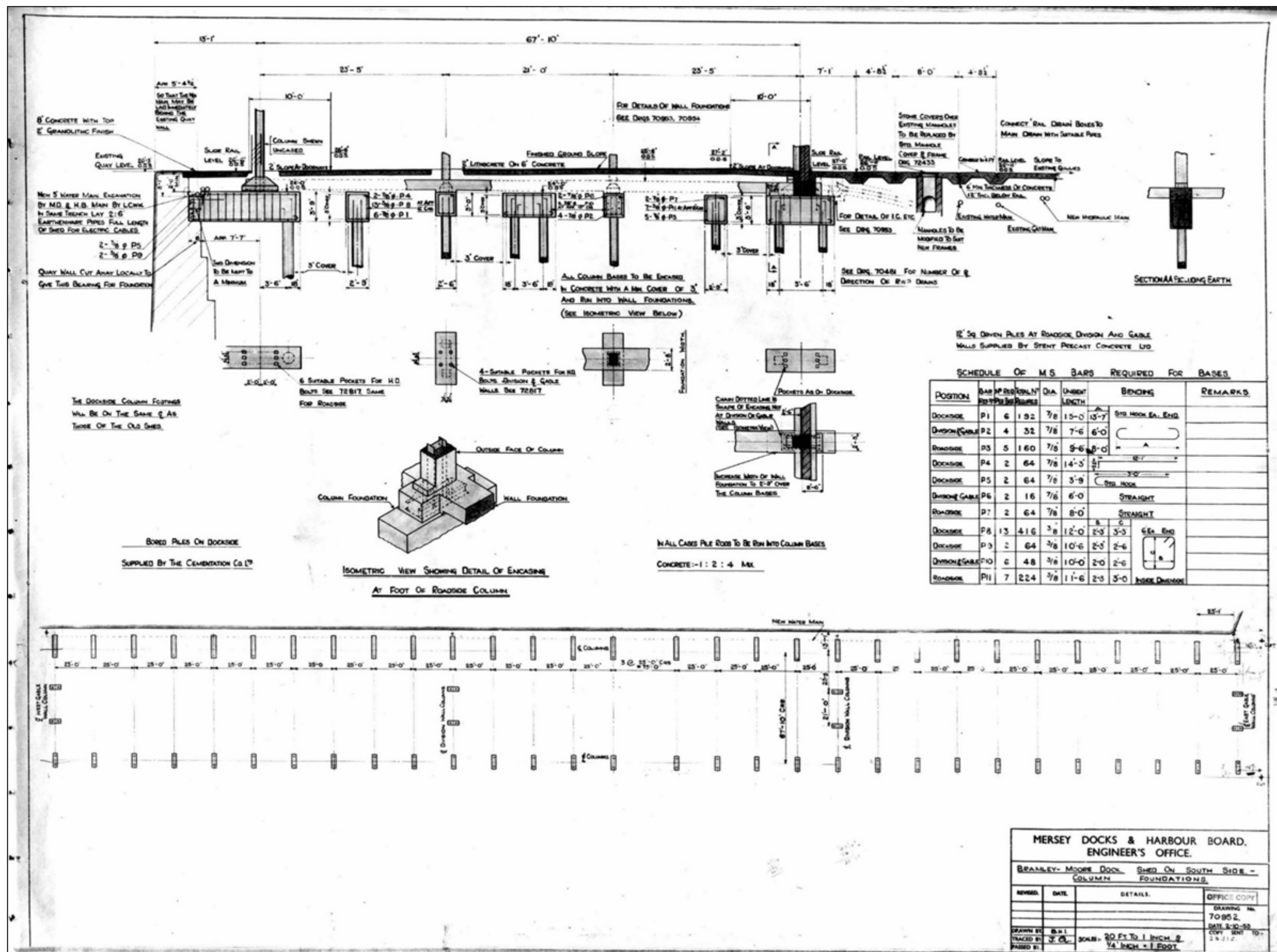

Figure I-3 - Archive drawing showing column foundations associated with current and former structures on the southern wharf.

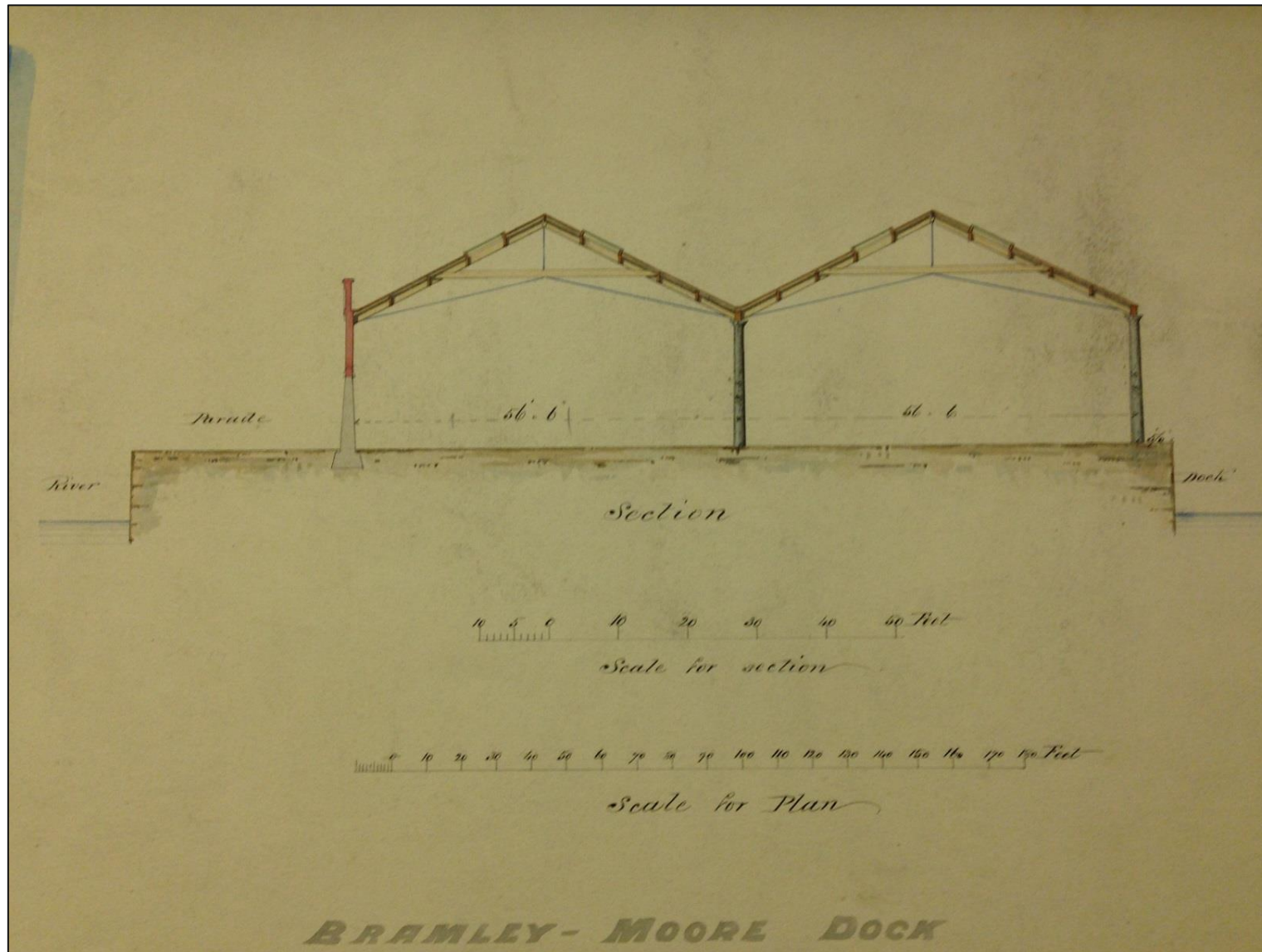

Figure I-4 - Archive drawing showing footings associated with the former structure on the western wharf.



# BRAMLEY - MOORE DOCK . EAST QUAY . Provision of Rough Cargo Berth

## Details of Crane Rail Foundations & Cross Section through Quay

Scales :-  $\frac{1}{2}$  & 1" to One Foot

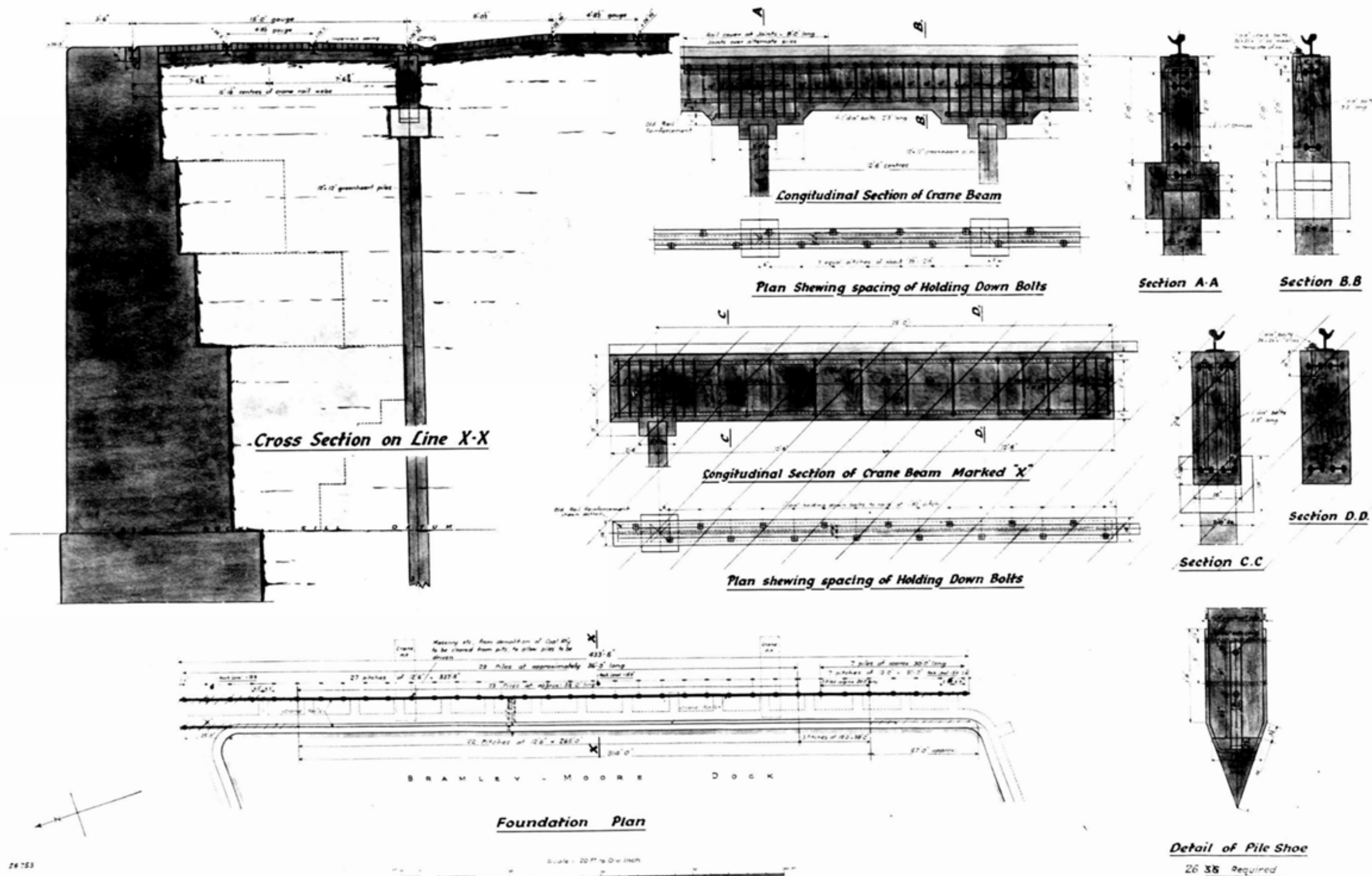

Figure I-5 - Archive drawing showing details of crane rail foundations on the eastern wharf.

## Appendix J – Drawings

Drawing ES-BHE-ZX-LXX-DR-CG-0002 – Site Walkover Plan

Drawing ES-BHE-ZX-LXX-DR-CG-0003 – Constraints Plan - Historical Information

Drawing ES-BHE-ZX-LXX-DR-CG-0004 – Constraints Plan - Conjectural



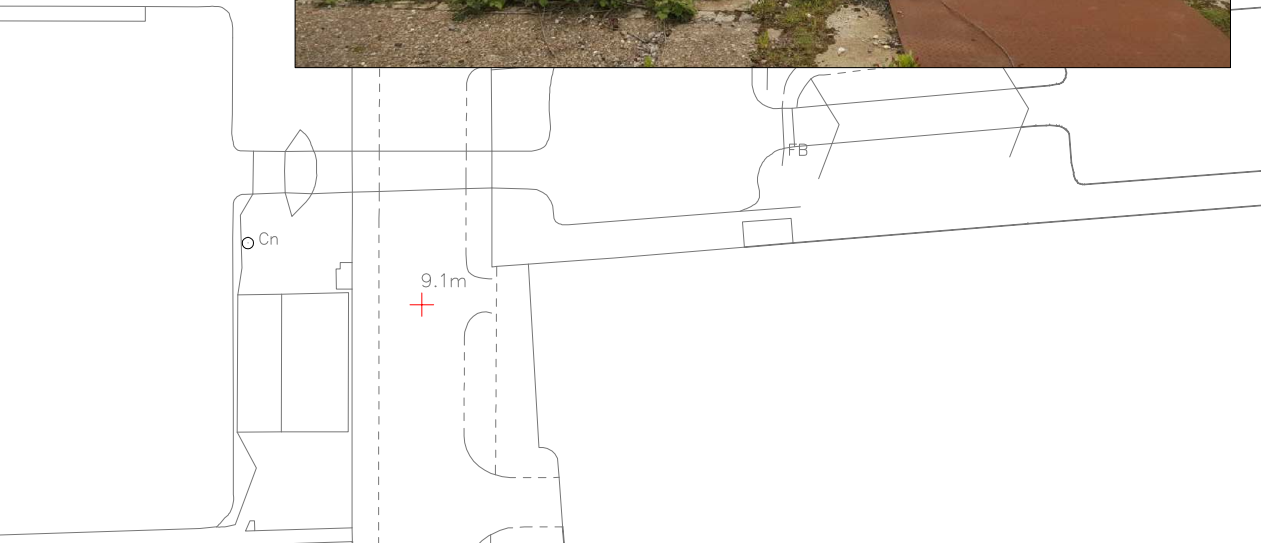
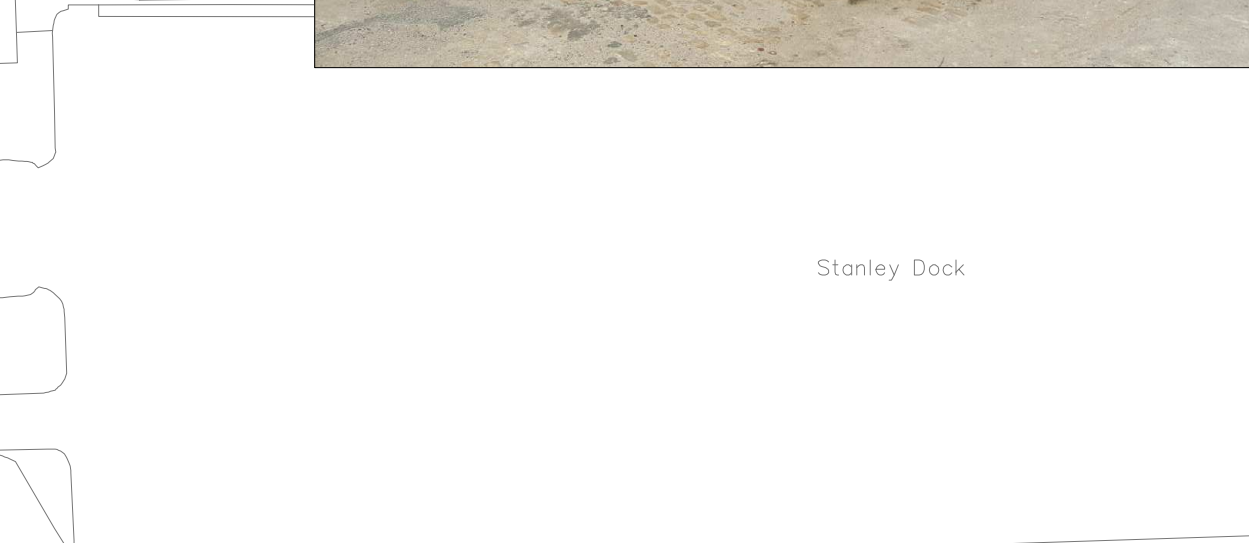
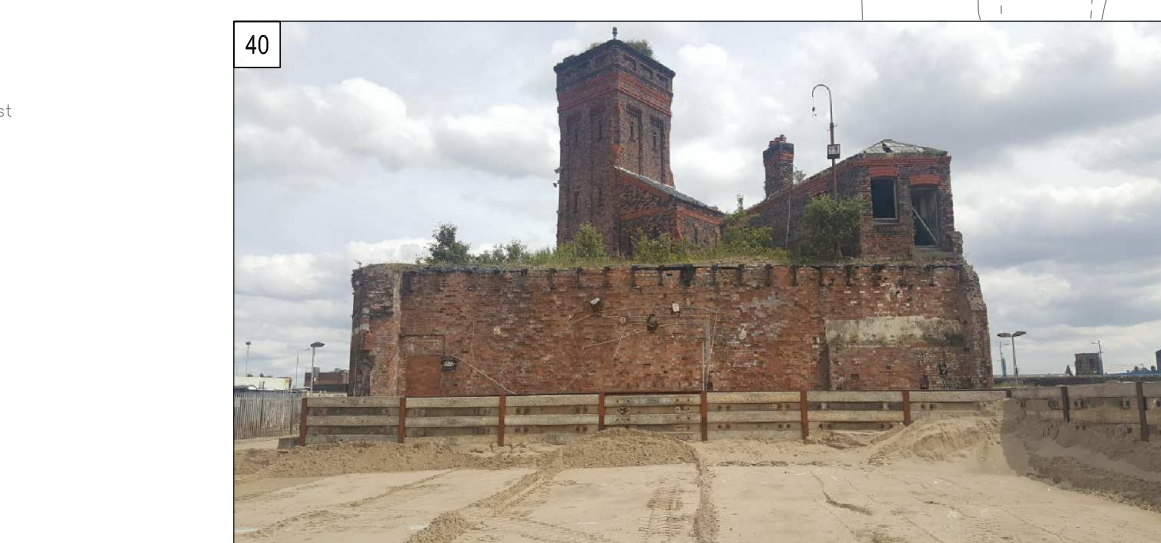
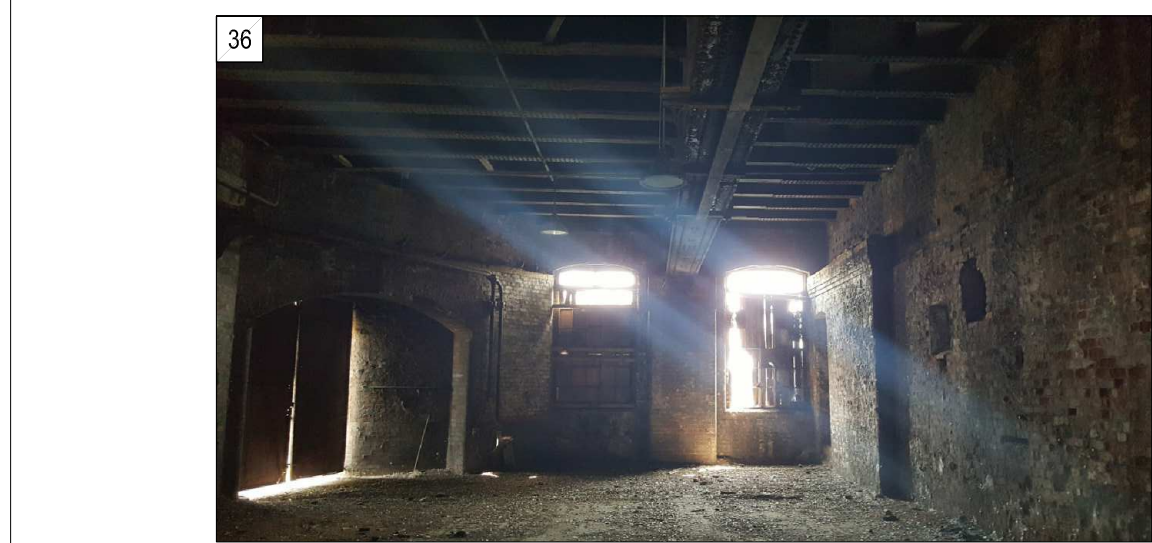
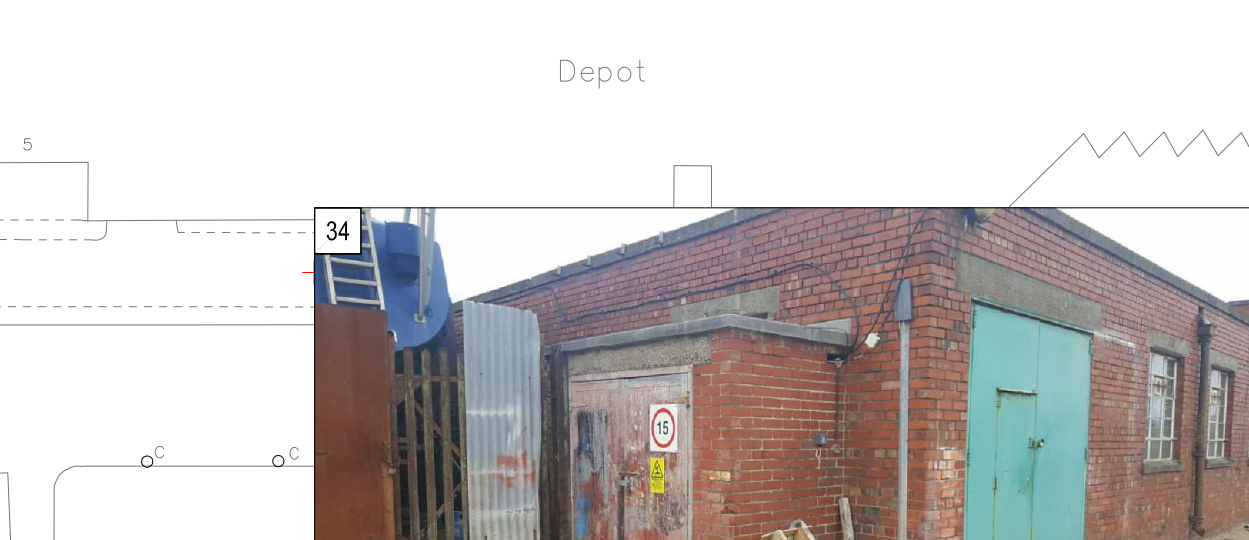
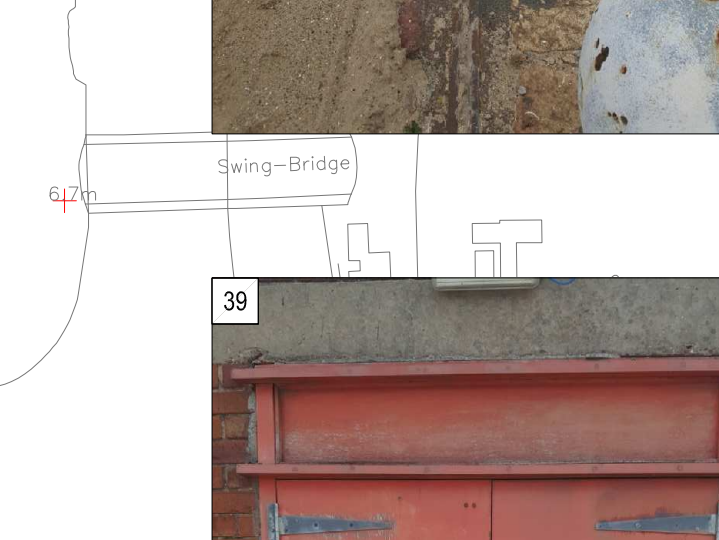
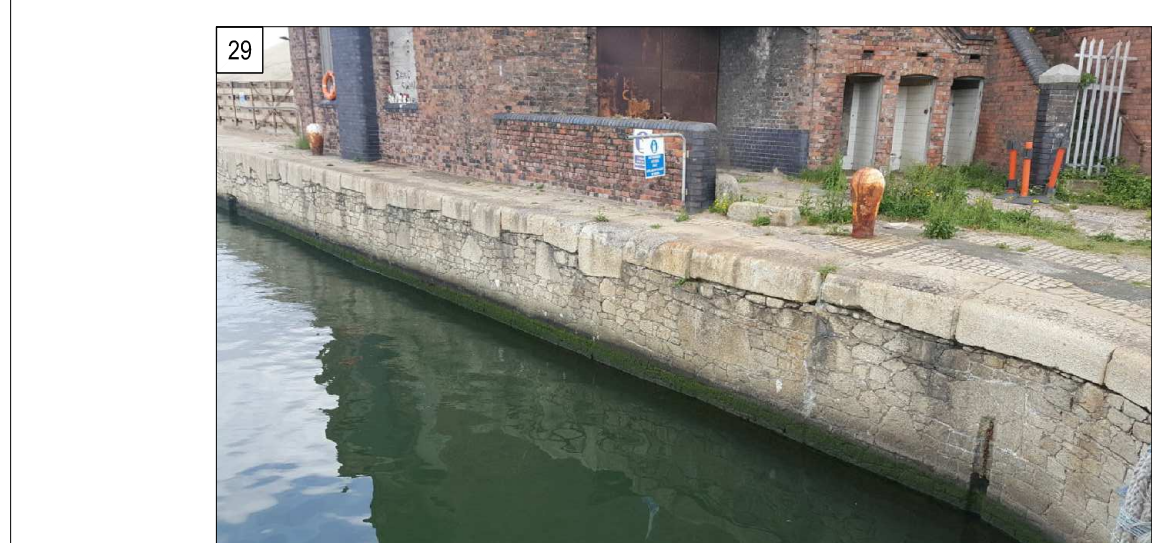
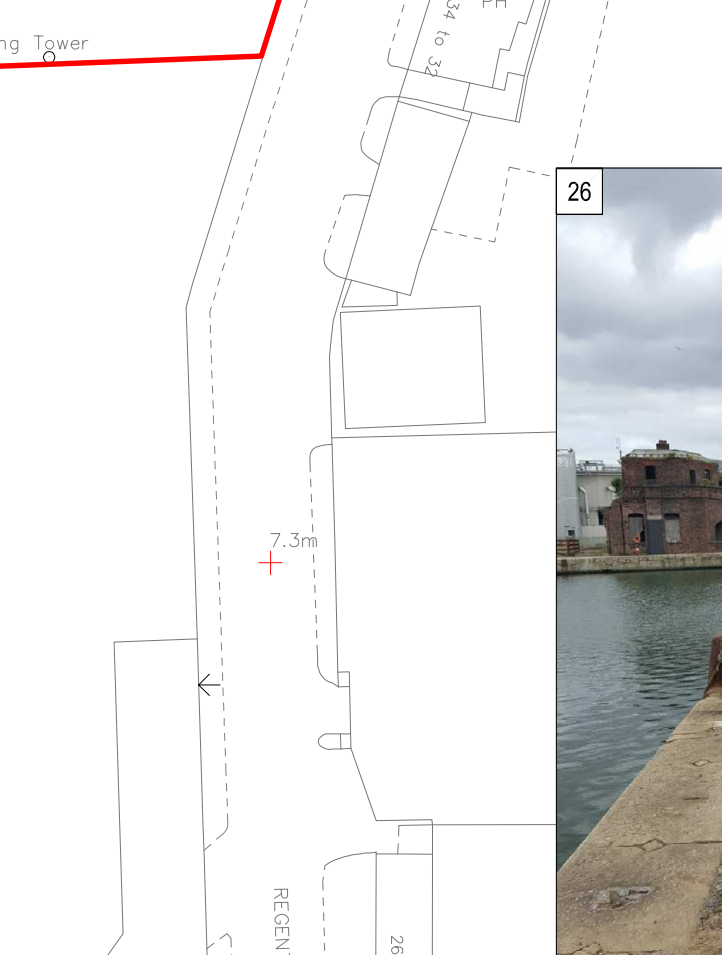
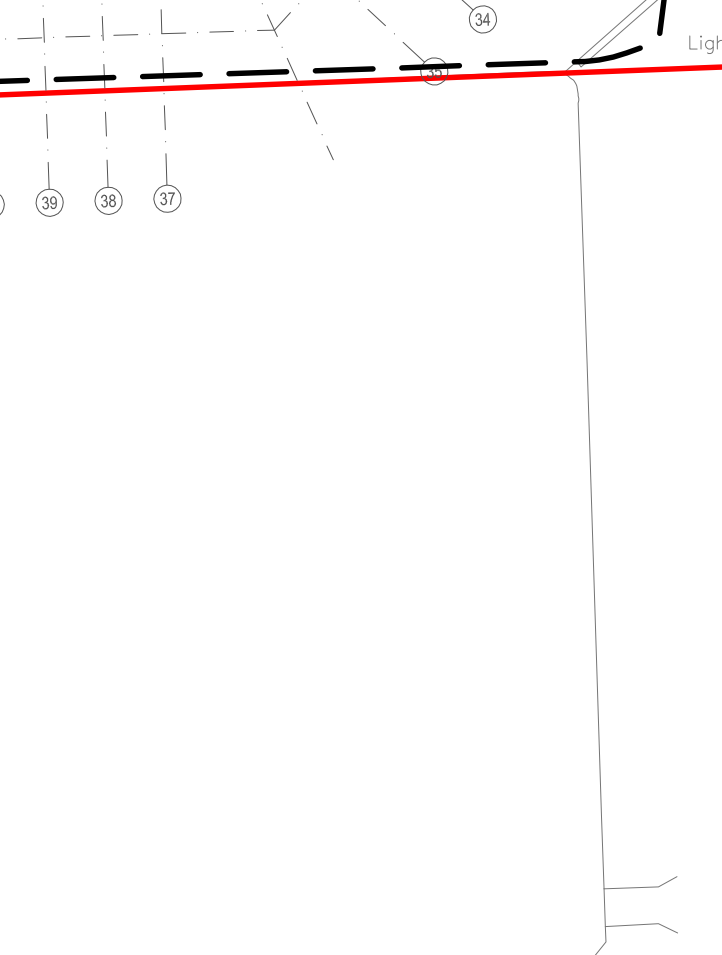
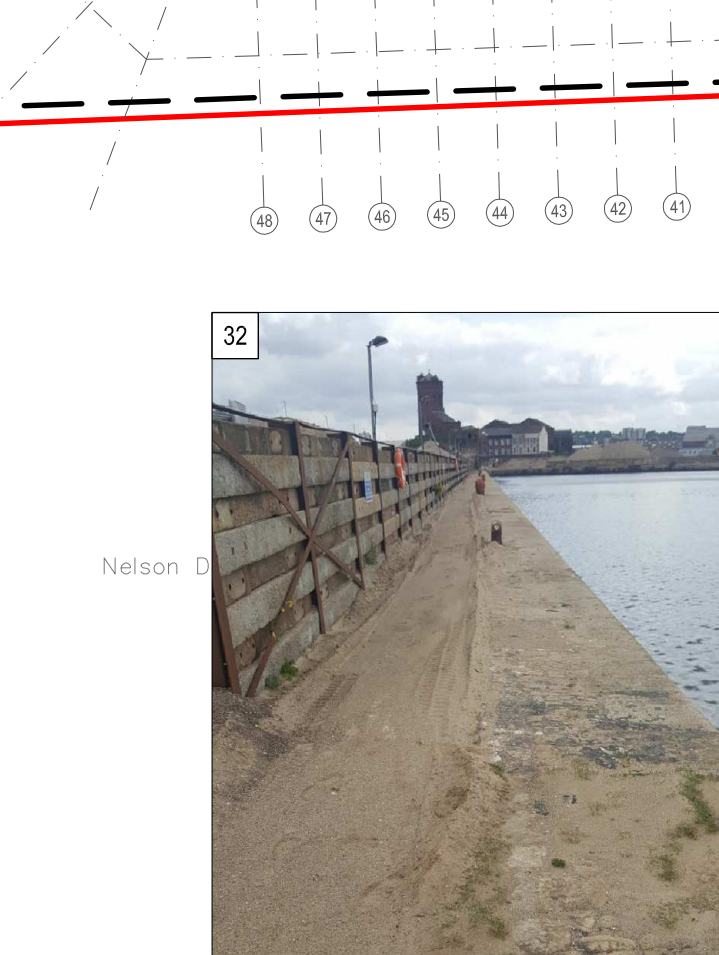
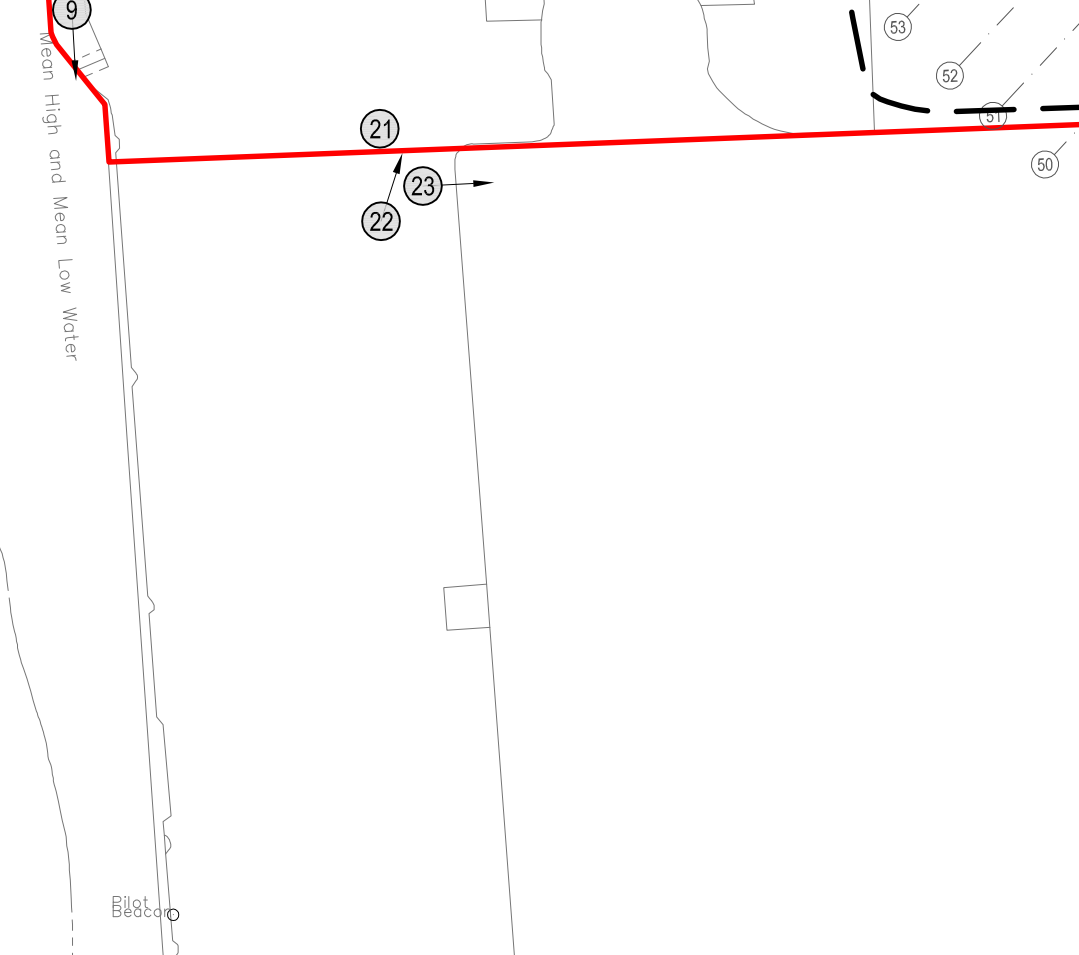
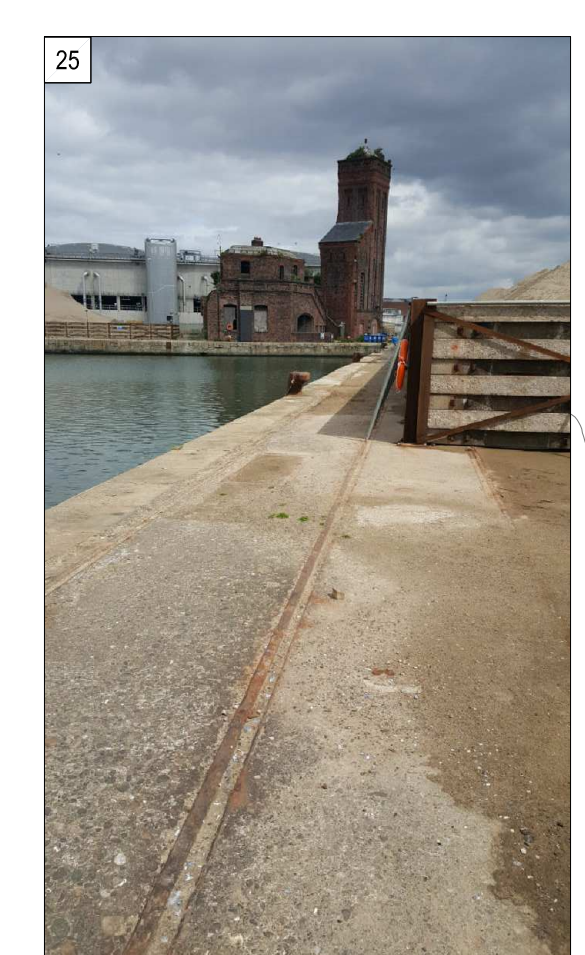
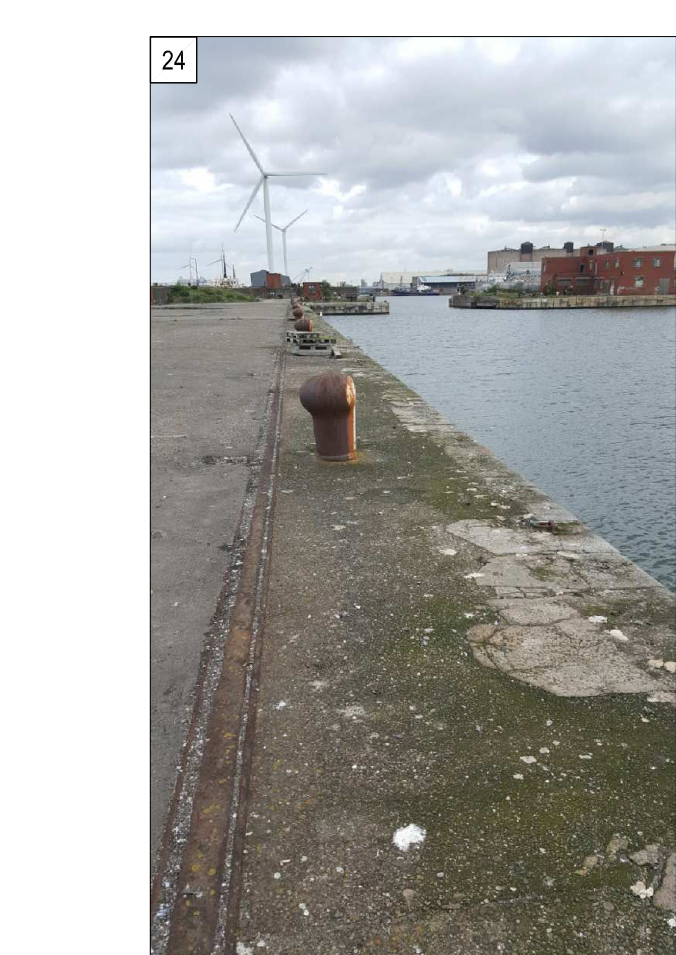
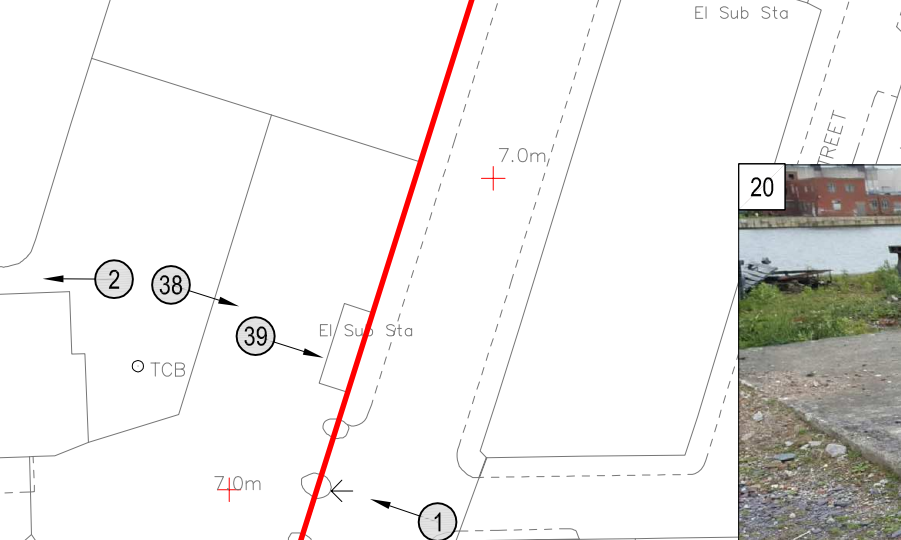
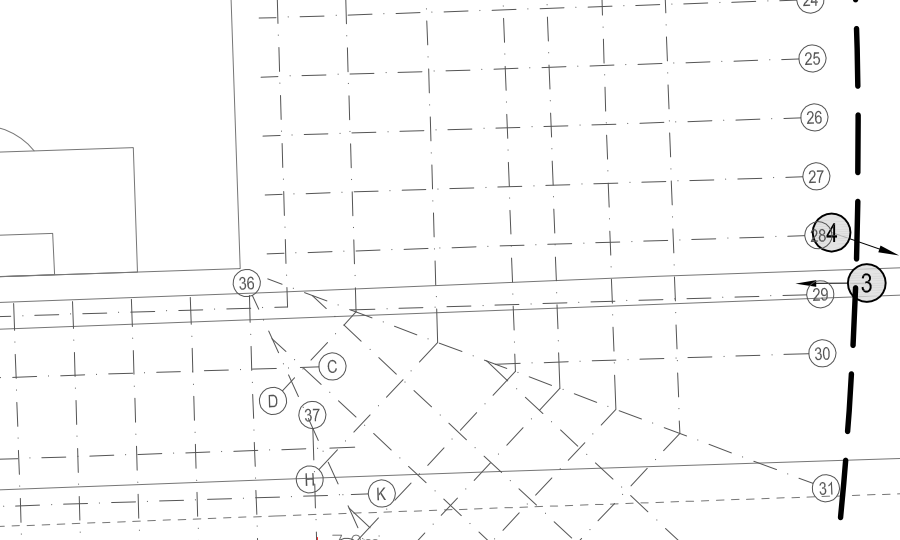
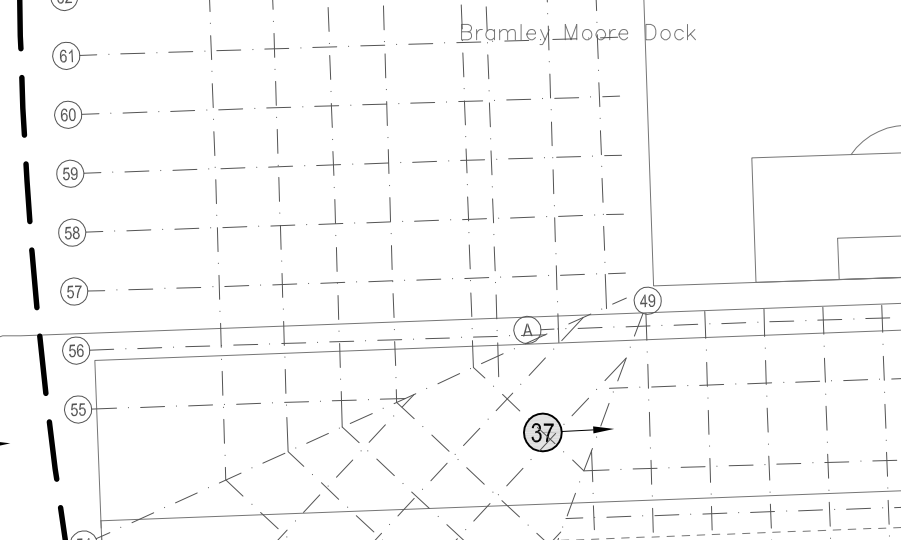
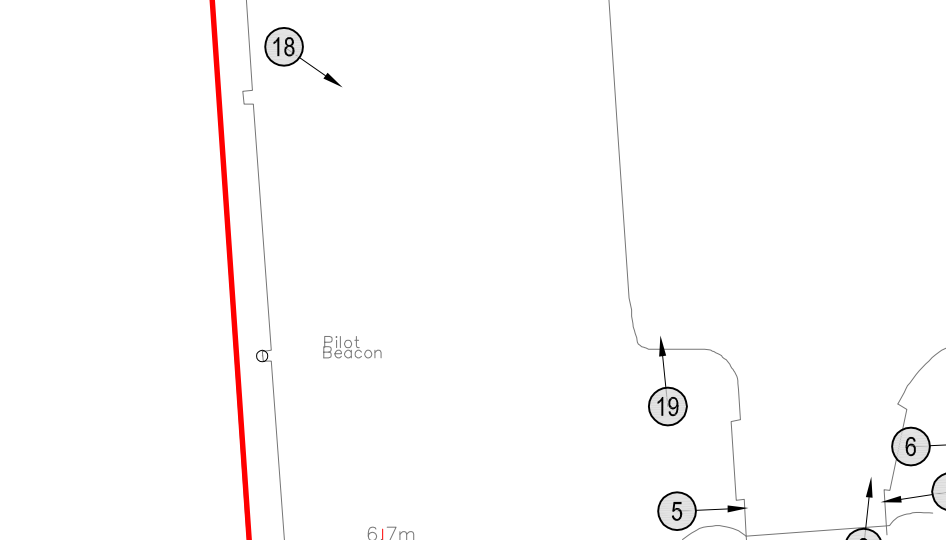
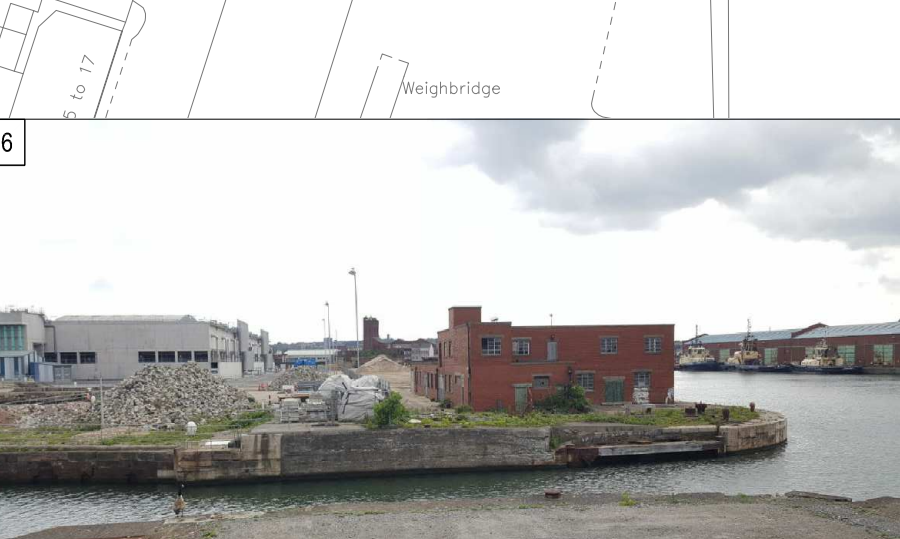
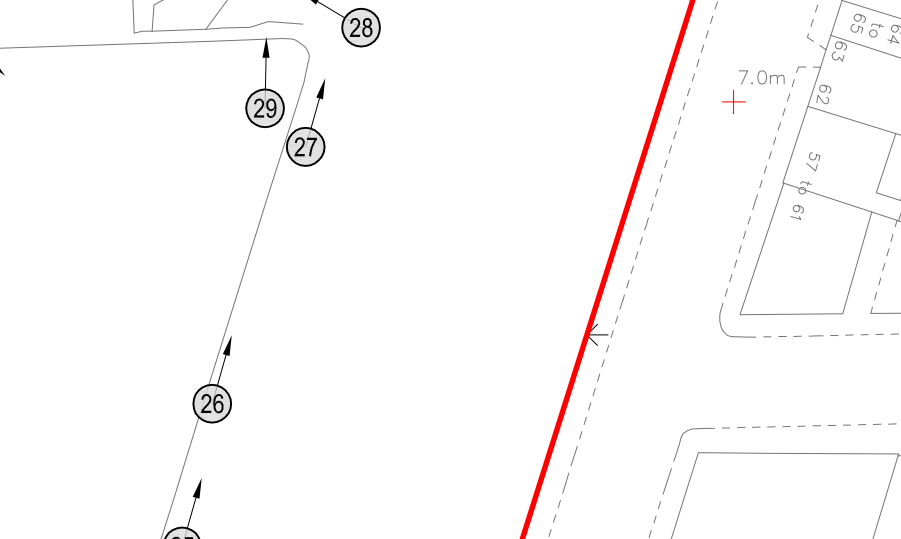
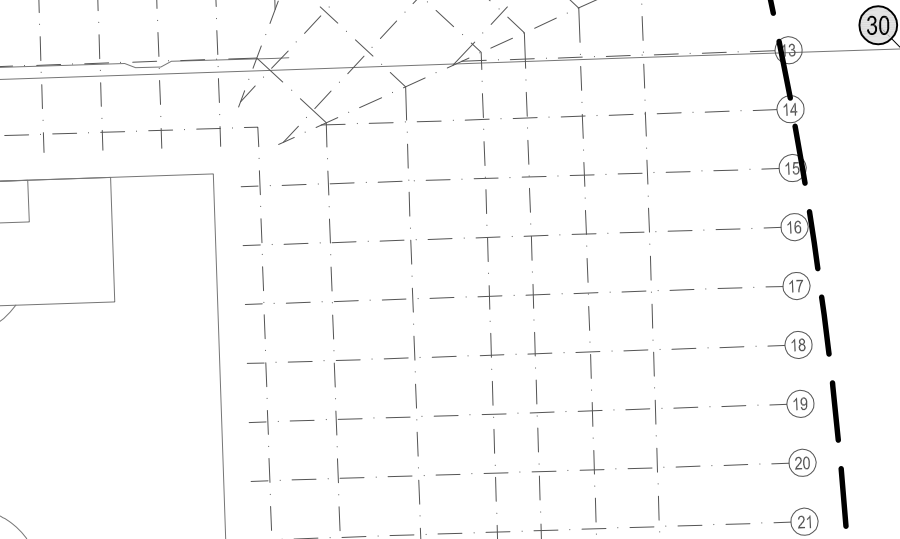
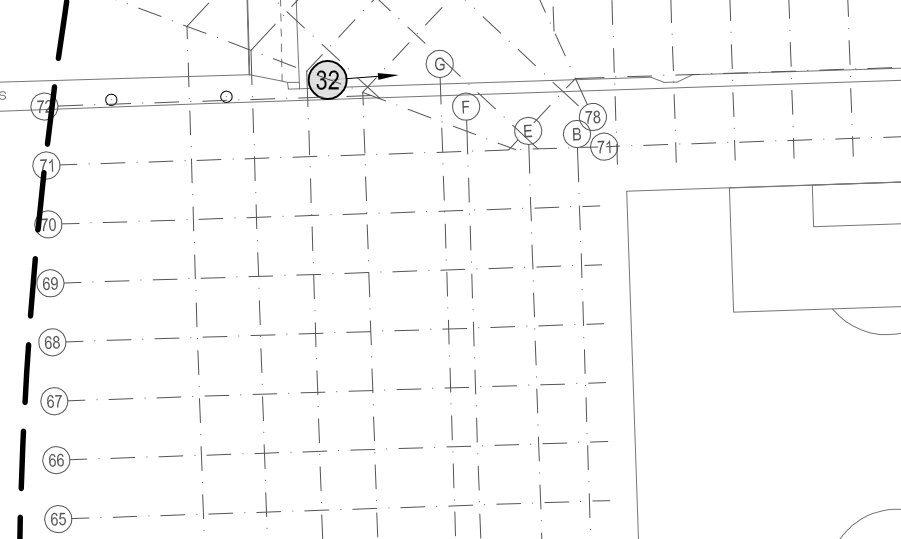
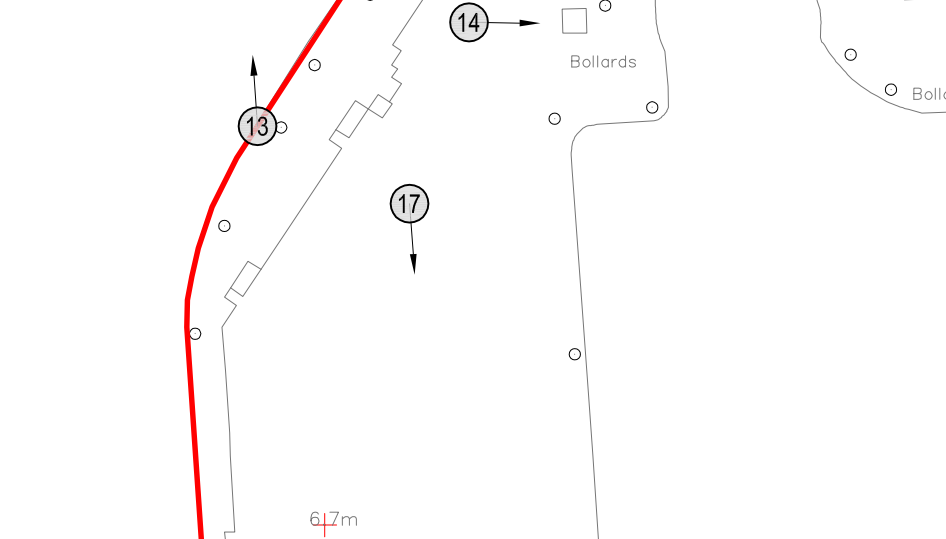
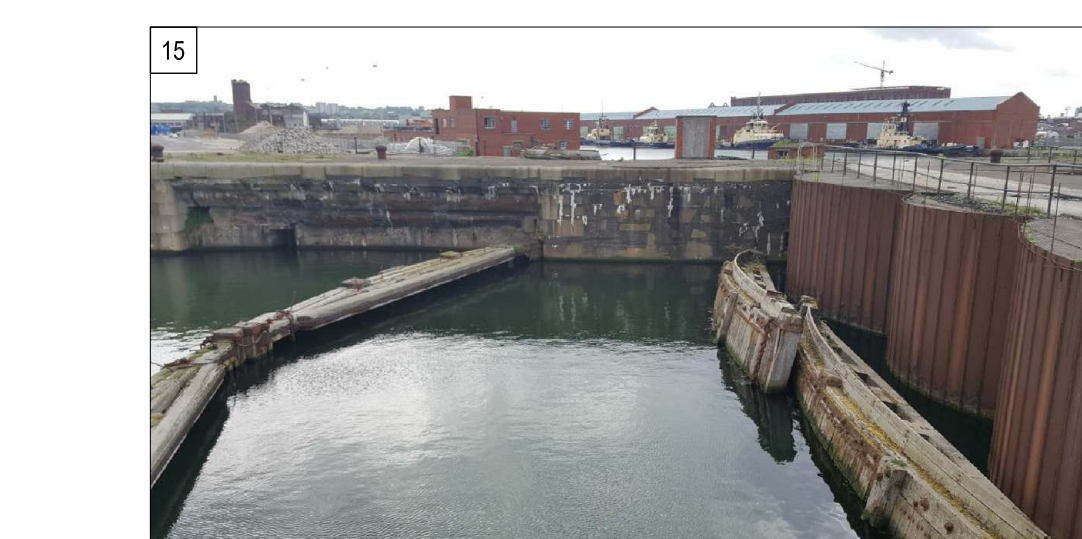
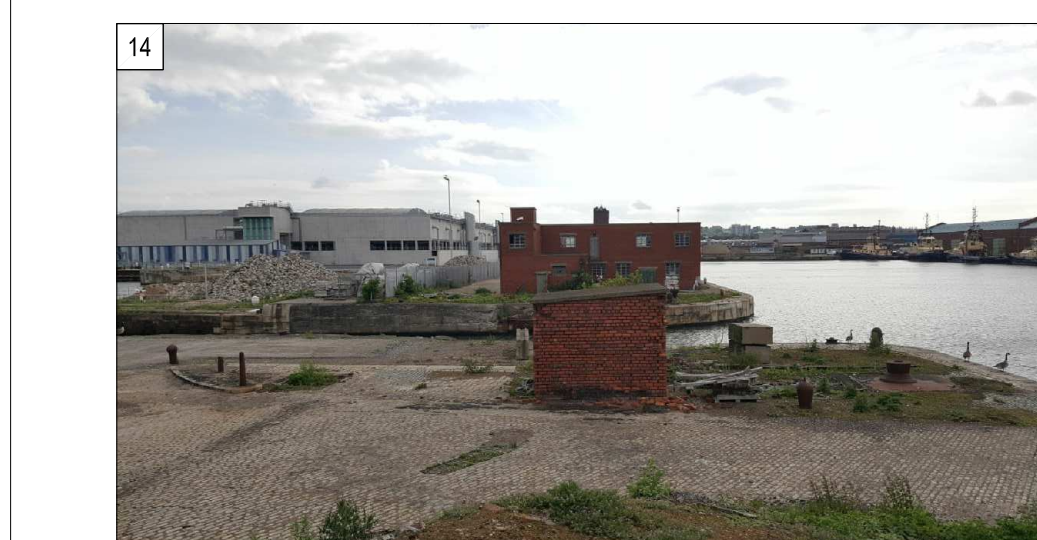
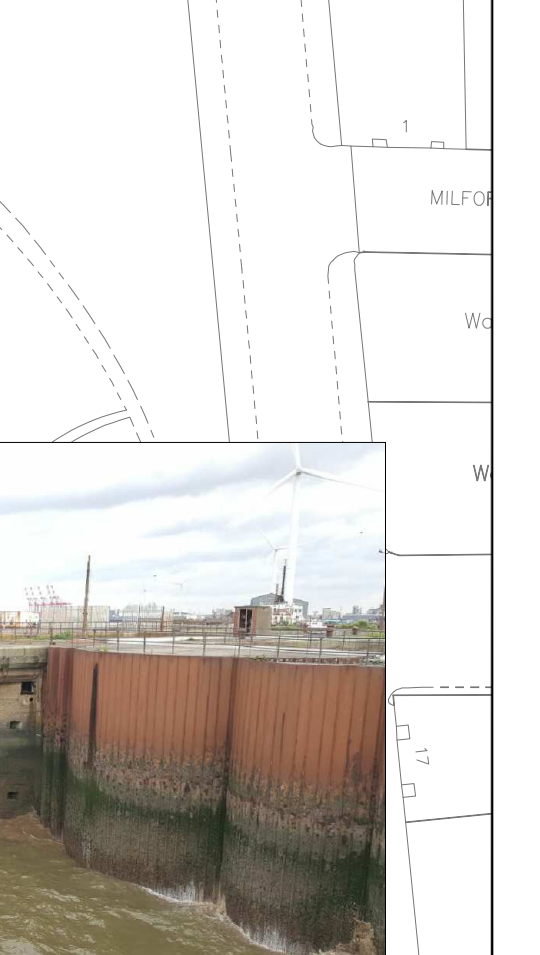
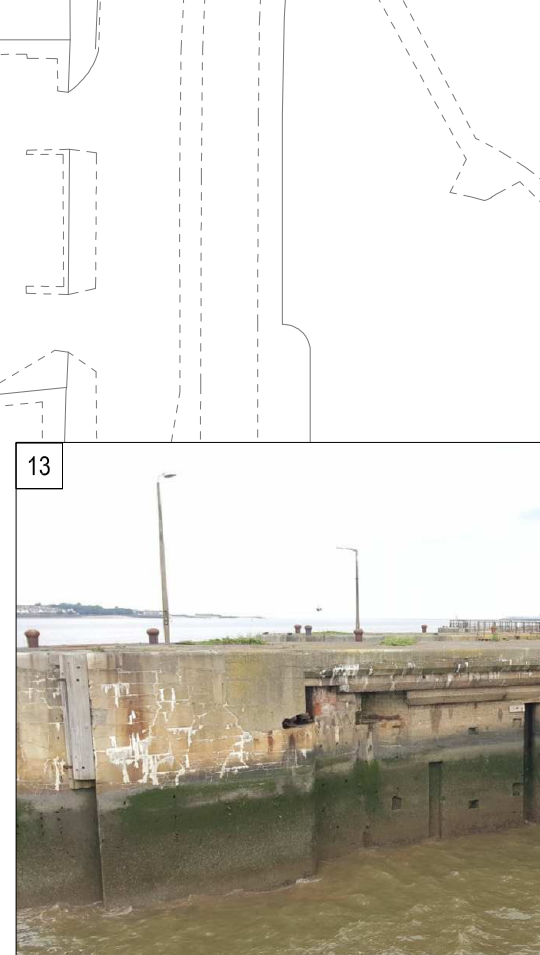
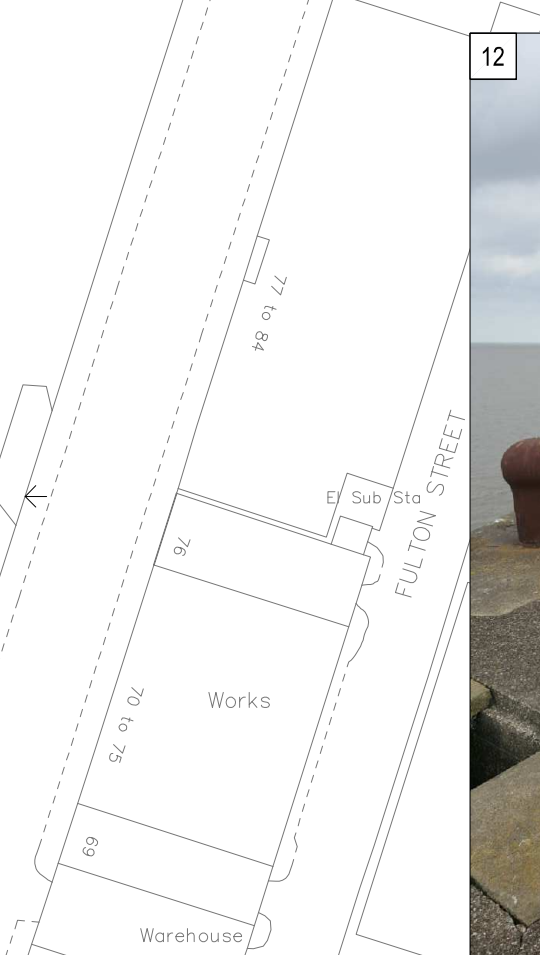
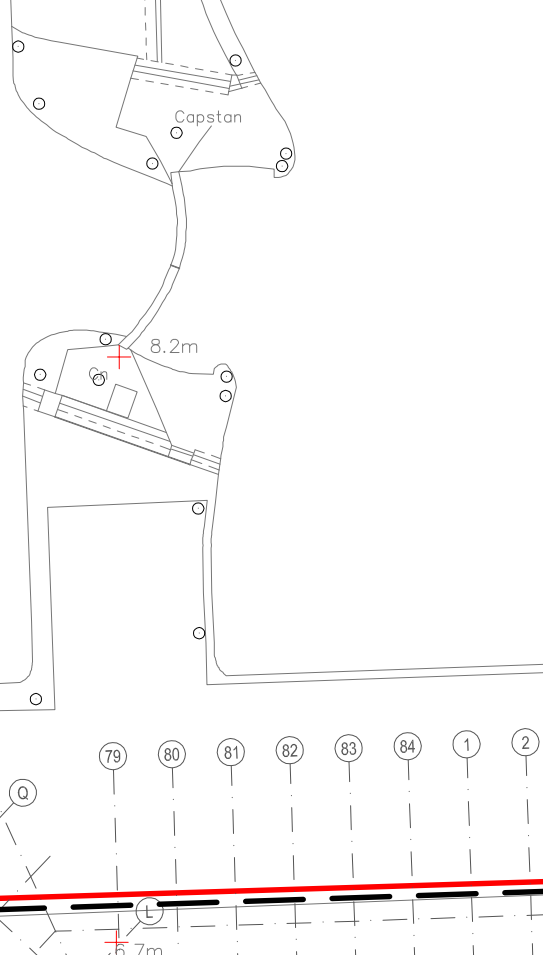
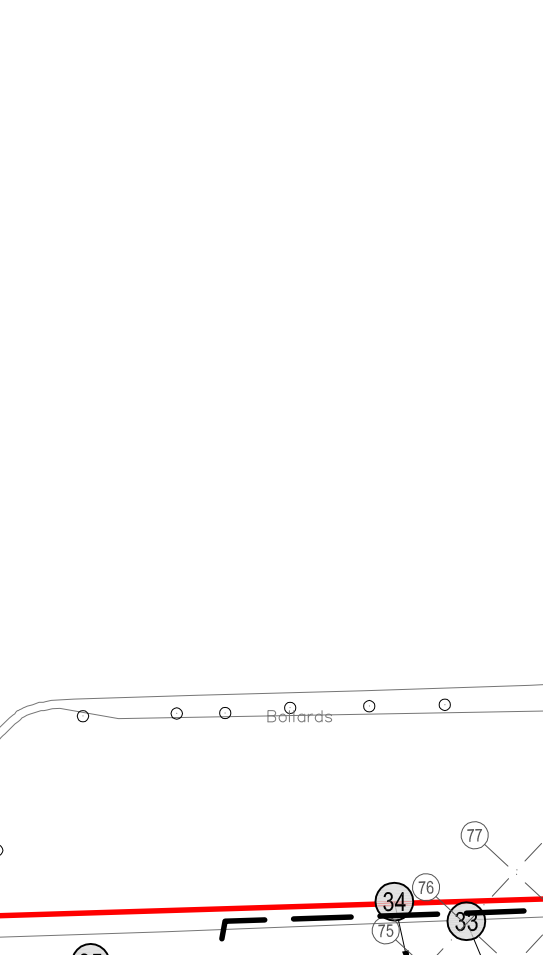
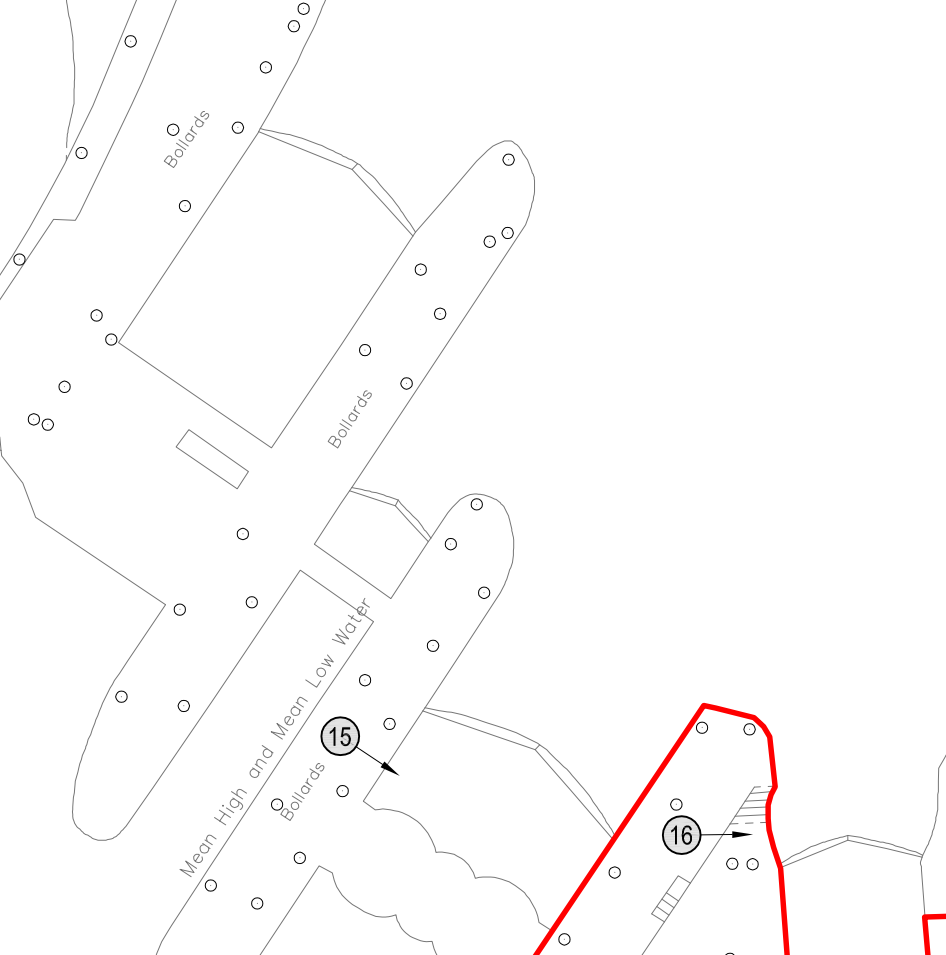
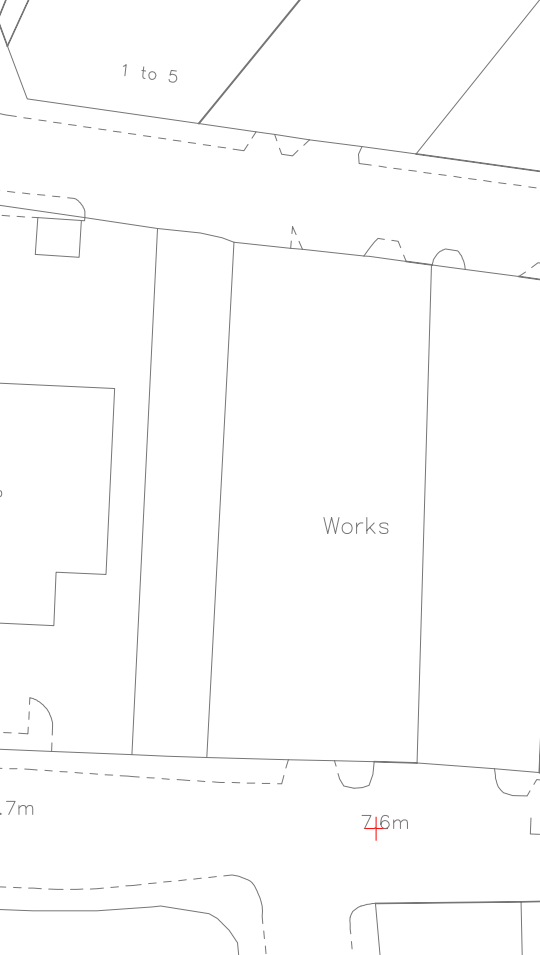
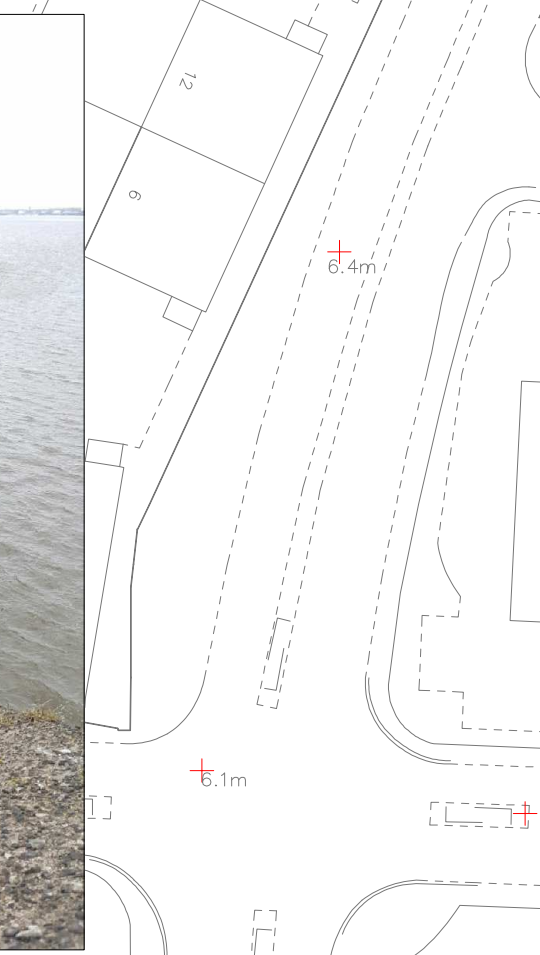
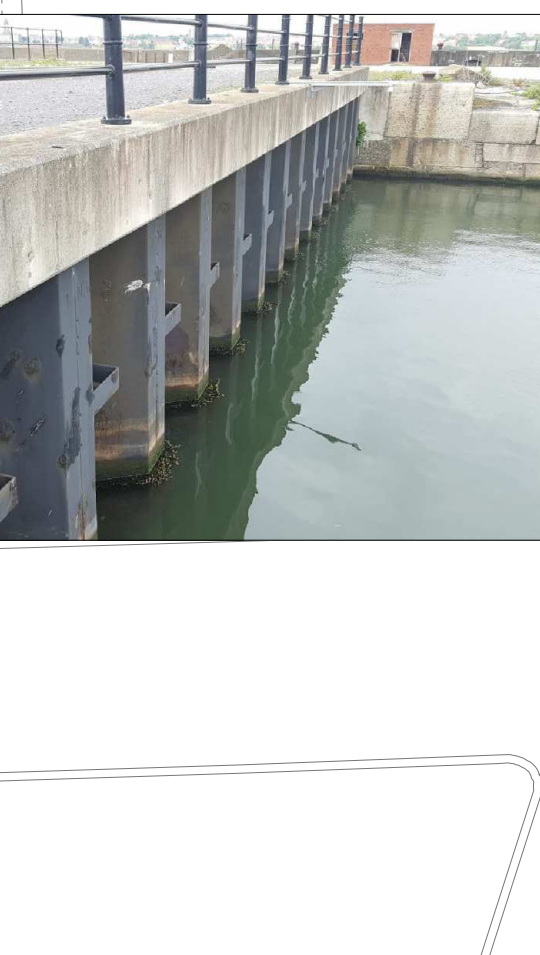
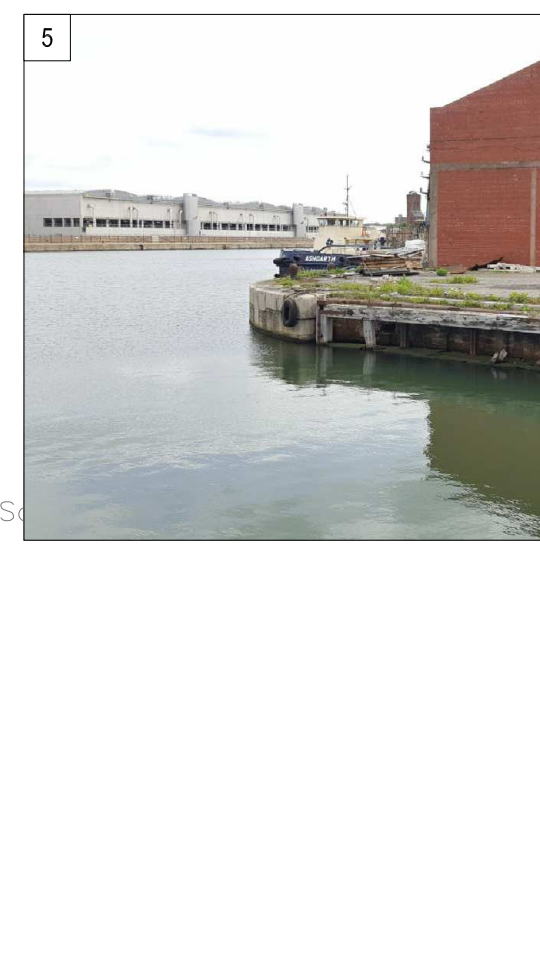
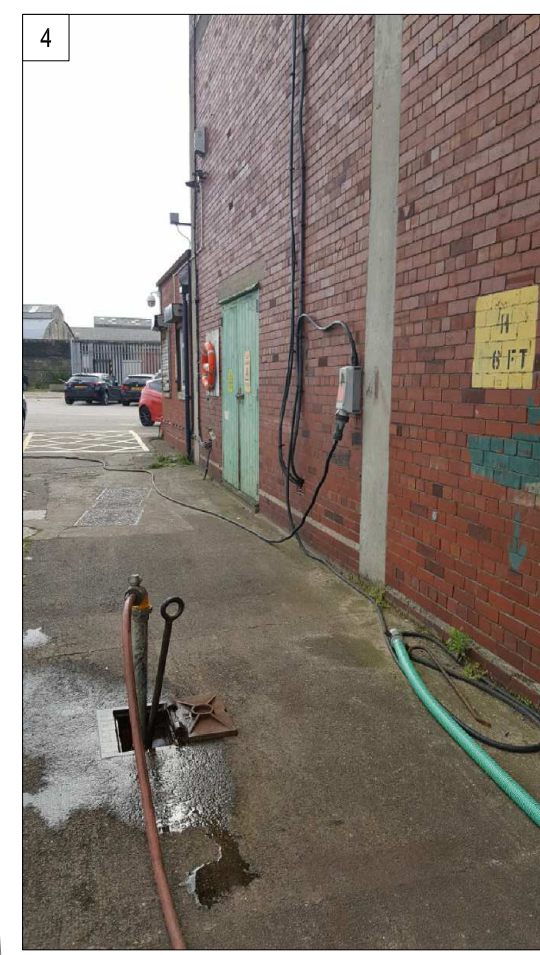
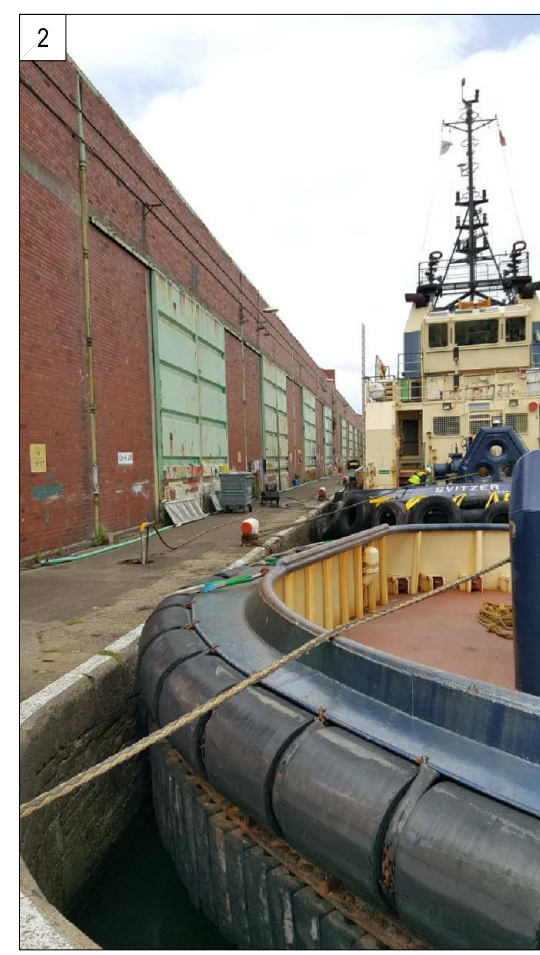
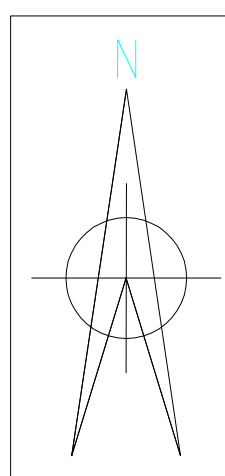

— SITE BOUNDARY  
— APPROX. STADIUM FOOTPRINT  
⑩ PHOTOGRAPH LOCATION & DIRECTION

© Buro Happold Limited or its group companies.  
All Rights Reserved. Buro Happold and its group companies accept no liability for any use of the information contained in this drawing for purposes other than those for which it was prepared.  
DO NOT SCALE THIS DRAWING.

**HEALTH AND SAFETY INFORMATION**  
IN ADDITION TO THE HAZARDS NORMALLY ASSOCIATED WITH THE TYPES OF WORK DETAILED ON THIS DRAWING, NOTE THE FOLLOWING:  
CONSTRUCTION.

MAINTENANCE  
CLEANING  
OPERATION.

DECOMMISSIONING  
DEMOLITION.

**Notes**  
POSITION OF HISTORICAL STRUCTURES FROM GROUND SURVEY MAPPING.  
POSITIONS OF HISTORICAL FOUNDATIONS NOT FROM AS BUILT INFORMATION, APPROXIMATE ONLY.

00 INFORMATION 03.07.17 NC NP  
Rev. Description Date Dm Gm

## INFORMATION

Status of drawing

**BUROHAPPOLD  
ENGINEERING**

Camden MB  
Lower Bristol Road  
Bath BA2 3DQ  
UK

Tel: +44 (0)1225 339000  
Fax: +44 (0)870 937 4148  
Email: [0040026@burohappold.com](mailto:0040026@burohappold.com)  
Web: [www.burohappold.com](http://www.burohappold.com)

Architect: MEIS  
Project: **PROJECT BLUE**  
Dwg Title: **SITE WALKOVER PLAN**

Scale: 1:1000  
Drawn by: NG  
Checked by: NP  
Date: JULY 2017

Job No: **0040026**  
Drawing No: ES-046-ZX-LXX-GR-CG-0002  
Rev: **00**