

MONARCHS QUAY

LIVERPOOL

APPENDIX 2 - LANDSCAPE APPENDICES

LYR088_MQ_ID002

FOR INFORMATION

OCTOBER 2017

Draft
Works in progress
LAYER
LANDSCAPE ARCHITECTURE

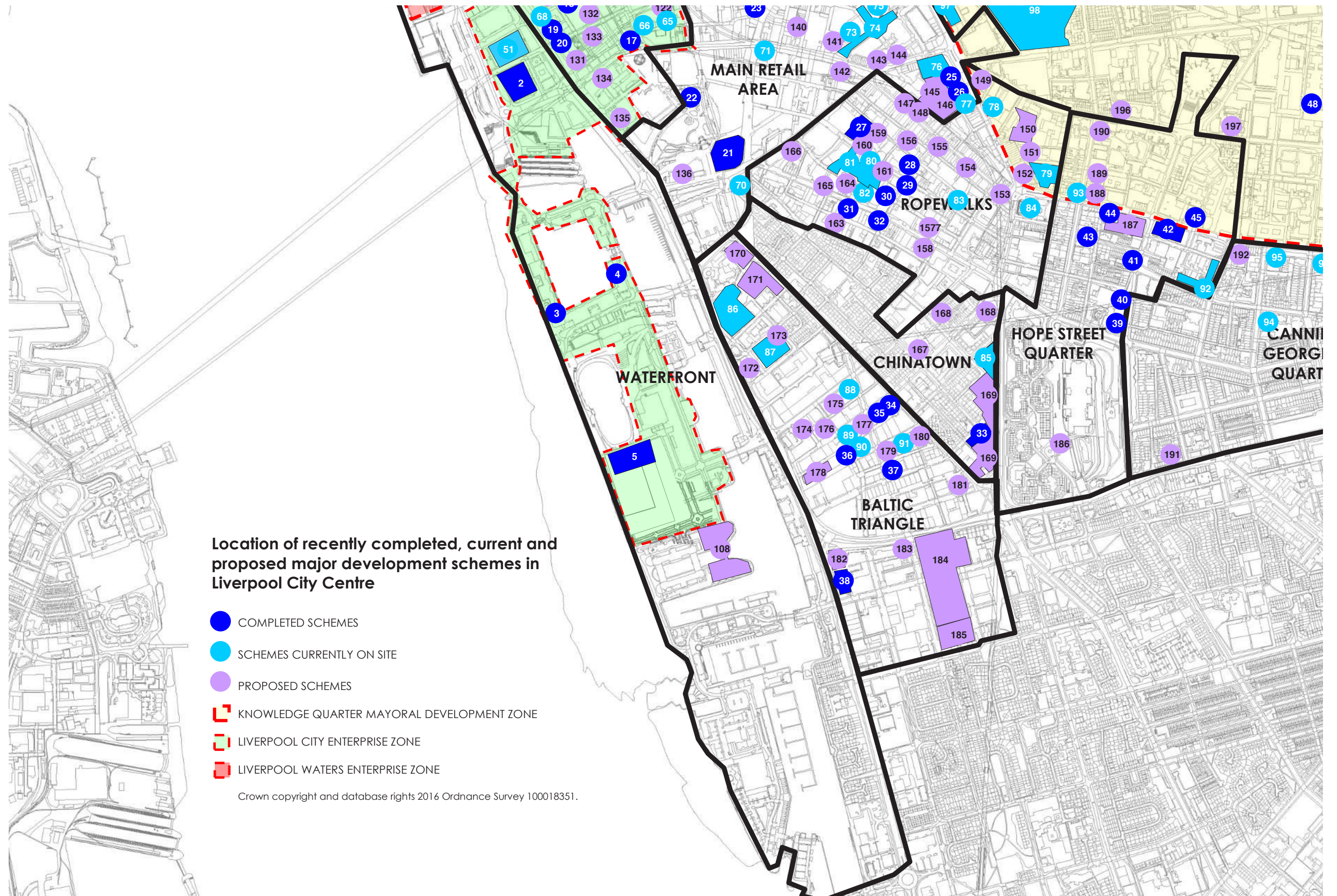

Urban Design Considerations

- 4.2.13 The following identifies a number of urban design considerations that should be taken into account when developing proposals for development within the WHS and Buffer Zone. The Council will place a particular emphasis on these issues when considering developments within the WHS and in areas adjacent to the WHS.
- 4.2.14 These considerations have been structured to provide a checklist of key issues that should be addressed during the development process and within the Design and Access Statement. These considerations will also be tested during the determination of planning applications. The relative importance given to these considerations will vary according the nature of the development and its location.
- 4.2.15 These considerations should be used in conjunction with CABE's By Design (2000), LCC's Liverpool Urban Design Guide (2003), UNESCO's Vienna Memorandum on World Heritage Contemporary Architecture (2005) and particularly UNESCO's Declaration on the Historic Urban Landscape (2005).
- 4.2.16 The Commission for Architecture and the Built Environment (CABE) produces extensive guidance on design issues (see www.cabe.org.uk). 4NW has also produced some documents that offer design advice: The North West Best Practice Design Guide and The Sustainability Appraisal Toolkit (see www.nwrpb.org.uk). Further information on sustainable design can be found at www.communities.gov.uk and www.breeam.org . A useful guide to biodiversity and design can be found at www.tcpa.org.uk .
- 4.2.17 Many historic buildings have inherent accessibility challenges but an objective is for the WHS to have inclusive access for all. Compromises will need to be made between the interests of accessibility and conservation. Liverpool City Council has recently gone to extraordinary lengths to improve accessibility at St George's Hall. English Heritage has produced two guidance leaflets on how to improve accessibility in historic buildings, one of which uses the access ramp at Liverpool Town Hall as an exemplar

Objectives	Considerations
Character	What are the key characteristics of the local environment and how does the development <u>respond</u> to them in terms of its design?
	How is the development situated in the context of the wider setting of the city centre and how does it respond to this?
	What is unique about its local environment in terms of "Liverpool" and how is this expressed in the design?
	What about the design makes this development relevant to Liverpool and nowhere else? Eg. Does it incorporate local design characteristics, maritime iconography or a sculptural
	How does the development respond in terms of its design to existing historic buildings and structures?
	How does the development incorporate and protect relevant views to, from and across the WHS?
	Is the development situated close to the WHS? If so, what measures have been taken to protect the visual setting of the WHS?
	How does the development promote architectural excellence and high quality design?
	How does the proposal affect the OUV of the WHS?

Objectives	Considerations
Continuity and Enclosure	Does the development provide a good sense of enclosure that works at the human scale and how does this reflect local patterns of enclosure?
	Does the development promote and include active frontages with frequent entrances onto the street?
	What steps have been taken to ensure that the development has a consistent frontage that reinforces the local street scene?
	Does the development avoid leaving gaps in street frontage?
	How has privacy and security been ensured through the design?
	How does the development respond to designated heritage assets in the locality in terms of ensuring that it does not over dominate them and retains a certain level of spatial separation?
Ease of movement	How has the development responded to local patterns of urban grain and street networks?
	Does the development encourage movement through the provision of a fine network of streets with small block sizes to increase permeability?
	Have the proposals taken into consideration public transport as an integral part of the development?
	What facilities have been provided for cyclists?
	How are vehicles accommodated within the development?
Quality of the public realm	How does the design address inclusion and accessibility issues?
	How does the development integrate new and existing public spaces?
	Have the public realm proposals been developed in line with guidance contained in the Public Realm Implementation Framework (PRIF) and Liverpool Urban Design Guide?
	Are all routes and spaces overlooked?
Diversity	How have any areas of surviving historic street materials and furniture been treated within the scheme?
	Does the development provide ground floor views into and where possible, access to, adjacent streets, parks and open spaces?
	How does the development relate to the street level to ensure activity and vitality?
Legibility	Does the development provide a mix of compatible uses that reflects current allocations?
	What role does the development play in aiding orientation and understanding of the city?
	Does the development make any contribution to the reinforcement of strategic gateways and nodes?
	How does the development respond to existing landmarks within the city and does it ensure that a hierarchy of landmarks is maintained?
Sustainability	What aspects of the development improve the image and perception of the city?
	How does the development take into account its social, economic and environmental impacts based on whole life costs and benefits?
	What sustainable measures have been incorporated into the development's design and maintenance?

Public Realm Design Considerations

4.3.5	<p>Within this context the following are broad considerations that the City Council would expect applicants to address within their Design and Access statements.</p> <ul style="list-style-type: none">• Have the proposals for new routes and spaces respected the historic urban grain; particularly where this forms an important aspect of the character of the area?• How does the proposal affect the OUV of the WHS and the local distinctiveness of each character area?• Do the proposals create high quality pedestrian links with a range of safe and direct choices?• Do the proposals ensure that key routes are not gated or otherwise blocked?• In the context of the wider design (see Section 4.2) are routes and spaces overlooked and are there views from the ground floor onto these spaces?• How do the proposals enhance existing public spaces and integrate them into the design?• Do the new public spaces ensure that they aid orientation and understanding of the city?• How have surviving areas of historic street surfaces, kerbing and furniture been incorporated into the design?• Does the public realm design conform to the PRIF and has it been designed in a coordinated manner?• What measures have been put in place to reduce street clutter?• How do the introduced materials relate to historic precedents; particularly in terms of street surfacing?• Do the proposals reflect the guidance contained in the PRIF in terms of ensuring consistency of materials across the city?• What consideration has been given to the robustness of materials?• Have the proposals integrated new Public Art and lighting?• What consideration has been given to how new spaces will be managed and maintained?• What is the potential to re-use existing historic materials, such as granite kerbs, riven Yorkstone flags, original bollards etc ?• Has consideration been given to preserving, enhancing and/or providing features of biodiversity and geodiversity in the public realm?• How does the design address the issues of inclusiveness and accessibility?• Are the spaces designed for multi-functionality?• How will the spaces be animated throughout the day?
-------	---

Appendix Figure 3 - Liverpool City Centre Strategic Investment Framework (2012) Pg 117 with Monarchs Quay Site Boundary Identified



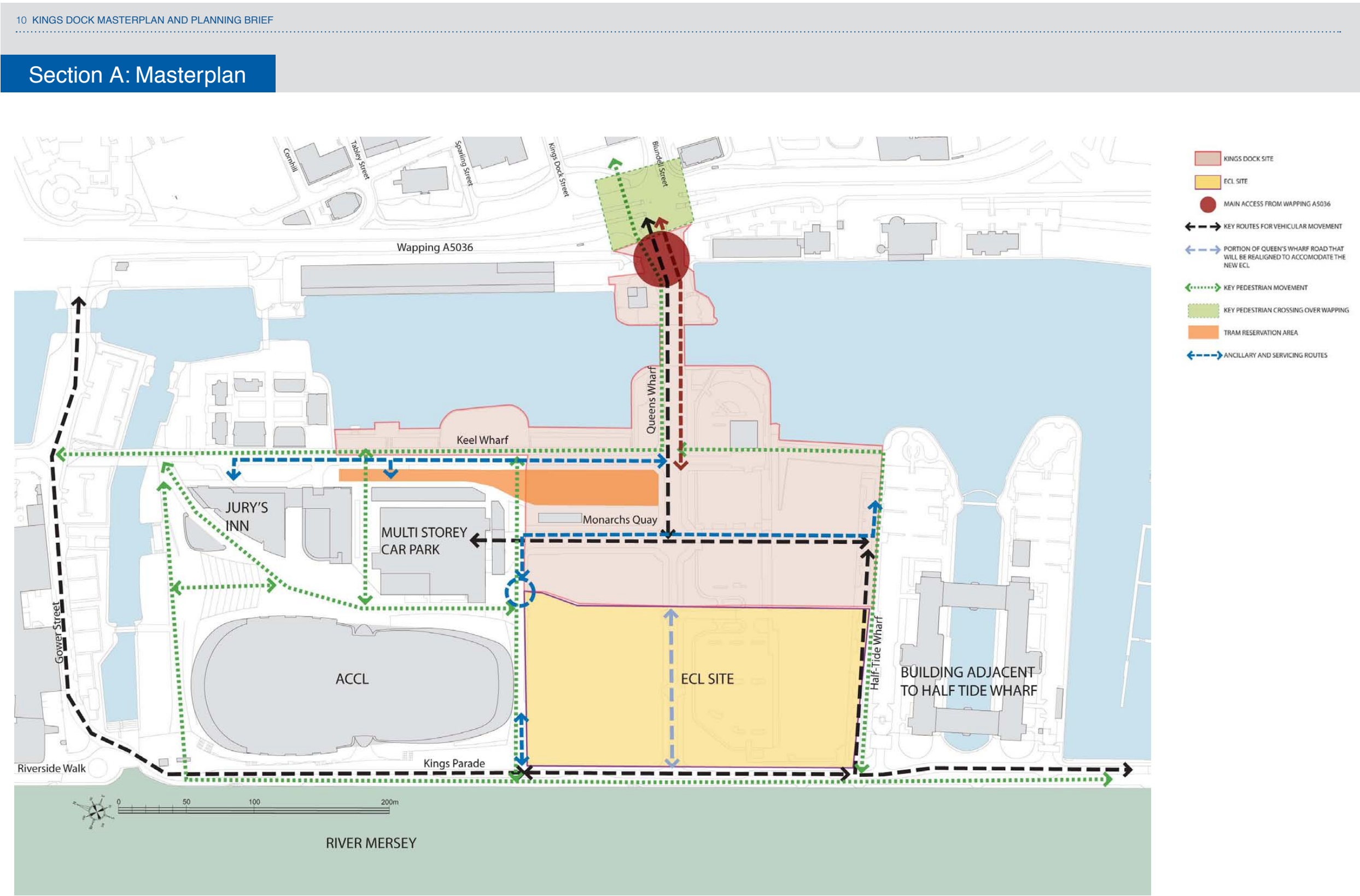
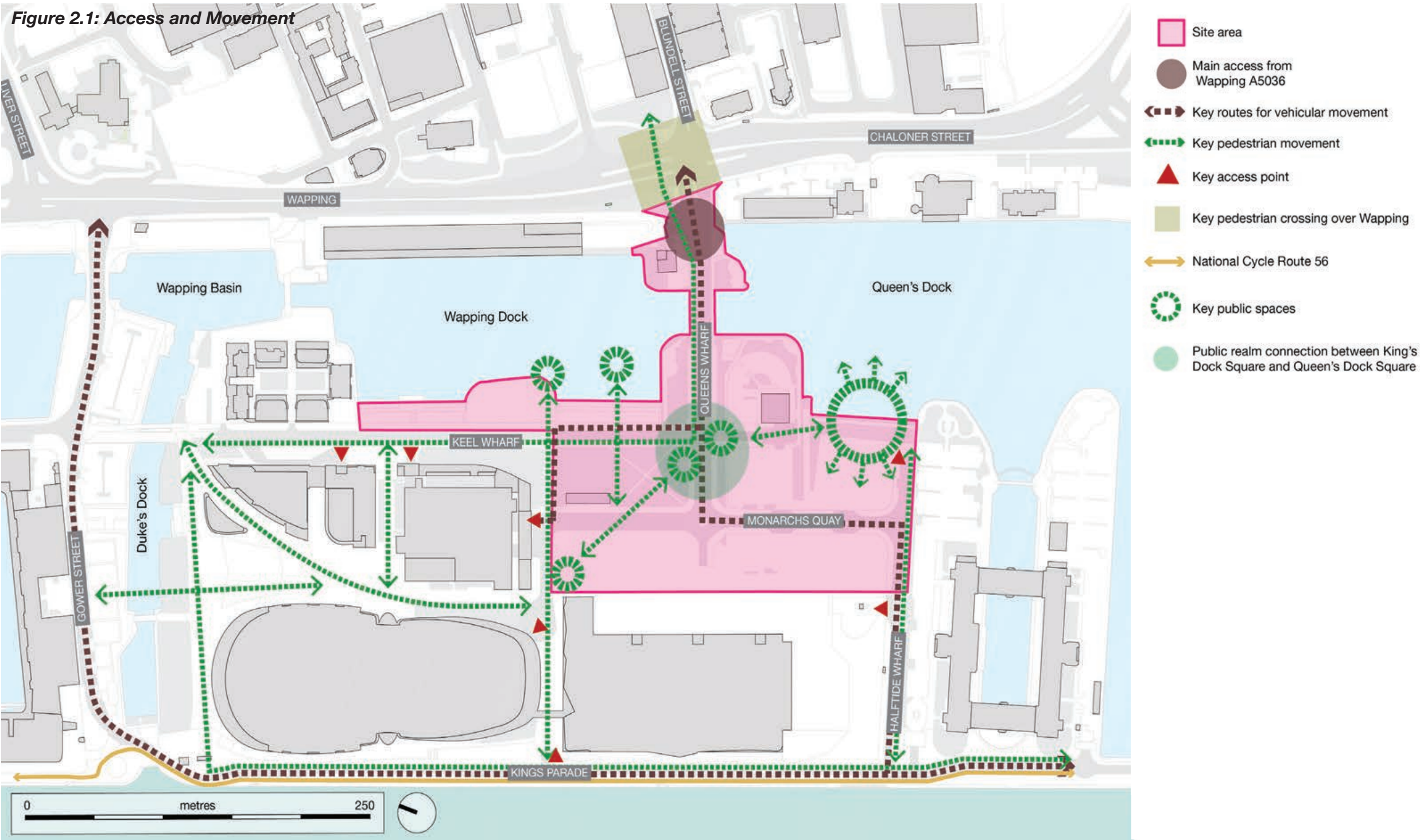
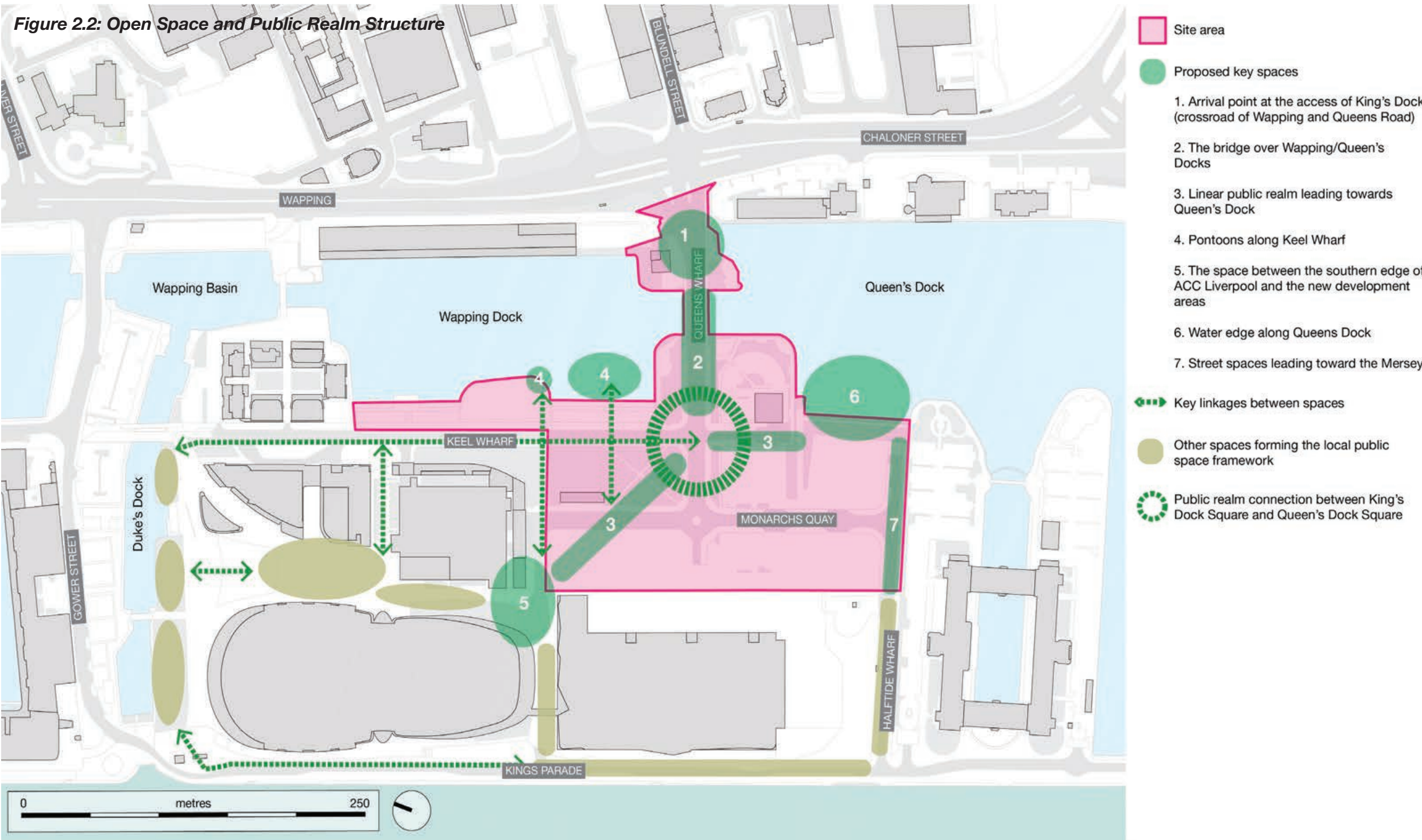

Figure 1.3 Access arrangements diagram.

Figure 2.1: Access and Movement





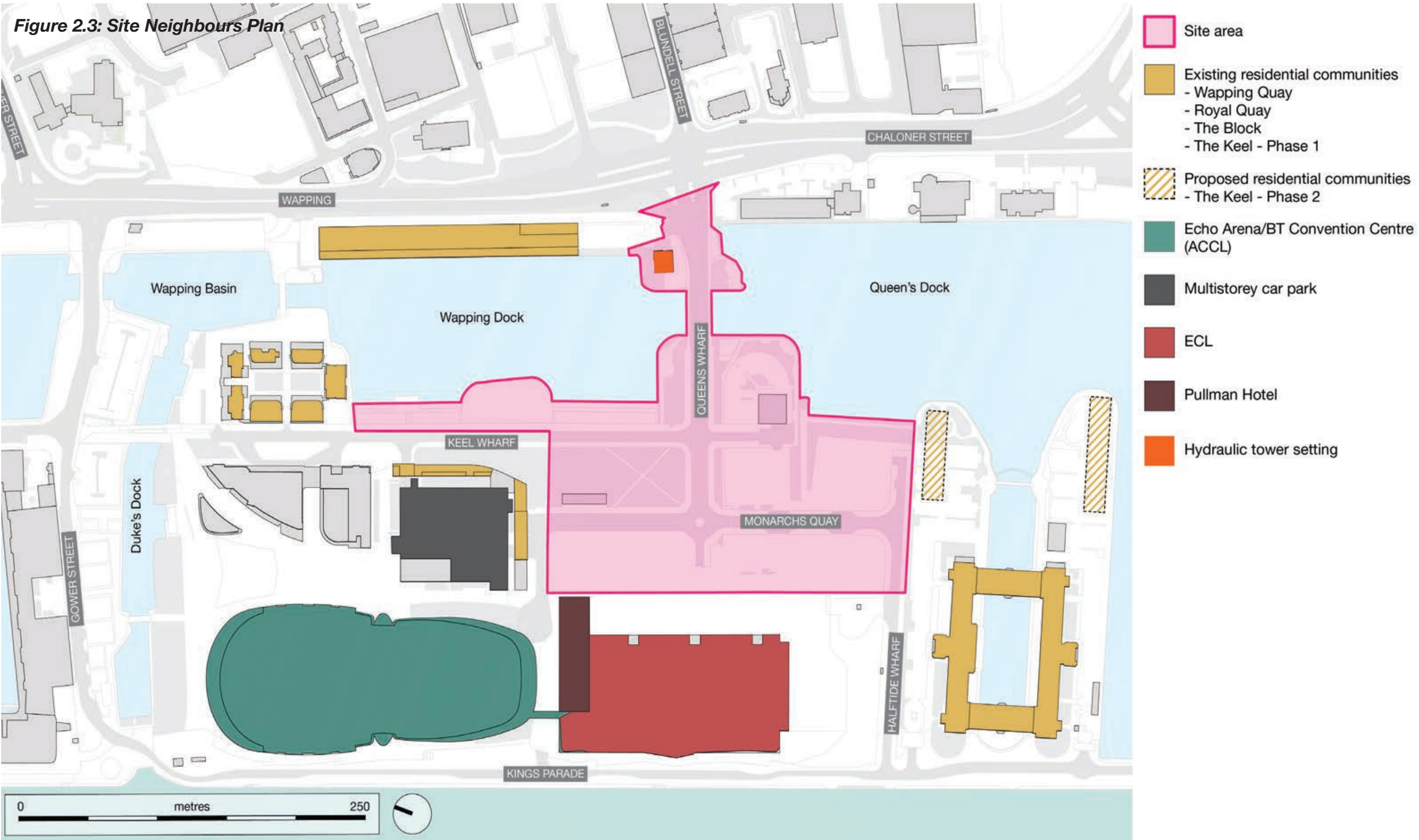
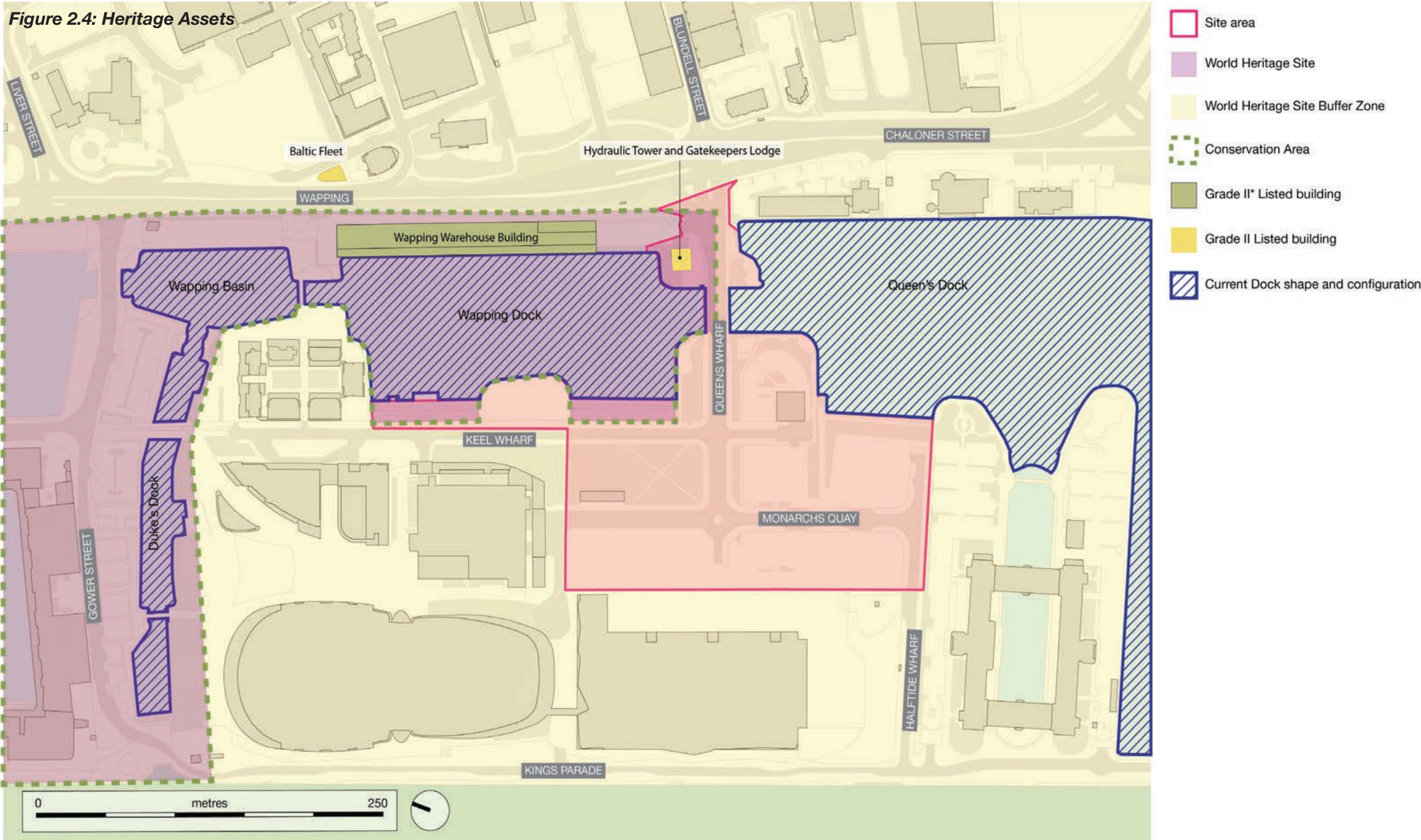

Figure 2.4: Heritage Assets



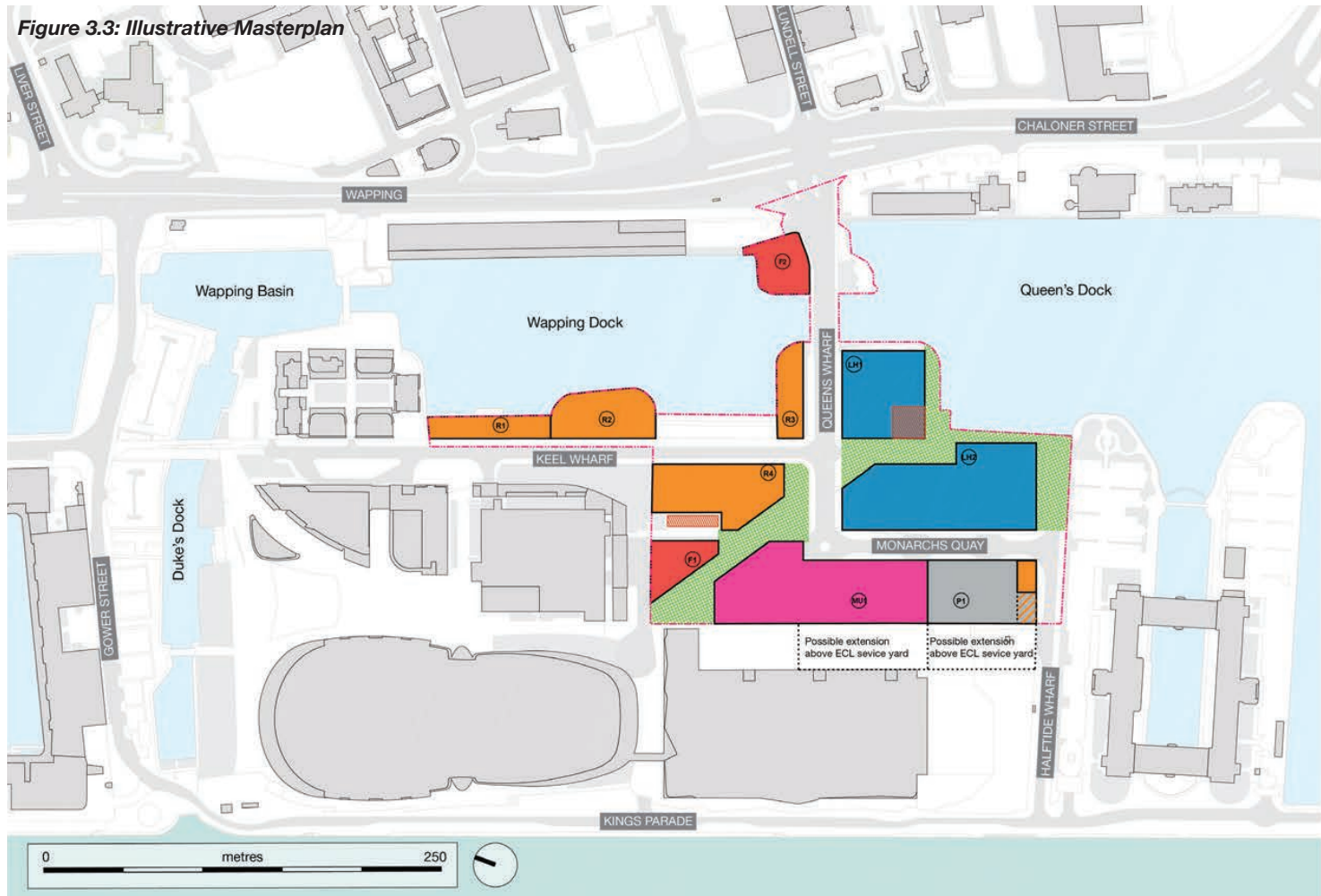
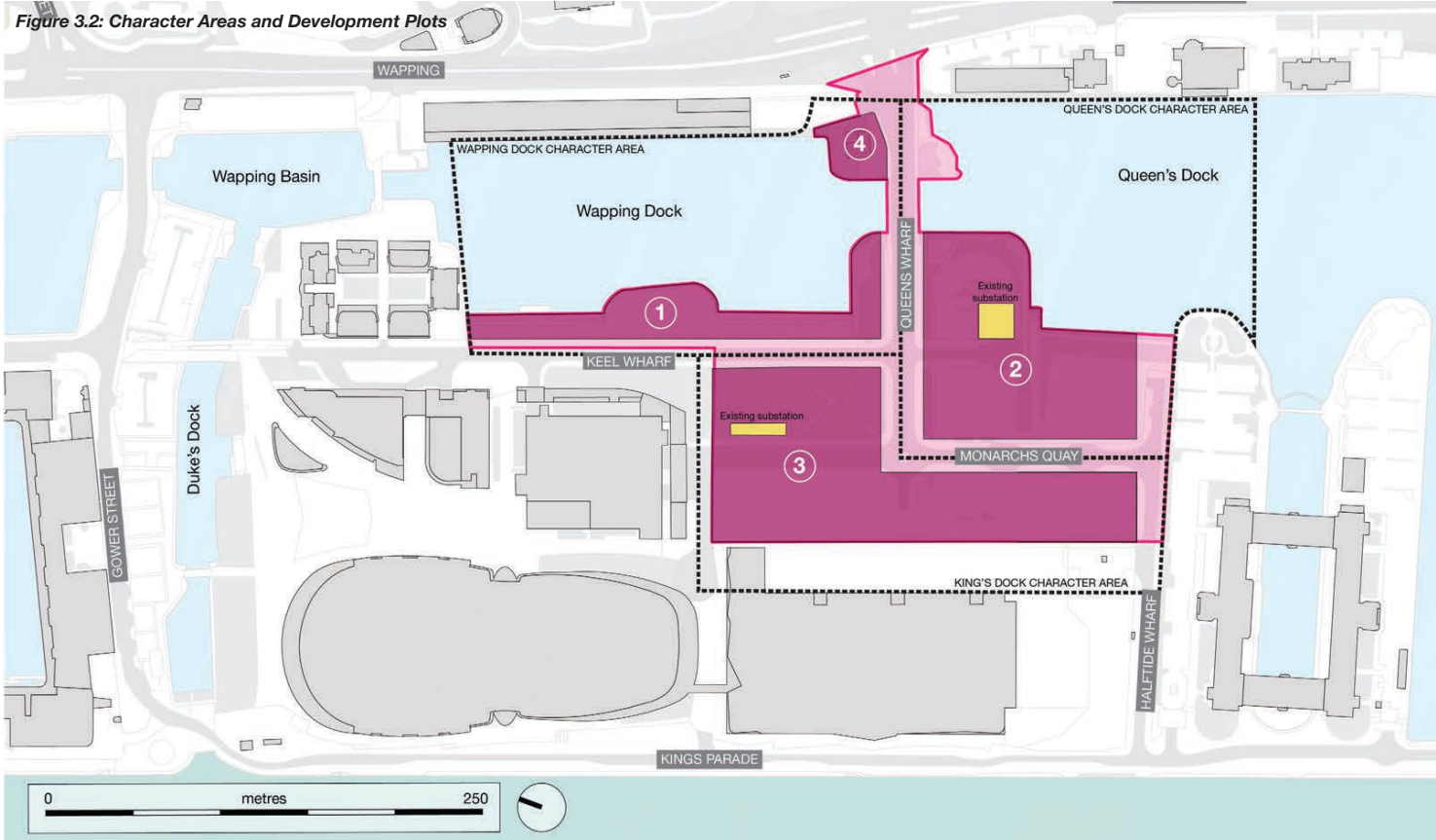
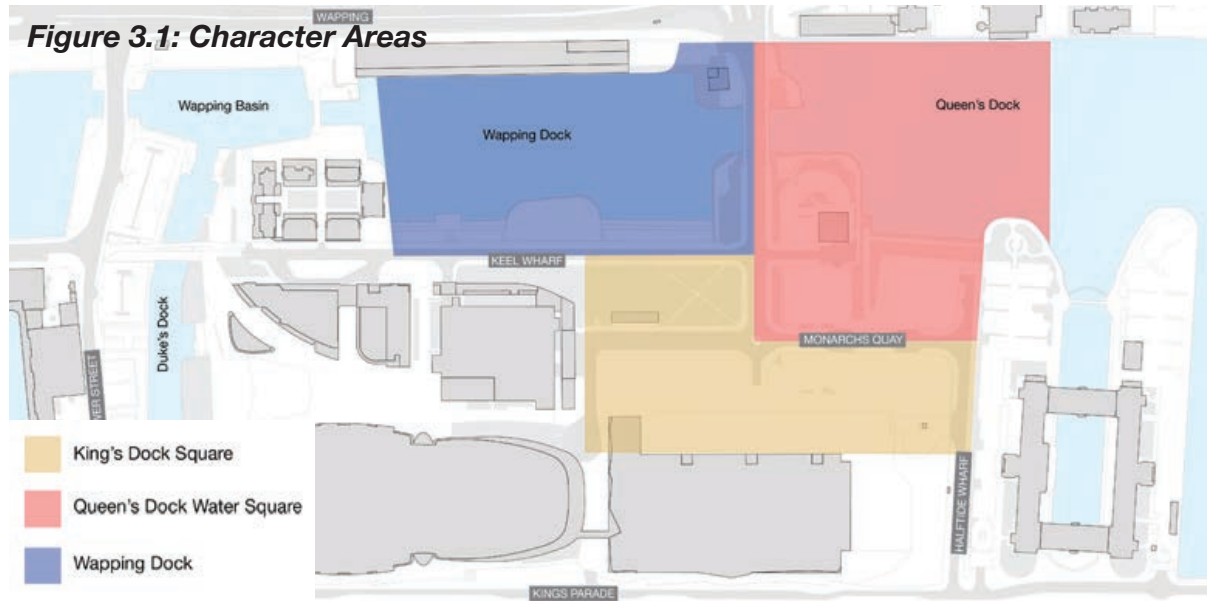
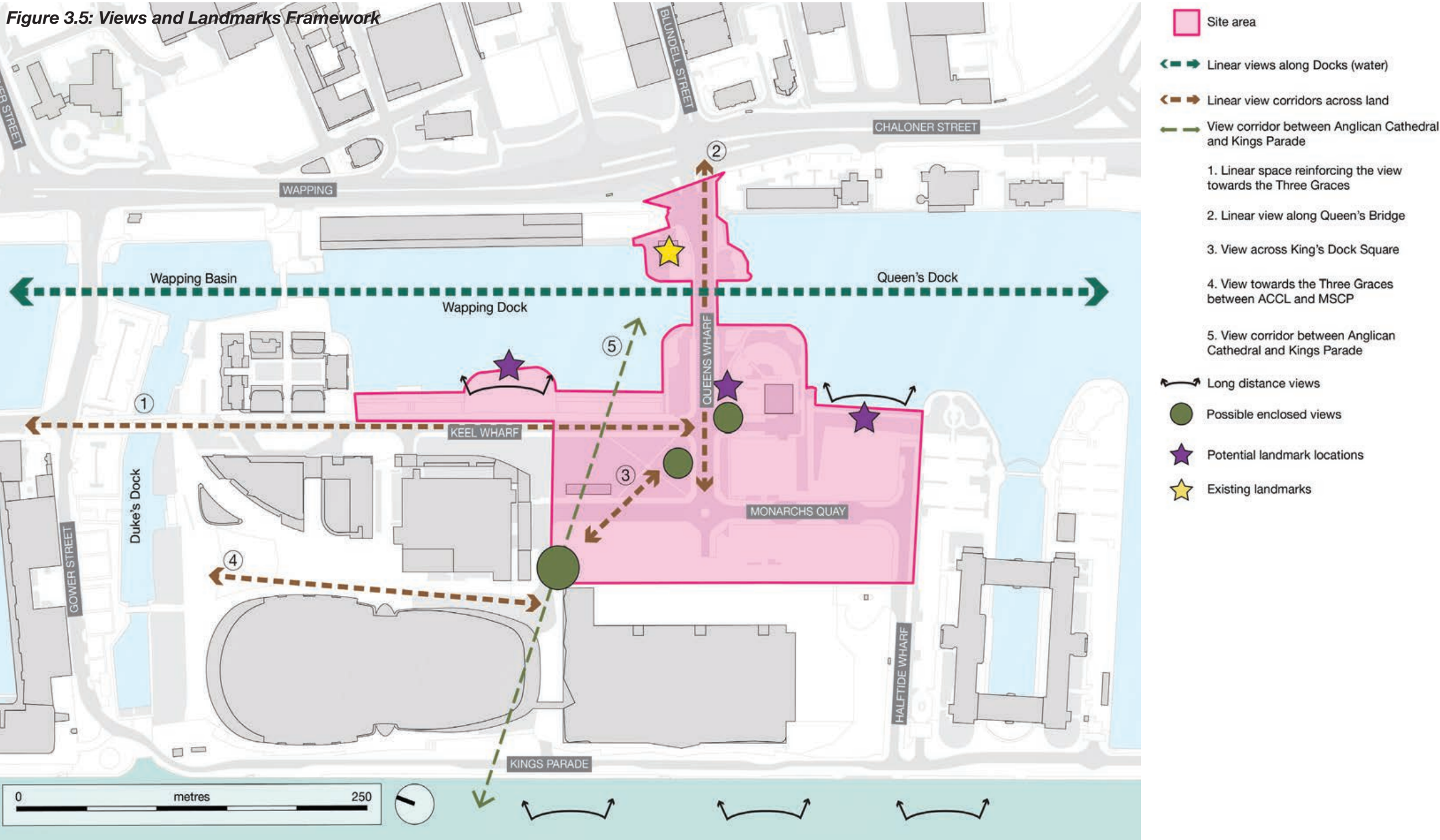

Figure 3.5: Views and Landmarks Framework



LAYER
LANDSCAPE ARCHITECTURE

The Barn
One Hollin Lane
Styal | Cheshire
SK9 4JH

07711 808474
hello@layer-ing.com
www.layer-ing.com