

ENTERING MANOEUVRE

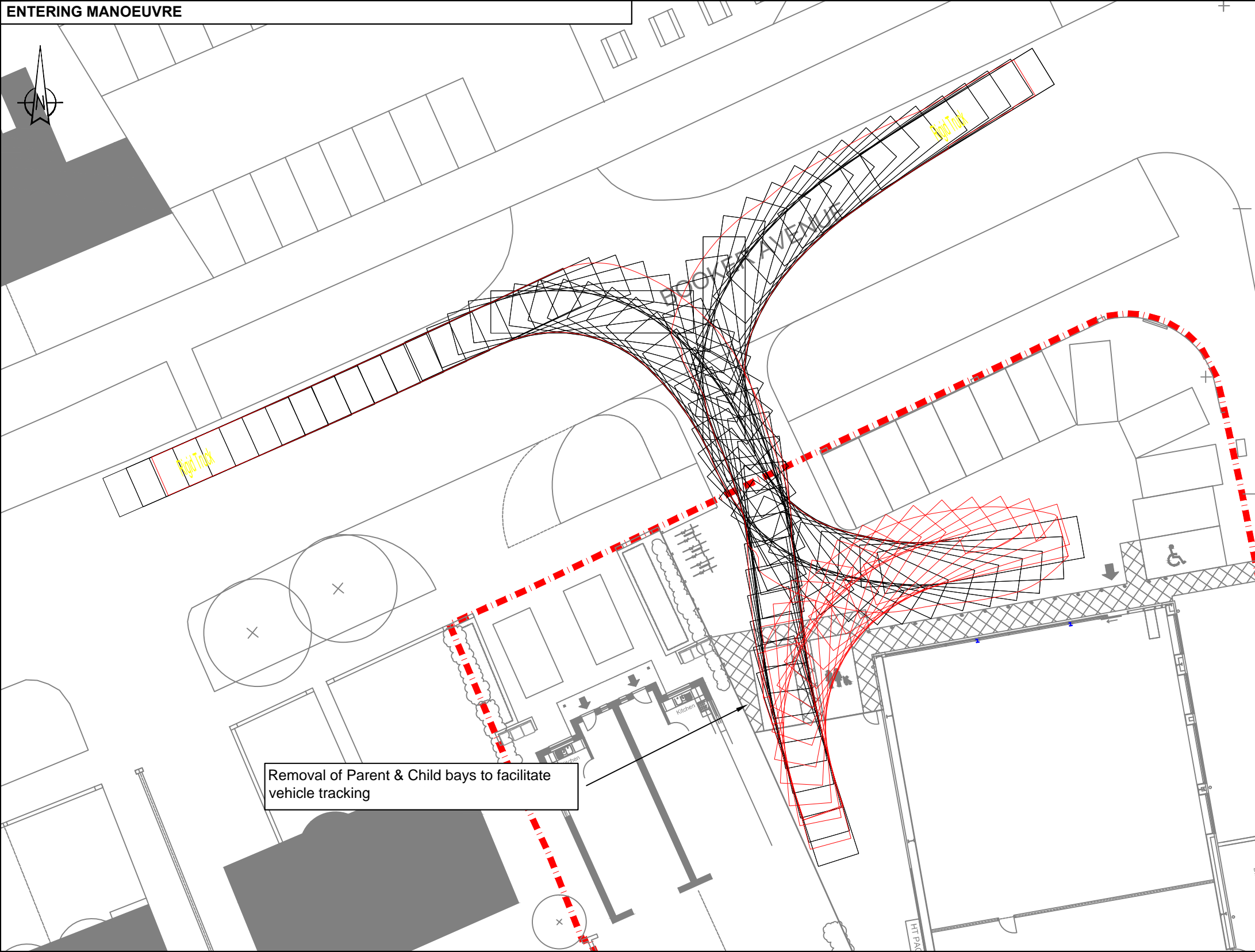

VEHICLE DETAILS

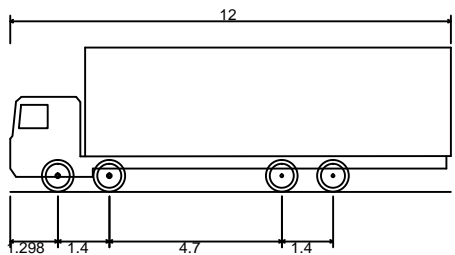

RIGID TRUCK

Overall Length	12.000m
Overall Width	2.500m
Overall Body Height	3.928m
Min Body Ground Clearance	0.412m
Track Width	2.471m
Lock to Lock Time	6.00s
Kerb to Kerb Turning Radius	11.900m

FORWARD MOVEMENTS ARE SHOWN IN BLACK (*design speed for all forward movements - 5kph*)

REVERSE MOVEMENTS ARE SHOWN IN RED (*design speed for all reverse movements - 2.5kph*)

REV	DETAILS	DRAWN	CHECKED	DATE

NOTES

1. Do not scale from this drawing.
2. This drawing is for illustrative purposes only and not for construction.
3. This drawing is to be read and printed in colour.
4. This drawing is based on OS base and WYG will not be held responsible for any inaccuracies or defects within.
5. This drawing has been based upon Drawing No. Z_129-101 provided by DMP Architects

PROJECT: 100 Booker Avenue, Liverpool

DRAWING TITLE: Vehicular Swept Path Analysis

DRAWN: AF	CHECKED: SE	DATE: 03.12.14	SCALES: 1:250	SHEET SIZE: A3
-----------	-------------	----------------	---------------	----------------

CLIENT: TPS DEZ Developments Ltd

WYG Transport
part of WYG group

100 St. John Street London EC1M 4EH
t: 020 7580 8844 f: 020 7580 8818 e: sba@sbax.co.uk

DRAWING NUMBER: A086135_TR006

REVISION: