

REVISION	DATE	DESCRIPTION	DRAWN	CHECKED
A	10.03.14	Fire Legend added, Wall FR added, General Update	oh	db
B	14.07.14	Updated sales area layout	rb	db
C	21/07/14	Updated entrance and pop-up dimensions added	rb	db

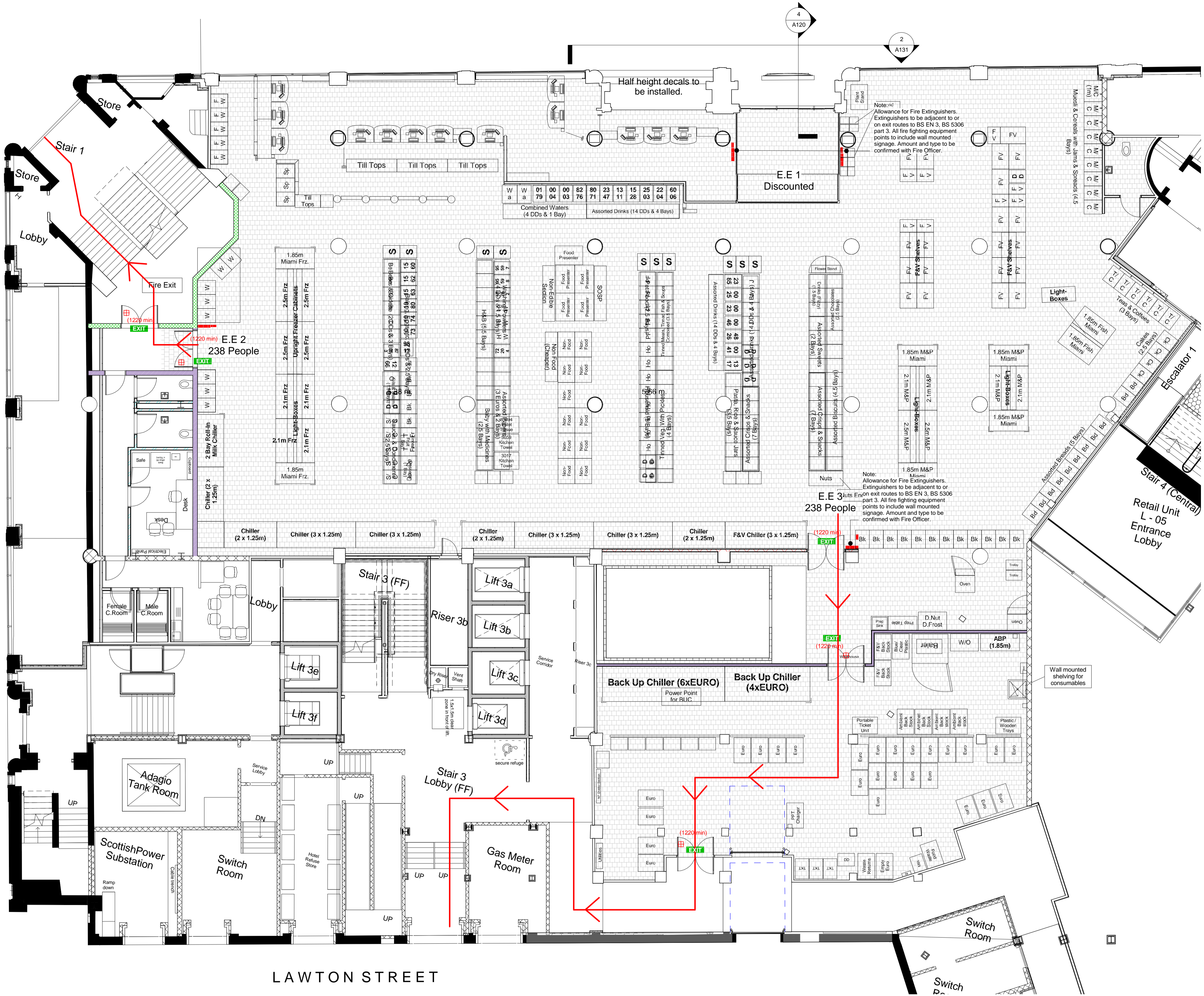

LAWTON STREET

LEGEND		General Note - Proposed Fire Strategy to be signed off by Landlord	
	Fire resisting wall/floor achieving 30 minutes (stability, integrity and insulation) or fire resisting wall/partition achieving 30 minutes fire resistance rating (stability, integrity and insulation) in accordance with BS476 Part 8/20-24 and relevant recommendations of appendix A of technical guidance document B with uninsulated glazed elements confined to the location identified in table A4 of technical guidance document or table 1 of BS5588 Part 1, 1990, fire rated walls/partitions to be either		Compartment wall/floor achieving 60 minutes fire resistance rating (stability, integrity and insulation) in accordance with BS476 Part 8/20-24 and relevant recommendations of appendix A of technical guidance document B and in the case of a wall is to extend full storey height.
(i)	Carried up above ceiling level or down below raised access floors to the soffit/top of the floor construction or the roof soffit level as appropriate.		Fire resistance not required. Refer to partition details for wall type.
(ii)	Cavity barriers are to be installed in the ceiling void or on the line of the fire rated partition.		Escalator
(iii)	Ceiling is to be constructed, throughout the compartment, to		Fire exit sign
a	Specification achieving 30 minutes fire resistance rating (integrity and insulation) in accordance with item 17 of table a1 of technical guidance document B. To be constructed by tenants appointed contractor.		Escape Calculations Sales Area 350 m sq at 2m sq per person = 475 people + 10 Staff (Assumed) = 485 People at 5mm per person = 2425mm minimum width required
		(A)	Minimum aggregate clear width of doors;
		(B)	Width of corridor measured between finished surface of walls or other fixed obstructions (such as protruding columns) at shoulder level subject to handrails not intruding more than 100mm or skirting not intruding more than 30mm into the measured width.
		(C)	Clear width of stairway measured between walls or balustrades subject to handrails
			Walls by landlord.
			Fire resisting doorset to have not less than 30 minutes integrity rating in accordance with BS476 Part 8/20-24 and to have a leakage rate not exceeding 3m³/m²/hour (head and jambs) when tested at 25pa under BS476 section 31.1. doorset to be fitted with an automatic door closing device capable of closing the door from any angle and against any latch fitted to the door.
			Fire resisting doorset to have not less than 60 mins integrity rating in accordance with BS476 Part 8/20-24 and to have a leakage rate not exceeding 3m³/m²/hour (head and jambs) when tested at 25pa under BS476 section 31.1. doorset to be fitted with an automatic self closing device capable of closing the door from any angle and against any latch fitted to the door

STATUS:  
PLANNING APPLICATION

ARCHITECTS  
PROJECT MANAGERS  
INTERIOR DESIGNERS  
CDM COORDINATORS  
HEALTH & SAFETY MANAGERS  
HISTORIC BUILDING CONSULTANTS

SOUTHPORT | t: 01704 531 252 | f: 01704 532 833 | e: southport@njsr.co.uk  
MANCHESTER | t: 0161 873 8770 | f: 0161 873 8771 | e: manchester@njsr.co.uk  
WWW.NJSR.CO.UK WWW.NJSRPROJECTSERVICES.CO.UK  
Client

Lidl UK GmbH

Project  
Project Name Lewis's, Ranelagh St,  
LIVERPOOL

Title  
Proposed Fire Strategy

Scale	Date	Drawn	Checked
1 : 100	21/07/14	rb	db
Contract	Dwg. No.	Rev	
1372.005	A010	C	