

PLAN 1:25

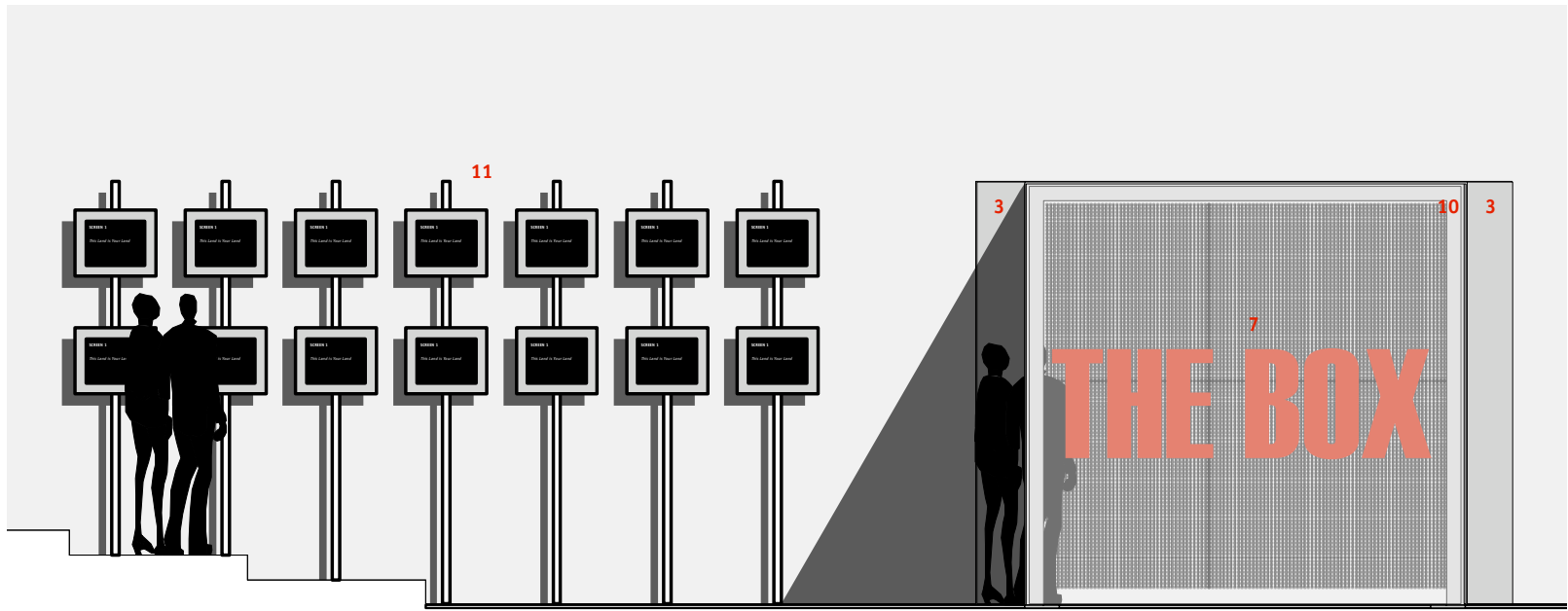

EXISTING PHOTOGRAPH

- 1 Remove existing concrete wall / ceiling doors forming lobby (red dotted)
- 2 Make good to floors / adjacent wall to match existing
- 3 Bolted back-painted glass wall linings
- 4 Bottom section of structure forming threshold strip
- 5 New 3mm thick poured resin flooring within cube
- 6 Laminated solid core acoustic doors to 'The Box' with recessed frame
- 7 Outer glazed skin to cube fixed back to steel frame
- 8 Inner glazed skin to cube fixed back to steel frame
- 9 LED grid matrix suspended within inner / outer glazed skins wired to existing ceiling mounted electrics
- 10 Primary steel frame to cube structure (finish TBC)
- 11 Existing Stainless steel screen installation to be relocated as shown



FRONT ELEVATION SHOWING EXISTING SCREENS RELOCATED 1:50

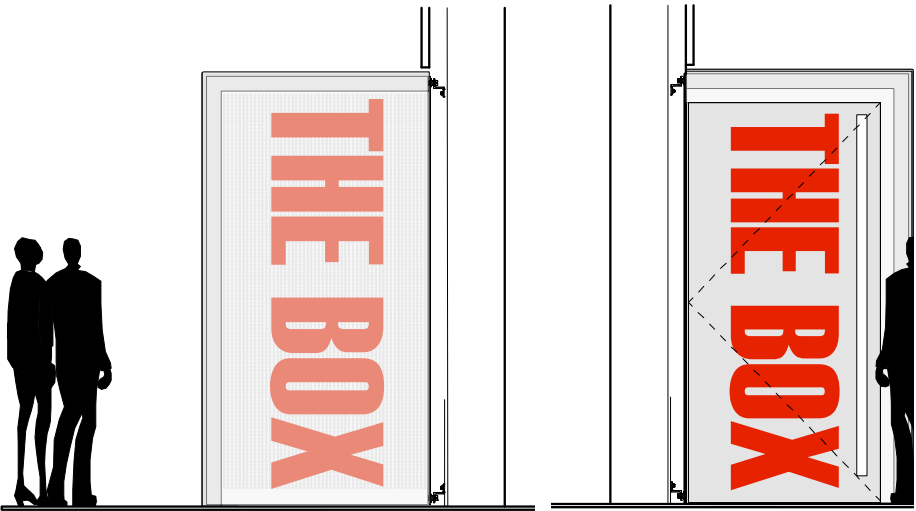

SIDE ELEVATION 1:50

ENTRANCE ELEVATION 1:50

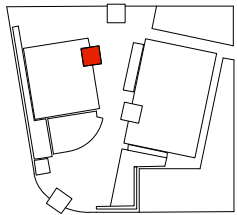

First Issue -----

PROPOSED CUBE TO GALLERY 1

### FUNDING

All dimensions to be checked on site and errors reported to the architect  
Do not scale, any dimensions not specified to be verified by the architect  
All superseded drawings should be replaced or clearly marked 'superseded'

5.005 Rev. -

Scale 1:50 / 1:20

Drawn by: SV Checked by: MF Sheet size: A3

Union North Elevator Studios 29 Parliament St, Liverpool L8 5RN  
T 0151 709 6252. F 0151 7070368. mail@unionnorth.co.uk