

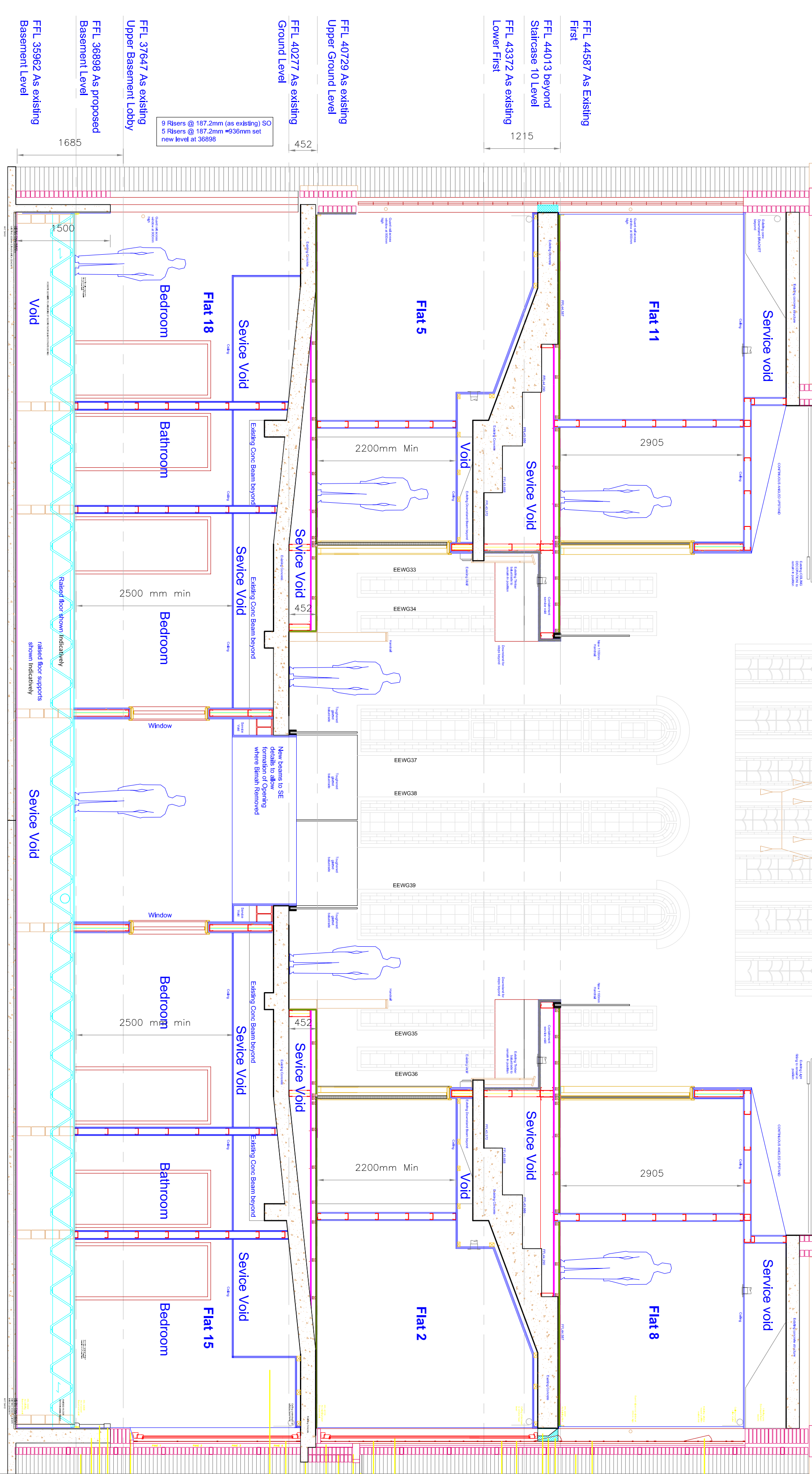

54293 As
Existing Ridge

48709 As
Existing Parapet





NC Architecture, 1st Fl. Suite The Island St, Am's Parade,
Alderley Rd, Winslow, Cheshire, SK9 1HG
T: 01625 536 767
F: 01625 536 765
E: info@ncarchitecture.com
W: www.ncarchitecture.com

Project
Residential Development @ Greenbank Synagogue Site

Drawing
Diagrammatic Proposed Cross-Section

Proj No
2214

Draw No
P-300

Scale
1:100 @ A1
1:200 @ A3

Date (MM/YY)
March 16

STATUS: PLANNING

Revision Item Date Drawn

Pericope
L17 1AN

Checked
TK

Drawn By
IL

Figured dimensions to be followed in preference to scaled. All dimensions to be checked on site, in the event of any discrepancy the dimensions on the drawing shall prevail. The drawing is the copyright of the Architect and may not be copied in whole or part without prior written consent.