

Proposed Floor Plan 1:100 @ A1

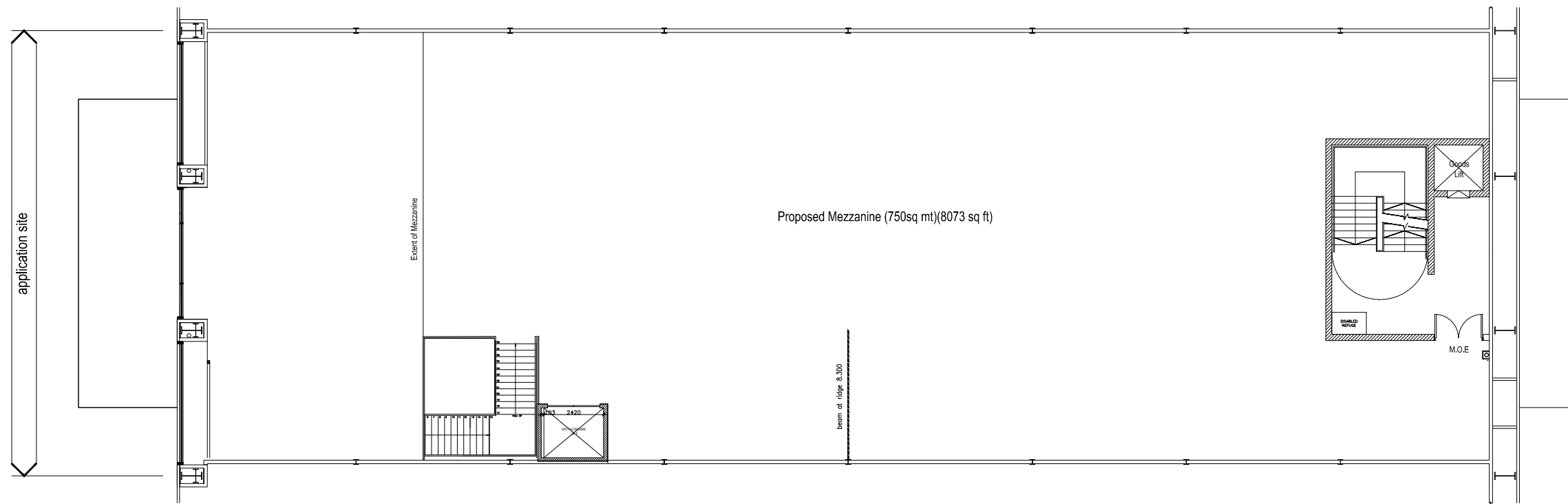

Proposed Floor Plan 1:100 @ A1

<p>Notes:</p> <p>0mm 50mm A1 original sheet size</p> <p>Contact HLN regarding terms & conditions, copyrights, CDM, etc. Check printed scale, responsibility is not accepted for reproduction of digital media or measuring from this document. Only figured dimensions to be used for construction. Report doubts/discrepancies to project Architect.</p>	<p>Notes:</p> <p>This feasibility drawing has been produced using an ordnance survey drawing. All boundaries and built locations are subject to full measured topographical survey. All service routes and locations are subject to conformation by approved statutory body/subscon survey. All proposed design work is subject to full consultation with LA planning and Highways.</p> <p>This original drawing is issued for the purpose indicated and contains confidential information. Further copies and circulation will be strictly in accordance with the confidentiality agreement with Hlnarchitects.</p> <p>Safely Health & Environmental (S.H.E.) Notes are for informing competent persons of significant risks or design issues, relevant to their area of work, which may be unusual or not obvious, or which might be difficult to manage.</p>
---	---

<p>Client mothercare CONTRACTOR</p> <p>Drawing Status PRELIMINARY</p> <p>HLN Architects Ltd 21/22 Neptune Court, Vanguard Way, Cardiff, CF24 5PJ</p> <p>t:029 2039 8611 f:029 2037 4690 e:info@hlnarchitects.com w:www.hlnarchitects.com</p>	<p>Project Mothercare Merseyside Retail Park</p> <p>Scale 1:100 @ A1 Date 21.08.14</p> <p>Drawn by mt Checked AA</p>	<p>Drawing Title Proposed Floor Plans</p> <p>Job No: 7032 Drawing No: (20) 200 Rev: -</p> <p> <input checked="" type="checkbox"/> CARDIFF <input type="checkbox"/> REDDITCH <input type="checkbox"/> LONDON </p> <p> HLN ARCHITECTURE + ENGINEERING <small>Chartered Practice</small> </p>
--	---	---