



architects

54 hamilton square birkenhead

Tel 0151 666 2990

office@cta-architects.co.uk

1768- CONDITIONS DISCHARGE FOR APPLICATION – 14L/2709 (Town and country planning)

Condition 1

Informative

Condition 2

Informative

Condition 3

Informative

Condition 4

Informative

Condition 5

- (i) The existing brick pavours will be carefully lifted and stored on site. Once the extension is complete they will be re-laid in the courtyard. Please see photo below for reference.

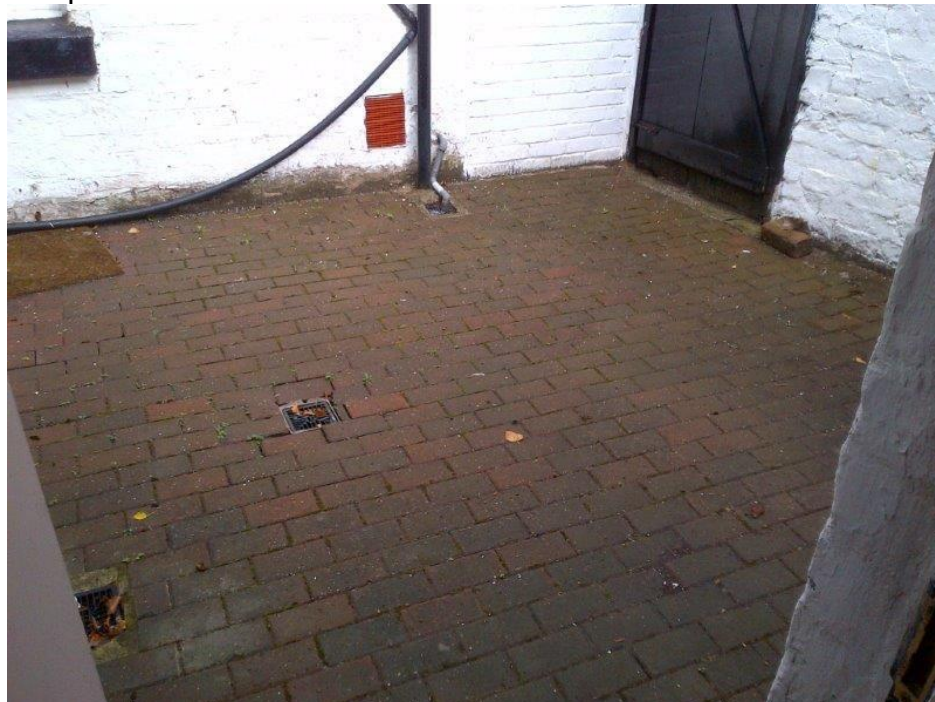

- (ii) Please refer to drawing 1678- Conditions drawing
 (iii) The new pyramid roof lights on the rear extension are made by `Roof Maker` they measure 1m by 1m please see below for product details.
 The roof lights will be blue tinted to counter act solar gain.

Pyramid Skylights



FRAMELESS ROOFLIGHT - TECHNICAL SPECIFICATION

Glass Type: Reflex+ High Performance 24mm Double Glazed Unit
Glass Colour Options: Reflex+ (Clear, Blue, Bronze or Opaque)

Please Note: Whilst we endeavour to ensure our information is as up to date and accurate as possible, the sizes shown may vary slightly. Sizes may also change without notice due to newer manufacturing techniques or requirements, our information will be updated as often as possible when these changes occur.

ROOFmaker

Manufacturers of super insulating skylights for flat roofs

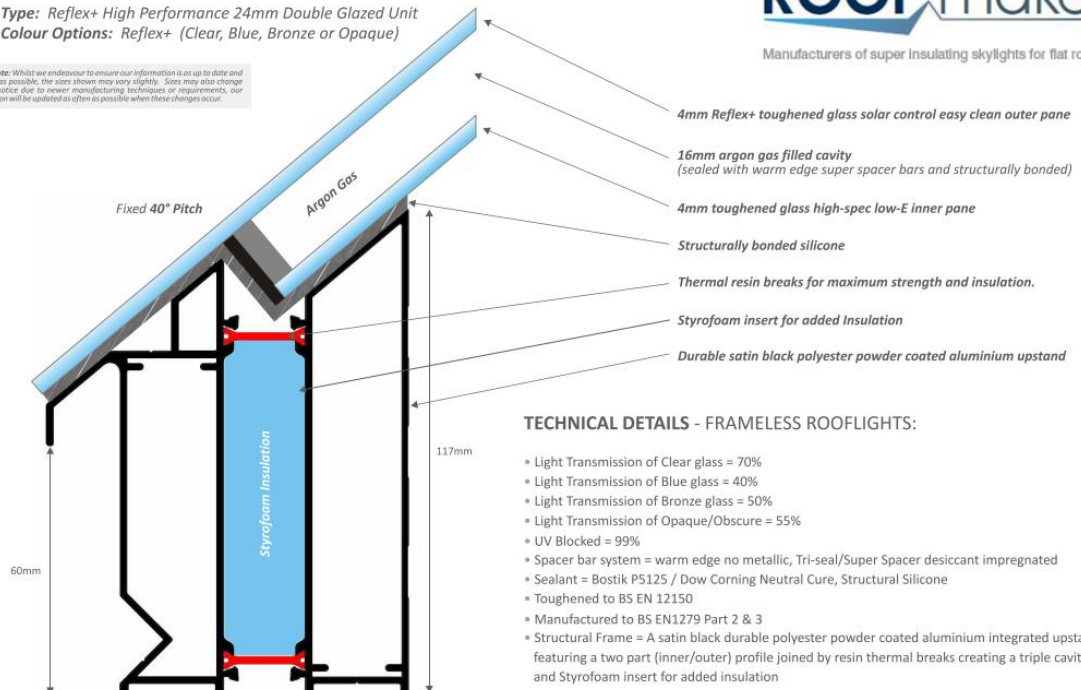

- (iv) The existing gate will be reutilised. It will be refurbished and made more secure.
- (v) Informative
- (vi) Please refer to drawing 1678- Conditions drawing.
- (vii) Please refer to drawing 1678-Condition drawing. Please note that all wiring will be taken through the floor zone and as such will not be visible.