

EXISTING LIFT SECTION A
SCALE 1:50

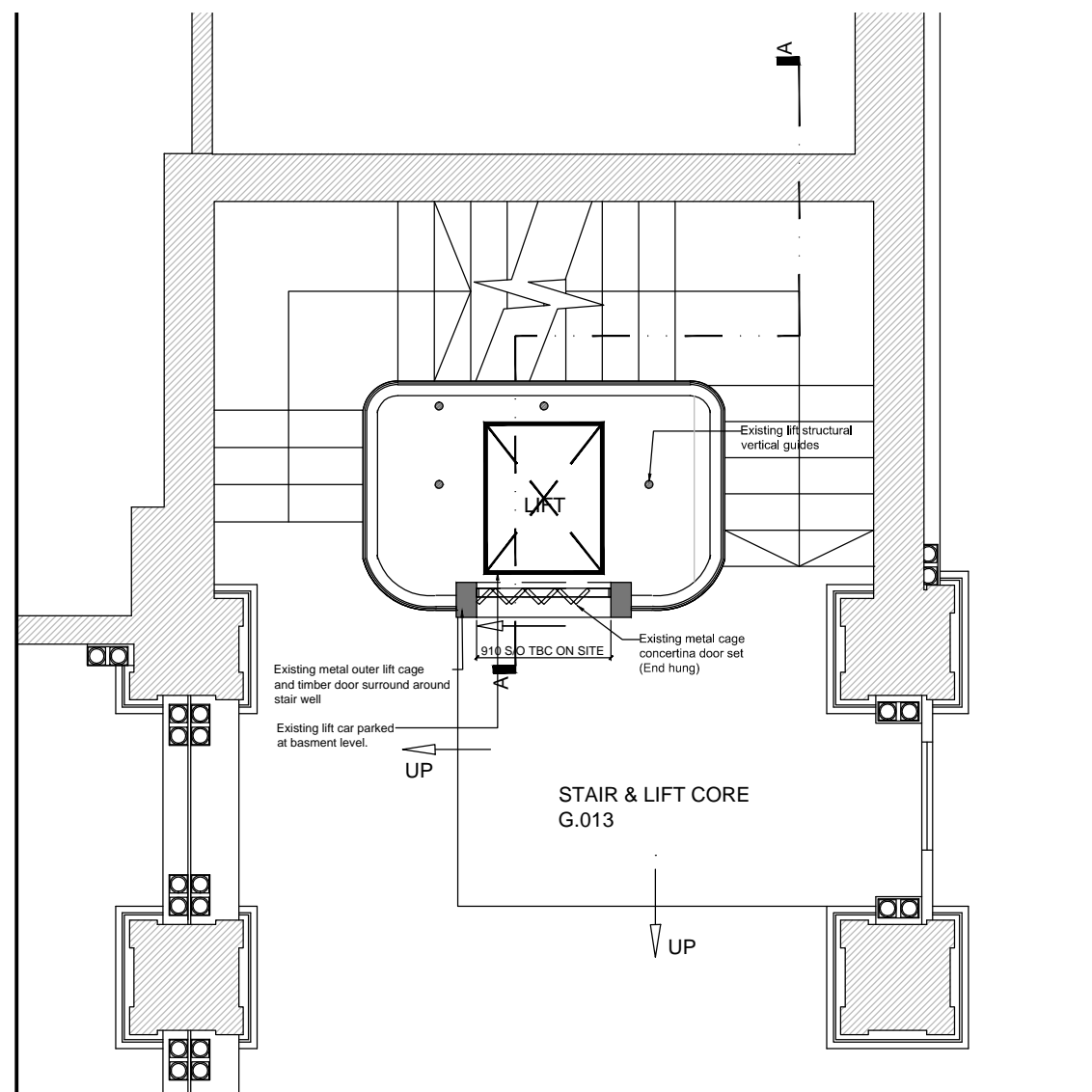

EXISTING GROUND FLOOR LEVEL
SCALE 1:50

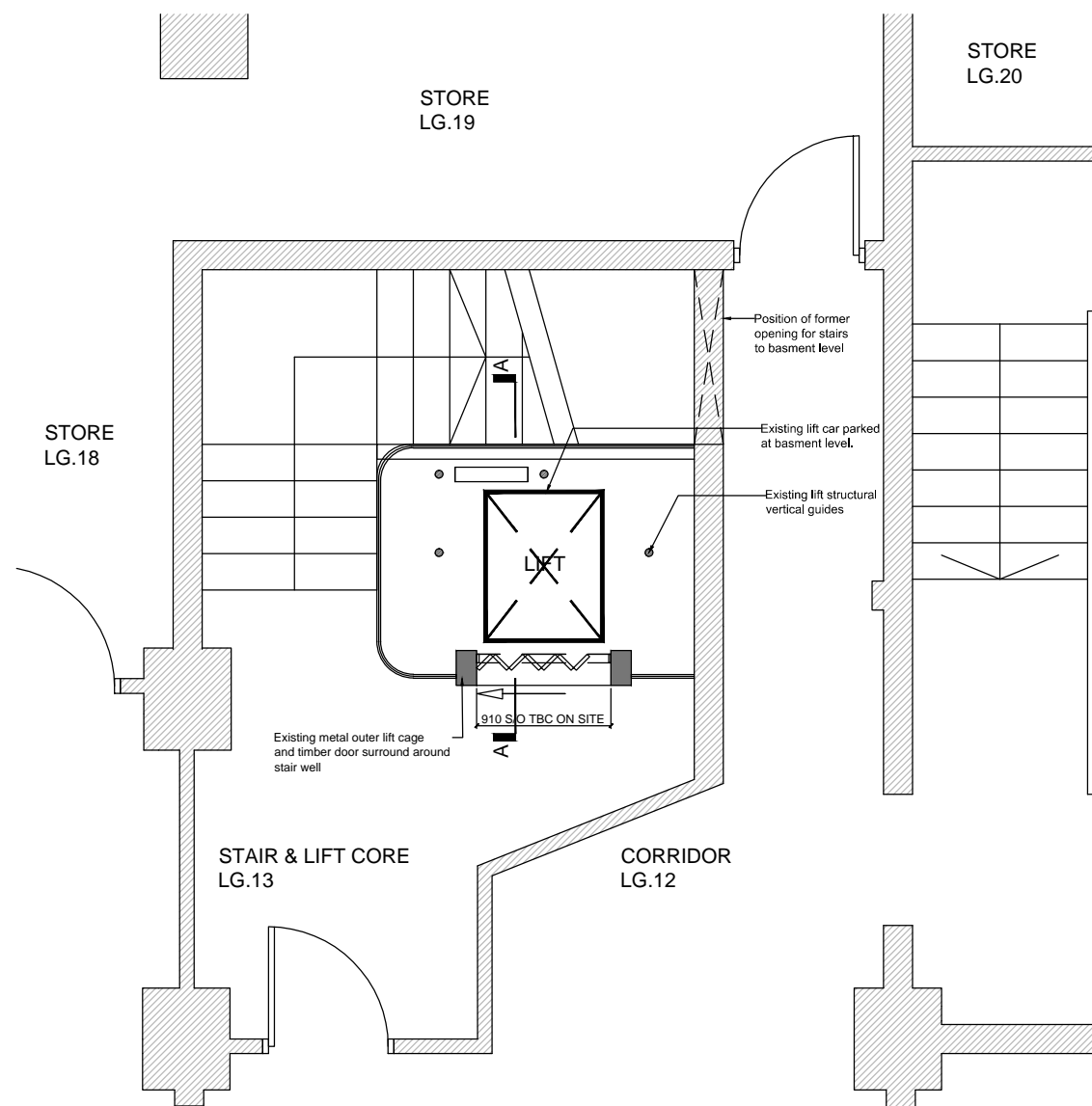

EXISTING LOWER GROUND FLOOR LEVEL
SCALE 1:50

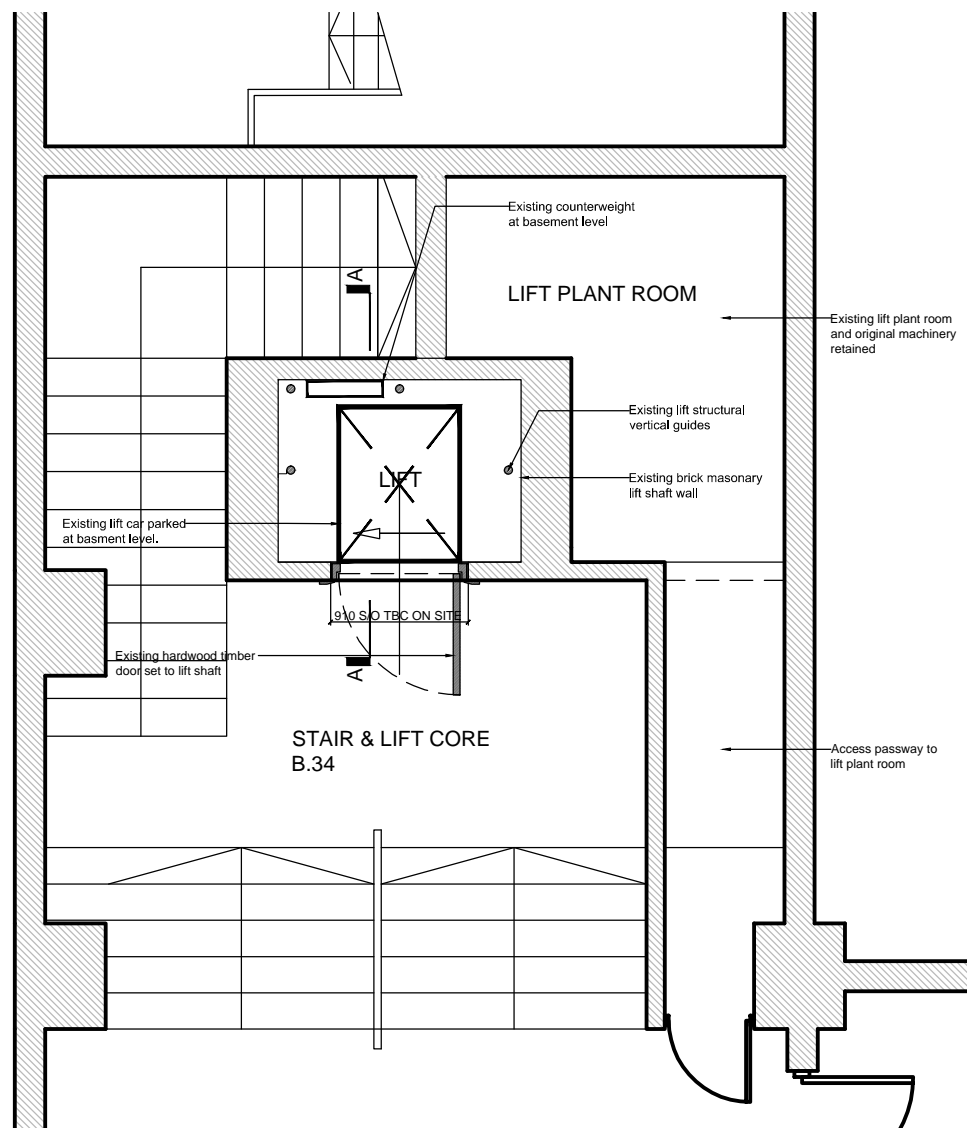

EXISTING BASEMENT LEVEL
SCALE 1:50

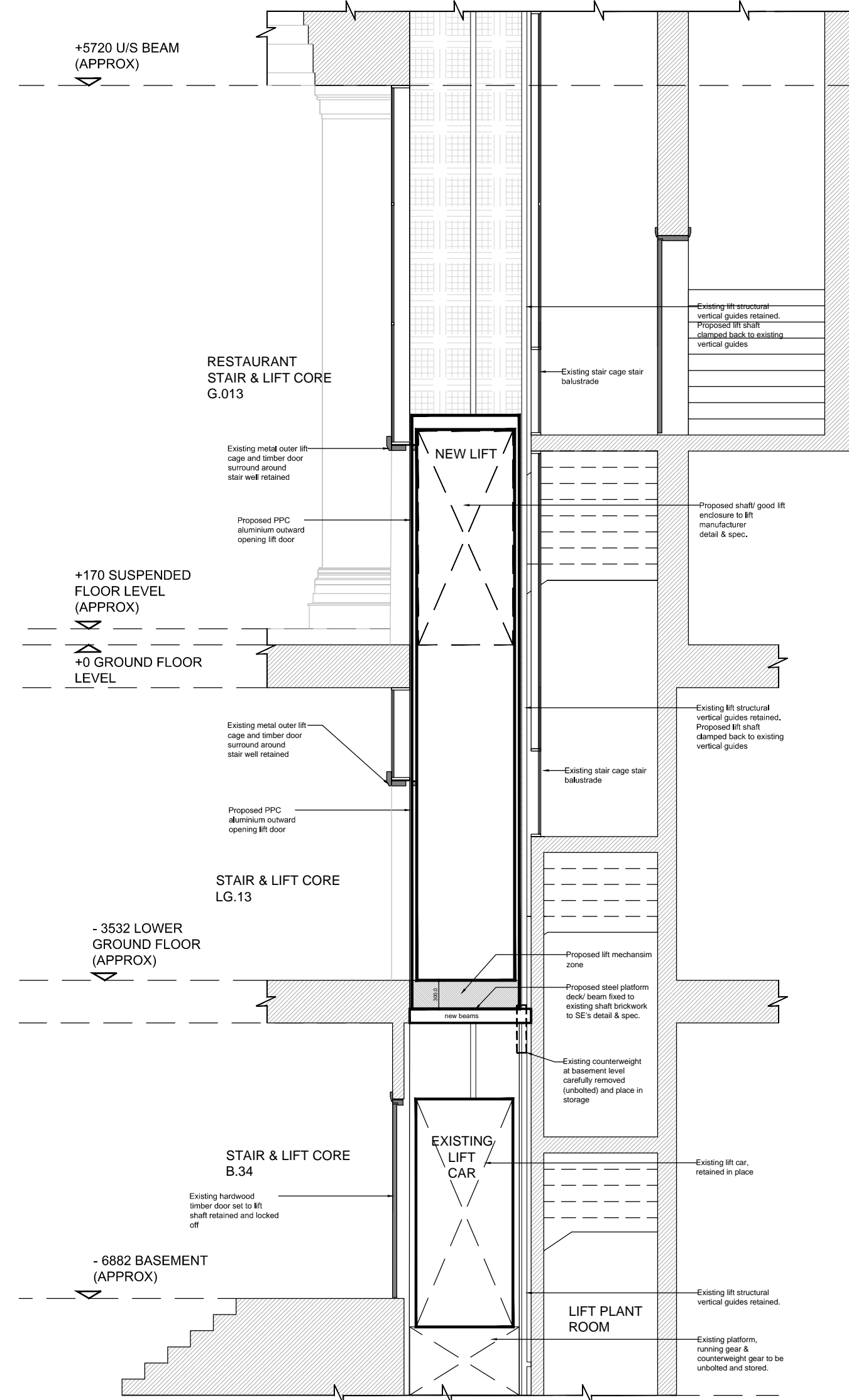

PROPOSED LIFT SECTION B
SCALE 1:50

Proposed new freestanding independent service lift and housing. Shaft and car painted black. New support structure steel beams fixed (bolted) between existing shaft base brick walls at lower ground floor level to support freestanding shaft so as not to damage existing lift and running gear. All existing lift running gear, rails, mesh cage to be retained in place. Existing car and lifting gear to be retained in place in basement. Existing running rails used only for clamp support positions to give lateral stability to be shaft. All clamps to be future removable. Existing concertina doors to be carefully removed and placed in storage. Existing lift counterweight to be carefully removed and placed in storage. See indicative arrangement drawing. All details to be agreed

PROPOSED BASEMENT LEVEL
SCALE 1:50

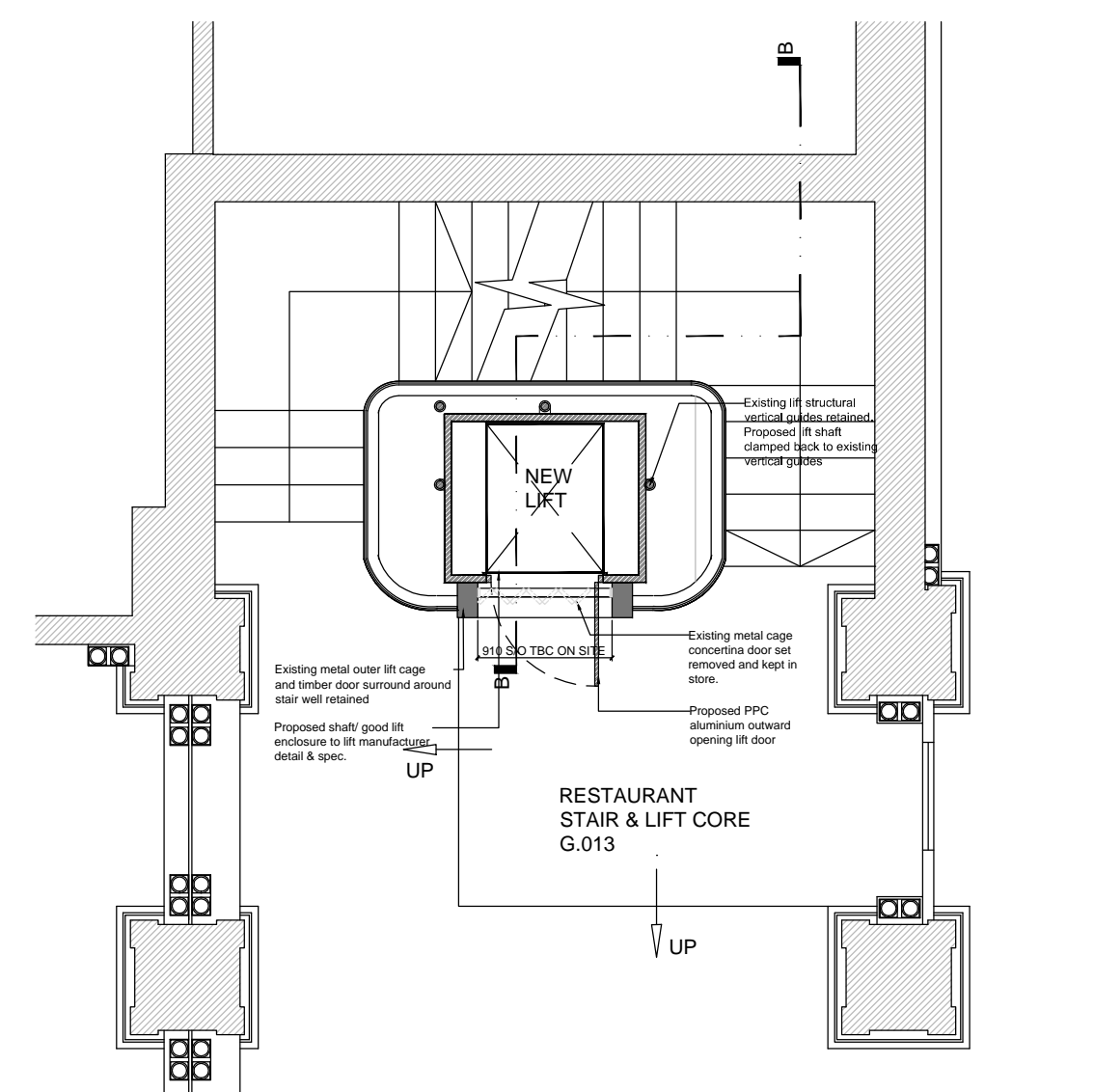

PROPOSED GROUND FLOOR LEVEL
SCALE 1:50

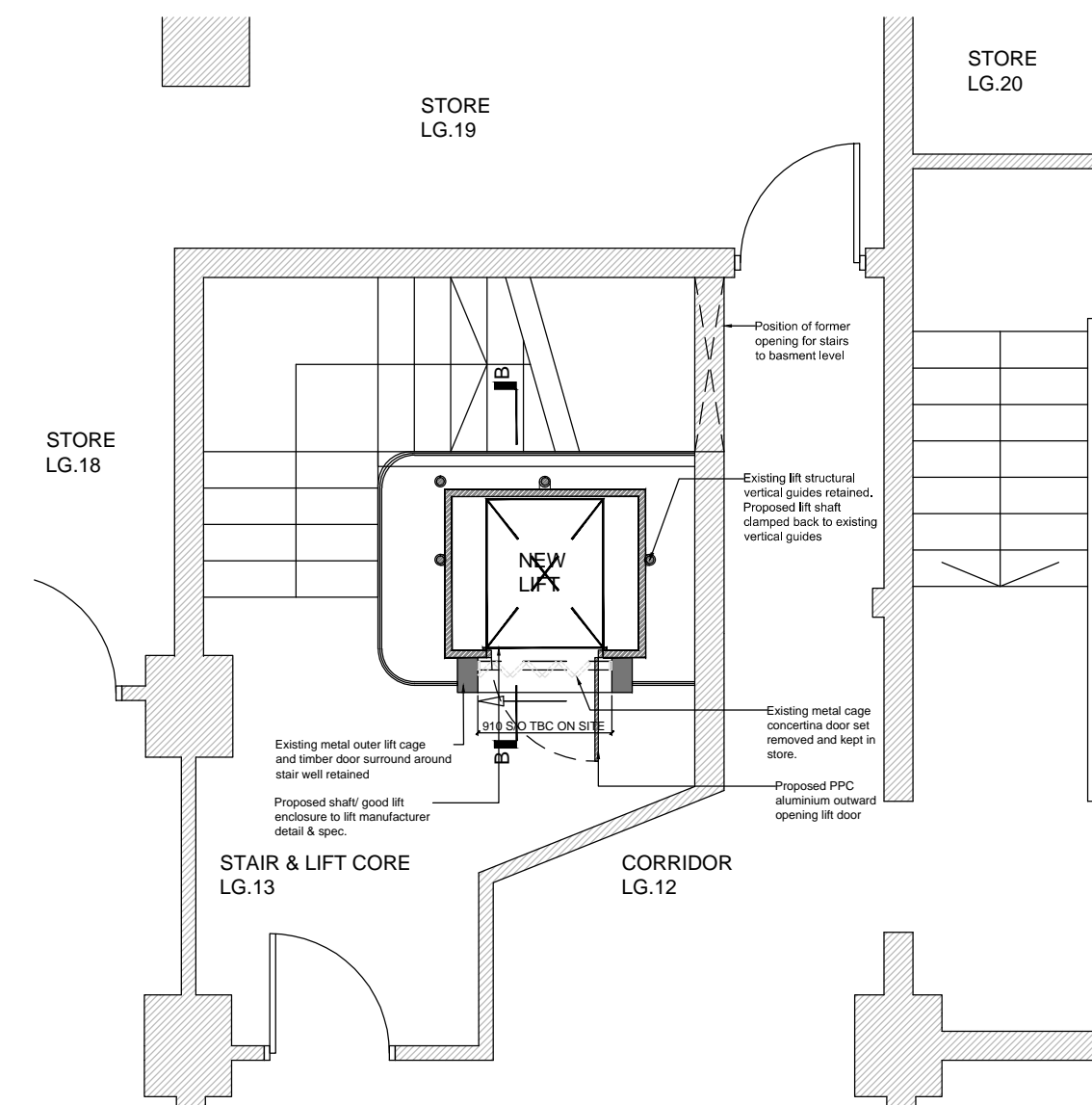

PROPOSED LOWER GROUND FLOOR LEVEL
SCALE 1:50

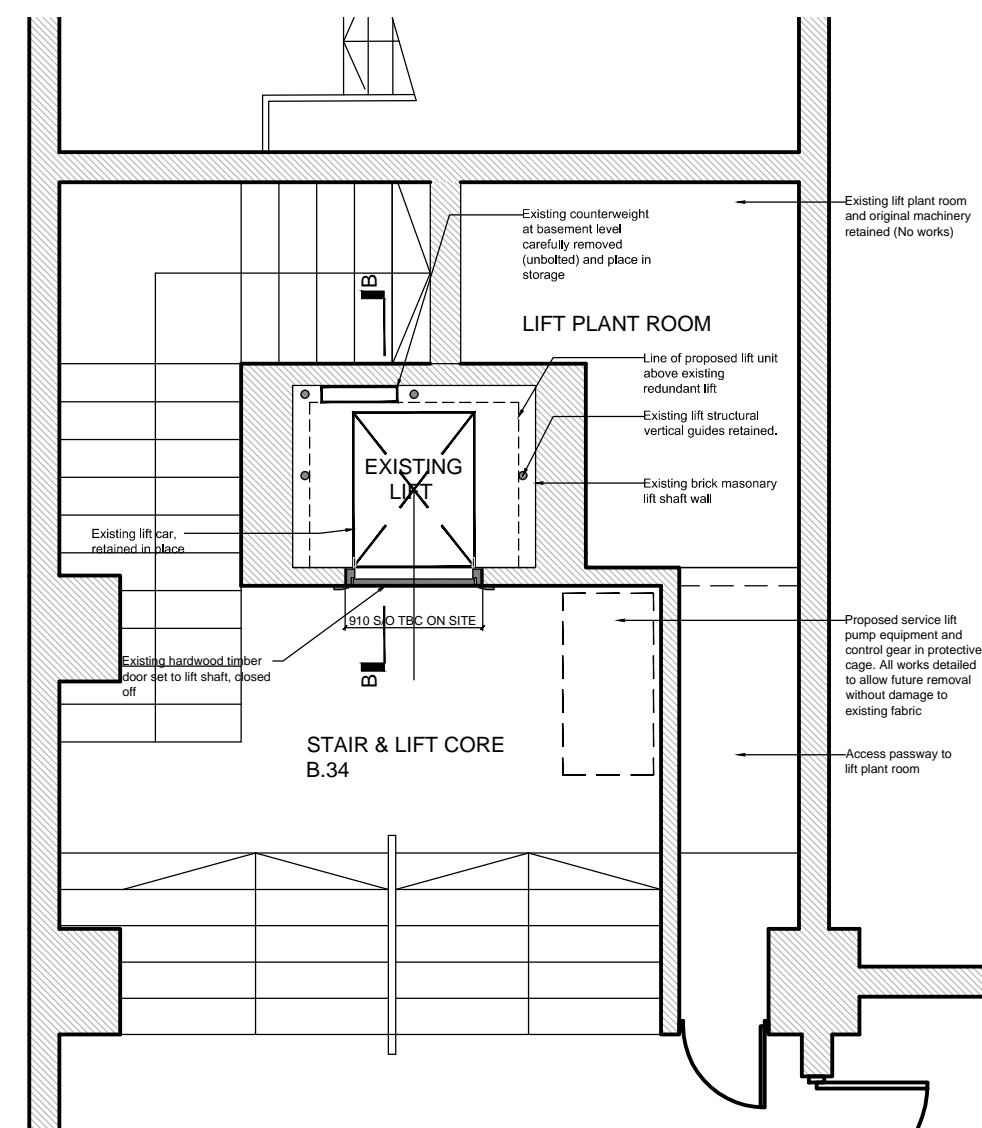

All dimensions to be checked on site.
Figured dimensions to be read in preference to scaled.
BCA accepts no responsibility for any unauthorised amendments to the drawing and does not permit unauthorised copying of the drawing.
This drawing is copyright and remains the property of BCA unless otherwise agreed.

| Revisions | | | |
|-----------|-----|----------------|-------|
| Date | Rev | Description | Init. |
| 16.12.15 | P01 | PLANNING ISSUE | CT |

Notes

PLANNING

| | |
|---------------|----------------------------|
| Client | LIVING VENTURES |
| Job title | CUNARD BUILDING, LIVERPOOL |
| Drawing title | EXISTING AND PROPOSED LIFT |

| | | | | | | | |
|------------|----------|----------------|----------|---------|-----|------|-------|
| Scale | 1:50 BA1 | Drawn | CT | Checked | SF | Date | 12/15 |
| Job number | 15.041 | Drawing number | A(28)100 | Issue | P01 | | |

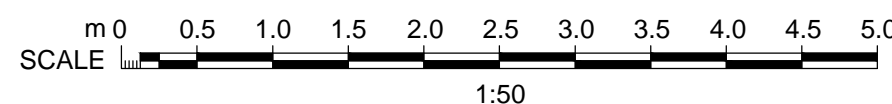

Brock Carmichael Architects

19 OLD HALL STREET
LIVERPOOL
L3 5JH
TEL: 0151 232 6222
FACSIMILE: 0151 238 4467
EMAIL: office@brockcarmichael.co.uk
WEB SITE: www.brockcarmichael.co.uk