

Proposed Block Plan

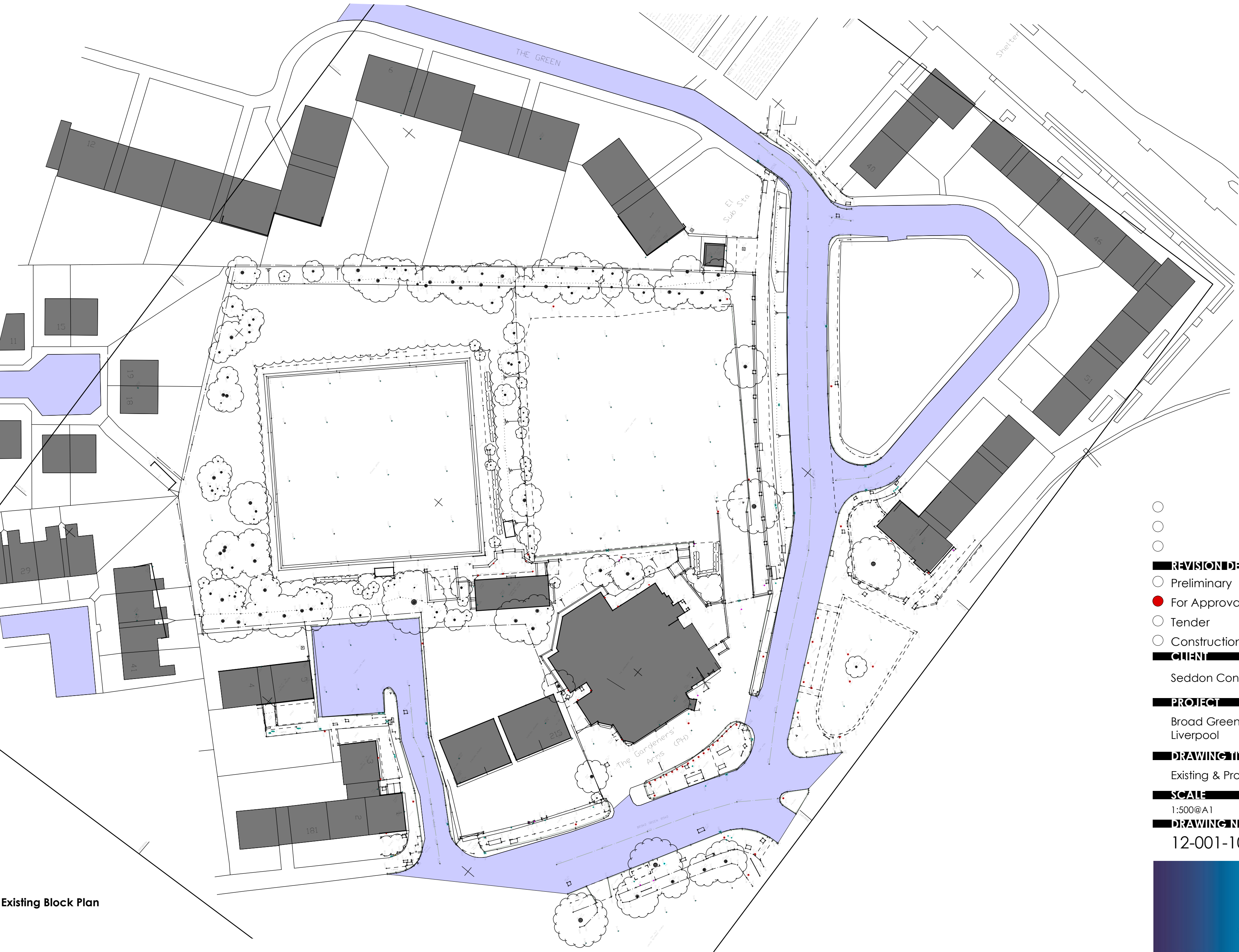

Existing Block Plan

NOTES

- This drawing is copyright of Candy and Lofthouse Ltd. and may not be reproduced in any way without their specific permission.
- All dimensions are to be checked on site. Do not scale from this drawing, work to figures dimensions only. Any queries please contact the architect.
- This drawing has been prepared based upon a digital survey undertaken by Survey Operations, tel 01695 725 662.
- MATERIALS PROHIBITED**  
Materials prohibited from use, except where used in accordance with 'good practice' in the selection of construction materials (2002)
  - High alumina cement in load bearing structures.
  - Wood wool slabs used as permanent shuttering or in structural elements.
  - Calcium chloride used as an additive in mixing concrete for use in reinforced concrete.
  - Aggregates for use in reinforced concrete which do not comply with British standard specifications current at the date of specification of the materials.
  - Calcium silicate bricks or tiles.
  - Asbestos or asbestos based products including crocidolite.
  - Lead or any material containing lead which may be ingested, inhaled or absorbed.
  - Organic formaldehyde fibres or materials which may be hazardous with reference to the limits set by the health & safety executive at the date of specification of the materials.
  - Materials which are generally composed of mineral fibres either man-made or naturally occurring which have a diameter of 3 microns or less and a length of 200 microns or less, or which contain any fibres not tested or otherwise stabilised to ensure that fibre migration is prevented.

REVISION DRAWS date / by

Preliminary

For Approval

Tender

Construction

CLIENT

Seddon Construction Ltd.

PROJECT

Broad Green House,  
Liverpool

DRAWING TITLE

Existing & Proposed Block Plan

SCALE drawn by date

1:500@A1 MW Jun 2012

DRAWING NO revision

12-001-102



T: 0151 207 4371 • F: 0151 207 7087