

PROPOSED IMPERMEABLE AREA = 3290m²

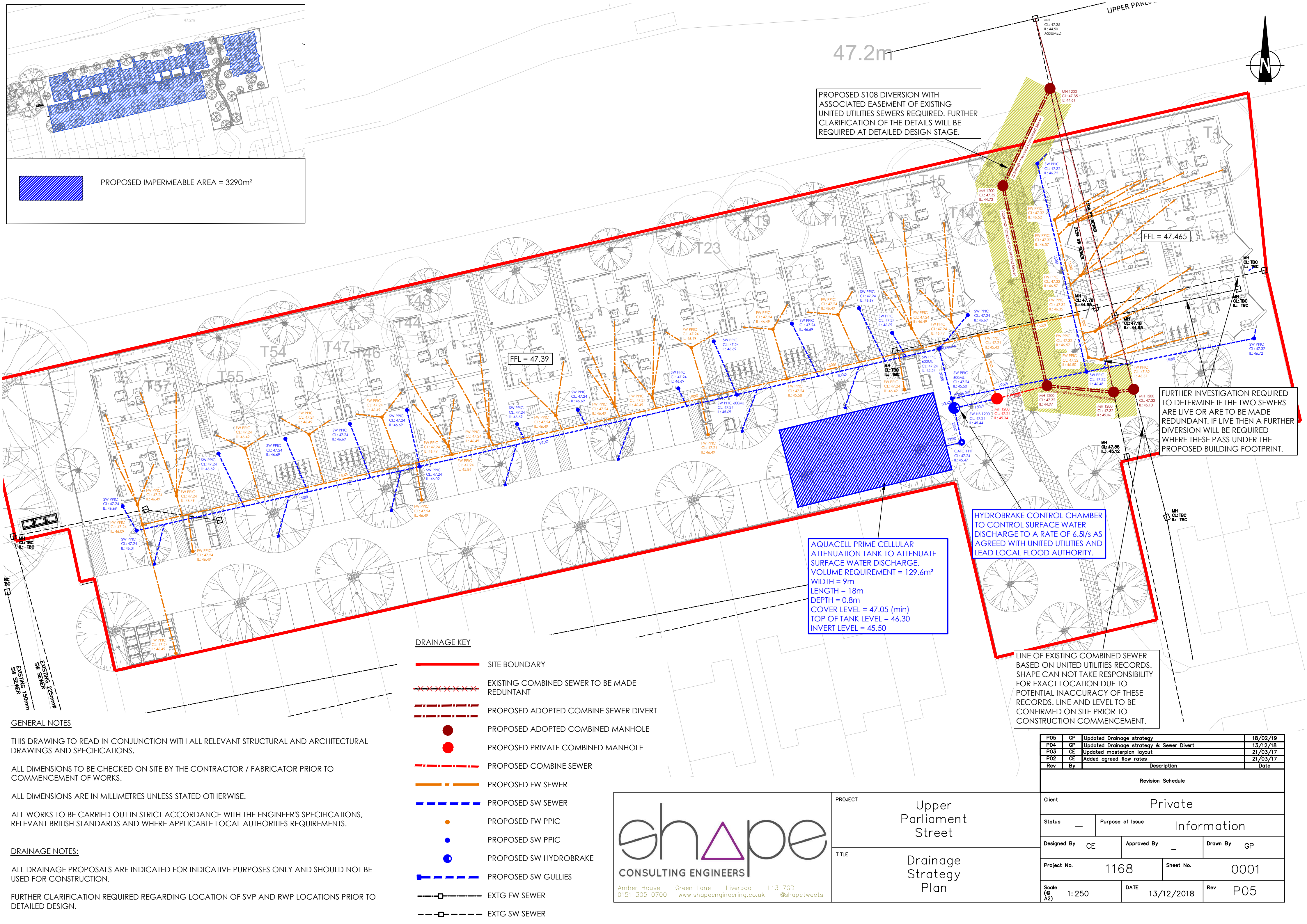

PROPOSED S108 DIVERSION WITH ASSOCIATED EASEMENT OF EXISTING UNITED UTILITIES SEWERS REQUIRED. FURTHER CLARIFICATION OF THE DETAILS WILL BE REQUIRED AT DETAILED DESIGN STAGE.

FFL = 47.465

FFL = 47.39

AQUACELL PRIME CELLULAR ATTENUATION TANK TO ATTENUATE SURFACE WATER DISCHARGE. VOLUME REQUIREMENT = 129.6m³  
WIDTH = 9m  
LENGTH = 18m  
DEPTH = 0.8m  
COVER LEVEL = 47.05 (min)  
TOP OF TANK LEVEL = 46.30  
INVERT LEVEL = 45.50

HYDROBRAKE CONTROL CHAMBER TO CONTROL SURFACE WATER DISCHARGE TO A RATE OF 6.5l/s AS AGREED WITH UNITED UTILITIES AND LEAD LOCAL FLOOD AUTHORITY.

FURTHER INVESTIGATION REQUIRED TO DETERMINE IF THE TWO SEWERS ARE LIVE OR ARE TO BE MADE REDUNDANT. IF LIVE THEN A FURTHER DIVERSION WILL BE REQUIRED WHERE THESE PASS UNDER THE PROPOSED BUILDING FOOTPRINT.

LINE OF EXISTING COMBINED SEWER BASED ON UNITED UTILITIES RECORDS. SHAPE CAN NOT TAKE RESPONSIBILITY FOR EXACT LOCATION DUE TO POTENTIAL INACCURACY OF THESE RECORDS. LINE AND LEVEL TO BE CONFIRMED ON SITE PRIOR TO CONSTRUCTION COMMENCEMENT.

DRAINAGE KEY

- SITE BOUNDARY
- EXISTING COMBINED SEWER TO BE MADE REDUNTANT
- PROPOSED ADOPTED COMBINE SEWER DIVERT
- PROPOSED ADOPTED COMBINED MANHOLE
- PROPOSED PRIVATE COMBINED MANHOLE
- PROPOSED COMBINE SEWER
- PROPOSED FW SEWER
- PROPOSED SW SEWER
- PROPOSED FW PPIC
- PROPOSED SW PPIC
- PROPOSED SW HYDROBRAKE
- PROPOSED SW GULLIES
- EXTG FW SEWER
- EXTG SW SEWER

GENERAL NOTES

THIS DRAWING TO READ IN CONJUNCTION WITH ALL RELEVANT STRUCTURAL AND ARCHITECTURAL DRAWINGS AND SPECIFICATIONS.

ALL DIMENSIONS TO BE CHECKED ON SITE BY THE CONTRACTOR / FABRICATOR PRIOR TO COMMENCEMENT OF WORKS.

ALL DIMENSIONS ARE IN MILLIMETRES UNLESS STATED OTHERWISE.

ALL WORKS TO BE CARRIED OUT IN STRICT ACCORDANCE WITH THE ENGINEER'S SPECIFICATIONS, RELEVANT BRITISH STANDARDS AND WHERE APPLICABLE LOCAL AUTHORITIES REQUIREMENTS.

DRAINAGE NOTES:

ALL DRAINAGE PROPOSALS ARE INDICATED FOR INDICATIVE PURPOSES ONLY AND SHOULD NOT BE USED FOR CONSTRUCTION.

FURTHER CLARIFICATION REQUIRED REGARDING LOCATION OF SVP AND RWP LOCATIONS PRIOR TO DETAILED DESIGN.

Amber House 0151 305 0700  
Green Lane www.shapeengineering.co.uk  
Liverpool L13 7GD  
@shapetweets

PROJECTUpper Parliament Street

TITLEDrainage Strategy Plan

ClientPrivate		
Status	Purpose of IssueInformation	
Designed ByCE	Approved By	Drawn ByGP
Project No.1168		Sheet No.0001
Scale1:250	DATE13/12/2018	RevP05

P05	GP	Updated Drainage strategy	18/02/19
P04	GP	Updated Drainage strategy & Sewer Divert	13/12/18
P03	CE	Updated masterplan layout	21/03/17
P02	CE	Added agreed flow rates	21/03/17
Rev	By	Description	Date
Revision Schedule			