

TYPICAL MANHOLE DETAIL TYPE A
DEPTH FROM GROUND LEVEL TO SOFFIT OF PIPE 3m TO 6m

TYPICAL MANHOLE DETAIL TYPE B
MAXIMUM DEPTH FROM GROUND LEVEL TO SOFFIT OF PIPE 3.0m

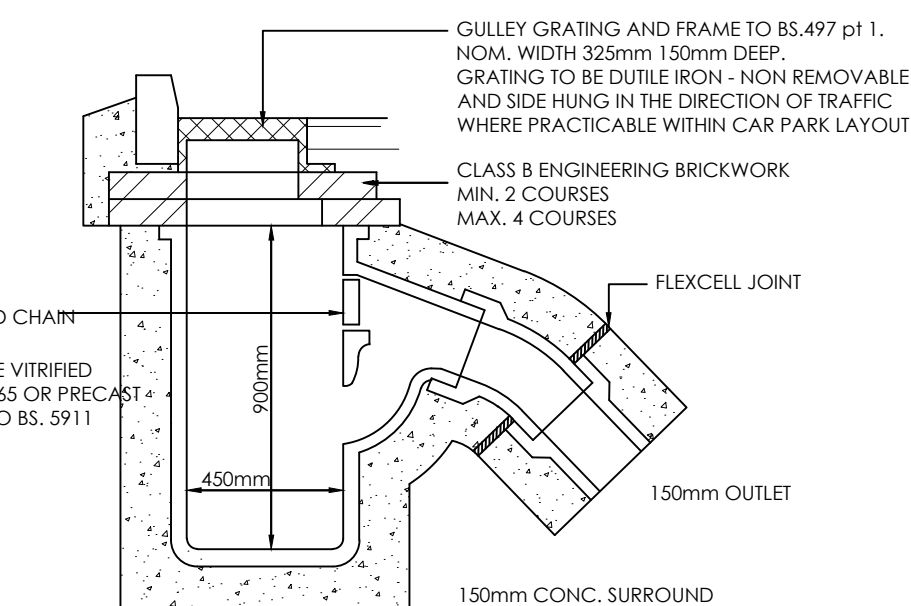

TYPICAL ROAD GULLEY DETAIL

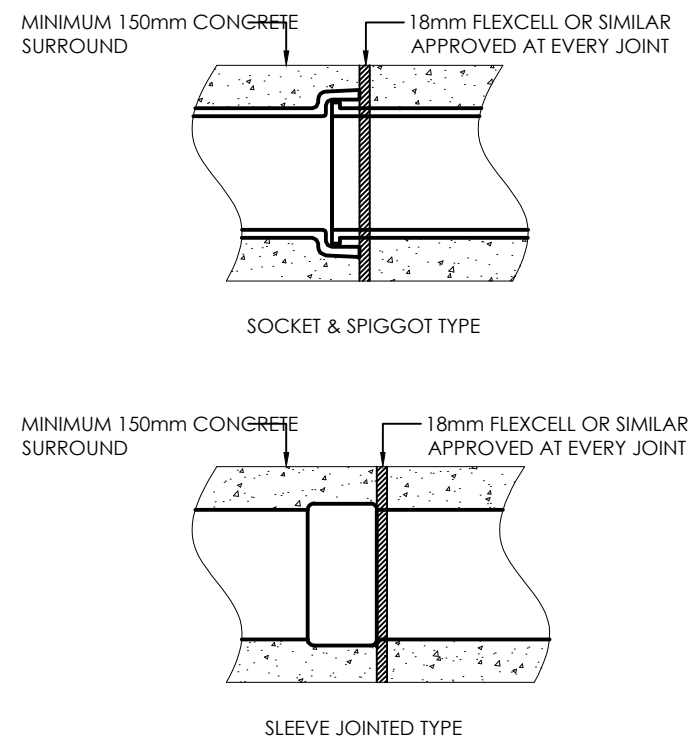

PLAN ON CONCRETE ENCASED PIPES
REQUIRED IN ROADWAYS & OTHER AREAS OF VEHICULAR TRAFFIC WHERE PIPE COVER IS LESS THAN 900mm (TO SOFFIT OF PIPE)

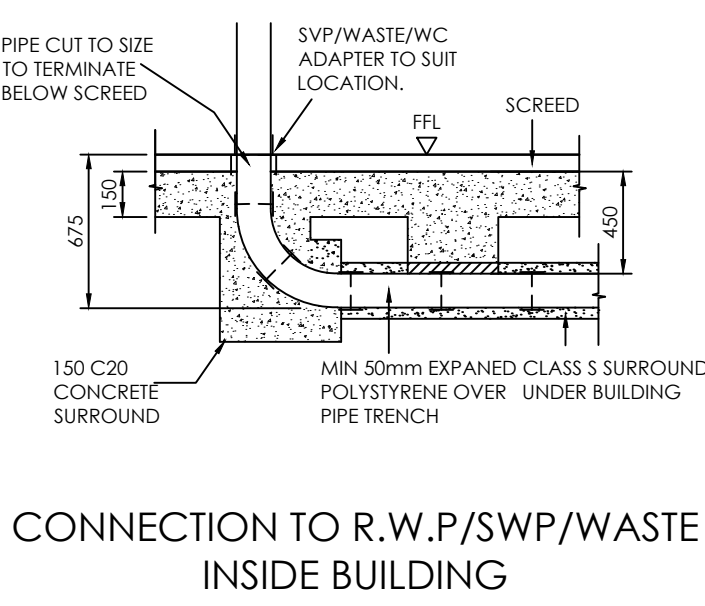

CONNECTION TO R.W.P./SWP/WASTE INSIDE BUILDING

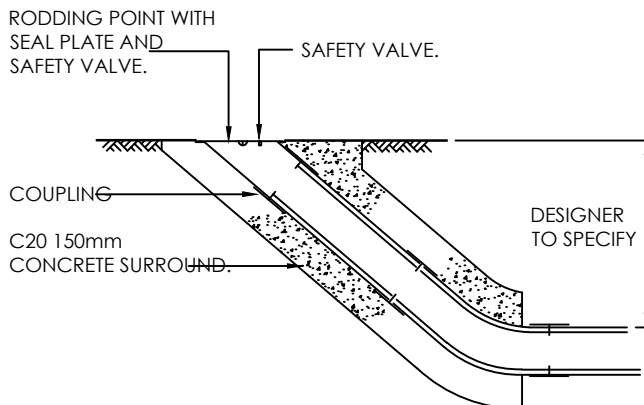

RODDING EYE

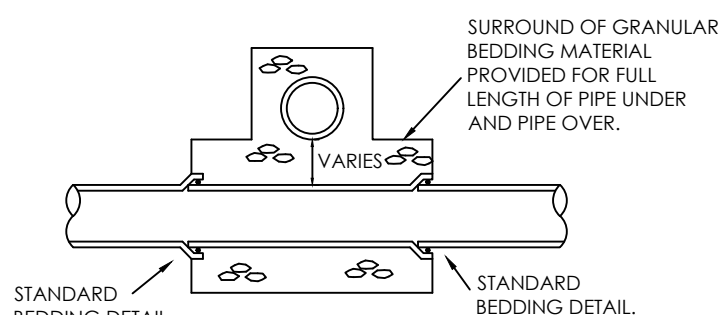

PIPE CROSS OVER DETAIL

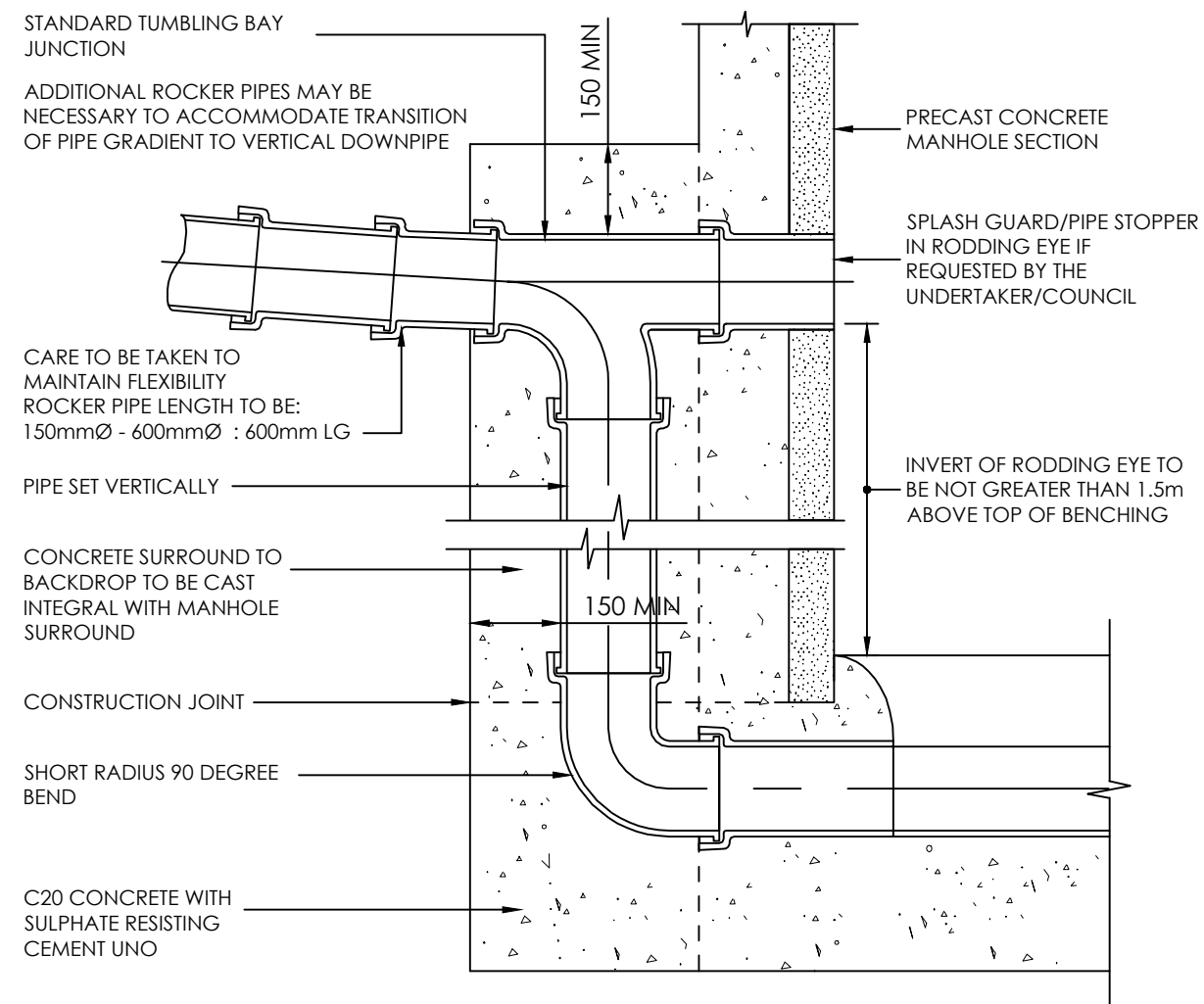
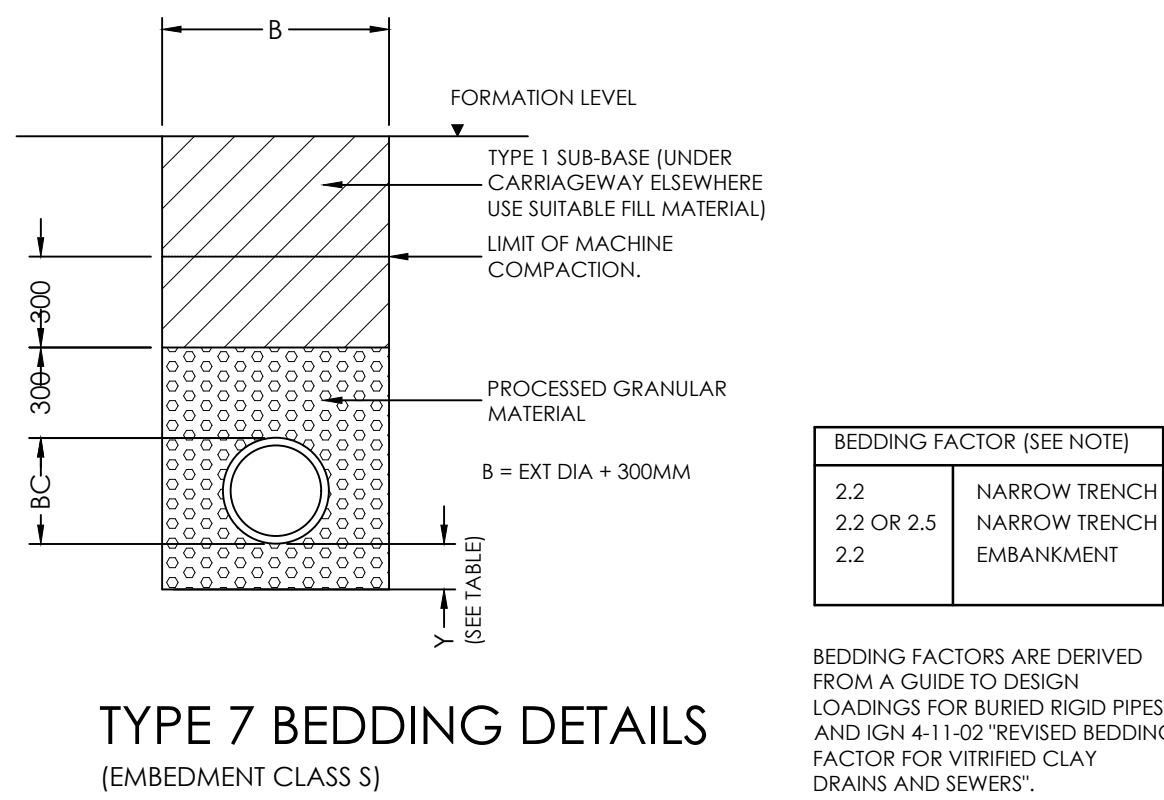

TYPICAL BACKDROP DETAIL

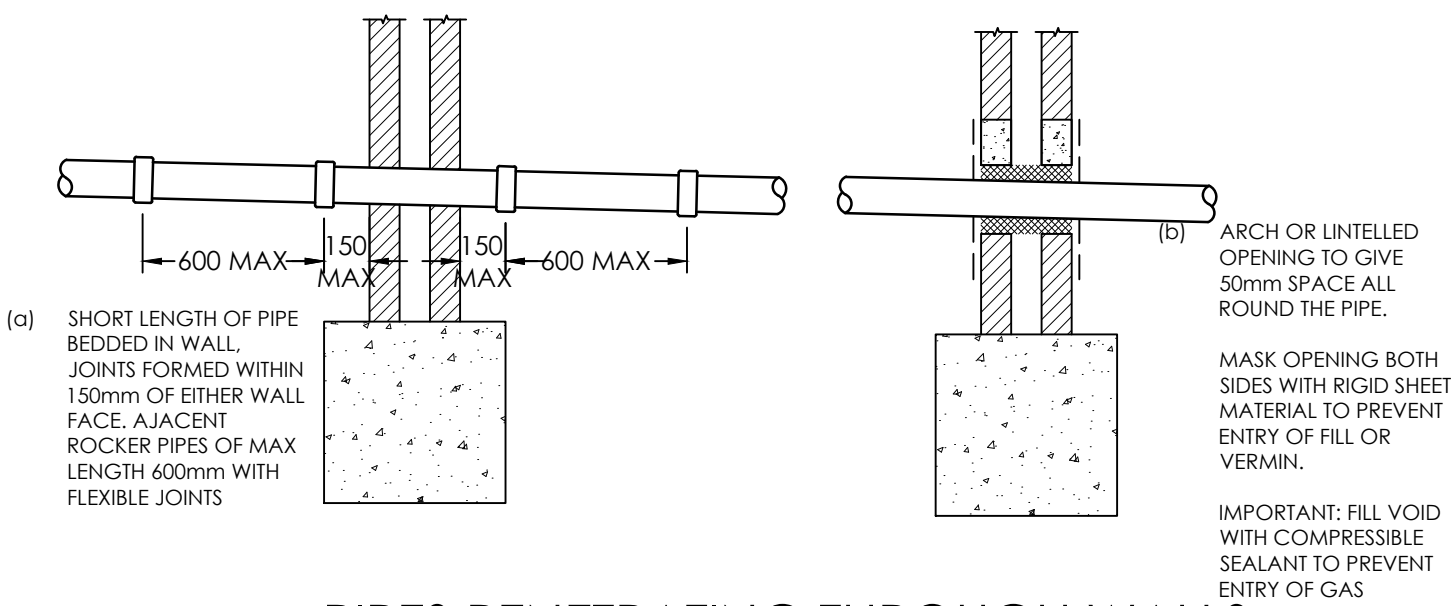

PIPES PENETRATING THROUGH WALLS

| NORMAL INT PIPE DIA | MINIMUM INTERNAL CHAMBER DIA | MINIMUM CLEAR OPENING SIZE | COVER SLAB ACCESS HOLE | COVER FRAME SEALING RING |
|---------------------|------------------------------|----------------------------|------------------------|--------------------------|
| 100 | 1050 | 750x750 | 750x750 CENTRAL | 750x750 CENTRAL |
| 150 | 1050 | 750x750 | 750x750 CENTRAL | 750x750 CENTRAL |
| 225 | 1200 | 1200x675 | 1200x675 CENTRAL | 1200x675 CENTRAL |
| 300 | 1200 | 1200x675 | 1200x675 CENTRAL | 1200x675 CENTRAL |
| 375 | 1350 | 1200x675 | 1200x675 CENTRAL | 1200x675 CENTRAL |

NOTE:

1 ALL DIMENSIONS IN MM

2 A CONCRETE SURROUND IS NOT NORMALLY TO MANHOLES UNLESS INSTALLED IN AREA OF UNSTABLE GROUND, UNDER CONDITIONS OF FLOATATION OR WHERE SUBJECTED TO EXCEPTIONAL OR ECCENTRIC LOADS IN WHICH CASES A 150mm SURROUND OF AT LEAST 20/20MM CONCRETE SHOULD BE PROVIDED. ANY JOINTS SHOULD BE STAGGERED WITH THE PRECAST CONCRETE JOINTS.

3 DOUBLE STEPS SHALL BE PLASTIC ENCAPSULATED CARBON TO BS EN 1247-2 MANHOLE STEPS. STEP IRONS AT 300 CENTRES HORIZONTALLY AND VERTICALLY MAY BE USED AS AN ALTERNATIVE TO DOUBLE STEPS.

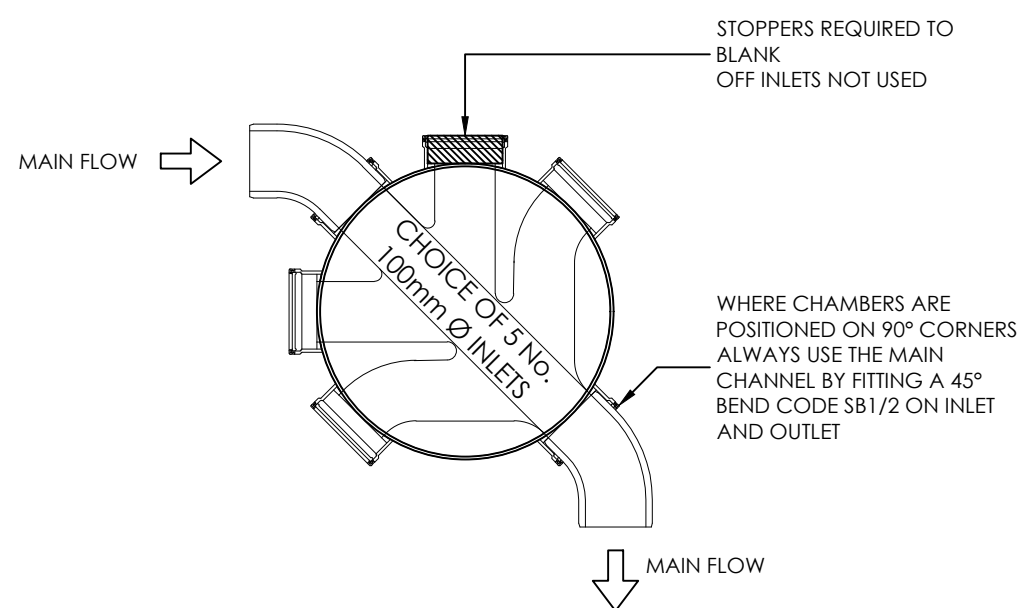

PLAN ON POLYPROPYLENE INSPECTION CHAMBER
(N.T.S)

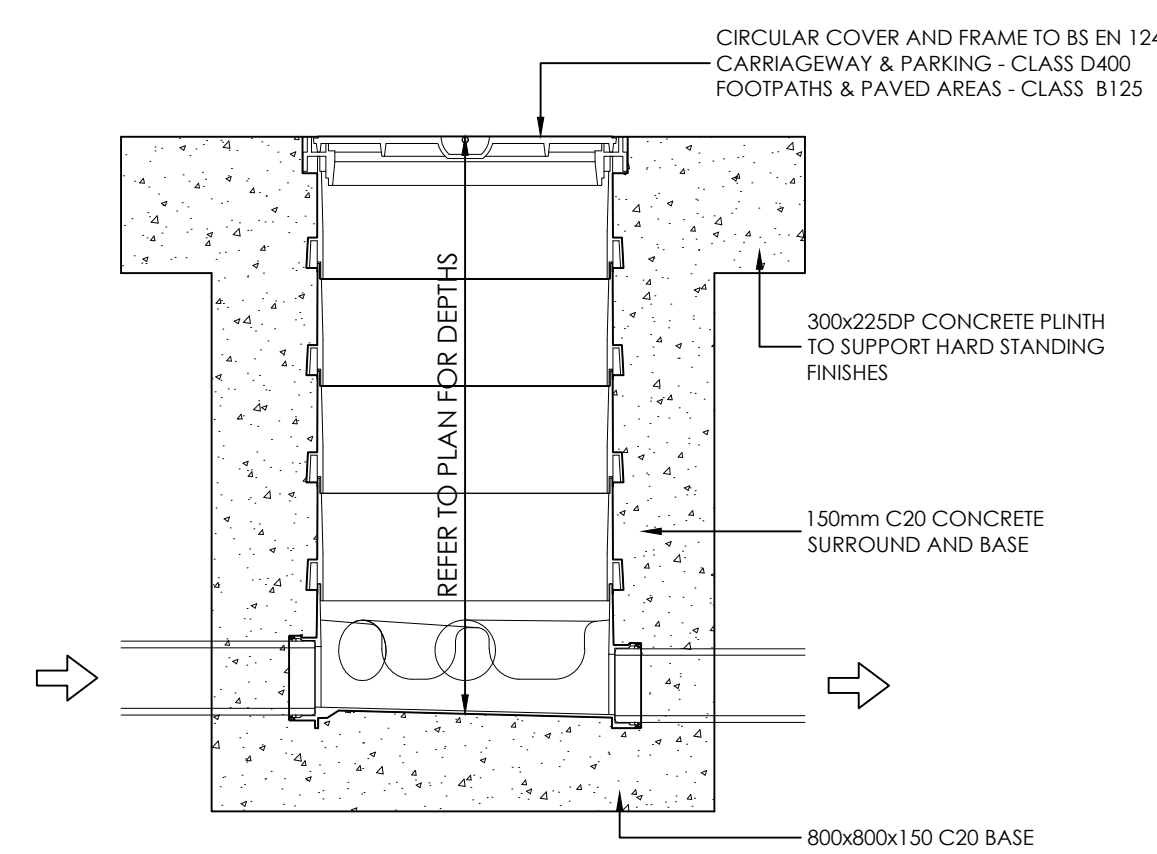

SECTION OF POLYPROPYLENE INSPECTION CHAMBER
(N.T.S)

DO NOT SCALE OFF THIS DRAWING

GENERAL NOTES

THIS DRAWING TO READ IN CONJUNCTION WITH ALL RELEVANT STRUCTURAL AND ARCHITECTURAL DRAWINGS AND SPECIFICATIONS.

ALL DIMENSIONS TO BE CHECKED ON SITE BY THE CONTRACTOR / FABRICATOR PRIOR TO COMMENCEMENT OF WORKS.

ALL DIMENSIONS ARE IN MILLIMETRES UNLESS STATED OTHERWISE.

ALL WORKS TO BE CARRIED OUT IN STRICT ACCORDANCE WITH THE ENGINEER'S SPECIFICATIONS, RELEVANT BRITISH STANDARDS AND WHERE APPLICABLE LOCAL AUTHORITIES REQUIREMENTS.

THE PURPOSE OF THIS DRAWING IS FOR TYPICAL CONSTRUCTION DETAILS ONLY. MANHOLES / PIPE DIAMETERS / SUMP DEPTHS ETC WILL VARY ON PLAN.

REFER TO DRAINAGE LAYOUT DRAWING FOR ALL PIPE SIZES, MANHOLE SIZES, PIPE LENGTHS, SUMP DEPTHS, STORAGE TANK CONFIGURATIONS, COVER LEVELS AND INVERT LEVELS

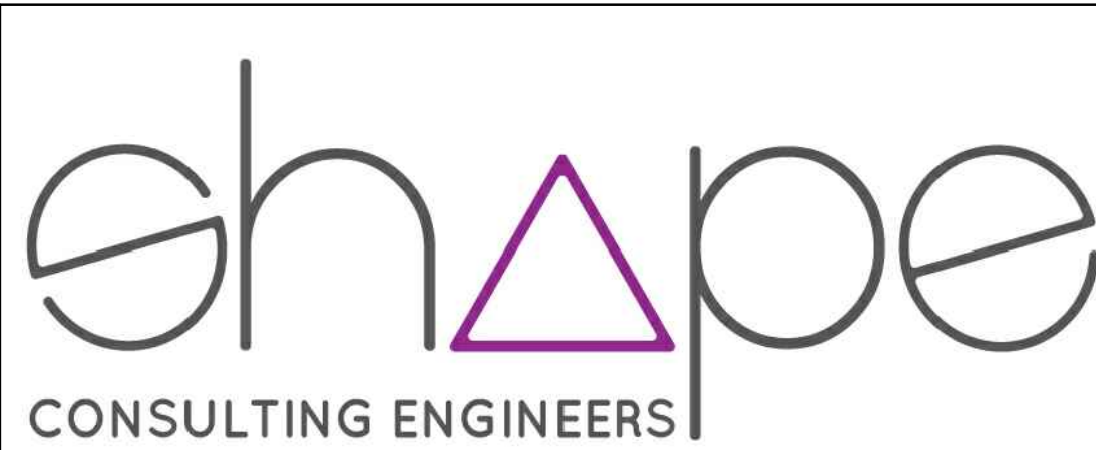

Amber House Green Lane Liverpool L13 7GD
0151 305 0700 www.shapeengineering.co.uk @shapetweets

| | | | | | | | | | | |
|---------|------------------|--------------|----|------------------|-------------|-------------|-----------|----------|------|-----|
| PROJECT | Upper Parliament | Client | | | | Private | | | | |
| | | Status | S1 | Purpose of Issue | | Preliminary | | | | |
| TITLE | Drainage Details | Designed By | | EJC | Approved By | | - | Drawn By | GP | |
| | | Project No. | | | 1168 | | Sheet No. | | 0004 | |
| | | Scale (@ A1) | | As Shown | | DATE | | 12/02/19 | Rev | P01 |