

THIRTEEN FLOOR LAYOUT
(SCALE 1:100)

THE CONTRACTOR IS TO BE FULLY RESPONSIBLE FOR ALL TEMPORARY/PERMANENT PROPPING AND SHORING ON THE PROJECT. CONTRACTOR TO ENSURE THAT ALL PARTS OF THE STRUCTURE ARE ADEQUATELY PROPPED PRIOR TO ANY COMMENCEMENT OF WORKS. ADVICE MAY BE SOUGHT FROM A SPECIALIST OR FROM THE STRUCTURAL ENGINEER.

MF-INDICATES MOMENT FRAME.
BF-INDICATES BRACE FRAME.

ALL DIMENSIONS, LEVELS AND SETTING OUT TO BE CONFIRMED WITH THE ARCHITECT PRIOR TO CONSTRUCTION.

APPROX. NET MASS OF STRUCTURAL STEELWORK IS 400TN.

INDICATES MULTI-DECK COMPOSITE FLOOR

IN ADDITION TO THE NET MASS OF STRUCTURAL STEELWORK SHOWN ON THE CONTRACT DRAWINGS THE CONTRACTOR SHALL INCLUDE FOR THE FOLLOWING ANCILLARY ITEMS:

ELEMENT	MINIMUM ALLOWANCE	AS A % OF THE TOTAL MASS OF STEELWORK SHOWN ON THE CONTRACT DRAWINGS
CONNECTIONS	15%	
SECONDARY STEELWORK	15%	

THE STEEL FABRICATOR IS TO ALLOW FOR USING BOTH THE STRUCTURAL ENGINEERS & ARCHITECTS DRAWINGS WHEN PREPARING FABRICATION DRAWINGS

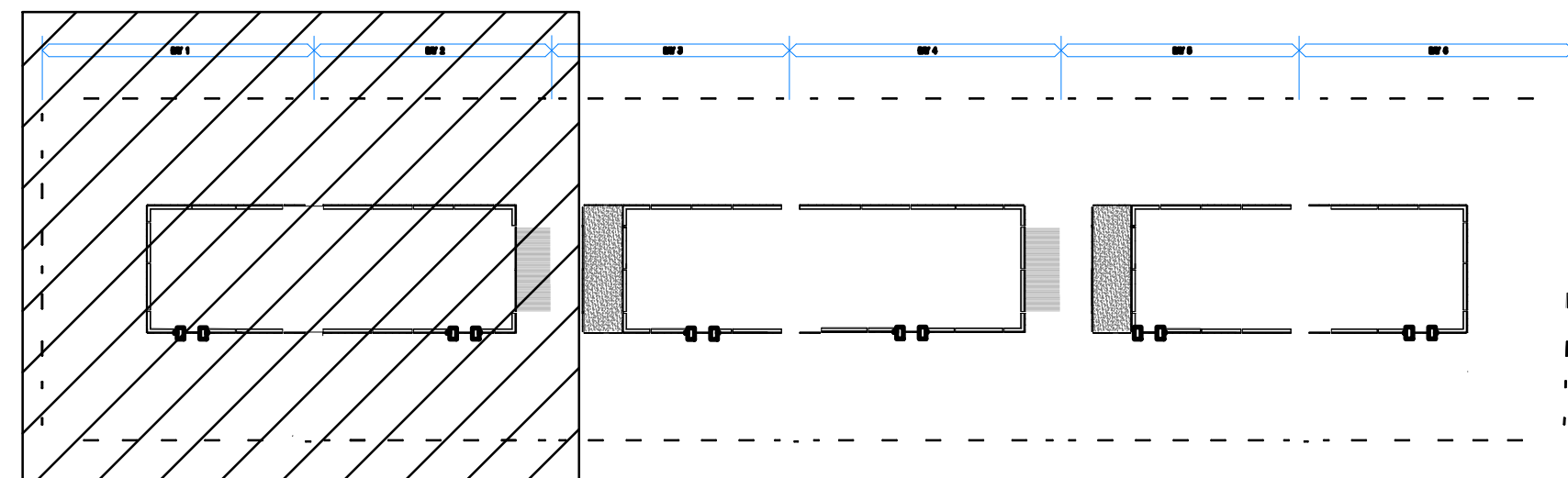

KEY PLAN
(SCALE 1:1000)

GENERAL NOTES

DO NOT SCALE OFF THIS DRAWING

THIS DRAWING TO READ IN CONJUNCTION WITH ALL RELEVANT STRUCTURAL AND ARCHITECTURAL DRAWINGS AND SPECIFICATIONS.

ALL DIMENSIONS TO BE CHECKED ON SITE BY THE CONTRACTOR / FABRICATOR PRIOR TO COMMENCEMENT OF WORKS.

ALL DIMENSIONS ARE IN MILLIMETRES UNLESS STATED OTHERWISE.

ALL WORKS TO BE CARRIED OUT IN STRICT ACCORDANCE WITH THE ENGINEER'S SPECIFICATIONS, RELEVANT BRITISH STANDARDS, STATUTORY HEALTH AND SAFETY/C.D.M. REGULATIONS, RELEVANT CODES OF PRACTICE AND THE CURRENT EDITION OF THE BUILDING REGULATIONS.

FOR FINAL SETTING OUT INFORMATION RELATING TO GRID LINES AND WALL POSITIONS REFER TO THE ARCHITECT'S DRAWINGS.

P1	26.06.15	SK	PRELIMINARY ISSUE	JK
Rev	Date	Checked	Description	By

NOT WORKING DRAWING



Client: STANLEY DOCK PROPERTIES

Project: TOBACCO WAREHOUSE
STANLEY DOCK
LIVERPOOL

Drawing title: PROPOSED THIRTEENTH
FLOOR-BAY 1-2

Scale at A0	1:100	Drawing number	27586-300
Drawn by	J.A.SUAREZ	Revision suffix	P1
Date	JUN. 14		

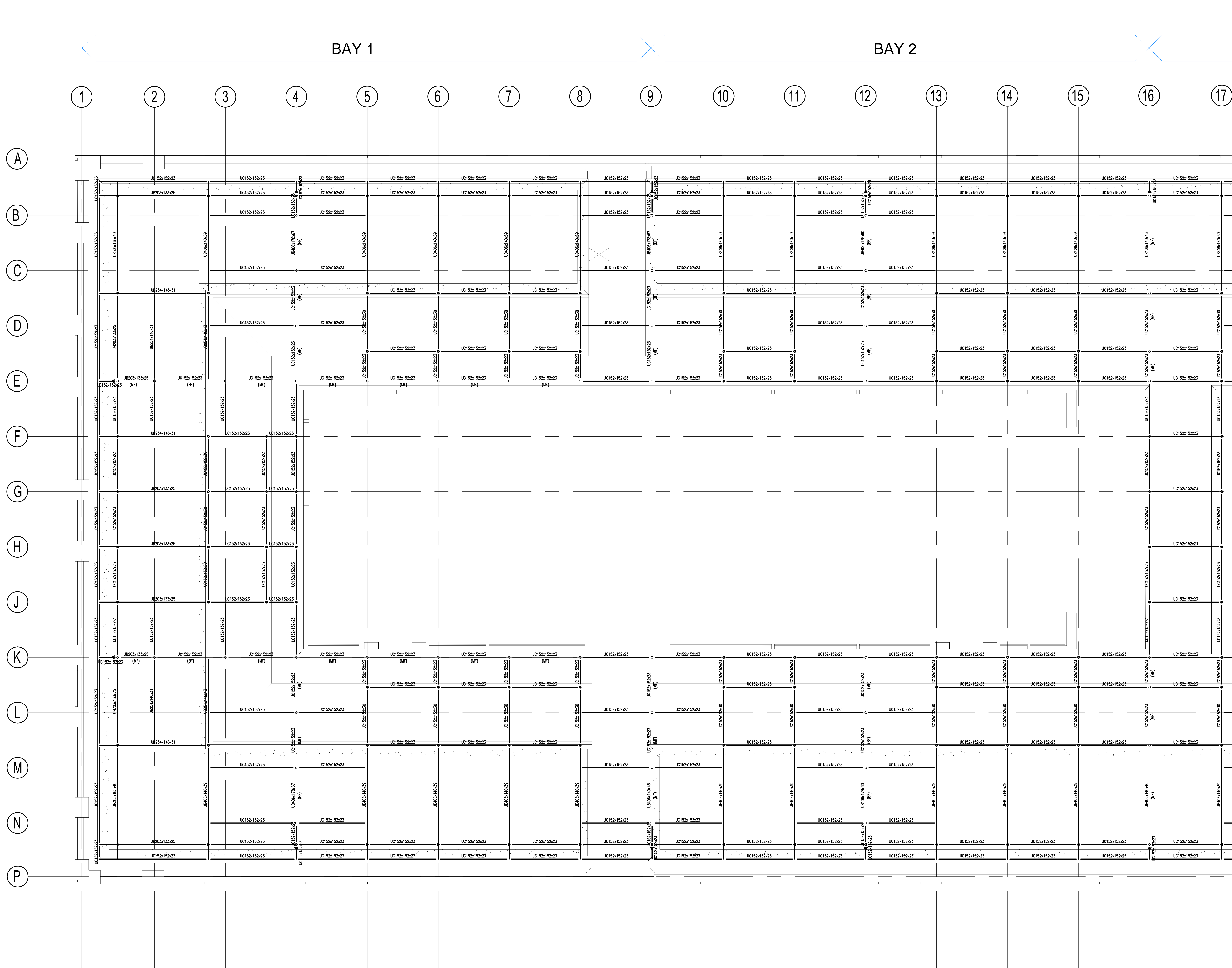

ROOF LAYOUT
(SCALE 1:100)

THE CONTRACTOR IS TO BE FULLY RESPONSIBLE FOR ALL TEMPORARY/PERMANENT PROPPING AND SHORING ON THE PROJECT. CONTRACTOR TO ENSURE THAT ALL PARTS OF THE STRUCTURE ARE ADEQUATELY PROPPED PRIOR TO ANY COMMENCEMENT OF WORKS. ADVICE MAY BE SOUGHT FROM A SPECIALIST OR FROM THE STRUCTURAL ENGINEER.

MF-INDICATES MOMENT FRAME.
BF-INDICATES BRACE FRAME.

ALL DIMENSIONS, LEVELS AND SETTING OUT TO BE CONFIRMED WITH THE ARCHITECT PRIOR TO CONSTRUCTION.

APPROX. NET MASS OF STRUCTURAL STEELWORK IS 400T.

INDICATES MULTIDECK COMPOSITE FLOOR

IN ADDITION TO THE NET MASS OF STRUCTURAL STEELWORK SHOWN ON THE CONTRACT DRAWINGS THE CONTRACTOR SHALL INCLUDE FOR THE FOLLOWING ANCILLARY ITEMS:

ELEMENT	MINIMUM ALLOWANCE	AS A % OF THE TOTAL MASS OF STEELWORK SHOWN ON THE CONTRACT DRAWINGS
CONNECTIONS	15%	
SECONDARY STEELWORK	15%	

THE STEEL FABRICATOR IS TO ALLOW FOR USING BOTH THE STRUCTURAL ENGINEERS & ARCHITECTS DRAWINGS WHEN PREPARING FABRICATION DRAWINGS

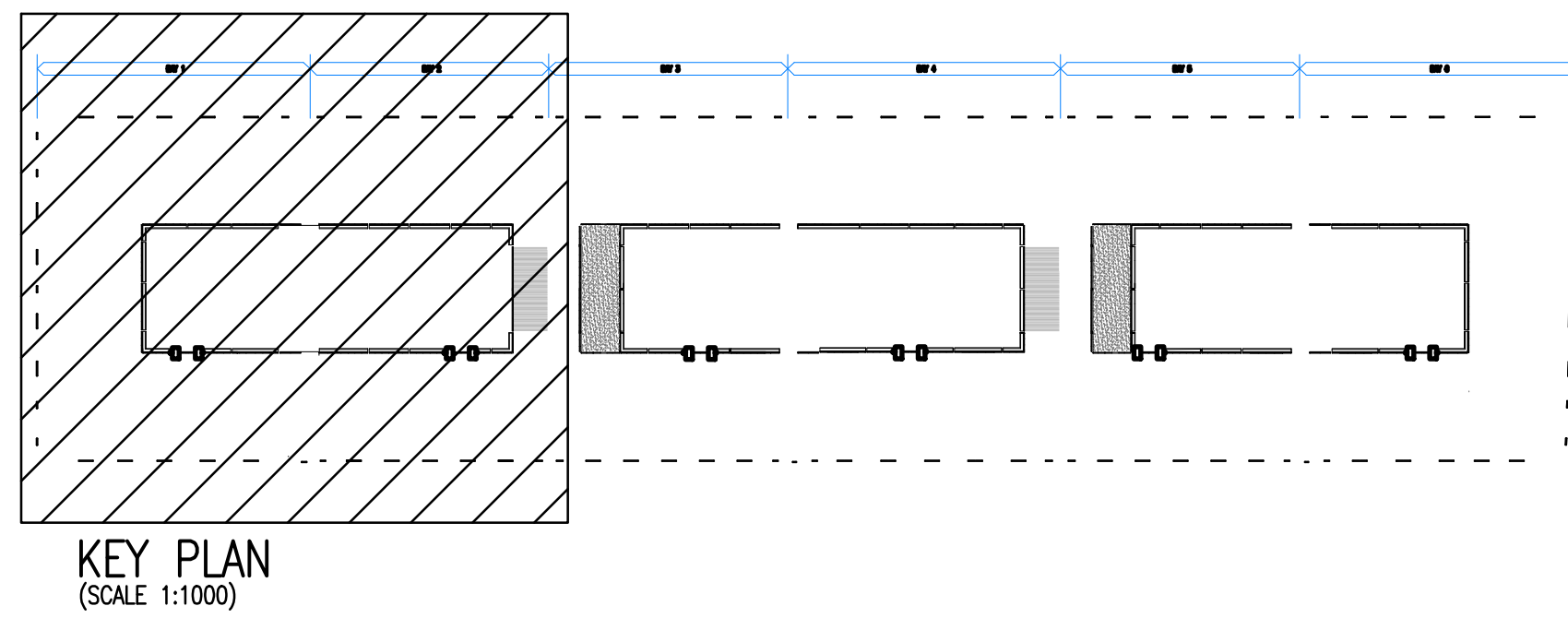

GENERAL NOTES

DO NOT SCALE OFF THIS DRAWING

THIS DRAWING TO READ IN CONJUNCTION WITH ALL RELEVANT STRUCTURAL AND ARCHITECTURAL DRAWINGS AND SPECIFICATIONS.

ALL DIMENSIONS TO BE CHECKED ON SITE BY THE CONTRACTOR / FABRICATOR PRIOR TO COMMENCEMENT OF WORKS.

ALL DIMENSIONS ARE IN MILLIMETRES UNLESS STATED OTHERWISE.

ALL WORKS TO BE CARRIED OUT IN STRICT ACCORDANCE WITH THE ENGINEER'S SPECIFICATIONS, RELEVANT BRITISH STANDARDS, STATUTORY HEALTH AND SAFETY/C.D.M. REGULATIONS, RELEVANT CODES OF PRACTICE AND THE CURRENT EDITION OF THE BUILDING REGULATIONS.

FOR FINAL SETTING OUT INFORMATION RELATING TO GRID LINES AND WALL POSITIONS REFER TO THE ARCHITECT'S DRAWINGS.

P1	26.06.15	SK	PRELIMINARY ISSUE	JK
Rev	Date	Checked	Description	By

NOT WORKING DRAWING



Client
STANLEY DOCK PROPERTIES

Project
**TOBACCO WAREHOUSE
STANLEY DOCK
LIVERPOOL**

Drawing title
**PROPOSED ROOF FLOOR
BAY 1-2**

Scale at A0	1:100	Drawing number	27586-303
Drawn by	J.A.SUAREZ	Revision suffix	P1
Date	JUN. 14		

LEGEND

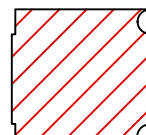

NON CAR PARKING AREA

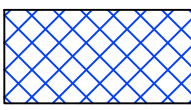

MAIN RUNNING LANE.
VARIES IN WIDTH FROM 2.4-2.7m WIDE.
ONE-WAY SYSTEM TO BE USED.
WHITE LINING TO DICTATE VEHICLE
MOVEMENT.



189No. VEHICLE CAR PARKING
SPACES BASED ON STANDARD SALON
VEHICLE (FORD MONDEO)



EXISTING COLUMN TO BE REMOVED TO
ALLOW VEHICLE MOVEMENT.
(LOCATION OF COLUMN REMOVAL
SUBJECT TO DETAILED STRUCTURAL
ANALYSIS OF THE EXISTING STRUCTURE.)

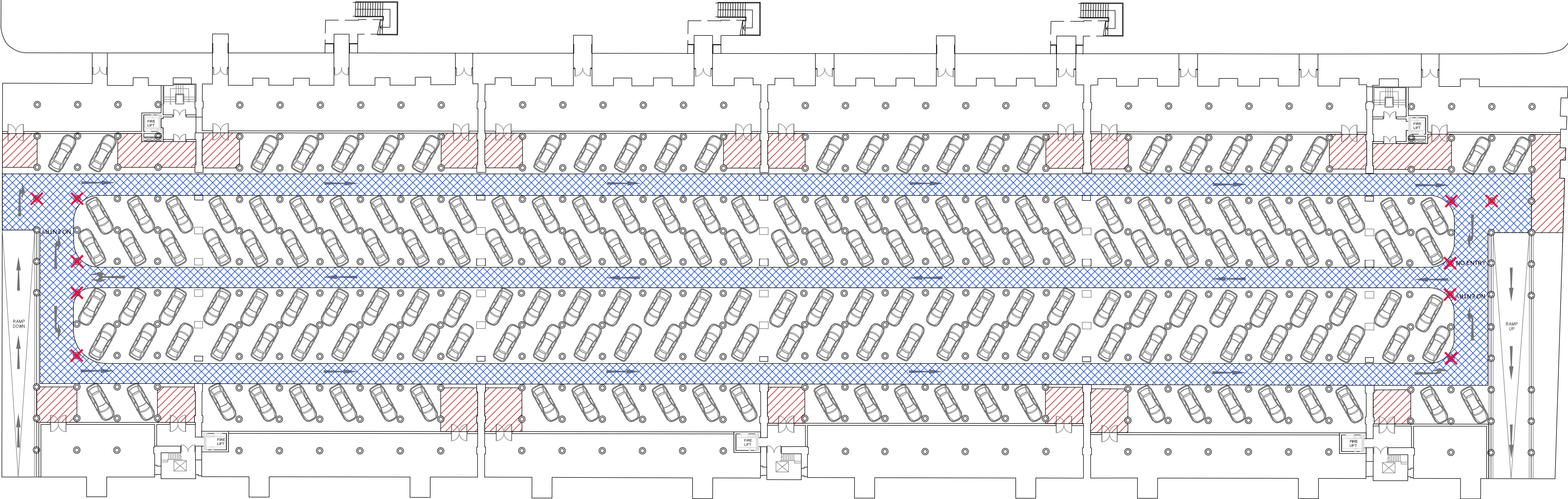

P1	28.05.2015	MP	ISSUED FOR COMMENTS.		MDP
Rev	Date	Checked	Description		By

PRELIMINARY



Sutcliffe
Sutcliffe

18-20 Harrington Street, Liverpool L2 9QA
t: 0151 227 3155 f: 0151 227 3156
e: sutcliffe@sutcliffe.co.uk w: www.sutcliffe.co.uk



Client		HARCOURT CONSTRUCTION	
Project		TOBACCO WAREHOUSE LIVERPOOL	
Drawing title		BASEMENT CAR PARKING STRATEGY OPTION 1	
Scale at A1	1:250	Drawing number	27586/CP/OP1/001
Drawn by	MDP		
Date	28.05.2015	Revision suffix	P1

LEGEND

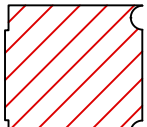

NON CAR PARKING AREA

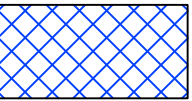

MAIN RUNNING LANE.
VARIES IN WIDTH FROM 2.4-2.7m WIDE.
ONE-WAY SYSTEM TO BE USED.
WHITE LINING TO DICTATE VEHICLE
MOVEMENT.

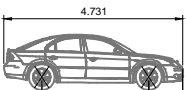
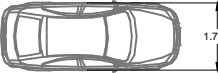

EXISTING COLUMN TO BE REMOVED TO
ALLOW VEHICLE MOVEMENT.
(LOCATION OF COLUMN REMOVAL
SUBJECT TO DETAILED STRUCTURAL
ANALYSIS OF THE EXISTING STRUCTURE.)

	Ford Mondeo	4.731m
	Overall Length	1.776m
	Overall Width	1.491m
	Overall Body Height	0.252m
	Min Body Ground Clearance	1.725m
	Track Width	4.00s
	Lock to Lock Time	5.780m
	Kerb to Kerb Turning Radius	

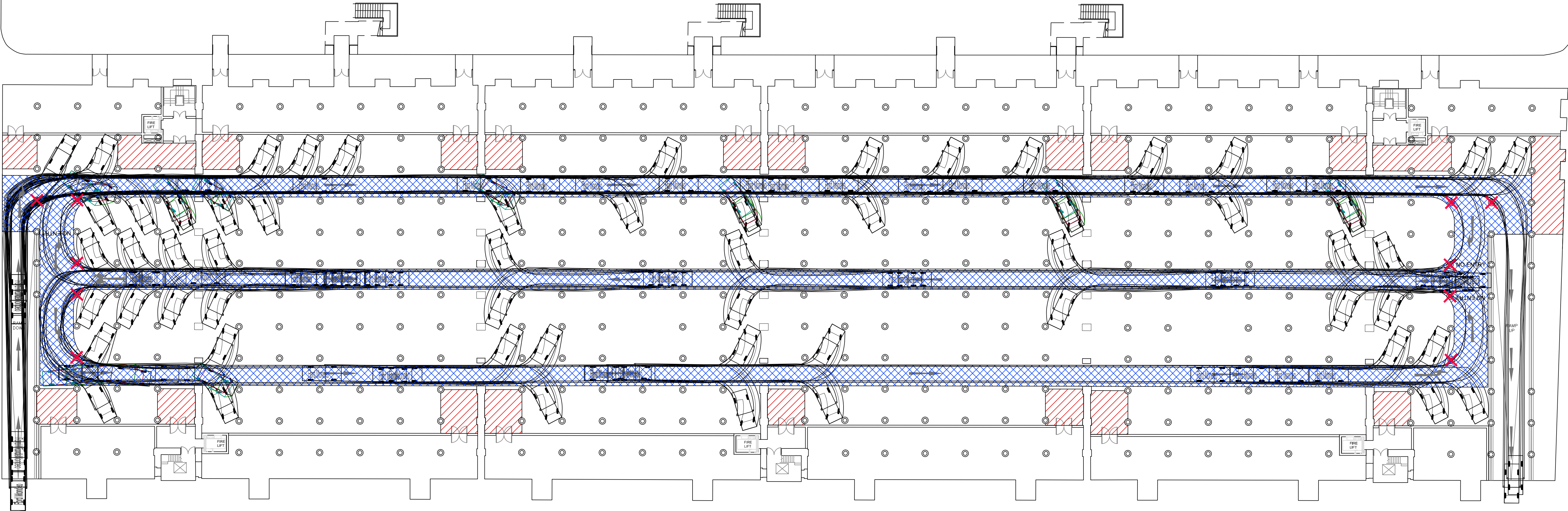

P1	28.05.2015	MP	ISSUED FOR COMMENTS.	MDP
Rev	Date	Checked	Description	By

PRELIMINARY



Sutcliffe

18-20 Harrington Street, Liverpool L2 9QA
t: 0151 227 3155 F: 0151 227 3156
e: sutcliffe@sutcliffe.co.uk w: www.sutcliffe.co.uk



Client
HARCOURT CONSTRUCTION

Project
TOBACCO WAREHOUSE
LIVERPOOL

Drawing title
BASEMENT CAR PARKING
STRATEGY
OPTION 1 - VEHICLE TRACKING

Scale at A1	1:250	Drawing number	27586/CP/OP1/002
Drawn by	MDP	Revision suffix	P1
Date	28.05.2015		

Appendix D – Archive Drawings

Prepared by: L. Westhoff
Instructed by: Abercorn Construction

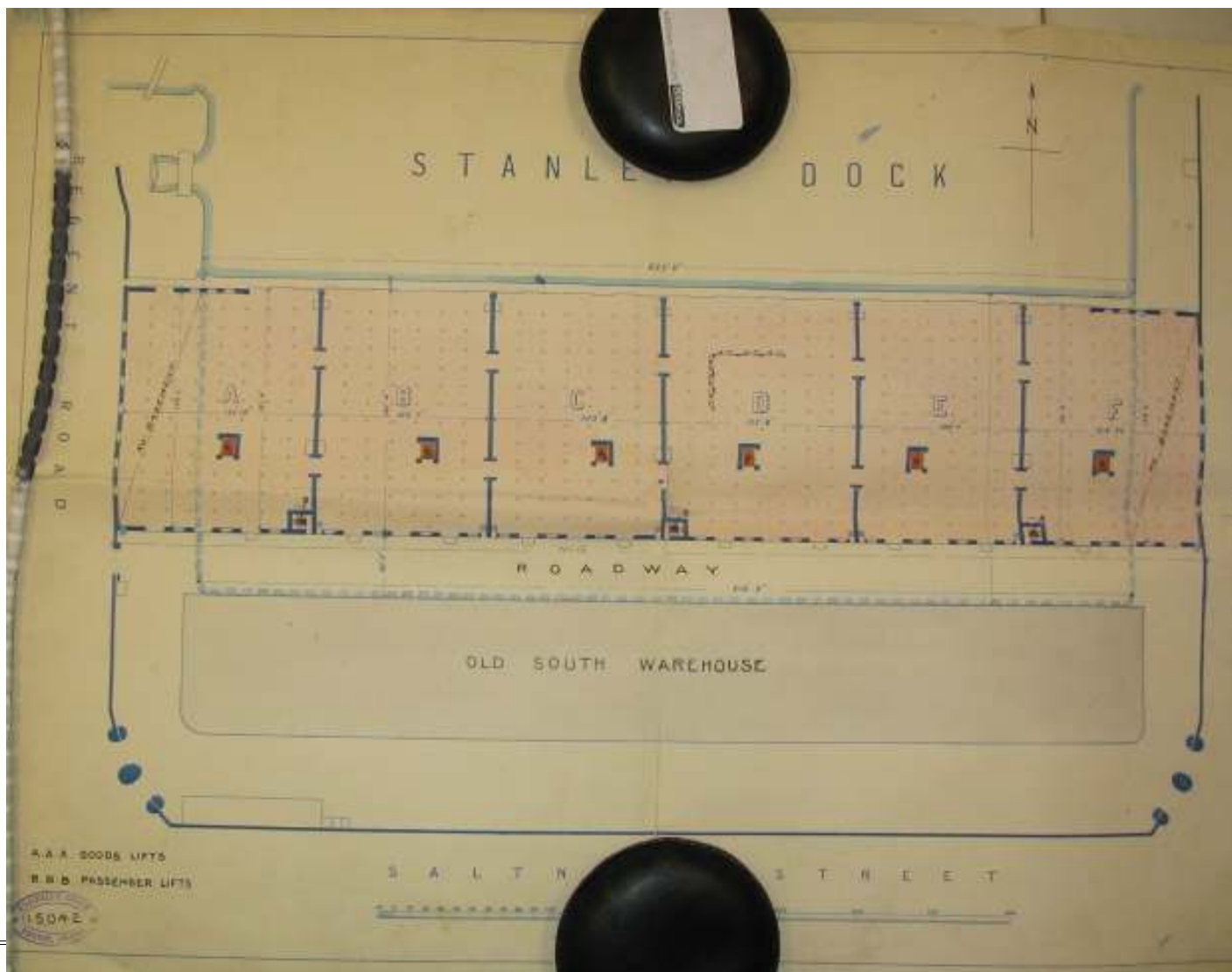

Date: 29th May 2015
Page number: 54

Prepared by: L. Westhoff
Instructed by: Abercorn Construction

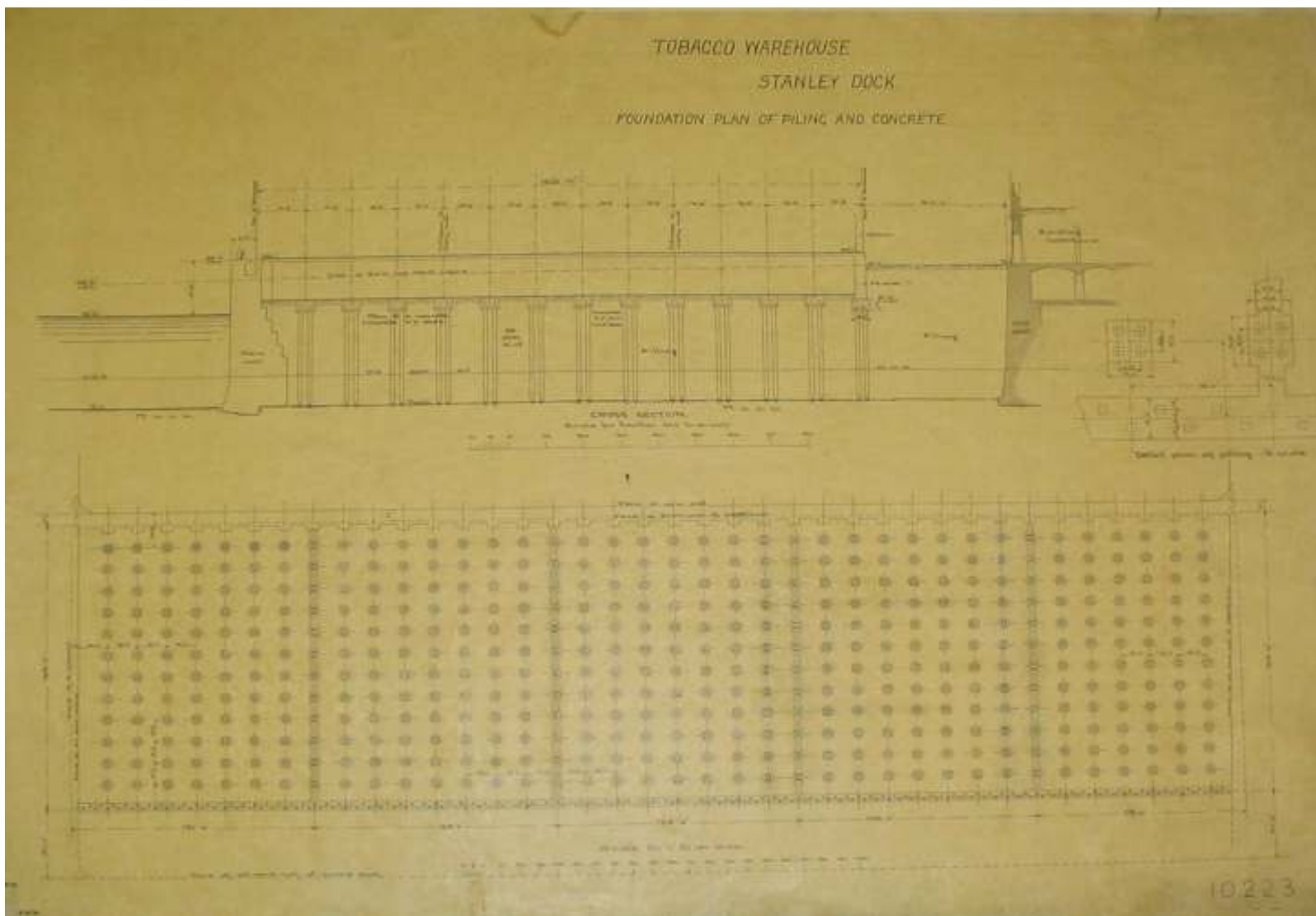

Date: 29th May 2015
Page number: 55

Prepared by: L. Westhoff
Instructed by: Abercorn Construction

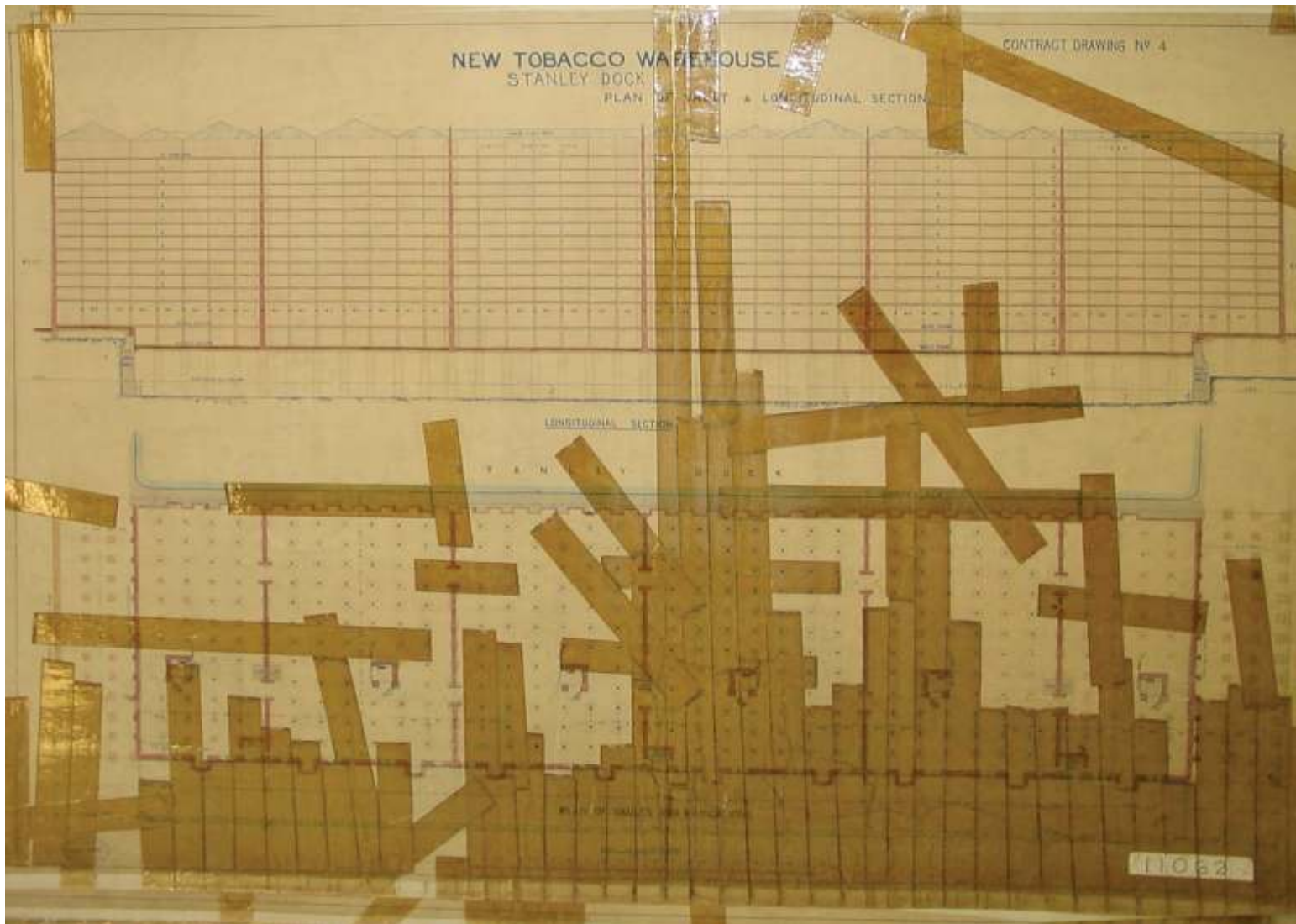

Date: 29th May 2015
Page number: 56

Prepared by: L. Westhoff
Instructed by: Abercorn Construction

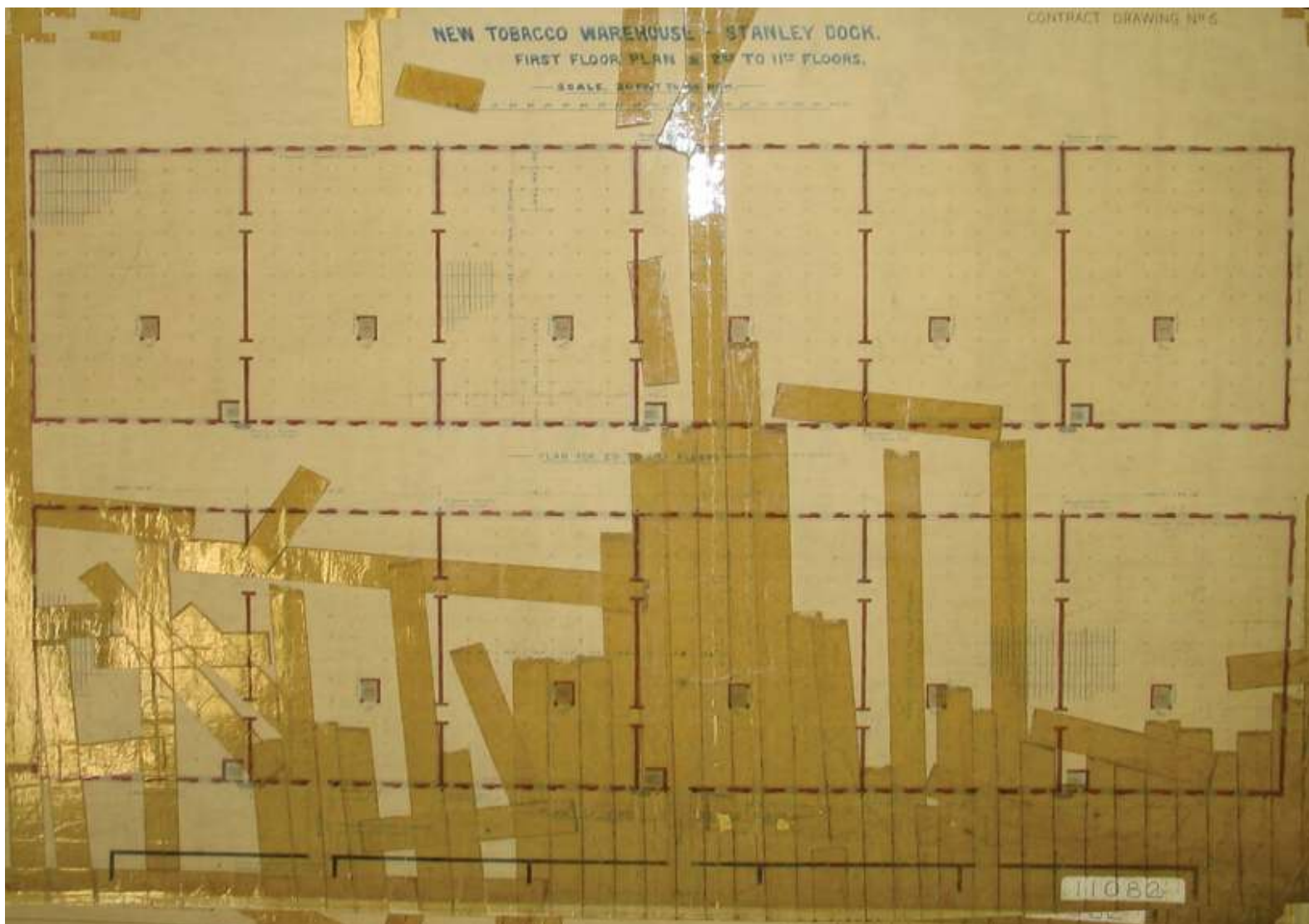

Date: 29th May 2015
Page number: 57

Prepared by: L. Westhoff
Instructed by: Abercorn Construction

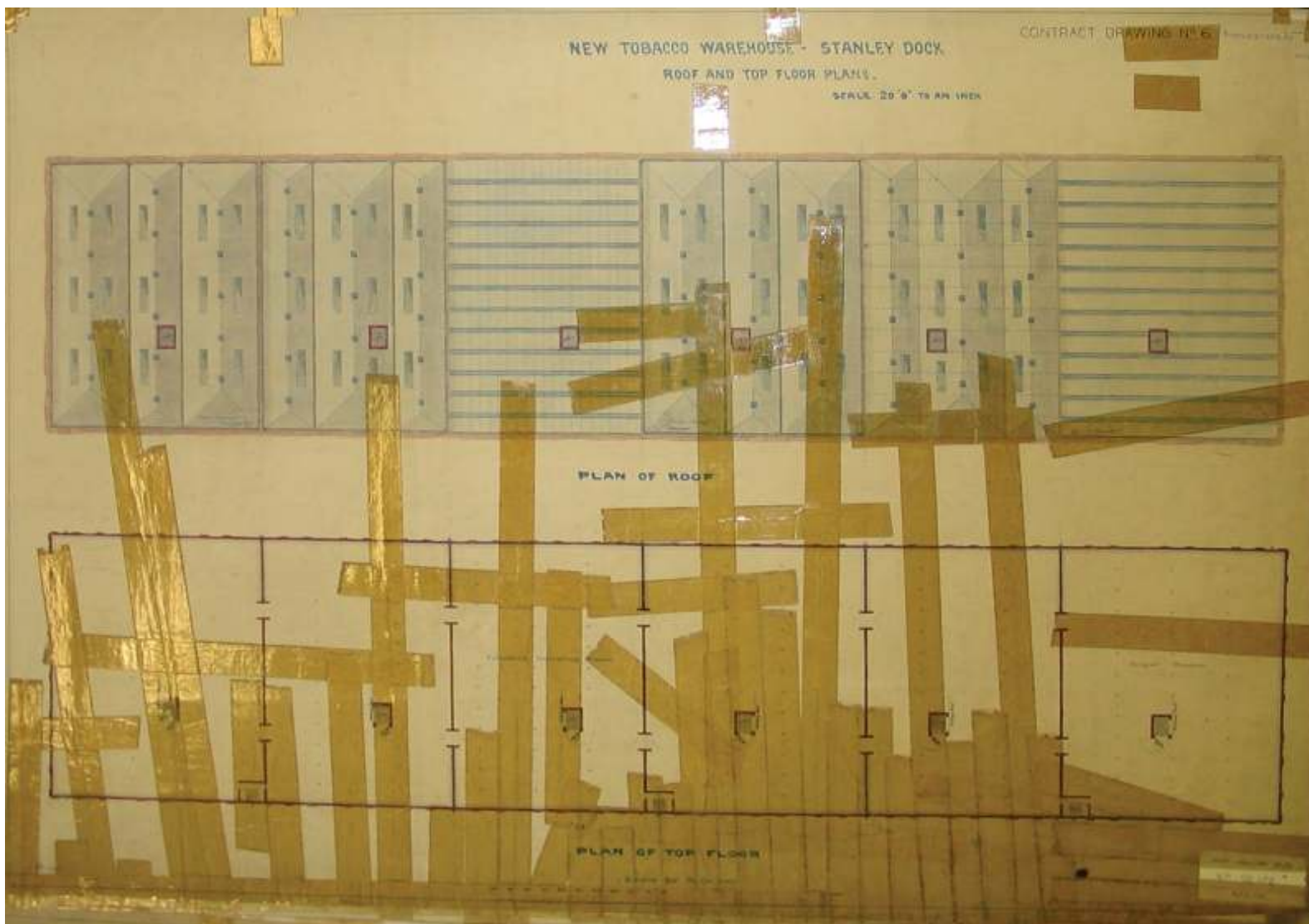

Date: 29th May 2015
Page number: 58

Prepared by: L. Westhoff
Instructed by: Abercorn Construction

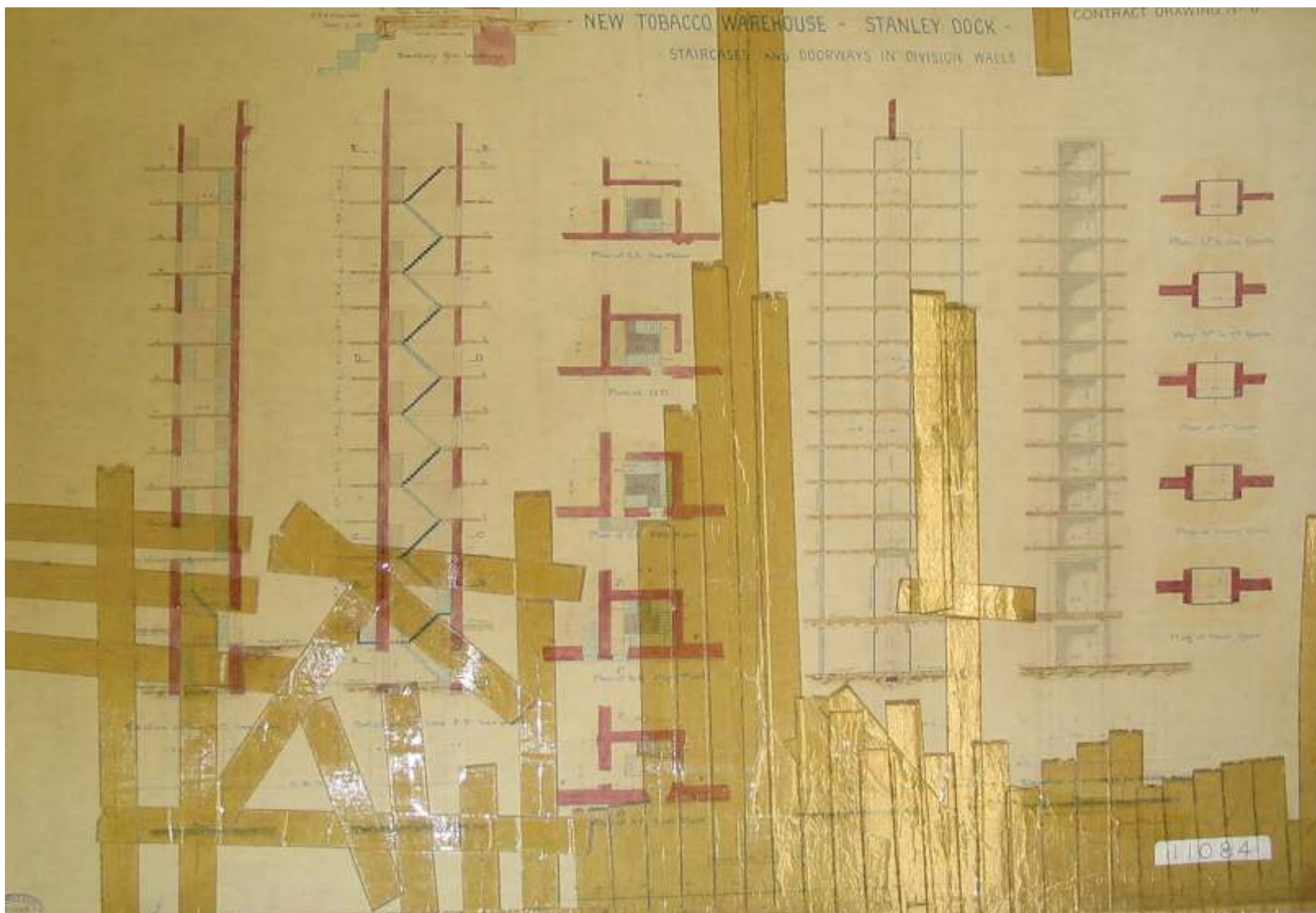

Date: 29th May 2015
Page number: 59



Prepared by: L. Westhoff
Instructed by: Abercorn Construction

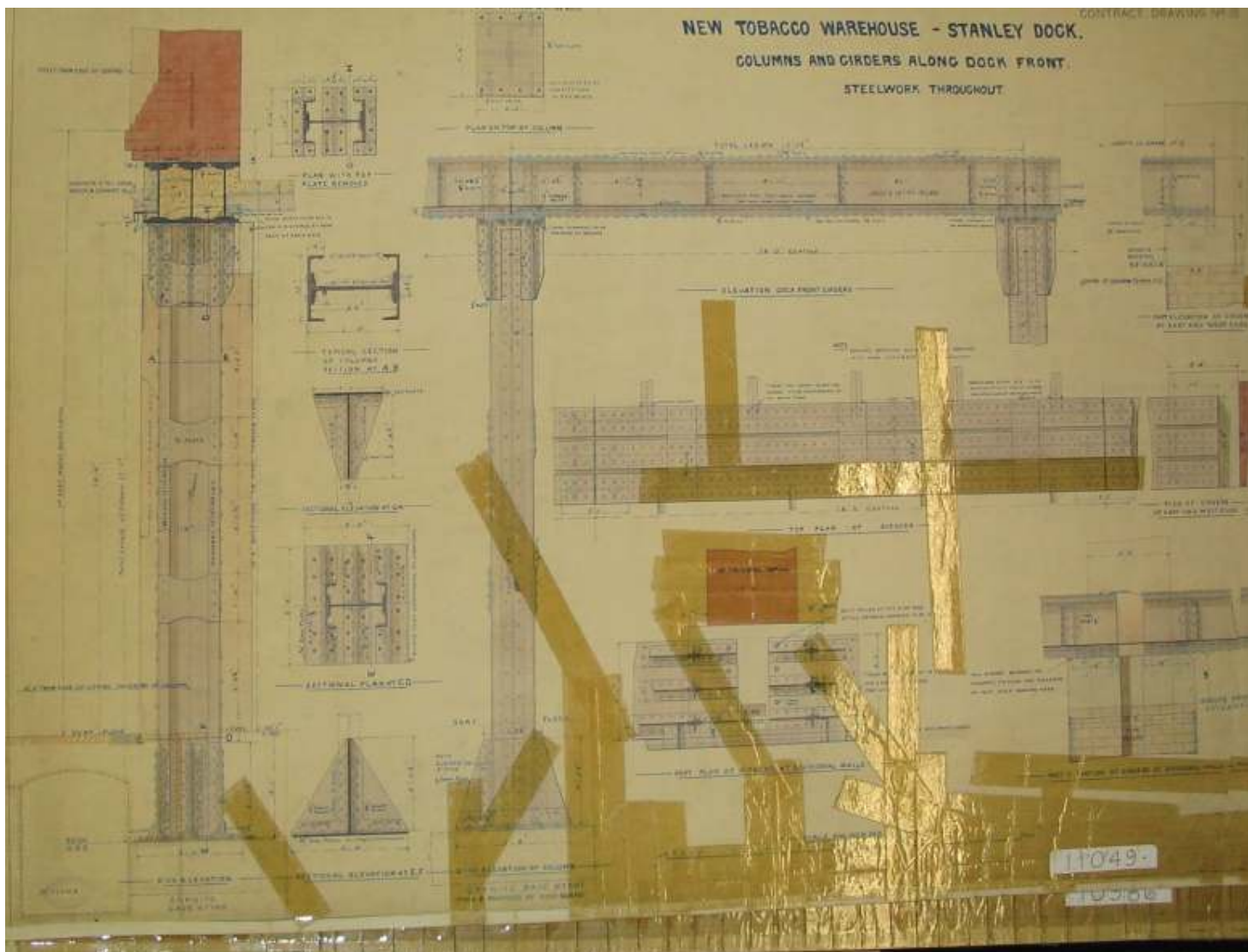

Date: 29th May 2015
Page number: 61

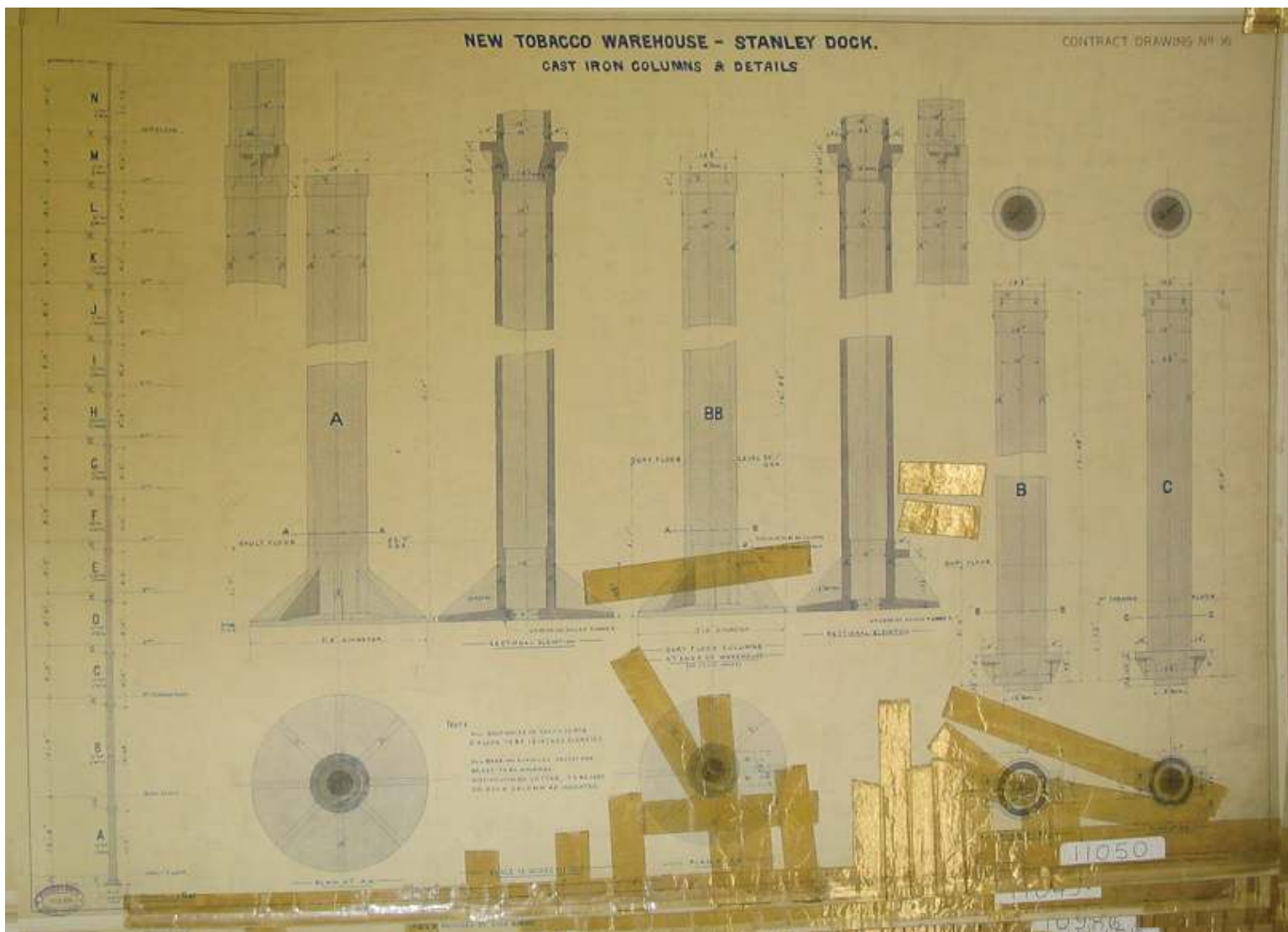

Prepared by: L. Westhoff
Instructed by: Abercorn Construction

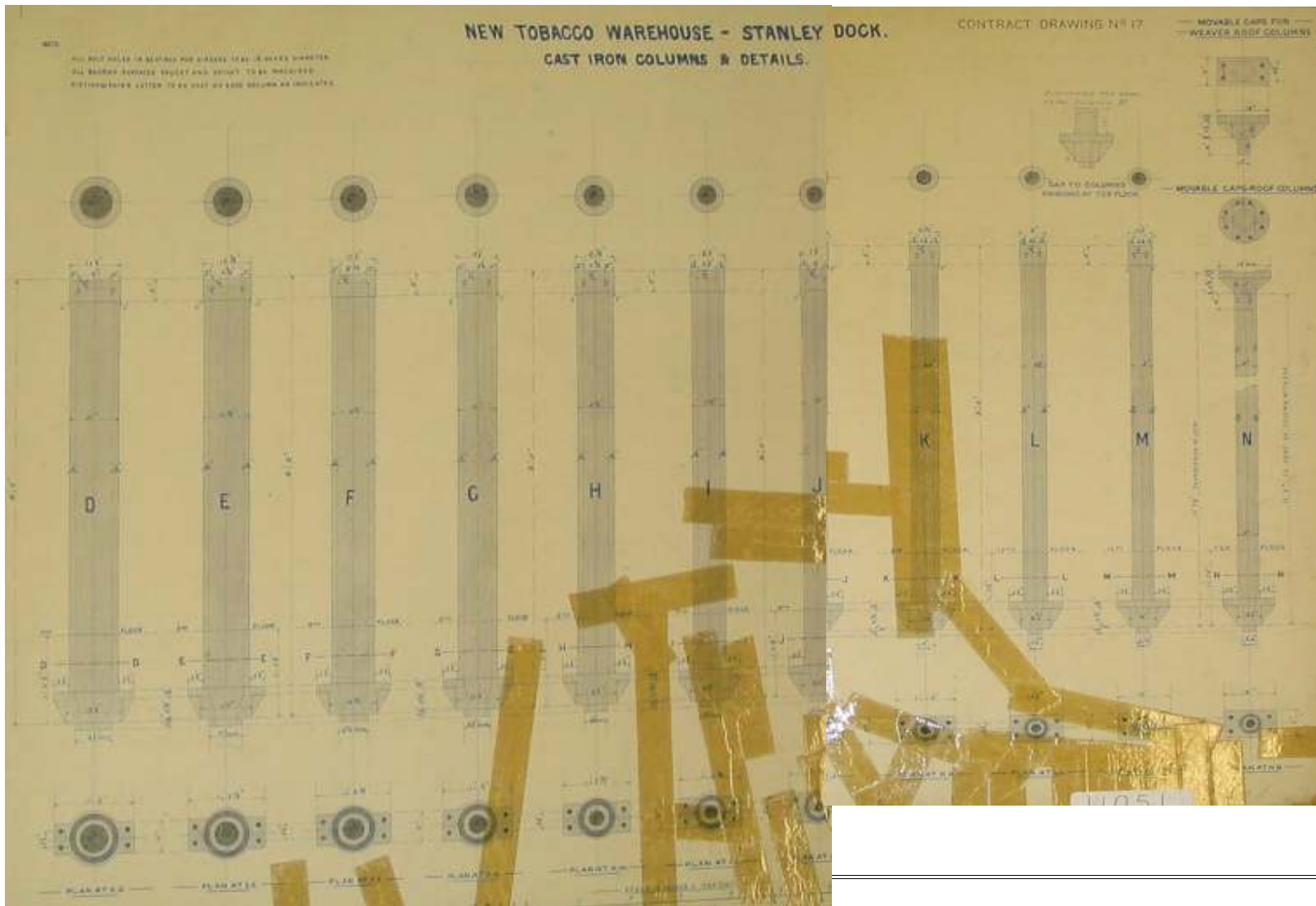

Date: 29th May 2015
Page number: 63

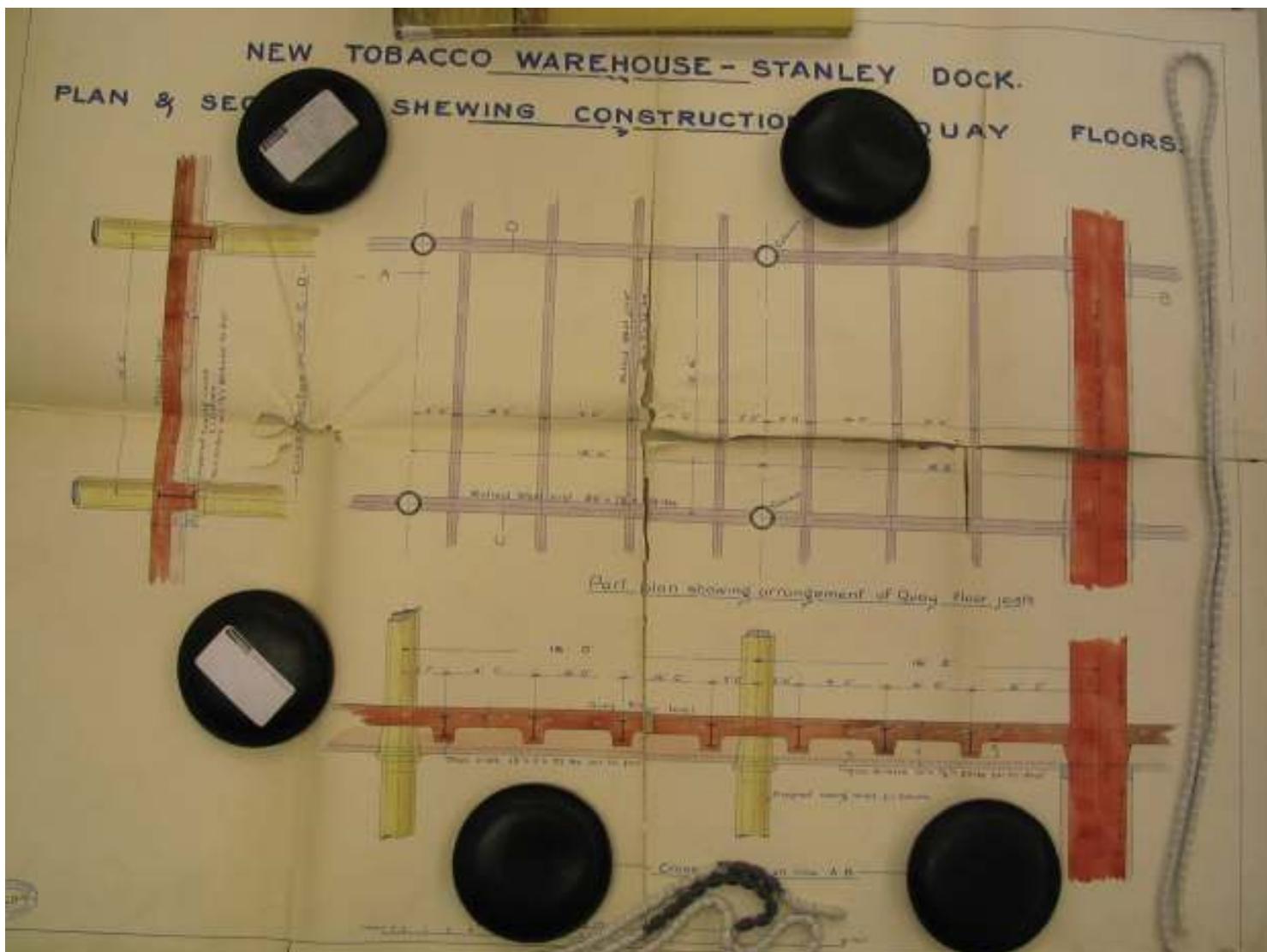

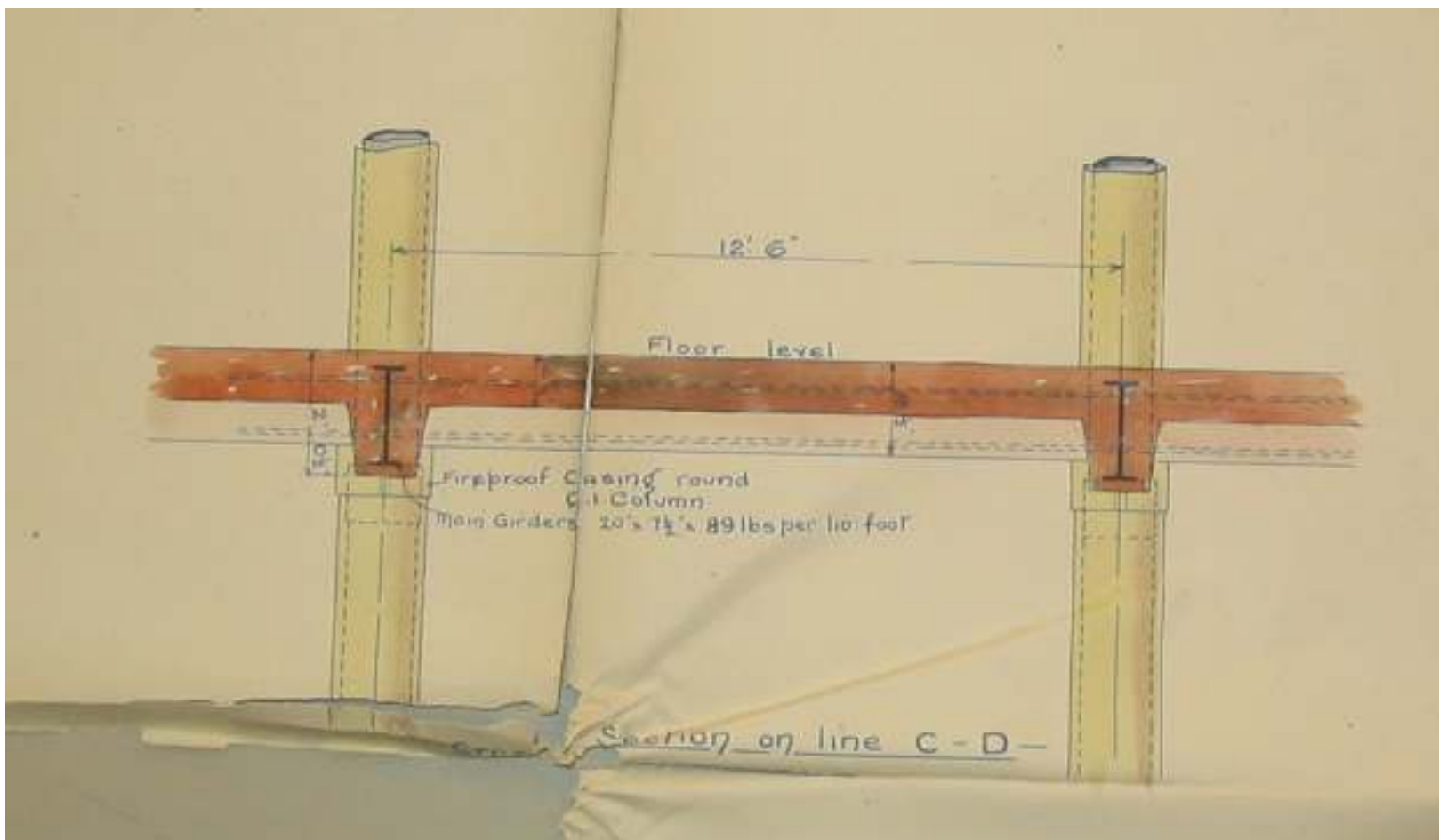

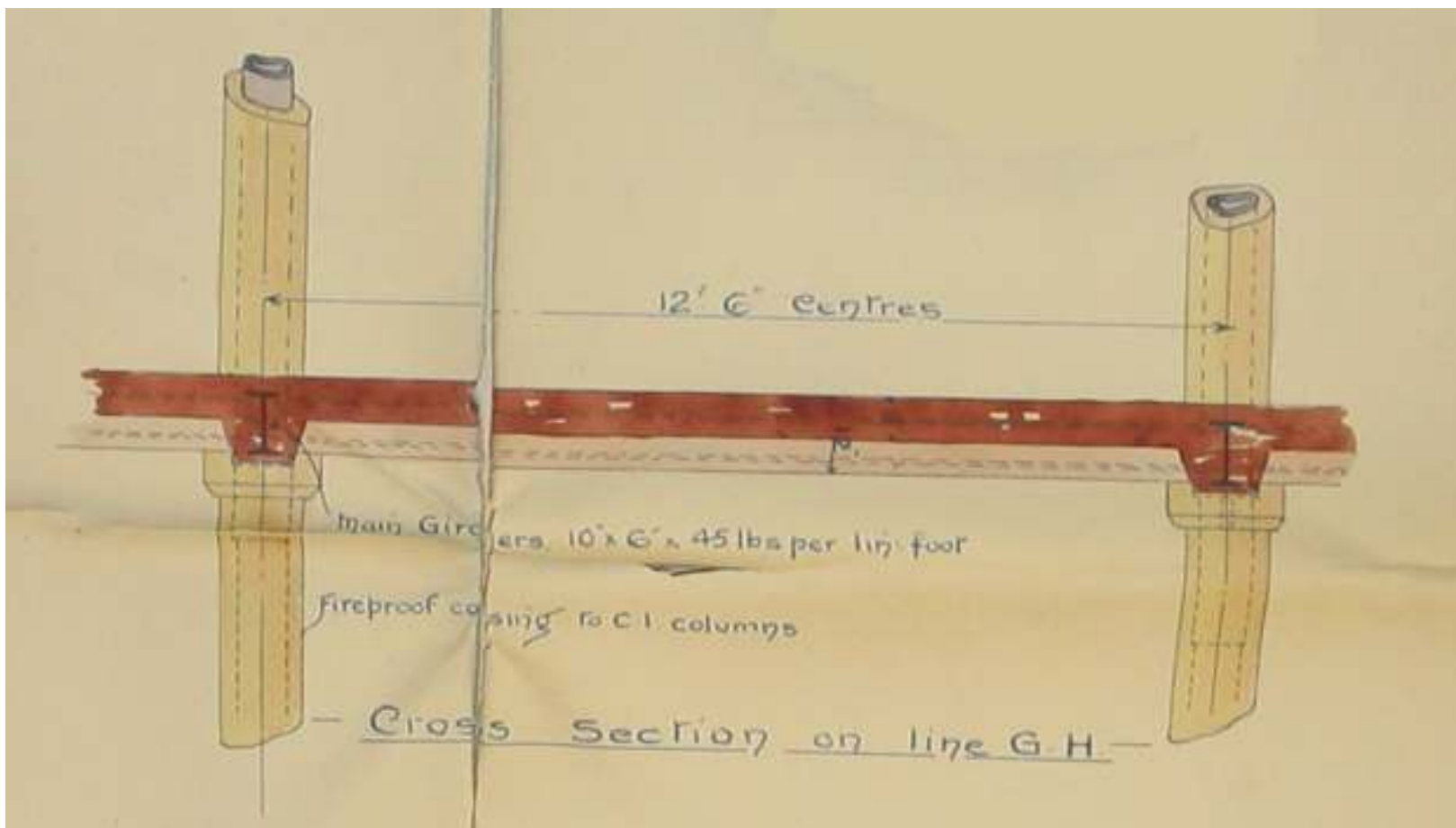

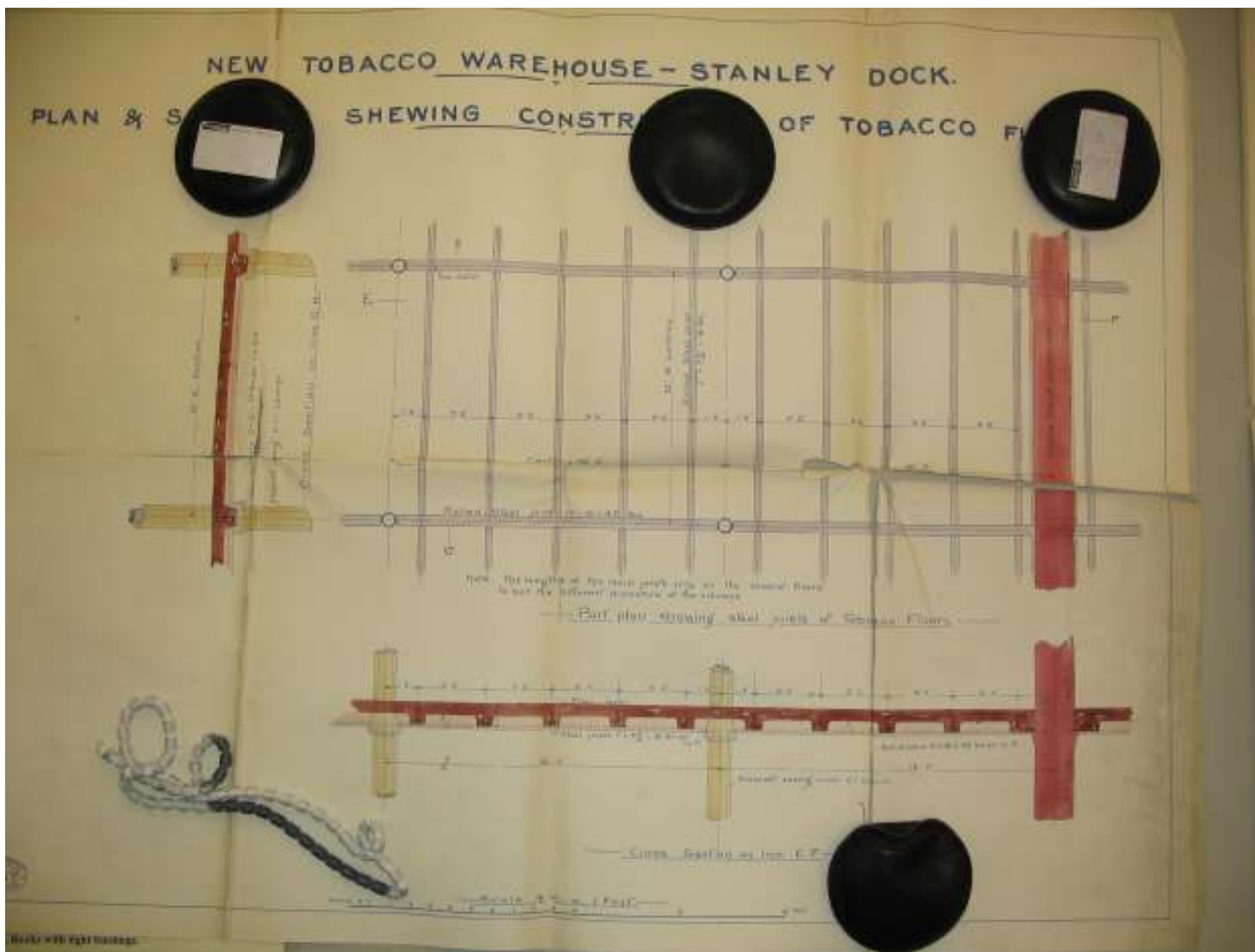

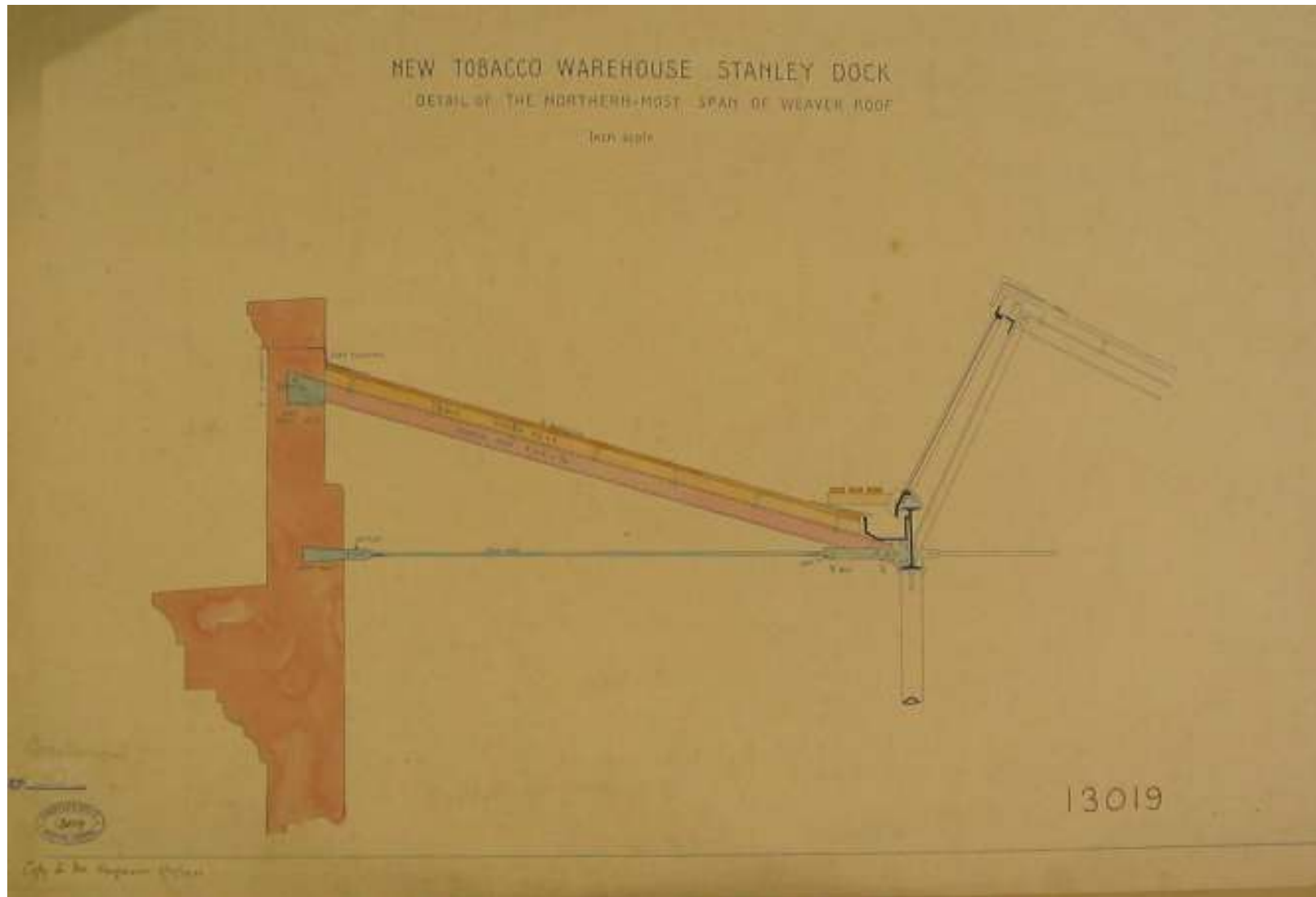

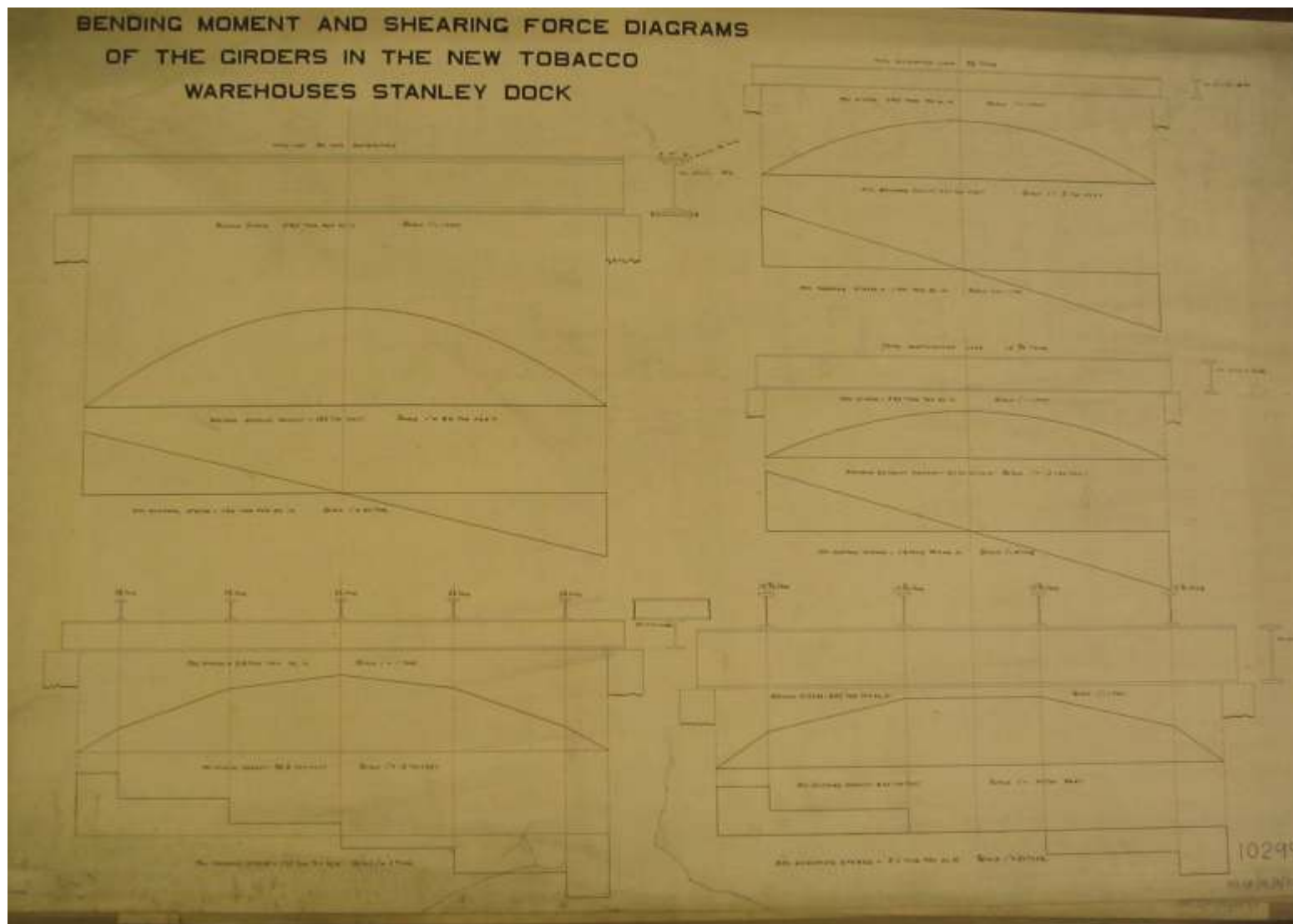

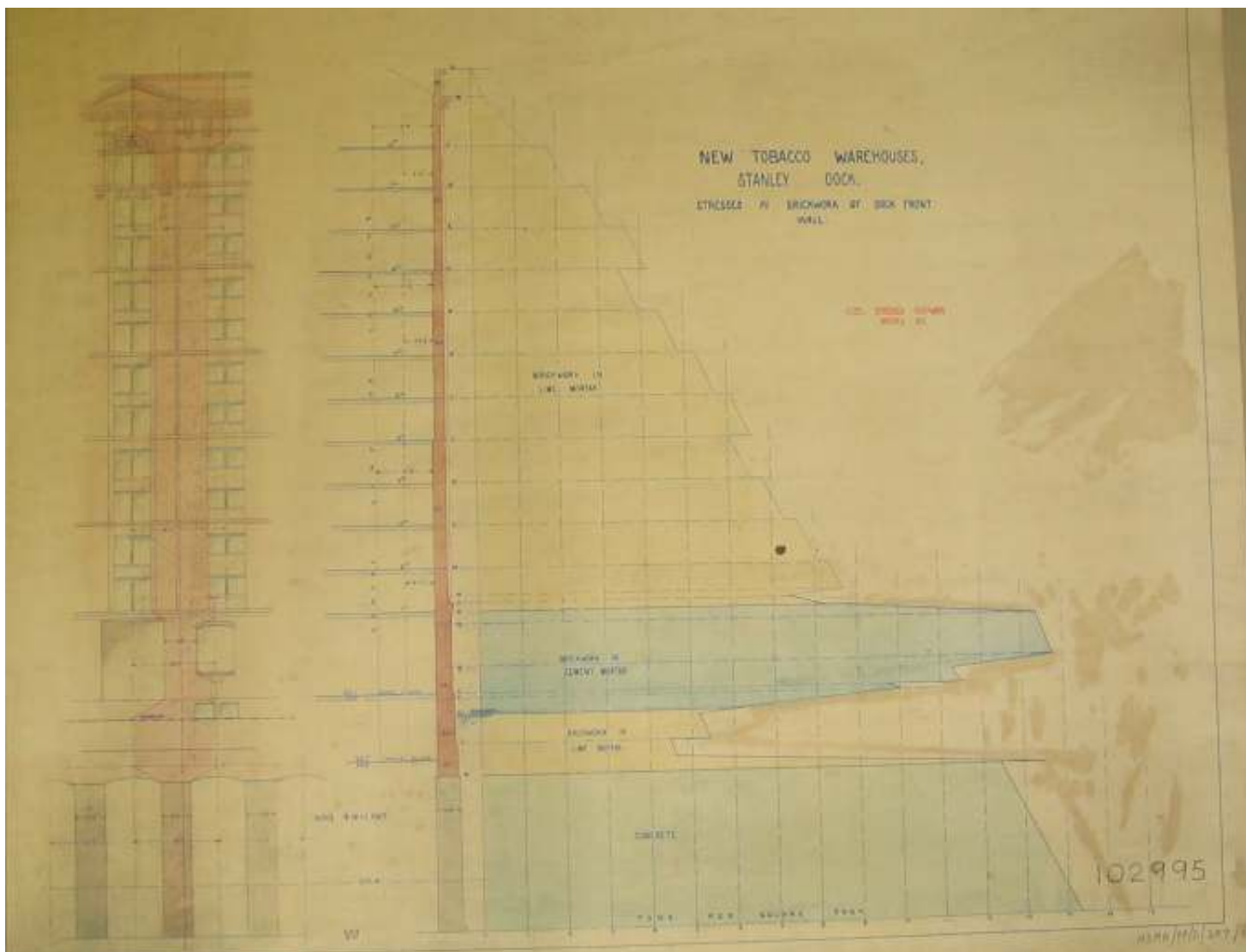

Prepared by: L. Westhoff
Instructed by: Abercorn Construction

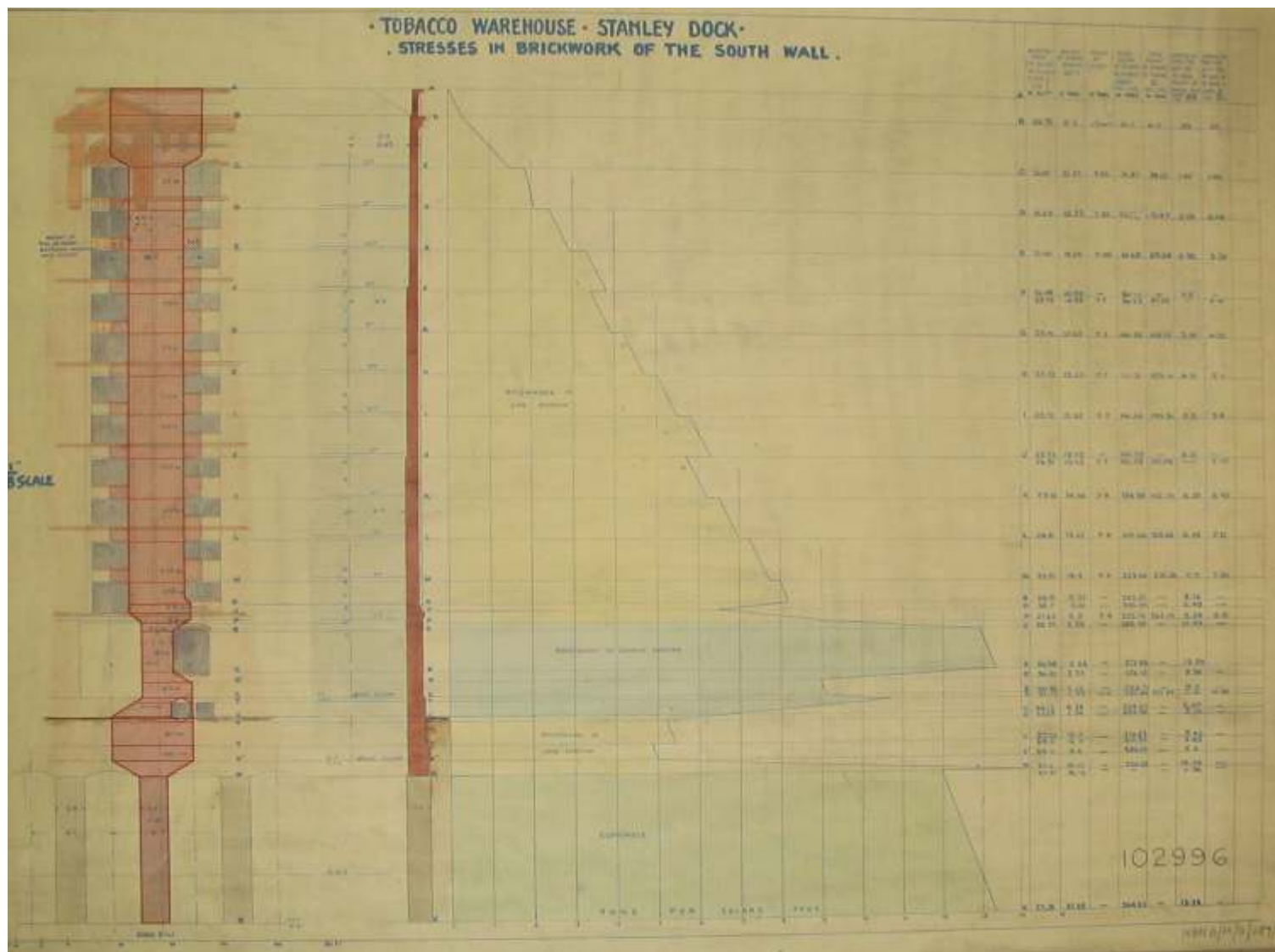

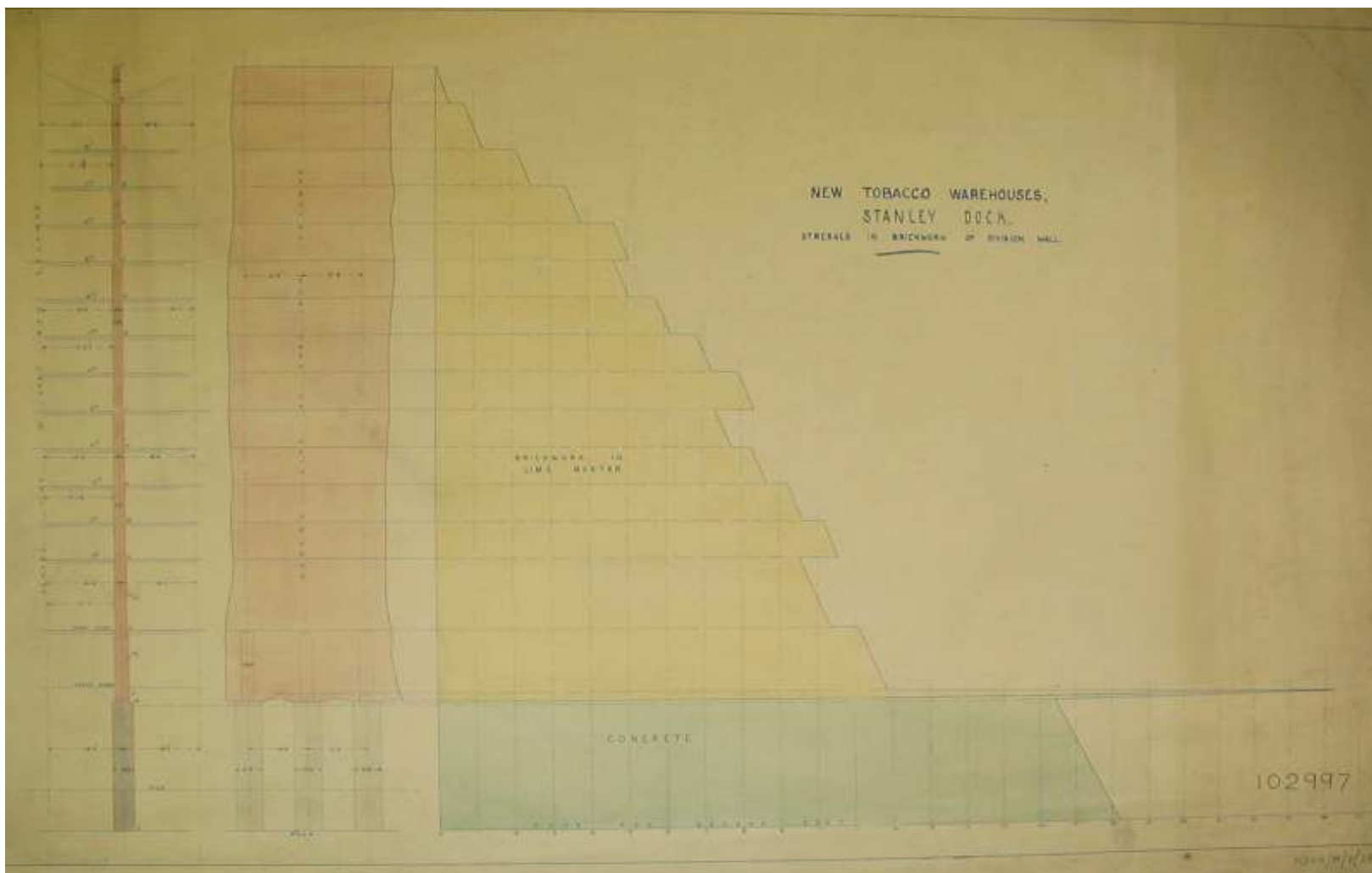

Appendix E - Photographs



Photo 1: Dockside Elevation of Warehouse



Photo 2: Elevation of Warehouse



Photo 3: Typical floor structure showing down stand filler joists and



Photo 4: View through hole formed through typical floor structure



Photo 5: Existing lift shaft to be removed



Photo 6: Angle Iron Roof Trusses



Photo 7: Water on slab on existing level 12



Photo 8: Deterioration around roof column and beams



Photo 9: Masonry cross walls



Photo 10: North Light Roof Trusses



Photo 11: Column Grid