

THE DETAILS PROVIDED ON THIS DRAWING ARE SUBJECT TO COMMENT BY ALL THE RELEVANT APPROVING AUTHORITIES ALL THE INFORMATION PROVIDED AND ASSOCIATED COSTINGS, ARE USED AT THE CLIENTS OWN RISK AND NO LIABILITY WILL BE ACCEPTED BY IMHOTEP DESIGN LTD. THIS DRAWING MUST THEREFORE BE USED FOR THE PURPOSE OF PLANNING APPROVAL ONLY AND REFERENCE MUST BE MADE TO ALL OTHER ACCOMPANYING MANUFACTURERS DETAILS.

IMHOTEP'S APPOINTMENT IS RESTRICTED TO THE DESIGN OF DRAWINGS FOR PLANNING SUBMISSION ONLY AND HAVE NO SITE ROLE. THE CONTRACTOR IS THUS ENTIRELY RESPONSIBLE FOR COMPLIANCE WITH THE HEALTH AND SAFETY AT WORK ACT AND NO LIABILITY WILL BE ACCEPTED BY IMHOTEP DESIGN LTD. THE CONTRACTOR SHALL BE SPECIFICALLY RESPONSIBLE FOR ALL TEMPORARY WORKS AND FOR THE STABILITY OF THE AFFECTED LAND AND STRUCTURES.

THE CONTRACTOR SHALL COMPLY WITH THE FOLLOWING:-

a. ALL OPERATIONS SHOULD BE CARRIED OUT IN ACCORDANCE WITH THE GENERAL HEALTH AND SAFETY POLICY OF MAIN CONTRACTOR AS REQUIRED BY SECTIONS 2 OF THE HEALTH AND SAFETY AT WORK ACT 1974 AND IN PARTICULAR THE CONSTRUCTION (GENERAL PROVISIONS) REGULATIONS.

b. THE LOCAL AUTHORITY AND SERVICE COMPANIES ARE TO BE NOTIFIED PRIOR TO COMMENCEMENT OF WORK ON SITE.

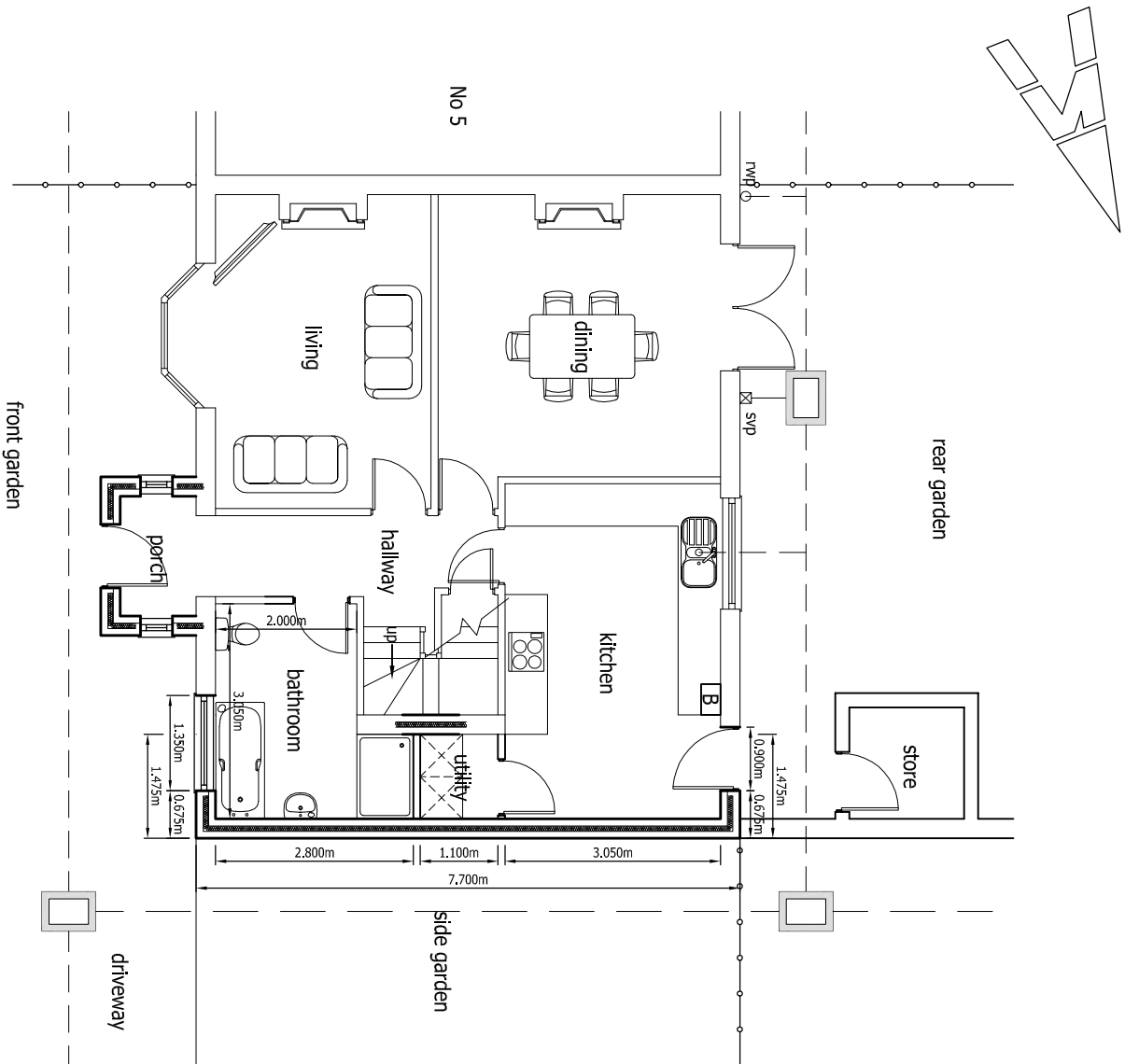

PROPOSED GROUND FLOOR PLAN

Scale 1:100

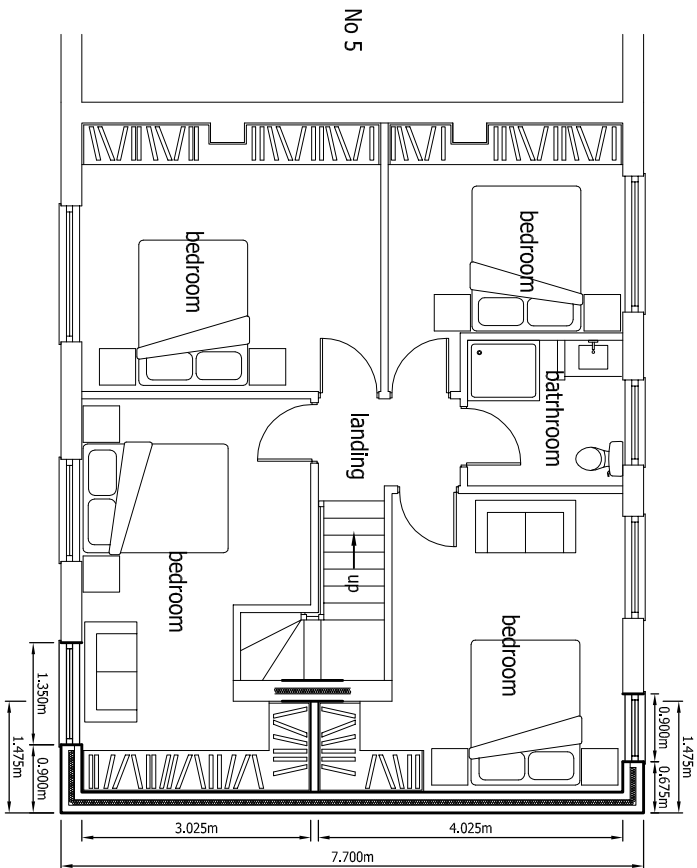

PROPOSED FIRST FLOOR PLAN

Scale 1:100

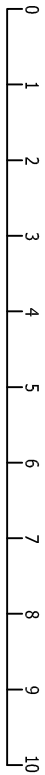

Scale Bar - Metres

**KEY:**

	Approx existing line of drainage
	450mm polypropylene inspection chamber
	Existing external wall
	external wall - 285mm cavity wall construction with 85mm cavity insulation



SCALED @ A3

CLIENT:

MR PAUL MILTON  
7 SCHOOL WAY  
LIVERPOOL  
L24 1UH

SITE LOCATION:

7 SCHOOL WAY  
LIVERPOOL  
L24 1UH

JOB NO.	DRAWING NO.	REVISION
0104	03	-

DATE - APRIL 2015