

Drawings Based on measurements by others

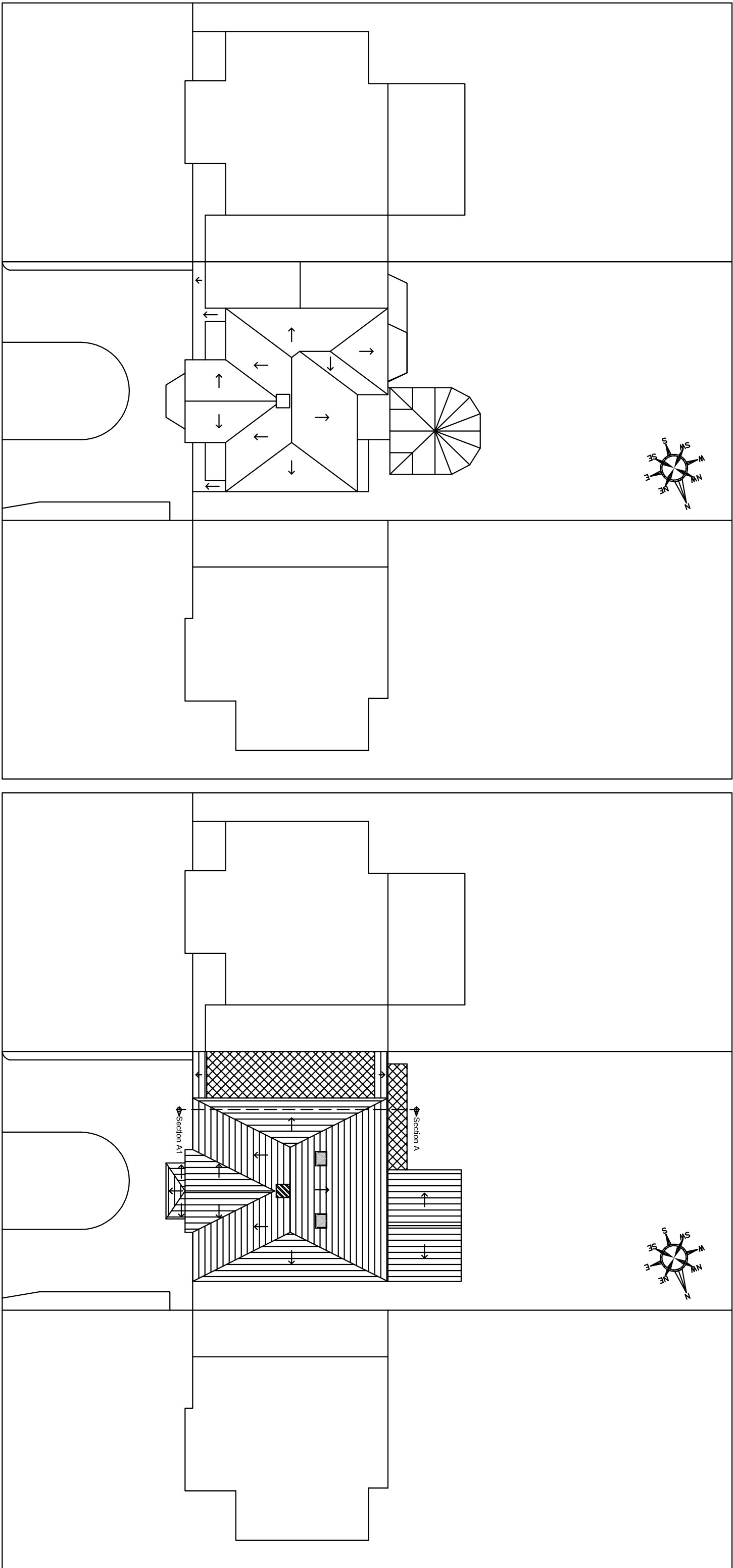

GENERAL NOTES:

All work should be carried out in accordance with current approved documents.

The contractor should check all dimensions and conditions prior to commencement of works on site.

The designer will not accept the responsibility of anomalies or mistakes occurring during construction stages.

A detailed design and supervision service will be carried out on a separate basis as agreed with the client.

Internal wall construction and wall thicknesses to be checked and confirmed by the contractor prior to works commencing on site.

All materials and workmanship are to comply with the relevant and current British standards and codes of practice.

The manufacturer's recommendations are to be followed in respect of the installation and fixing of all products and any discrepancies between those recommendations and any other requirement of the specification or drawings should be reported back to Paul Ennis and Company.

All necessary planning/building control approvals should be obtained prior to the commencement of the works, and complied with.

Any deviation from the approved drawings is undertaken at your own risk, and may require further planning/building control approvals.

All steelwork dimensions to be checked by general and fabricating contractors prior to fabrication of steelwork.

**CDM Regulations:** all parties must abide by the construction design and management regulations 2007. It is the client's responsibility to appoint a competent cdn co-ordinator on all projects that are notifiable to the health & safety executive, projects are notifiable if the building works will involve more than 500 man hours or be longer than 30 days in duration, projects for domestic clients are not notifiable, however the cdn regulations do still apply, domestic clients are people who have work done to their own home or the home of a family member (which they live in or will live in), that does not relate to a trade or business.

**Party Wall Act:** The owner has a duty to serve a party structure notice to any adjoining owner if works are to be carried out to a party wall, structure, or line of junction or if works involve excavations lower than the foundations of a neighbouring building within 3m, or excavations cut through a 45° line from the foundations of a neighbouring building within 6m, a party wall agreement/award should be formalised before the commencement of the works.

No.	Revision/Issue	Date	
Client: Mr & Mrs Hayes			
Site Location: 9 Blackwood Avenue Woolton Liverpool L25 4RH			
Project: Extension to front and rear including new roof structure			
Drawing Title: Existing & Proposed Site/Block Plan			
Project Number: BPE/2014/281/09			
Project Status:			
Stage:	Draft:	Approved:	
Design			
Planning			
Building Regulations			
Date: March '15	Drawn By: AKR/ME		
Scale: 1:100, 1:50@A1	Revision: 28109-003	Drawing Number:	

185 Liverpool Road, Southport, PR8 4NZ  
HEAD OFFICE: T: 01704 562675 F: 01704 560939  
E: office@paulennis.co.uk W: paulennis.co.uk

**PAUL ENNIS**  
CHARTERED SURVEYORS | CONSULTANT ENGINEERS | PROJECT MANAGERS

**incabe**  
Institution of Chartered  
Building Engineers  
RICS

**INCABE**  
Institution of Chartered  
Building Engineers  
RICS